

NEW MEXICO OIL CONSERVATION COMMISSION
WELL LOCATION AND ACERAGE DEDICATION PLAT

All distances must be from the outer boundaries of the Section

Operator EL PASO NATURAL GAS COMPANY			Lease CASE (SF-078095)		Well No. 1 -A
Unit Letter D	Section 5	Township 31 NORTH	Range 11 WEST	County SAN JUAN	
Actual Footage Location of Well: 818 feet from the NORTH line and 925 feet from the WEST line					
Ground Level Elev. 6520	Producing Formation PIC. CLIFFS MESA VERDE		Pool BLANCO PICTURED CLIFFS BLANCO MESA VERDE	Dedicated Acreage: 310.22 & 150.22 <input checked="" type="checkbox"/>	

1. Outline the acreage dedicated to the subject well by colored pencil or hatchure marks on the plat below.
2. If more than one lease is dedicated to the well, outline each and identify the ownership thereof (both as to working interest and royalty),
3. If more than one lease of different ownership is dedicated to the well, have the interests of all owners been consolidated by communitization, unitization, force-pooling, etc?
 () Yes () No If answer is "yes," type of consolidation _____

If answer is "no," list the owners and tract descriptions which have actually consolidated. (Use reverse side of this form if necessary.) _____

No allowable will be assigned to the well until all interests have been consolidated (by communitization, unitization, forced-pooling, or otherwise) or until a non standard unit, eliminating such interests, has been approved by the Commission.

CERTIFICATION

I hereby certify that the information contained herein is true and complete to the best of my knowledge and belief.

A. G. Brisco
 Name
Drilling Clerk
 Position
El Paso Natural Gas Co.
 Company
12-14-77

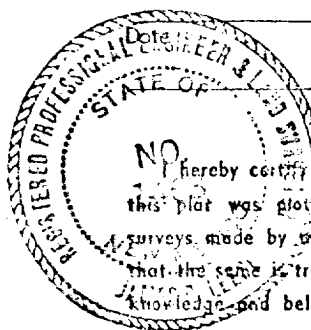
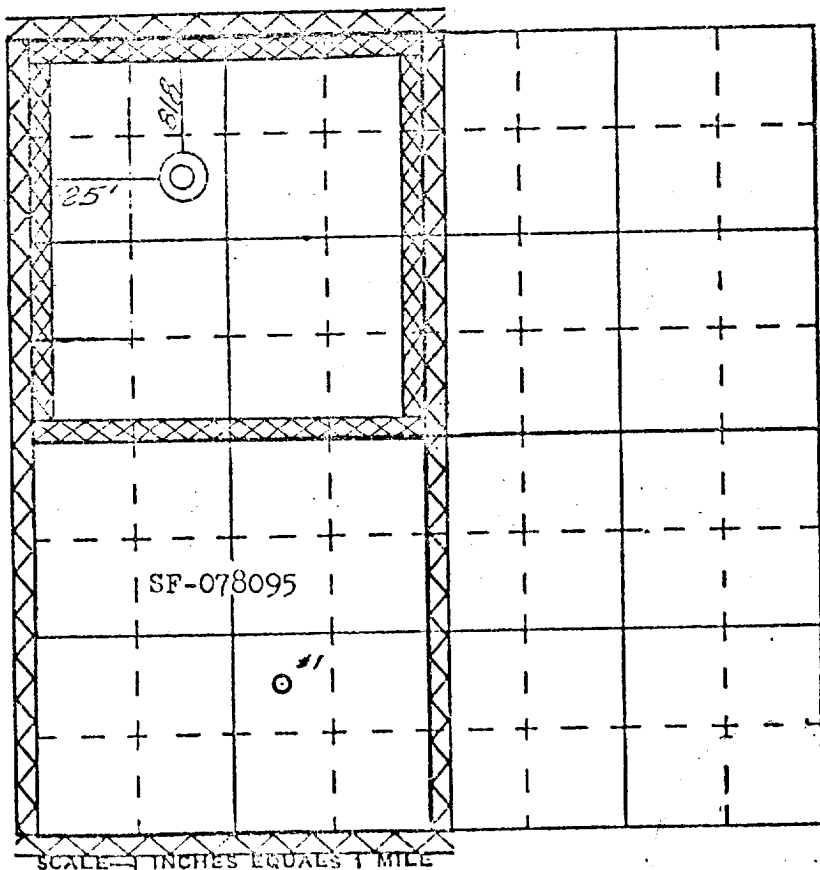

I hereby certify that the well location shown on this plat was plotted from field notes of actual surveys made by me or under my supervision, and that the same is true and correct to the best of my knowledge and belief.

9 November 1977
 Date Surveyed
James P. Leeso
 Registered Professional Engineer
 and/or Land Surveyor **James P. Leeso**