

# *Consolidated Oil & Gas, Inc.*

LINCOLN TOWER BUILDING  
1860 LINCOLN STREET  
DENVER, COLORADO 80295  
(303) 861-5252

May 3, 1978

U. S. Geological Survey  
P. O. Box 959  
Farmington, New Mexico 87401

Re: Application for Permit to Drill  
Williams 1-A  
San Juan County, New Mexico

Gentlemen:

Following is the information requested in NTL-6 to accompany the permit to drill:

1. Location: 1190' FNL and 1850' FWL Sec 24, T31N, R13W, San Juan County, New Mexico
2. Elevation of Unprepared Ground: 5853' GL
3. Geologic Name of Surface Formation: Nacimiento
4. Type Drilling Tools: Rotary
5. Proposed Drilling Depth: 6800'
6. Estimated Tops of Geologic Markers: Ojo Alamo 352'; Pictured Cliff 2050'; Cliff House 3698'; Pt. Lookout 4427'; Dakota 6594'
7. Estimated Depths at Which Anticipated Gas or Oil Bearing Formations Expected: Pictured Cliff 2050'; Cliff House 3698'; Pt. Lookout 4427'; Dakota 6594'
8. Casing Program and Setting Depth:

	<u>Size</u>	<u>Weight</u>	<u>Grade</u>	<u>Condition</u>	<u>Setting Depth</u>
Surface	10-3/4"	24.0#	K-55	New	250'
Production	5-1/2"	15.5#	K-55	New	6800'

9. Casing Setting Depth and Cementing:

- a. Surface casing will be set at 250'. Cement will be circulated to surface with approximately 200 sx Class "B" neat cement containing 2%  $\text{CaCl}_2$ .
- b. Production casing will be set to total depth of approximately 6800'. A stage collar will be run in the casing string at approximately 4800'. The casing will be cemented in two stages with the first stage consisting of 60 sx 65/35 Pozmix with 12% gel, tailed with 160 sx 50/50 Pozmix with 4% gel and 0.4% FLA. The second stage will consist of 120 sx 65/35 Pozmix with 6% gel tailed with 160 sx 50/50 Pozmix with 4% gel and 0.4% FLA.

Note: Exact volume of cement to be determined after running Caliper log.

10. Pressure Control Equipment: See attached diagram "A".

11. Circulating Media: 0-250' fresh water spud mud; 250-6800' fresh water low solid mud with following properties:

Viscosity 32-38 sec., water loss 20-6 cc, weight 8.5-9.0 ppg. with heavier weights if required by well conditions.

12. Testing, Logging and Coring Programs:

- a. Open hole logs will be run prior to running production casing.
- b. Coring is not planned.

13. Abnormal Pressure or Temperature and Hydrogen Sulfide Gas:

We do not anticipate abnormal pressure, temperature, or hydrogen sulfide gas; however, remote control blowout preventer as shown on attached diagram "A" will be installed.

14. Anticipated Starting Date: Drilling operations should start shortly after June 15, 1978.

15. Other Facets of the Proposed Operations: None

Yours very truly,

CONSOLIDATED OIL & GAS, INC.

*C. M. Parham*  
for C. M. Parham  
Senior Production Engineer

DEVELOPMENT PLAN FOR SURFACE USE

Williams 1-A

Consolidated Oil & Gas, Inc. - Operator

U.S.N.M.-048376

NE NW Sec. 24-T31N-R13W NMPM

San Juan County, New Mexico

1. Existing Roads

See enclosed topographic map (Attachment "A") which shows existing improved and unimproved roads.

2. Planned Access Roads

See enclosed topographic map (Attachment "A"). The required new road will be approximately 1050' long and 12' wide.

3. Location of Existing Wells

See enclosed lease map (Attachment "B").

4. Location of Existing and/or Proposed Facilities

See enclosed lease map (Attachment "B") showing location of wells and facilities operated by Consolidated Oil & Gas, Inc. If production is encountered, the tank battery and other required producing equipment will be located per attached completion plat (Attachment "C").

5. Location and Type of Water Supply

Water for drilling will be trucked approximately fifteen miles from an irrigation canal in Aztec, New Mexico or purchased locally and transported via irrigation pipe if water is available.

6. Source of Construction Materials

No additional construction material will be required.

7. Methods of Handling Waste Disposal

All waste material will be contained by earthen and steel pits. Earthen pits will be subsequently backfilled and buried. A portable chemical toilet will be furnished for drilling personnel.

8. Ancillary Facilities

No separate drill campsites are proposed

9. Wellsite Layout

The drilling site location will be graded and will approximate 200' x 250' with natural drainage to the southwest. Care will be taken while grading to control erosion. A 10' cut will be required on the southeast side of the wellsite. See attached drillsite layout (Attachment "D").

10. Plans for Restoration of Surface

- A. Following drilling and completion operations, all equipment and material not needed for operations will be removed. Pits containing fluid will be fenced until filled with any additional pits filled and the location cleaned of all trash and junk.
- B. After abandonment, any special rehabilitation and/or revegetation requirements (reseed with seed mixture No. 2) will be complied with and accomplished as expeditiously as possible. All pits should be filled and leveled within 90 days after abandonment.

11. Other Information

The location is on the side of a slope in a rolling hills area. The sandy clay soil has scrub cedar vegetation with no grass. No residences or structures are nearby. The surface rights are Federally owned. If during operations, any historic or prehistoric ruin, monument or site, or any object of antiquity is discovered, work will be suspended and the discovery will be reported to the appropriate regulatory agency.

12. Operator's Representative

Consolidated Oil & Gas, Inc.  
C. M. Parham  
Senior Production Engineer  
1860 Lincoln Street  
Denver, Colorado 80295  
Phone (303) 861-5252

13. Certification

I hereby certify that I, or persons under my direct supervision, have inspected the proposed drillsite and access route; that I am familiar with the conditions which presently exist; that the statements made in this plan are, to the best of my knowledge, true and correct; and that the work associated with the operations proposed herein will be performed by Consolidated Oil & Gas, Inc. and its contractors and subcontractors in conformity with this plan and the terms and conditions under which it is approved.

May 3, 1978  
\_\_\_\_\_  
Date

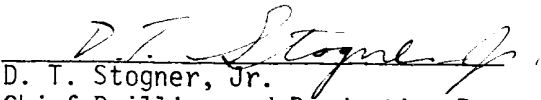
  
D. T. Stogner, Jr.  
Chief Drilling and Production Engr.

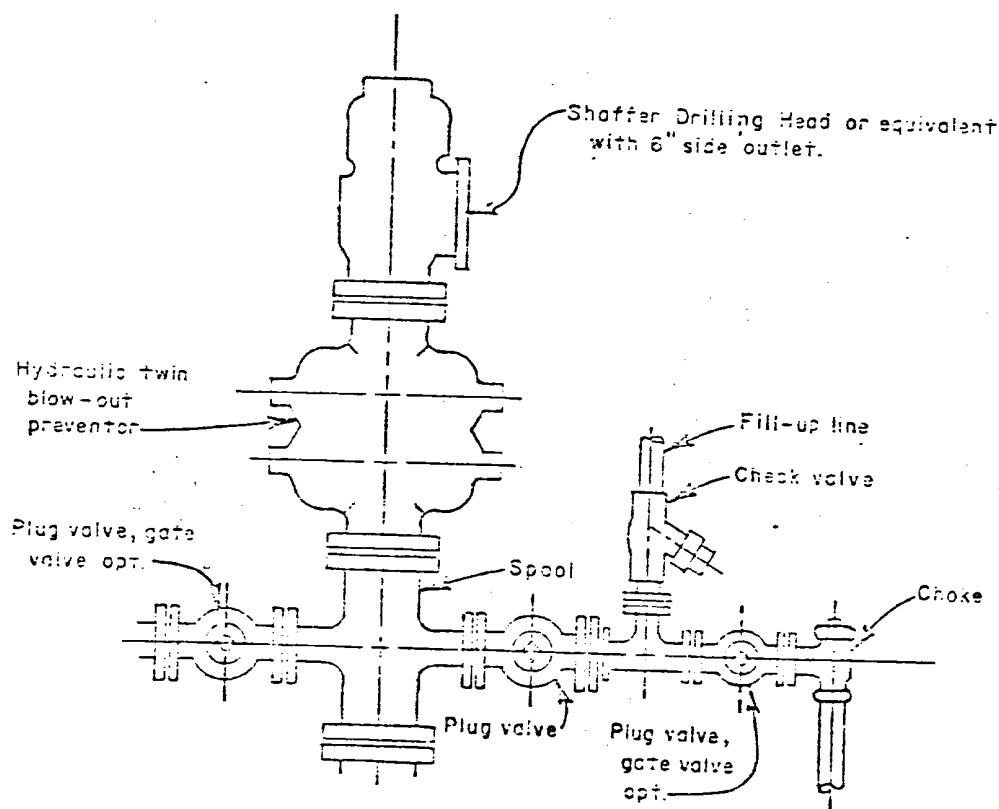

DIAGRAM "A"

U.S.G.S. APPLICATION FOR PERMIT  
TO DRILL

CONSOLIDATED OIL & GAS, INC - OPERATOR

WILLIAMS 1-A

U.S.N.M. -048376

NE NW SEC 24-T31N-R13W NMPM

SAN JUAN COUNTY, NEW MEXICO

SAN JUAN COUNTY, NEW MEXICO

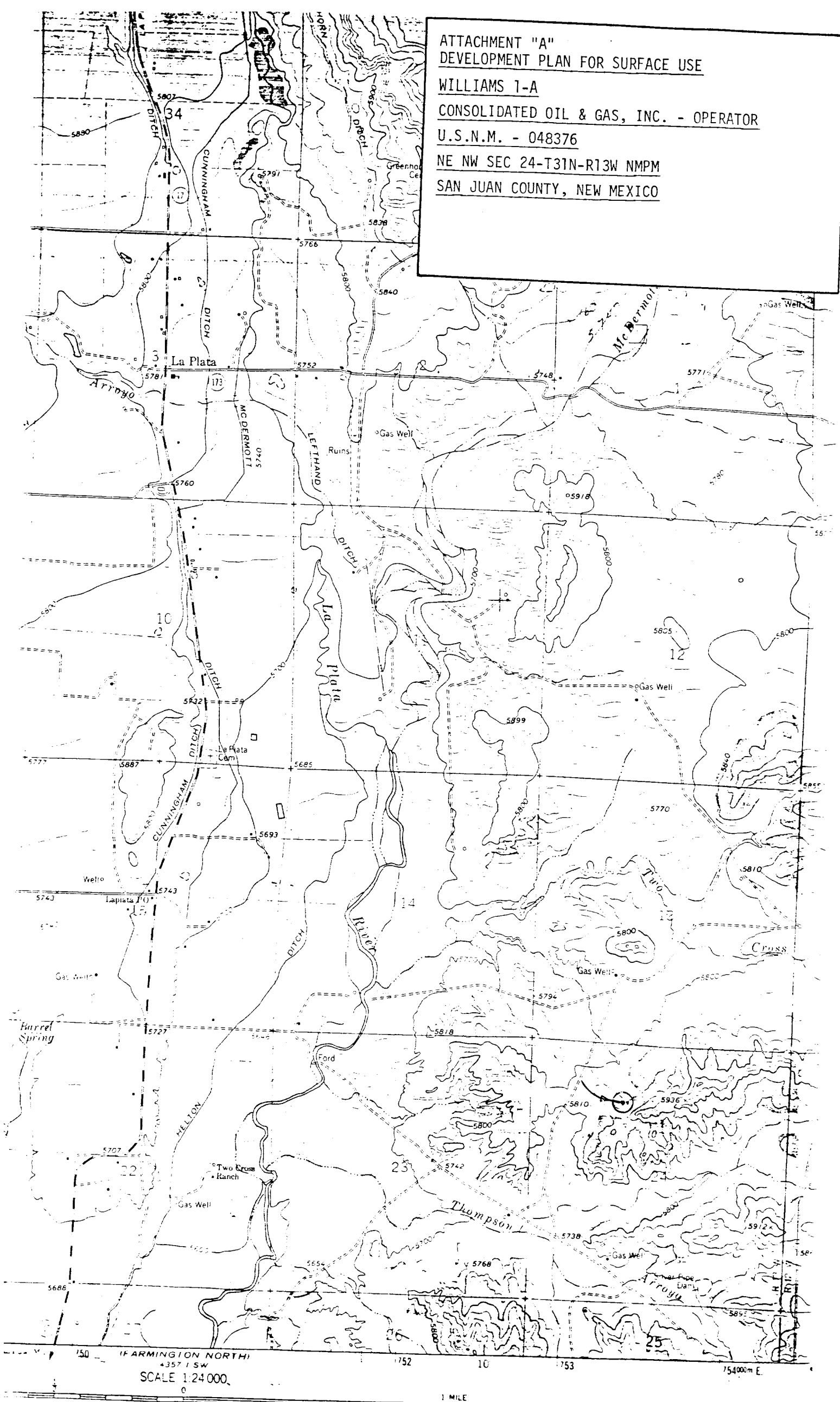

ATTACHMENT "B"  
DEVELOPMENT PLAN FOR SURFACE  
USE

WILLIAMS 1-A

CONSOLIDATED OIL & GAS, INC -  
OPERATOR

U.S.N.M. - 048376

NE NW SEC 24-T31N-R13W NMPM

SAN JUAN COUNTY, NEW MEXICO

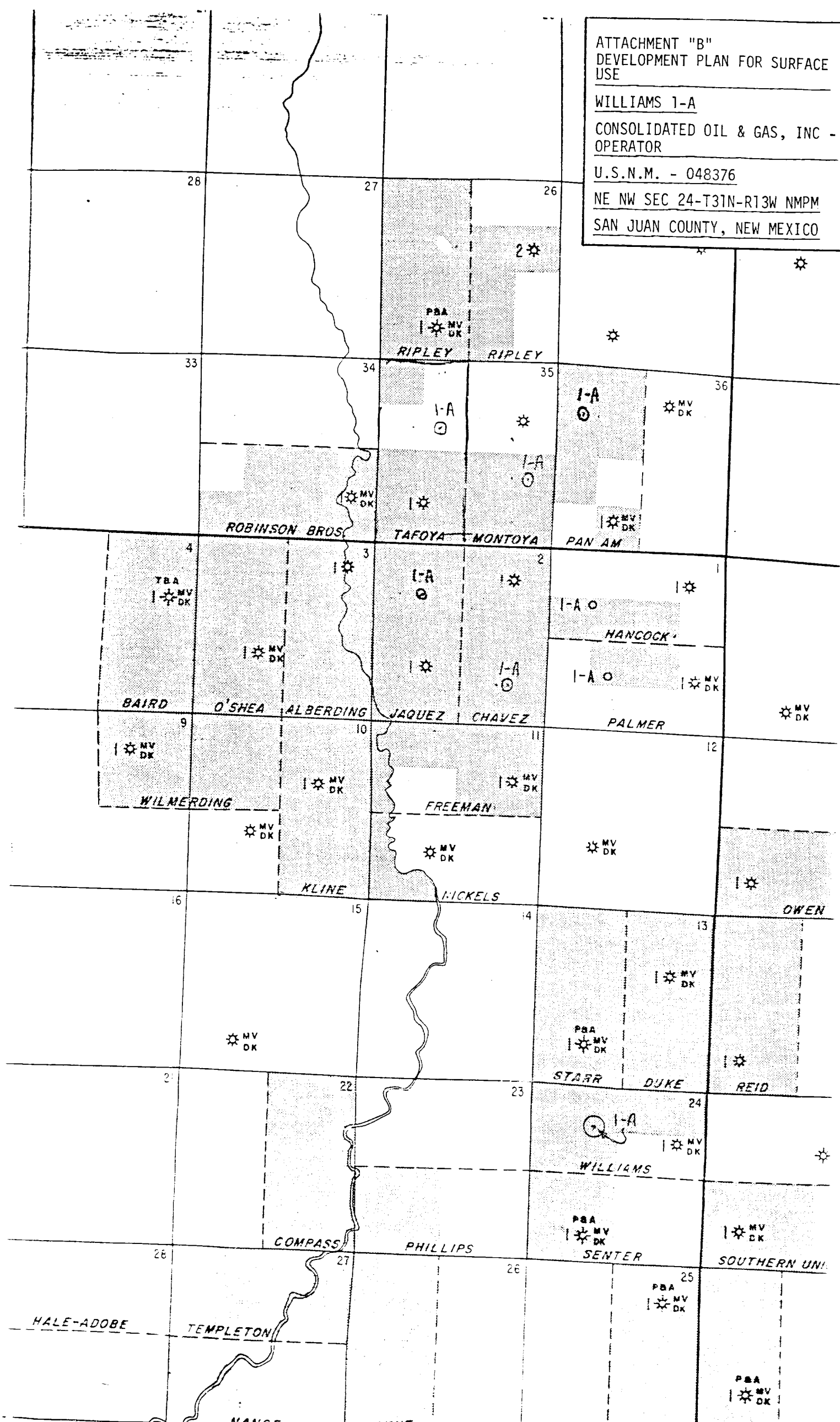



ATTACHMENT "C"

DEVELOPMENT PLAN FOR SURFACE USE

CONSOLIDATED OIL & GAS, INC. - OPERATOR

WILLIAMS 1-A

U.S.N.M. - 048376

NE NW SEC 24-T31N-R13W NMPM

SAN JUAN COUNTY, NEW MEXICO

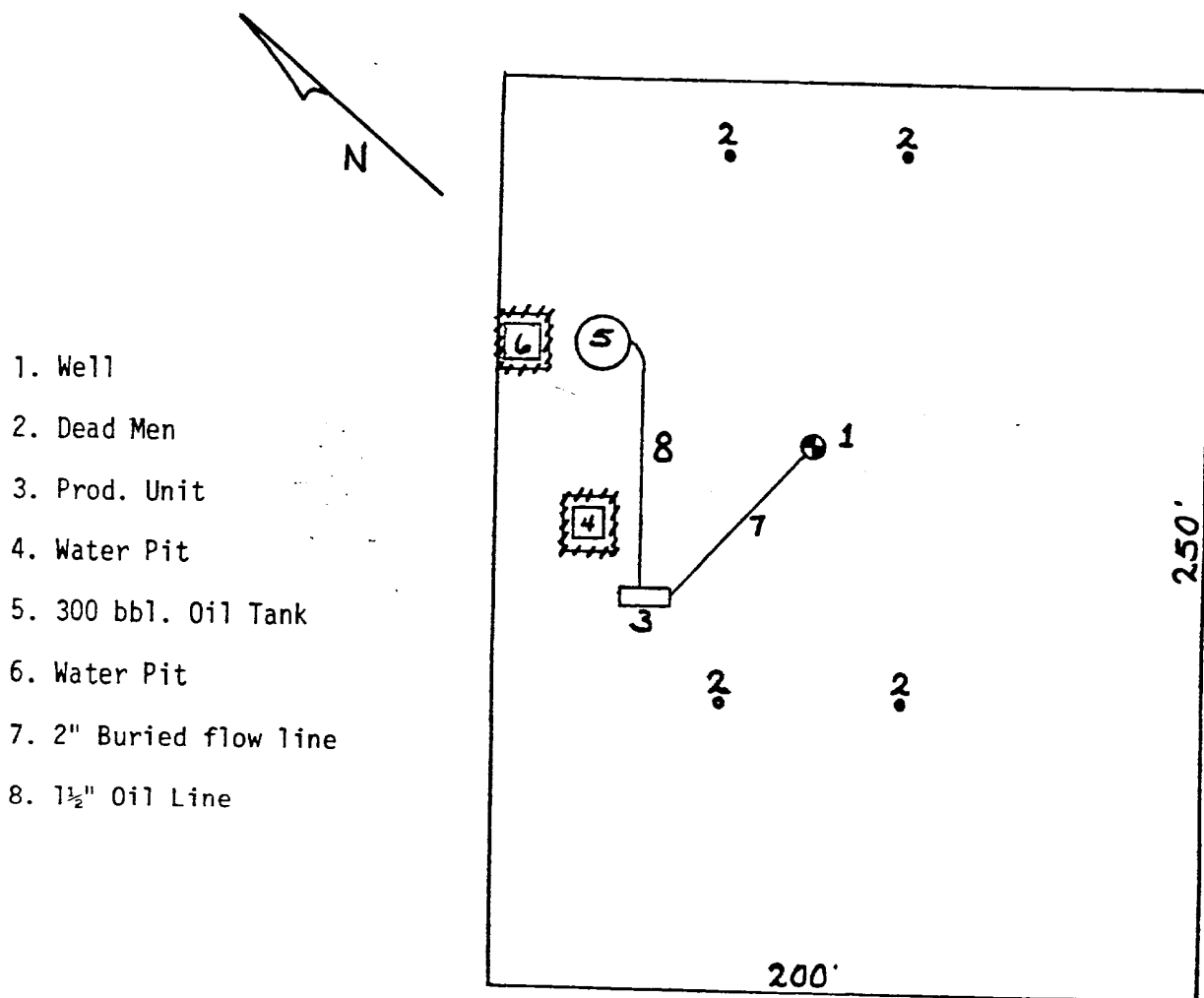

1" equals 50'

Fence - - - - -

ATTACHMENT "D"

DEVELOPMENT PLAN FOR SURFACE USE

CONSOLIDATED OIL & GAS, INC. - OPERATOR

WILLIAMS 1-A

U.S.N.M. - 048376

NE NW SEC 24-T31N-R13W NMPM

SAN JUAN COUNTY, NEW MEXICO

1. Sub.
2. Drive in unit
3. Doghouse
4. Water Tank
5. Walk
6. Pipe racks
7. Pipe racks
8. Steel working pit
9. Pump
10. Pump
11. Mud storage
12. Light plant
13. Change house
14. Reserve pit
15. Air compressor
16. Air compressor
17. Air Compressor
18. Burn Pit
19. Blow Pit
20. Latrine (chemical)

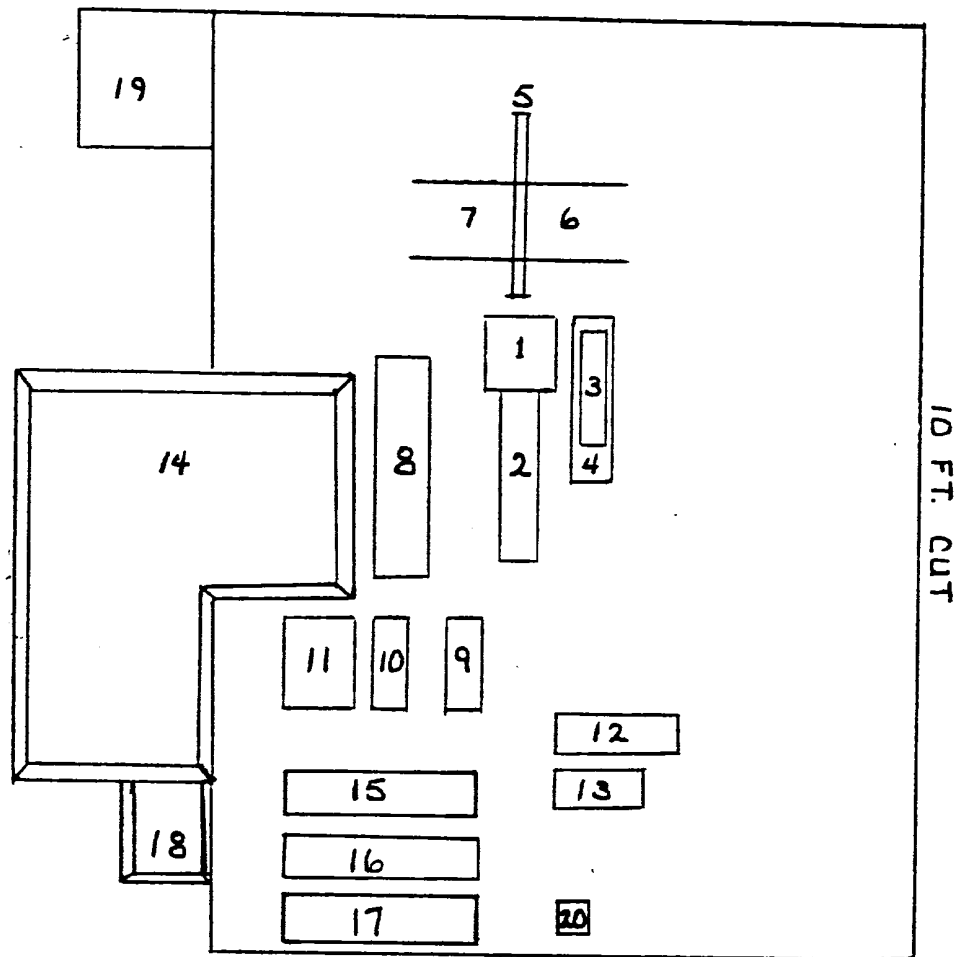

1" equals 50'

