

NO. OF COPIES RECEIVED	6
DISTRIBUTION	
SANTA FE	
FILE	
U.S.G.S.	2
LAND OFFICE	
OPERATOR	2

# NEW MEXICO OIL CONSERVATION COMMISSION

30-095-23044  
Form C-101  
Revised 1-1-65

5A. Indicate Type of Lease	
STATE <input type="checkbox"/>	FEE <input checked="" type="checkbox"/>
5. State Oil & Gas Lease No.	

## APPLICATION FOR PERMIT TO DRILL, DEEPEN, OR PLUG BACK

1a. Type of Work		7. Unit Agreement Name	
b. Type of Well OIL WELL <input type="checkbox"/> GAS WELL <input checked="" type="checkbox"/> OTHER <input type="checkbox"/>		8. Farm or Lease Name Atlantic B	
2. Name of Operator El Paso Natural Gas Company		9. Well No. 26	
3. Address of Operator P.O. Box 990 Farmington, NM		10. Field and Pool, or Wildcat Blanco Picture d-Cliffs	
4. Location of Well UNIT LETTER N LOCATED 990 FEET FROM THE south LINE AND 1500 FEET FROM THE west LINE OF SEC. 34 TWP. 31-N RGE. 10-W NMPM		12. County San Juan	
19. Proposed Depth 3110		19A. Formation Pictured Cliff	20. Rotary or C.T. Rotary
21. Elevations (Show whether DF, RT, etc.) 6232 GR.	21A. Kind & Status Plug. Bond Statewide	21B. Drilling Contractor	22. Approx. Date Work will start

23.

### PROPOSED CASING AND CEMENT PROGRAM

SIZE OF HOLE	SIZE OF CASING	WEIGHT PER FOOT	SETTING DEPTH	SACKS OF CEMENT	EST. TOP
12 1/4	8 5/8	24	120	84	circulate
6 3/4	2 7/8	6.5	3110	323	top of Ojo Alamo

Selectively perforate and sand water fracture the Pictured Cliffs formation

A 3000 psi WP and 6000 psi test double gate preventor equipped with blind and pipe rams will be used for blow out prevention on this well.

This gas is dedicated

The SW/4 of Sec. 34 is dedicated to this well.

EXPIRES 8-21-78

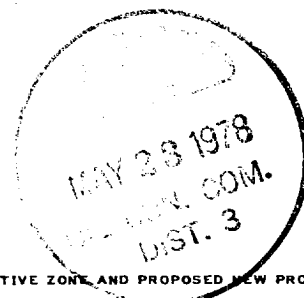

IN ABOVE SPACE DESCRIBE PROPOSED PROGRAM: IF PROPOSAL IS TO DEEPEN OR PLUG BACK, GIVE DATA ON PRESENT PRODUCTIVE ZONE AND PROPOSED NEW PRODUCTIVE ZONE. GIVE BLOWOUT PREVENTER PROGRAM, IF ANY.

I hereby certify that the information above is true and complete to the best of my knowledge and belief.

Signed A. D. Duico Title Drilling Clerk Date 5-18-78

(This space for State Use)

APPROVED BY [Signature] TITLE SUPERVISOR DIST. 3 DATE MAY 28 1978

CONDITIONS OF APPROVAL, IF ANY:

30.000. 11.000

# NEW MEXICO OIL CONSERVATION COMMISSION WELL LOCATION AND ACREAGE DEDICATION PLAT

Form C-102  
Supersedes C-129  
Effective 1-1-65

All distances must be from the outer boundaries of the Section.

Operator <b>EL PASO NATURAL GAS COMPANY</b>		Lease <b>ATLANTIC B (FEE)</b>		Well No. <b>26</b>
Unit Letter <b>N</b>	Section <b>34</b>	Township <b>31-N</b>	Range <b>10-W</b>	County <b>SAN JUAN</b>
Actual Footage Location of Well: <b>990</b> feet from the <b>SOUTH</b> line and <b>1500</b> feet from the <b>WEST</b> line				
Ground Level Elev. <b>6232</b>	Producing Formation <b>PICTURED CLIFFS</b>	Pool <b>BLANCO PICTURED CLIFFS</b>	Dedicated Acreage: <b>157.92</b> Acres	

1. Outline the acreage dedicated to the subject well by colored pencil or hachure marks on the plat below.
2. If more than one lease is dedicated to the well, outline each and identify the ownership thereof (both as to working interest and royalty).
3. If more than one lease of different ownership is dedicated to the well, have the interests of all owners been consolidated by communitization, unitization, force-pooling, etc?

☒ Yes ☐ No If answer is "yes," type of consolidation Communitization

If answer is "no," list the owners and tract descriptions which have actually been consolidated. (Use reverse side of this form if necessary.)

No allowable will be assigned to the well until all interests have been consolidated (by communitization, unitization, forced-pooling, or otherwise) or until a non-standard unit, eliminating such interests, has been approved by the Commission.

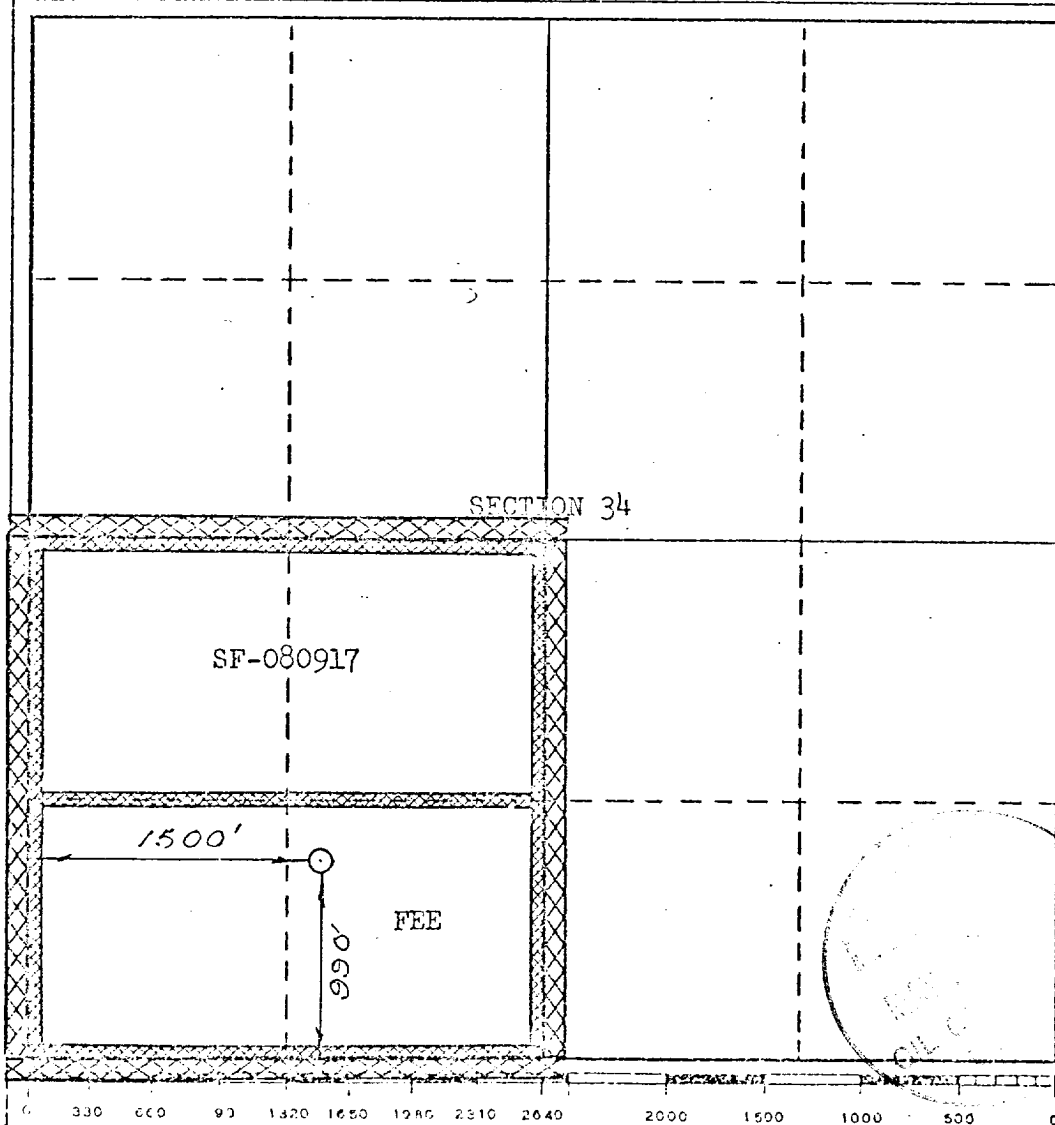

## CERTIFICATION

I hereby certify that the information contained herein is true and complete to the best of my knowledge and belief.

*A. G. Guero*

Name  
**Drilling Clerk**

Position  
**El Paso Natural Gas Co.**

Company  
**5-18-78**

Date

I hereby certify that the well location shown on this plat was plotted from field notes of actual surveys made by me or under my supervision, and that the same is true and correct to the best of my knowledge and belief.

Date Surveyed  
**JANUARY 8, 1974**

Registered Professional Engineer  
and/or Land Surveyor

Certificate No. **1760**