

NO. OF COPIES RECEIVED	6
DISTRIBUTION	
SANTA FE	
FILE	
U.S.G.S.	2
LAND OFFICE	
OPERATOR	2

NEW MEXICO OIL CONSERVATION COMMISSION

30-045-23067  
Form C-101  
Revised 1-1-65

5A. Indicate Type of Lease STATE <input type="checkbox"/> FEE <input checked="" type="checkbox"/>
5. State Oil & Gas Lease No.

8-29-78

APPLICATION FOR PERMIT TO DRILL, DEEPEN, OR PLUG BACK			
1a. Type of Work DRILL <input checked="" type="checkbox"/> DEEPEN <input type="checkbox"/> PLUG BACK <input type="checkbox"/>		7. Unit Agreement Name	
b. Type of Well OIL WELL <input type="checkbox"/> GAS WELL <input checked="" type="checkbox"/> OTHER <input type="checkbox"/>		8. Farm or Lease Name Page	
2. Name of Operator Southland Royalty Company		9. Well No. #2A	
3. Address of Operator P. O. Drawer 570, Farmington, New Mexico		10. Field and Pool, or Wildcat Blanco Mesa Verde	
4. Location of Well UNIT LETTER I LOCATED 1770 FEET FROM THE South LINE AND 1120 FEET FROM THE East LINE OF SEC. 7 TWP. 32N RGE. 10W NMPM		12. County San Juan	
19. Proposed Depth 5592'		19A. Formation Mesa Verde	20. Rotary or C.T. Rotary
21. Elevations (Show whether DF, RT, etc.) 6232' GR	21A. Kind & Status Plug. Bond	21B. Drilling Contractor	22. Approx. Date Work will start Juen 15, 1978

23. PROPOSED CASING AND CEMENT PROGRAM

SIZE OF HOLE	SIZE OF CASING	WEIGHT PER FOOT	SETTING DEPTH	SACKS OF CEMENT	EST. TOP
12-1/4"	9-5/8"	36#	300'	160 sxs	Circ to surface
8-3/4"	7"	20#	3263'	270 sxs	Cover Ojo Alamo
6-1/4"	4-1/2"	10.5#	3113'-5592'	265 sxs	Liner top
	2-3/8"	4.7#	5550'		

Surface formation is San Jose.  
Top of the Ojo Alamo is at 1494'.  
Top of the Pictured Cliffs is at 2963'.  
Fresh water mud will be used to drill from surface to intermediate casing point.  
An air system will be used to drill from intermediate depth to total depth.  
It is anticipated that IES and GR-Density logs be run at intermediate depth.  
It is anticipated that GR-Induction and GR-Density logs be run at total depth.  
No abnormal pressures or poisonous gases are anticipated in this well.  
It is expected that this well be drilled by August 1, 1978. This depends on time required for approvals, rig availability and the weather.  
Gas is dedicated.

IN ABOVE SPACE DESCRIBE PROPOSED PROGRAM: IF PROPOSAL IS TO DEEPEN OR PLUG BACK, GIVE DATA ON PRESENT PRODUCTIVE ZONE AND PROPOSED NEW PRODUCTIVE ZONE. GIVE BLOWOUT PREVENTER PROGRAM, IF ANY.

I hereby certify that the information above is true and complete to the best of my knowledge and belief.  
Signed Van Ryan Title District Production Manager Date May 25, 1978

(This space for State Use)  
APPROVED BY AK Kendrick TITLE SUPERVISOR DIST. #3 DATE MAY 31 1978  
CONDITIONS OF APPROVAL, IF ANY:

11111 2-UG7

NEW MEXICO OIL CONSERVATION COMMISSION  
WELL LOCATION AND ACREAGE DEDICATION PLAT

Form C-102  
Supersedes C-128  
Effective 1-1-65

All distances must be from the outer boundaries of the Section.

Operator <b>SOUTHLAND ROYALTY COMPANY</b>			Lease <b>Page</b>		Well No. <b>2A</b>
Unit Letter <b>I</b>	Section <b>7</b>	Township <b>32N</b>	Range <b>10W</b>	County <b>San Juan</b>	
Actual Footage Location of Well: <b>1770</b> feet from the <b>South</b> line and <b>1120</b> feet from the <b>East</b> line					
Ground Level Elev: <b>6232</b>	Producing Formation <b>Mesa Verde</b>	Pool <b>Blanco</b>		Dedicated Acreage: <b>320 327.64</b> Acres	

1. Outline the acreage dedicated to the subject well by colored pencil or hatchure marks on the plat below.
2. If more than one lease is dedicated to the well, outline each and identify the ownership thereof (both as to working interest and royalty).
3. If more than one lease of different ownership is dedicated to the well, have the interests of all owners been consolidated by communitization, unitization, force-pooling, etc?

☐ Yes ☐ No If answer is "yes," type of consolidation \_\_\_\_\_

If answer is "no," list the owners and tract descriptions which have actually been consolidated. (Use reverse side of this form if necessary.) \_\_\_\_\_

No allowable will be assigned to the well until all interests have been consolidated (by communitization, unitization, forced-pooling, or otherwise) or until a non-standard unit, eliminating such interests, has been approved by the Commission.

*All of partial Section  
Null 3-497*

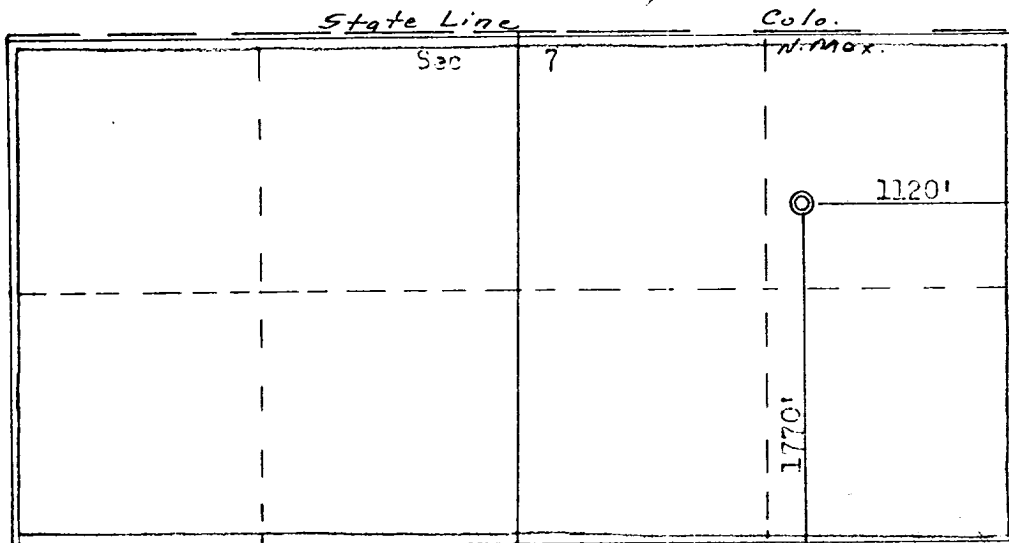

CERTIFICATION

I hereby certify that the information contained herein is true and complete to the best of my knowledge and belief.

Name *[Signature]*  
Position  
District Production Manager  
Company  
Southland Royalty Company  
Date  
May 25, 1978

I hereby certify that the well location shown on this plat was plotted from field notes of actual surveys made by me or under my supervision, and that the same is true and correct to the best of my knowledge and belief.

Date Surveyed  
April 3, 1978  
Registered Professional Engineer and Land Surveyor  
*[Signature]*  
Fred B. Kerr Jr.  
Certificate No.  
3950