

NO. 6	6
DIST	
SANTA FE	1
FILE	1
U.S.G.S.	2
LAND OFFICE	
OPERATOR	2

# NEW MEXICO OIL CONSERVATION COMMISSION

30-095-23068  
Form C-101  
Revised 1-1-65

NEW MEXICO OIL CONSERVATION COMMISSION  
LAND OFFICE  
SANTA FE, N.M.

EXPIRES 8-29-78

5A. Indicate Type of Lease	
STATE <input type="checkbox"/>	FEE <input checked="" type="checkbox"/>
5. State Oil & Gas Lease No.	

## APPLICATION FOR PERMIT TO DRILL, DEEPEN, OR PLUG BACK

1a. Type of Work				7. Unit Agreement Name	
b. Type of Well DRILL <input checked="" type="checkbox"/> DEEPEN <input type="checkbox"/> PLUG BACK <input type="checkbox"/> OIL WELL <input type="checkbox"/> GAS WELL <input checked="" type="checkbox"/> OTHER <input type="checkbox"/> SINGLE ZONE <input type="checkbox"/> MULTIPLE ZONE <input checked="" type="checkbox"/>				8. Farm or Lease Name Mark Maddox	
2. Name of Operator Southland Royalty Company				9. Well No. #1A	
3. Address of Operator P. O. Drawer 570, Farmington, New Mexico				10. Field and Pool, or Wildcat Blanco Pictured Cliffs Blanco Mesa Verde	
4. Location of Well UNIT LETTER J LOCATED 1610 FEET FROM THE South LINE AND 1760 FEET FROM THE East LINE OF SEC. 15 TWP. 32N RGE. 11W NMPM				12. County San Juan	
19. Proposed Depth 5746'				19A. Formation Mesa Verde	
20. Rotary or C.T. Rotary				21. Elevations (Show whether DF, RT, etc.) 6411' GR	
21A. Kind & Status Plug. Bond				21B. Drilling Contractor	
22. Approx. Date Work will start June 15, 1978					

## PROPOSED CASING AND CEMENT PROGRAM

SIZE OF HOLE	SIZE OF CASING	WEIGHT PER FOOT	SETTING DEPTH	SACKS OF CEMENT	EST. TOP
12-1/4"	9-5/8"	36#	200'	110 SXS	Circ to surface
8-3/4"	7"	20#	3401'	270 SXS	Cover Ojo Alamo
6-1/4"	4-1/2"	10.5#	3251'-5746'	285 SXS	Liner top
	2-3/8"	4.7#	5680'		
	1-1/4"	2.3#	3250'		

Surface formation is Nacimiento.

Top of Ojo Alamo is at 1641'.

Top of Pictured Cliffs is at 3101'.

Fresh water mud will be used to drill from surface to intermediate casing point.

An air system will be used to drill from intermediate to total depth.

It is anticipated that an IES and a GR-Density log be run at intermediate casing point.

It is anticipated that a GR-Induction and a GR-Density log will be run at total depth.

No abnormal pressures or poisonous gases are anticipated in this well.

It is expected this well be drilled by August 1, 1978. This depends on time required for approvals, rig availability and the weather.

Gas is dedicated.

IN ABOVE SPACE DESCRIBE PROPOSED PROGRAM: IF PROPOSAL IS TO DEEPEN OR PLUG BACK, GIVE DATA ON PRESENT PRODUCTIVE ZONE AND PROPOSED NEW PRODUCTIVE ZONE, GIVE BLOWOUT PREVENTER PROGRAM, IF ANY.

I hereby certify that the information above is true and complete to the best of my knowledge and belief.

Signed [Signature] Title District Production Manager Date May 25, 1978

(This space for State Use)

APPROVED BY [Signature] TITLE SUPERVISOR DIST. 63 DATE MAY 31 1978

CONDITIONS OF APPROVAL, IF ANY:

**NEW MEXICO OIL CONSERVATION COMMISSION  
WELL LOCATION AND ACREAGE DEDICATION PLAT**

Form C-102  
Supersedes C-128  
Effective 1-1-65

All distances must be from the outer boundaries of the Section.

Operator <b>SOUTHLAND ROYALTY COMPANY</b>			Lease <b>Mark Maddox</b>		Well No. <b>1A</b>
Unit Letter <b>J</b>	Section <b>15</b>	Township <b>32N</b>	Range <b>11W</b>	County <b>San Juan</b>	
Actual Footage Location of Well: <b>1610</b> feet from the <b>South</b> line and <b>1760</b> feet from the <b>East</b> line					
Ground Level Elev. <b>6411</b>	Producing Formation <b>Mesa Verde / Pictured Cliffs</b>		Pool <b>Blanco / Blanco</b>	Dedicated Acreage: <b>320 ± 160</b> Acres	

1. Outline the acreage dedicated to the subject well by colored pencil or hachure marks on the plat below.
2. If more than one lease is dedicated to the well, outline each and identify the ownership thereof (both as to working interest and royalty).
3. If more than one lease of different ownership is dedicated to the well, have the interests of all owners been consolidated by communitization, unitization, force-pooling, etc?

☐ Yes    ☐ No    If answer is "yes," type of consolidation \_\_\_\_\_

If answer is "no," list the owners and tract descriptions which have actually been consolidated. (Use reverse side of this form if necessary.) \_\_\_\_\_

No allowable will be assigned to the well until all interests have been consolidated (by communitization, unitization, forced-pooling, or otherwise) or until a non-standard unit, eliminating such interests, has been approved by the Commission.

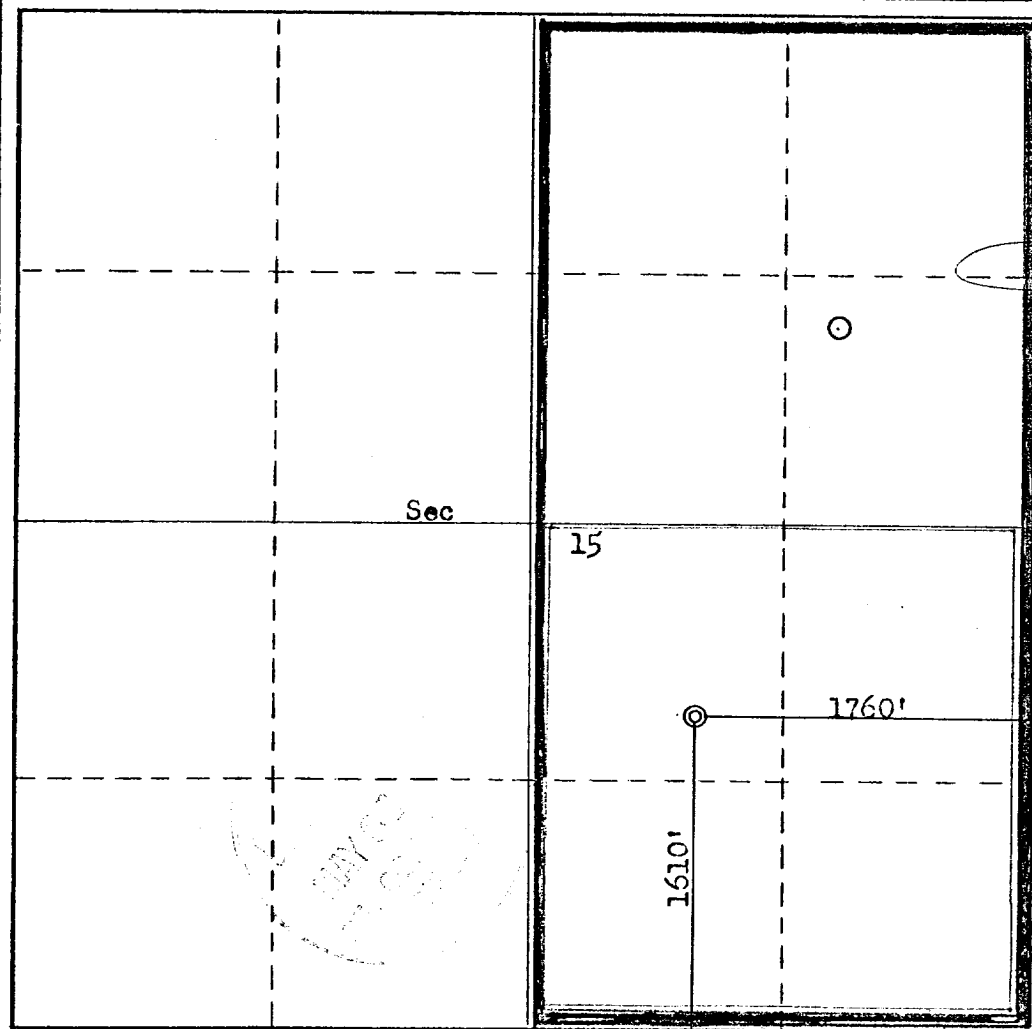

**CERTIFICATION**

*I hereby certify that the information contained herein is true and complete to the best of my knowledge and belief.*

Name *Stan Ryan*  
 Position  
**District Production Manager**  
 Company  
**Southland Royalty Company**  
 Date  
**May 25, 1978**

*I hereby certify that the well location shown on this plat was plotted from field notes of actual surveys made by me or under my supervision, and that the same is true and correct to the best of my knowledge and belief.*

Date Surveyed  
**April 8, 1978**  
 Registered Professional Engineer  
 and/or Land Surveyor  
*[Signature]*  
**Fred B. Kerr Jr.**  
 Certificate No. **3950**  
 EXPIRES **2-28-82**