

UNITED STATES
DEPARTMENT OF THE INTERIOR
GEOLOGICAL SURVEY

APPLICATION FOR PERMIT TO DRILL, DEEPEN, OR PLUG BACK

| | | | |
|---|--|--|--|
| 1a. TYPE OF WORK DRILL <input checked="" type="checkbox"/> DEEPEN <input type="checkbox"/> PLUG BACK <input type="checkbox"/> | | 5. LEASE DESIGNATION AND SERIAL NO. MOO-C-1420-1710 | |
| b. TYPE OF WELL OIL WELL <input checked="" type="checkbox"/> GAS WELL <input type="checkbox"/> OTHER <input type="checkbox"/> | | 6. IF INDIAN, ALLOTTEE OR TRIBE NAME Ute Mtn. Ute | |
| 2. NAME OF OPERATOR Robert C. Anderson | | 7. UNIT AGREEMENT NAME Ute x Mtn x AGA None | |
| 3. ADDRESS OF OPERATOR The Summit Bldg. - Suite 310 5929 N. May Ave. Oklahoma City, Okla. 73112 | | 8. FARM OR LEASE NAME Ute Mtn.-AGA | |
| 4. LOCATION OF WELL (Report location clearly and in accordance with any State requirements.)* At surface 790' FSL - 790' FEL Sec.15 T31N - R16W At proposed prod. zone Same | | 9. WELL NO. 3 | |
| 14. DISTANCE IN MILES AND DIRECTION FROM NEAREST TOWN OR POST OFFICE* | | 10. FIELD AND POOL, OR WILDCAT Straight Canyon Dakota | |
| 15. DISTANCE FROM PROPOSED* LOCATION TO NEAREST PROPERTY OR LEASE LINE, FT. (Also to nearest drlg. unit line, if any) 790 | | 11. SEC., T., R., M., OR BLK. AND SURVEY OR AREA Sec.15-Twp.31N-R16W N.M.P.M. | |
| 16. NO. OF ACRES IN LEASE 640 | | 12. COUNTY OR PARISH San Juan | |
| 17. NO. OF ACRES ASSIGNED TO THIS WELL 40 | | 13. STATE New Mexico | |
| 18. DISTANCE FROM PROPOSED LOCATION* TO NEAREST WELL, DRILLING, COMPLETED, OR APPLIED FOR, ON THIS LEASE, FT. 1499 | | 19. PROPOSED DEPTH 2500 | |
| 20. ROTARY OR CABLE TOOLS Rotary | | 21. APPROX. DATE WORK WILL START* Sept.18, 1978 | |
| 21. ELEVATIONS (Show whether DF, RT, GR, etc.) 5685 GL | | | |

| 23. PROPOSED CASING AND CEMENTING PROGRAM | | | | |
|---|----------------|-----------------|---------------------------|-------------------------------------|
| SIZE OF HOLE | SIZE OF CASING | WEIGHT PER FOOT | SETTING DEPTH | QUANTITY OF CEMENT |
| 9 7/8" | 7" | 20# | 550 feet | 200 sx.(Cir. to surface). |
| 6 1/4" | 4 1/2" | 10.5 | 2 1/2 (At proposed depth) | (Amt. to protect oil or gas zones). |

It is proposed to drill a Dakota sand well to an approximate depth of 2500 feet at the above captioned location in the following manner: 9 7/8" surface hole will be rotary-mud drilled to approx. depth of 550 feet and 7" surface casing set at this depth with the cement circulated to surface. A 6 1/4" hole then to be rotary air-drilled to the proposed depth. Blow out preventer will be installed and in use during drilling operations under surface casing. (Type B.O.P. - 8" - 900 Series, hydraulic closing, double ram, 6000 psi test, 3000 psi working pressure Shaffer blow out preventer). All drilled formations are to be carefully tested as would any prudent operator.

Gas or oil to be found ~~axx~~ at this location is not dedicated as yet. Approx. formation tops: Surface -- Point Lookout (MV). Mancos -- 450, Gallup sand zone 1700, Sanastee 1800, Greenhorn 2150 Dakota 2300.

IN ABOVE SPACE DESCRIBE PROPOSED PROGRAM. If proposal is to deepen or plug back, give data on present productive zone and proposed new productive zone. If proposal is to drill or deepen directionally, give pertinent data on subsurface locations and measured and true vertical depths. Give blowout preventer program, if any.

24. Ashton B. Geren, Jr. Agent for: Robert C. Anderson DATE Aug. 31, 1978
SIGNED Ashton B. Geren, Jr. TITLE Robert C. Anderson

(This space for Federal or State office use)

PERMIT NO. _____

APPROVAL DATE _____

APPROVED BY _____

TITLE _____

DATE _____

CONDITIONS OF APPROVAL, IF ANY:

ok Frank

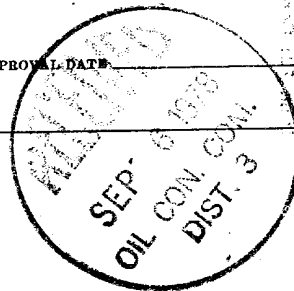

**NEW MEXICO OIL CONSERVATION COMMISSION
WELL LOCATION AND ACREAGE DEDICATION PLAT**

Form C-102
Supersedes C-124
Effective 1-1-75

All distances must be from the outer boundaries of the Section.

| | | | | | |
|---------------------------------------|--------------------------------------|---------------------------------------|----------------------------------|---------------------------|----------------------|
| Operator Robert C. Anderson | | | Lease Ute Mountain-AGA | | Well No. 3 |
| Well Letter P | Section 15 | Township 31N | Range 16W | County San Juan | |
| Actual Footage Location of Well: | | | | | |
| 790 | feet from the South | Line and | 790 | feet from the East | Line |
| Ground Level Elev. 5685 | Producing Formation Dakota | Pool Straight Canyon Dakota | Dedicated Acres: 40 | | Acres |

1. Outline the acreage dedicated to the subject well by colored pencil or hachure marks on the plat below.
2. If more than one lease is dedicated to the well, outline each and identify the ownership thereof (both as to working interest and royalty).
3. If more than one lease of different ownership is dedicated to the well, have the interests of all owners been consolidated by communitization, unitization, force-pooling, etc?

☐ Yes ☐ No If answer is "yes," type of consolidation _____

If answer is "no," list the owners and tract descriptions which have actually been consolidated. (Use reverse side of this form if necessary.) _____

No allowable will be assigned to the well until all interests have been consolidated (by communitization, unitization, forced-pooling, or otherwise) or until a non-standard unit, eliminating such interests, has been approved by the Commission.

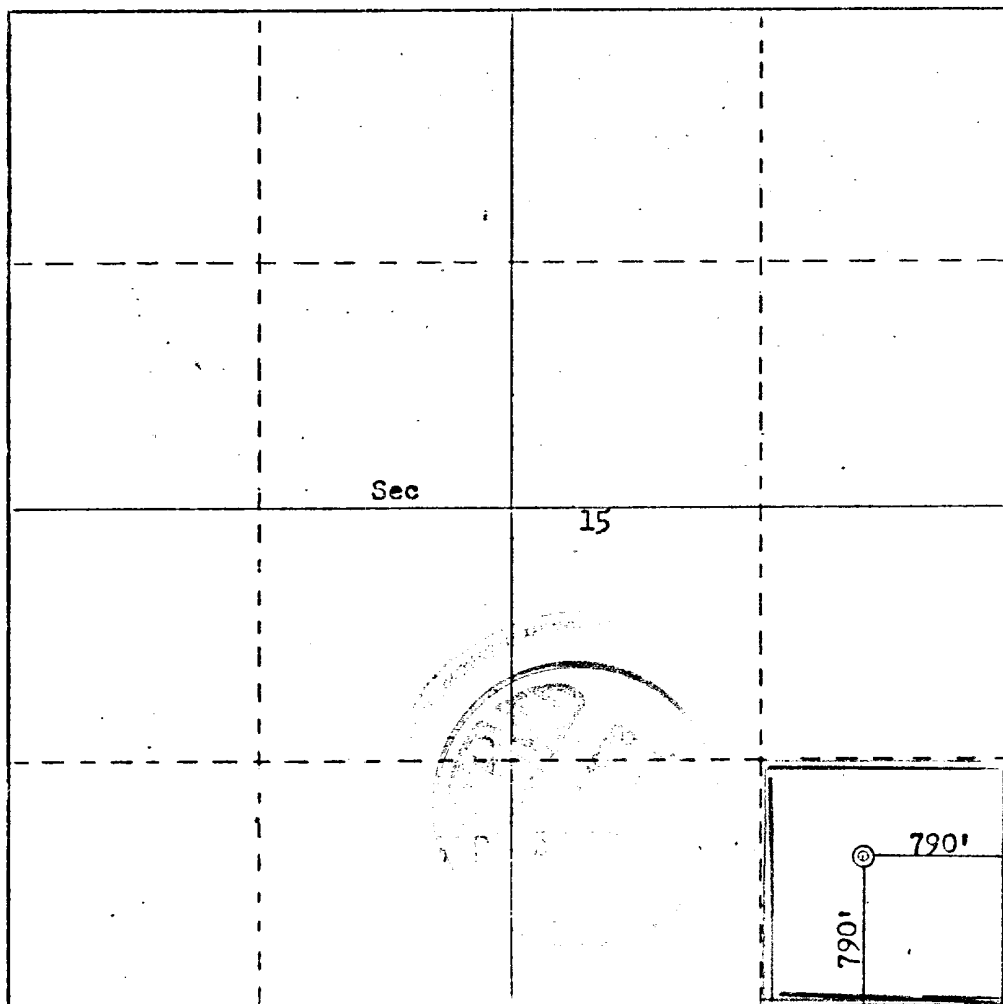

CERTIFICATION

I hereby certify that the information contained herein is true and complete to the best of my knowledge and belief.

Ashton B. Geren, Jr.
Name

Ashton B. Geren, Jr.

Position Agent for:
Robert C. Anderson

Company
Robert C. Anderson

Date
August 31, 1978

I hereby certify that the well location shown on this plat was plotted from field notes of actual surveys made by me or under my supervision, and that the same is true and correct to the best of my knowledge and belief.

Date Surveyed
August 16, 1978

Registered in the State of New Mexico
and of the County of _____

Fred B. Kerr, Jr.
Fred B. Kerr, Jr.

Certification No. **3950**

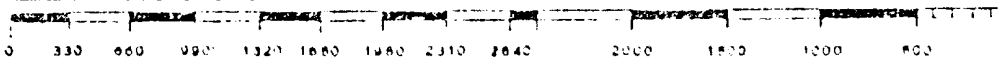

Robert C. Anderson
Ute Mtn.-AGA No. 3
SE SE Sec. 15 - T31N - R16W
San Juan Co., New Mexico

13-POINT SURFACE USE PLAN

1. The proposed location is approximately 15 miles in a northwesterly direction from the north exit from N.M. Hwy. 550 near Waterflow, N.M. A paved road runs north at this exit for approximately two or three miles to a point immediately south of the San Juan power plant. At this point, turn west on an existing dirt road and follow in a northwesterly direction for a distance of approximately eight to nine miles to a windmill designated Windmill No. A-11 as shown on U.S.G.S. Heifer Point-N.Mex.-Colo. topographic map. At this point turn to the left or southwesterly on an existing road and follow on an existing road approximately one half mile, then turn south east on the new access road a distance of approx. 1500 feet to the location.
2. The access road to the location will be approx. 1500 feet long, running southeast from the existing road. The tank battery, if required, will be constructed on the location near the well site.
3. The proposed location is 790' FSL - 790' FEL of Section 15, Township 31 North, Range 16 West in San Juan County, New Mexico. This is to be a proposed 2500' Dakota sand well, and all drilled formations will be tested as would any prudent operator. (See attached topo. map.)
4. No lateral roads from this location are planned other than the inspected route on to the Robert C. Anderson Chace-Ute well to be drilled in the NW NW of Sec. 23-T31N-R16W.
5. If well is a producer, tank battery will be constructed on existing well pad.
6. Fresh water will be trucked from the San Juan River approximately 15 miles to the south.
7. Waste disposal will be in the reserve pit and trash pit. A pit for cuttings while air drilling will be 15 to 20 feet southeast of the well site.
- 8&9. No camps or airstrips will be constructed.
10. A rig layout plat is attached.
11. The surface will be restored as near possible to the original condition, including grading the location and pits as soon as practical. Grass will be reseeded on the disturbed area of the location.
12. The terrain in the area is rather flat with very little native grass. Very little grading will be required for the well site and will not effect the natural drainage of the area.

Robert C. Anderson
Ute Mtn.-AGA No.3
SE SE Sec.15 - T31N - R16W
San Juan Co., New Mexico

12. Lessee's or operator's representative.

Ashton B. Geren, Jr.
P.O. Box 1469
Farmington, New Mexico 87401

Phone (505) 327-9483

13. I hereby certify that I, or persons under my direct supervision, have inspected the proposed drillsite and access route; that I am familiar with the conditions which presently exist; that the statements made in this plan are, to the best of my knowledge, true and correct; and, that the work associated with the operations proposed herein will be performed by Robert C. Anderson and its contractors and sub-contractors in conformity with this plan and the terms and conditions under which it is approved.

August 31, 1978
Date

Ashton B. Geren, Jr.
Ashton B. Geren, Jr. Agent & Petroleum
Name & Title Consultant for:
Robert C. Anderson

RESERVE

Plot

AREA

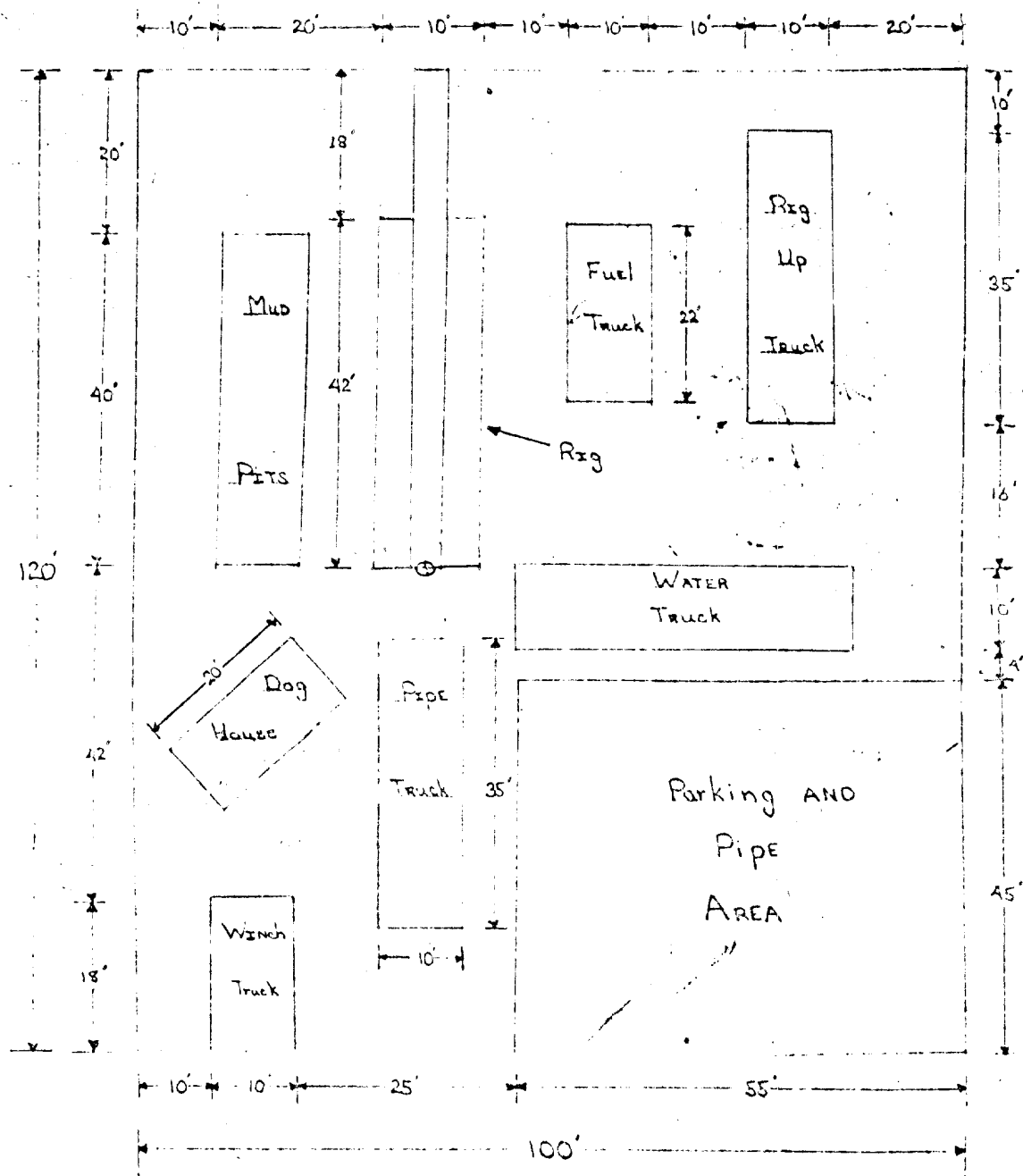

Scale: 1"=20'

LOCATION

Plot

For

Wilson Drilling Company D-10A

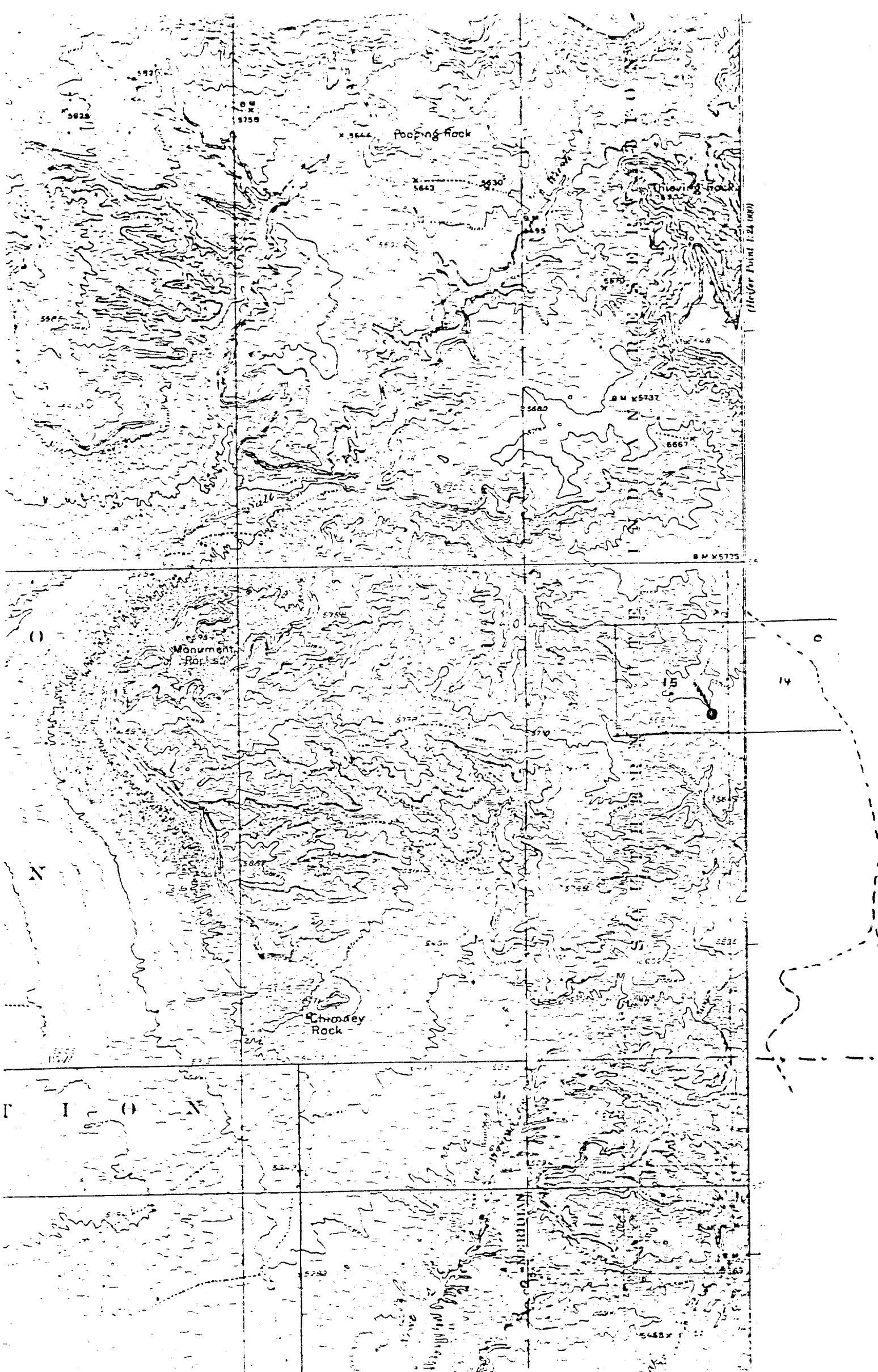

Vicinity Map for
ROBERT C. ANDERSON #3 UTE MOUNTAIN-AGA
790'FSL 790'FEL Sec 15-T31N-R16W
SAN JUAN COUNTY, NEW MEXICO