

UNITED STATES  
DEPARTMENT OF THE INTERIOR  
GEOLOGICAL SURVEY

## APPLICATION FOR PERMIT TO DRILL, DEEPEN, OR PLUG BACK

## 1a. TYPE OF WORK

DRILL ☒DEEPEN ☐PLUG BACK ☐

## b. TYPE OF WELL

OIL  
WELL ☐GAS  
WELL ☒

OTHER

SINGLE  
ZONE ☒MULTIPLE  
ZONE ☐

## 2. NAME OF OPERATOR

El Paso Natural Gas Company

## 3. ADDRESS OF OPERATOR

PO Box 289, Farmington, NM 87401

## 4. LOCATION OF WELL (Report location clearly and in accordance with any State requirements.)\*

At surface

1050'S, 800'E

At proposed prod. zone

same

## 14. DISTANCE IN MILES AND DIRECTION FROM NEAREST TOWN OR POST OFFICE\*

16 miles North of Kirtland, NM

## 15. DISTANCE FROM PROPOSED\*

LOCATION TO NEAREST  
PROPERTY OR LEASE LINE, FT.  
(Also to nearest drig. unit line, if any)

800'

## 16. NO. OF ACRES IN LEASE

1304.00

17. NO. OF ACRES ASSIGNED  
TO THIS WELL

320.00 ✓

18. DISTANCE FROM PROPOSED LOCATION\*  
TO NEAREST WELL, DRILLING, COMPLETED,  
OR APPLIED FOR, ON THIS LEASE, FT.

3000'

## 19. PROPOSED DEPTH

6285'

## 20. ROTARY OR CABLE TOOLS

Rotary

## 21. ELEVATIONS (Show whether DF, RT, GR, etc.)

5597'GR

## 22. APPROX. DATE WORK WILL START\*

## 23.

## PROPOSED CASING AND CEMENTING PROGRAM

SIZE OF HOLE	SIZE OF CASING	WEIGHT PER FOOT	SETTING DEPTH	QUANTITY OF CEMENT
12 1/4"	8 5/8"	24.0#	200'	165 cu.ft. to circulate
8 3/4" & 7 7/8"	4 1/2"	10.5# & 11.6#	6285'	1385 cu.ft. - 3 stages

1st stage - 320 cu.ft. to cover Gallup  
2nd stage - 482 cu.ft. to cover Mesa Verde  
3rd stage - 583 cu.ft. to circulate to surface.

Selectively perforate and sandwater fracture the Dakota formation.

A 3000 psi WP and 6000 psi test double gate preventer equipped with blind and pipe rams will be used for blow out prevention on this well.

This gas is dedicated.

The S/2 of Section 26 is dedicated to this well.

IN ABOVE SPACE DESCRIBE PROPOSED PROGRAM: If proposal is to deepen or plug back, give data on present productive zone and proposed productive zone. If proposal is to drill or deepen directionally, give pertinent data on subsurface locations and measured and true vertical depths. Give blowout preventer program, if any.

## 24.

SIGNED

*A. G. Busco*

TITLE

Drilling Clerk

DATE

11-15-78

(This space for Federal or State office use)

PERMIT NO.

APPROVAL DATE

APPROVED BY

TITLE

DATE

CONDITIONS OF APPROVAL, IF ANY:

*ok Frank*

\*See Instructions On Reverse Side

30-045-23285

5. LEASE DESIGNATION AND SERIAL NO.  
Ute Mt. MOO  
C-1420-0625

6. IF INDIAN, ALLOTTEE OR TRIBE NAME

7. UNIT AGREEMENT NAME

8. FARM OR LEASE NAME

Pinon Mesa B ✓

9. WELL NO.

3 ✓

10. FIELD AND POOL, OR WILDCAT

Basin Dakota ✓

11. SEC., T., R., M., OR BLK.  
AND SURVEY OR AREASec. 26, T-31-N, R-14-W  
NMPM

12. COUNTY OR PARISH

San Juan

13. STATE

NM

NEW MEXICO OIL CONSERVATION COMMISSION  
WELL LOCATION AND ACREAGE DEDICATION PLAT

Form C-102  
Supersedes C-128  
Effective 1-1-65

All distances must be from the outer boundaries of the Section.

Operator <b>EL PASO NATURAL GAS COMPANY</b>			Lease <b>PINON MESA "B"</b>		UTE MTN. # <b>M00</b> <b>C-1420-0625</b>	Well No. <b>3</b>
Unit Letter <b>P</b>	Section <b>26</b>	Township <b>31N</b>	Range <b>14W</b>	County <b>San Juan</b>		

Actual Footage Location of Well:

**1050** feet from the **South** line and **800** feet from the **East** line  
Ground Level Elev. **5597** Producing Formation **Dakota** Pool **Basin Dakota** Dedicated Acreage: **320.00** Acres

1. Outline the acreage dedicated to the subject well by colored pencil or hachure marks on the plat below.
2. If more than one lease is dedicated to the well, outline each and identify the ownership thereof (both as to working interest and royalty).
3. If more than one lease of different ownership is dedicated to the well, have the interests of all owners been consolidated by communitization, unitization, force-pooling, etc?

☐ Yes ☐ No If answer is "yes," type of consolidation \_\_\_\_\_

If answer is "no," list the owners and tract descriptions which have actually been consolidated. (Use reverse side of this form if necessary.) \_\_\_\_\_

No allowable will be assigned to the well until all interests have been consolidated (by communitization, unitization, forced-pooling, or otherwise) or until a non-standard unit, eliminating such interests, has been approved by the Commission.

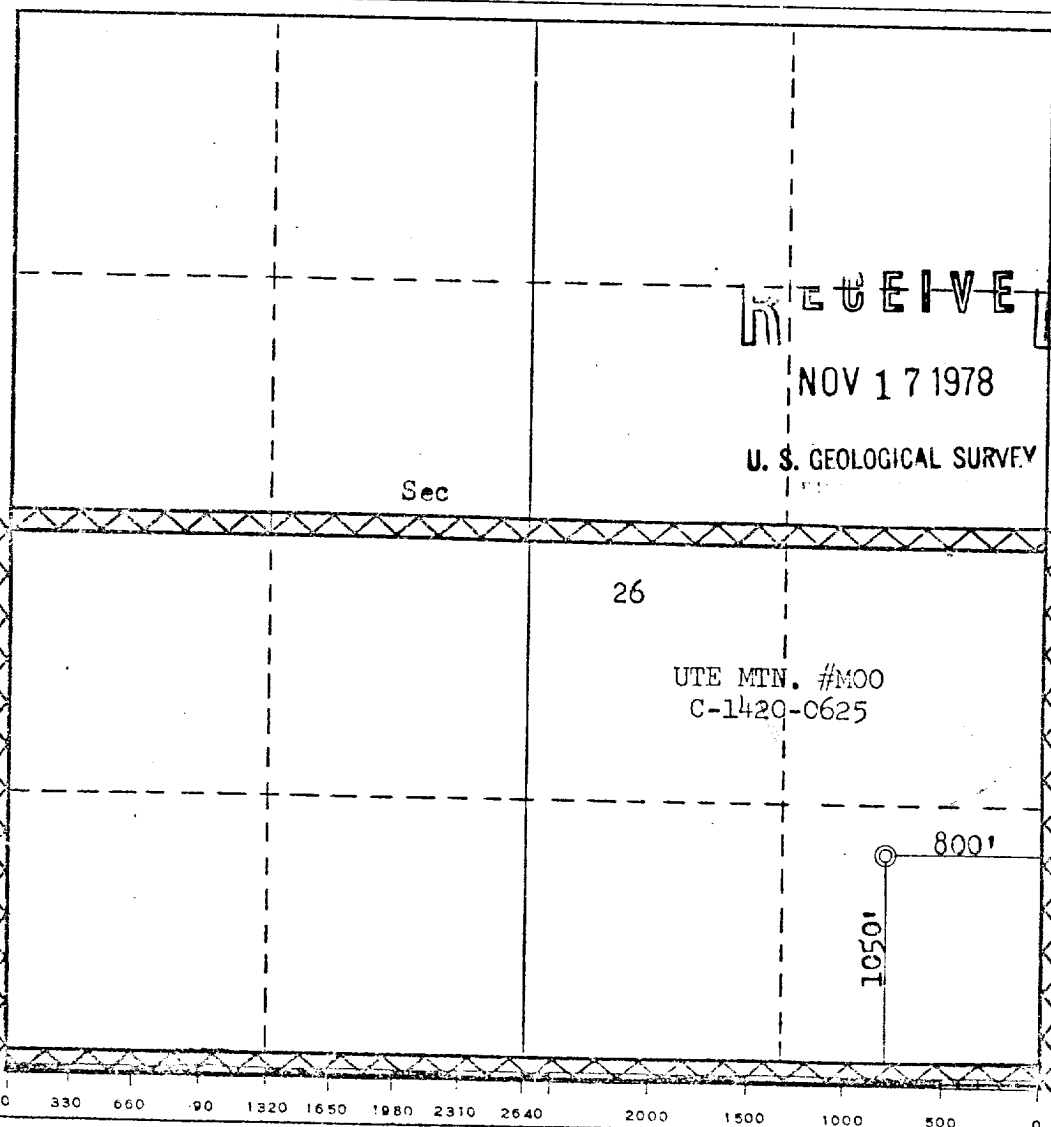

CERTIFICATION

I hereby certify that the information contained herein is true and complete to the best of my knowledge and belief.

*A. G. Quisenberry*

Name  
Position  
Company  
Date

**Drilling Clerk**  
**El Paso Natural Gas Co.**  
**November 15, 1978**

I hereby certify that the well location shown on this plat was plotted from field notes of actual surveys made by me or under my supervision, and that the same is true and correct to the best of my knowledge and belief.

Date Surveyed  
**October 11, 1978**  
Registered Professional Engineer and/or Land Surveyor  
*Fred R. Kern Jr.*  
Certificate No. **3950** **KERN, JR.**

Multi-Point Surface Use Plan  
Pinon Mesa B #3

1. Existing Road - Please refer to Map No. 1 which shows the existing roads. New roads which will be required have been marked on this map. All existing and new roads will be properly maintained during the duration of this project.
2. Planned Access Roads - Please refer to Map No. 1. The grade of the access roads will be consistent with that of the local terrain. The road surface will not exceed twenty feet (20') in width. Upon completion of the project, the access road will be adequately drained to control soil erosion. Drainage facilities may include ditches, water bars, culverts or any other measure deemed necessary by trained Company personnel to insure proper drainage. Gates and/or cattleguards will be installed if necessary.
3. Location of Existing Wells - Please refer to Map No. 2.
4. Location of Tank Batteries, Production Facilities, and Production Gathering and Service Lines - Please refer to Maps No. 1 and No. 2. Map No. 2 shows the existing gas gathering lines. Map No. 1 shows the existing roads and new proposed access roads. All known production facilities are shown on these two maps.
5. Location and Type of Water Supply - Water for the proposed project will be obtained from San Juan River Plant.
6. Source of Construction Materials - No additional materials will be required to build either the access road or the proposed location.
7. Methods of Handling Waste Materials - All garbage and trash materials will be put into a burn pit shown on the attached Location Plat No. 1. When clean-up operations are begun on the proposed project, the burn pit with its refuse will be buried to a depth of at least three feet (3'). A latrine, the location of which is also shown on Plat No. 1,

RECEIVED

NOV 17 1978

U. S. GEOLOGICAL SURVEY

7. cont'd. will be provided for human waste. If large amounts of liquids are left in the reserve pit after completion of the project, the pit will be fenced until the liquids have had adequate time to dry. The location clean-up will not take place until such time as the reserve pit can be properly covered over to prevent run-off from carrying any of these materials into the watershed. No earthen pit will be located on natural drainages; all earthen pits will be so constructed as to prevent leakage from occurring.
8. Ancillary Facilities - No camps or airstrips will be associated with this project.
9. Wellsite Layout - Please refer to the attached Plat No. 1.
10. Plans for Restoration of the Surface - After completion of the proposed project, the location will be cleaned and leveled. The location will be left in such a condition that will enable reseeding operations to be carried out. Seed mixture as designated by the responsible government agency will be used. The reseeding operation will be performed during the time period set forth by the regulatory body. The location production equipment will be painted as designated by the responsible government agency.
11. Other Information - The terrain is rolling hills and sagebrush flats with sagebrush and cedar growing. Cattle graze the proposed project site.
12. Operator's Representative - W.D. Dawson, PO Box 990, Farmington, NM
13. Certification - I hereby certify that I, or persons under my direct supervision, have inspected the proposed drillsite and access route; that I am familiar with the conditions which presently exist; that the statements made in this plan are, to the best of my knowledge, true and correct; and that the work associated with the operations proposed herein will be performed by El Paso Natural Gas Company and its contractors and sub-contractors in conformity with this plan and the terms and conditions under which it is approved.

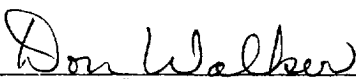
  
D. C. Walker  
Project Drilling Engineer

RECEIVED

NOV 17 1978

U. S. GEOLOGICAL SURVEY

November 15, 1978

Operations Plan - Pinon Mesa B #3

I. Location: 1050'S, 800'E, Section 26, T-31-N, R-14-W, San Juan County, NM

Field: Basin Dakota

Elevation: 5597'GR

II. Geology:

A. Formation Tops:	Surface	Farmington	Menefee	3130'
	Ojo Alamo	----	Point Lookout	3820'
	Kirtland	----	Gallup	5160'
	Fruitland	974'	Greenhorn	5939'
	Pic.Cliffs	1354'	Graneros	6007'
	Lewis	1500'	Dakota	6170'
	Mesa Verde	3010'	Total Depth	6285'

B. Logging Program: Induction Electric and Gamma Ray Density at TD.

C. Coring: none

D. Samples: none

III. Drilling:

A. Mud Program: mud from surface to Total Depth.

IV. Materials:

A. Casing Program:	<u>Hole Size</u>	<u>Depth</u>	<u>Csg.Size</u>	<u>Wt.&amp;Grade</u>
	12 1/4"	200'	8 5/8"	24.0# J-55
	7 7/8"	6285'	4 1/2"	10.5# J-55

B. Float Equipment: 8 5/8" surface casing - Pathfinder guide shoe (Part #2006-1-010)

4 1/2" production casing - Howco guide shoe (Prod. No. 102-1) and self-fill insert valve (Prod. No. 177-13). Two Howco multiple stage cementers (Prod. No.200-03) equipped for three stage cementing. Set tool for second stage at 4420' and tool for third stage at 1600'. Run 20 Howco centralizers (Prod. No. 200-03) spaced as follows: one on each of the bottom 8 joints, one below each stage tool and five above each stage tool spaced every other joint.

C. Tubing: 6285' of 2 3/8", 4.7#, J-55 tubing with a common pump seating nipple and an expendable check valve with drill type guide.

D. Wellhead Equipment: 8" 2000 x 8 5/8" Gray casing head with a 8" 2000 x 6" 2000 Gray xmas tree. Wellhead representative to set slip.

RECEIVED

NOV 17 1978

U. S. GEOLOGICAL SURVEY

Operations Plan - Pinon Mesa B #3

V. Cementing:

Surface casing (12 1/4" x 8 5/8") - use 140 sks. of Class "B" cement with 1/4# gel-flake per sack and 3% calcium chloride (163 cu.ft. of slurry, 100% excess to circulate). WOC 12 hours. Test to 600#/30 min.

Production casing -

First stage (4 1/2" x 7 7/8") - use 216 sks. of 65/35 Class "B" Pozmix with 6% gel and 2% calcium chloride mixed with 8.3 gallons water per sack followed by 75 sks. 50/50 Class "B" Pozmix with 2% gel, 2% calcium chloride and 1/4# fine tuf-plug per cu.ft. (320 cu.ft. of slurry, 25% excess to cover the Gallup).

Second stage (4 1/2" x 7 7/8") - circulate mud for 2 hours, then cement with 297 sks. of 65/35 Class "B" Pozmix with 6% gel and 2% calcium chloride and 8.3 gallons of water per sack (482 cu.ft. of slurry, 50% excess to cover the Mesa Verde).

Third stage (4 1/2" x 7 7/8") - circulate mud for 2 hours, then cement using 360 sks. 65/35 Class "B" Pozmix with 6% gel and 2% calcium chloride mixed with 8.3 gallons water per sack (583 cu.ft. of slurry, 60% excess to circulate to surface).

RECEIVED

NOV 17 1978

U. S. GEOLOGICAL SURVEY

*Pinar Mesa L#3*

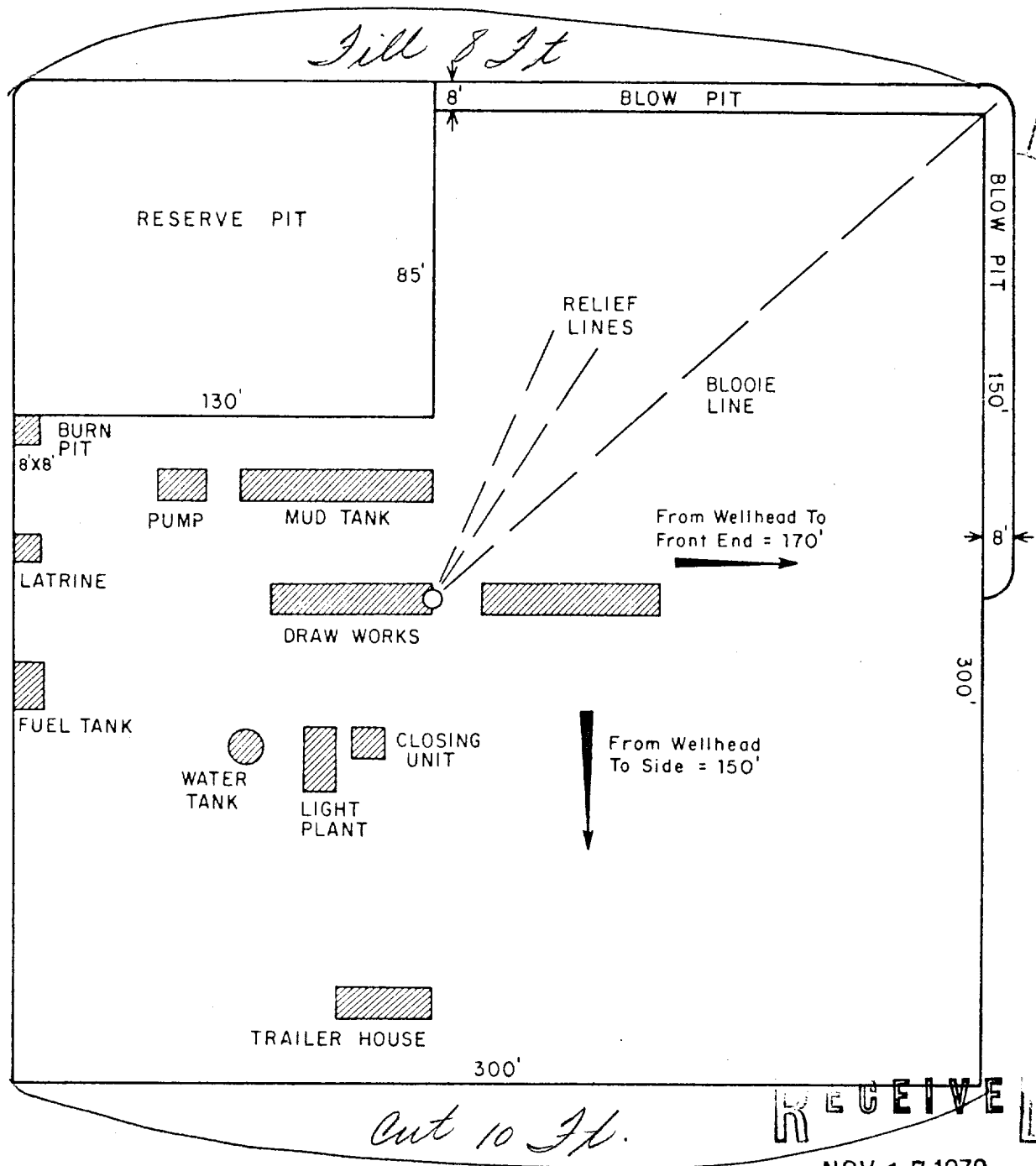

**RECEIVED**

NOV 17 1978

U. S. GEOLOGICAL SURVEY

**e** El Paso Natural Gas Company

TYPICAL LOCATION PLAT FOR  
MESAVERDE OR DAKOTA DRILL SITE

SCALE: 1" = 50'

DWG.  
NO.

REV.

ENG. REC.

DATE

DRAWN J.L.H. 8-16-78

CHECKED

CHECKED

PROJ. APP.

DESIGN

W.O.

PRINT RECORD

PRT. SEP. DATE TO W.O.

Typical B.O.P. Installation  
for Dakota Well

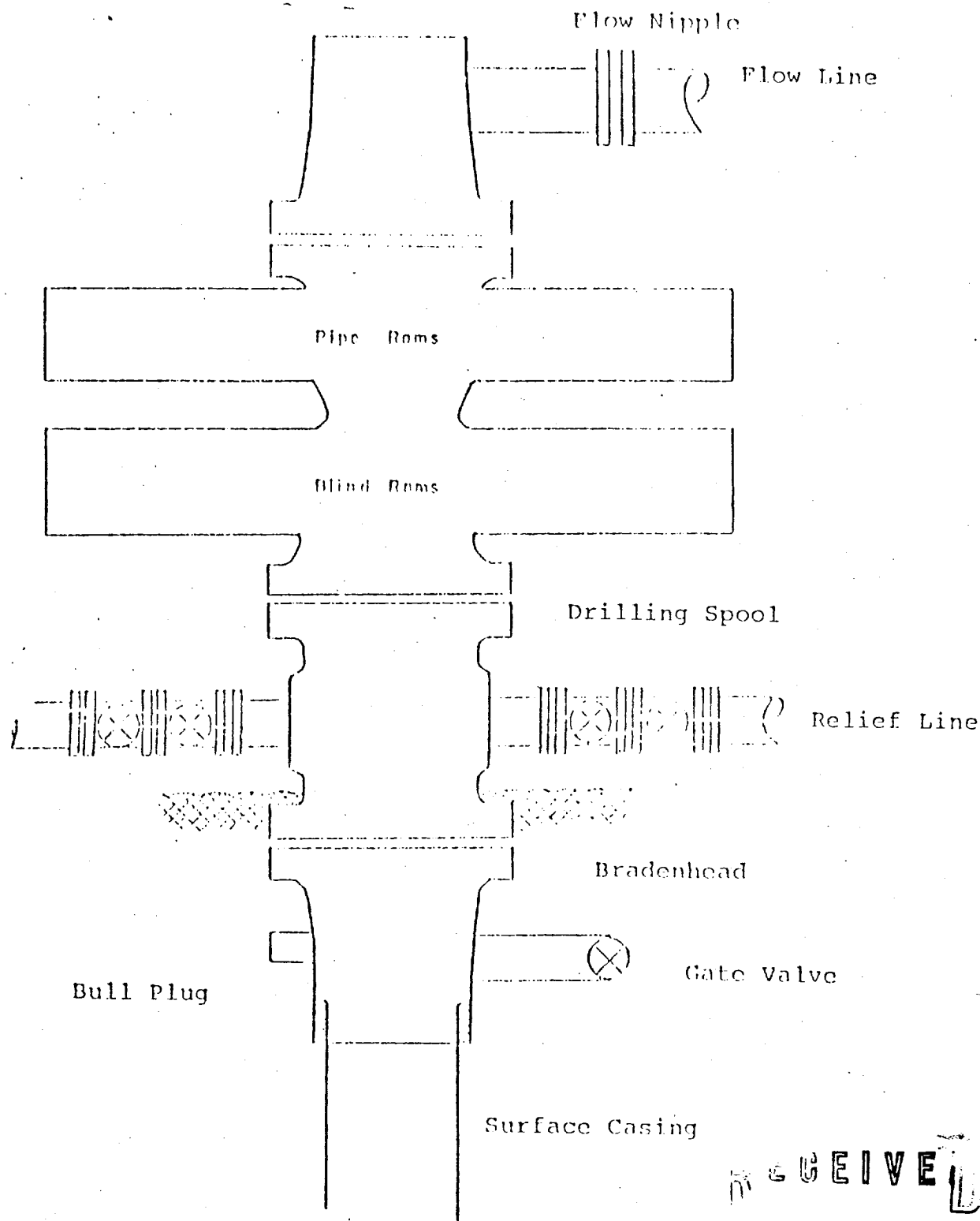

Series 900 Double Gate BOP, rated  
at 3000 psi Working Pressure

When gas drilling operations begin a Shaffer type  
50 or equivalent rotating head is installed on top of  
the flow nipple and the flow line is converted into  
a blowie line.

RECEIVED

NOV 17 1978

U. S. GEOLOGICAL SURVEY



EL PASO NATURAL GAS COMPANY

Pinon Mesa R #3

SE 26-31-14

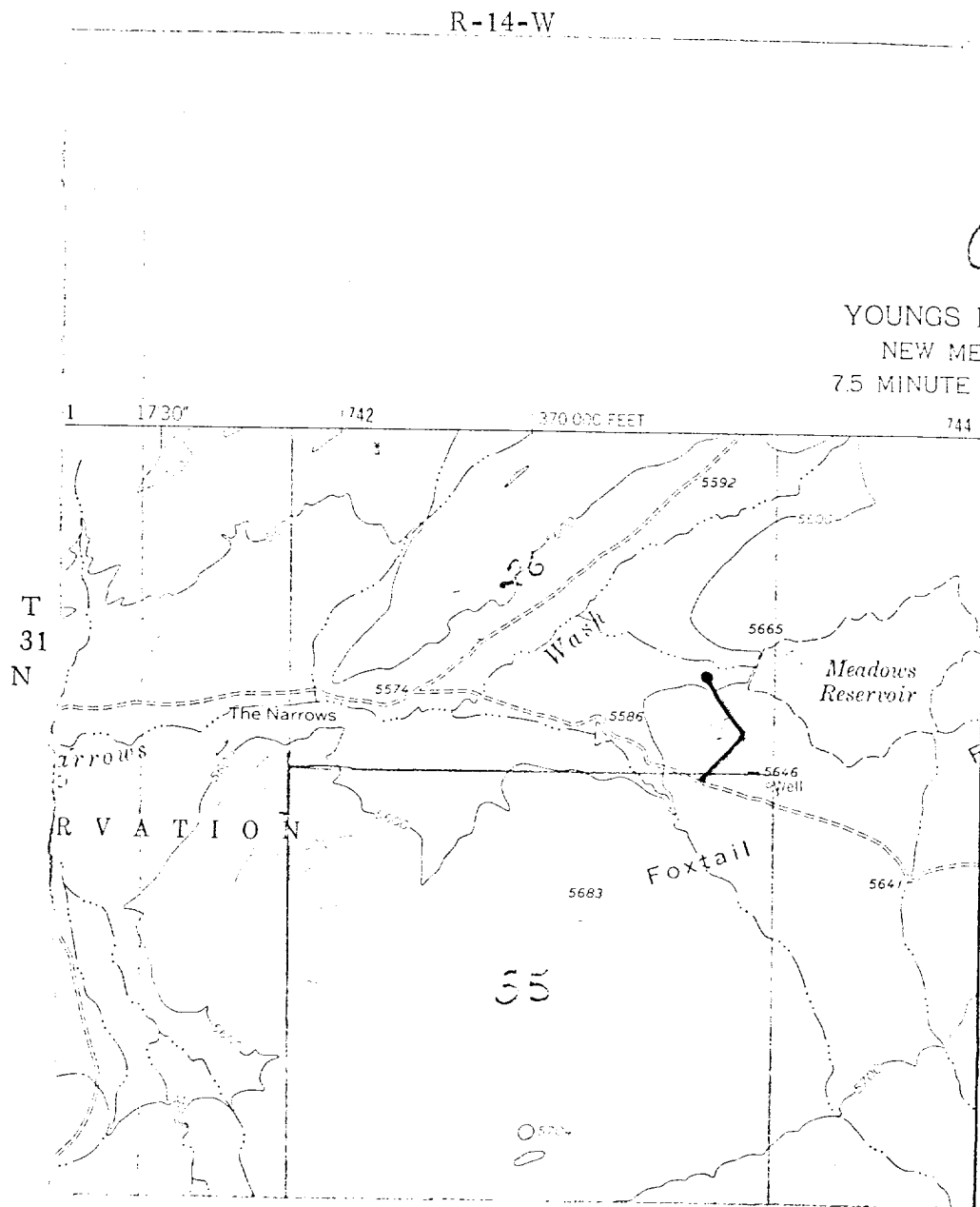

MAP #1

RECEIVED

NOV 17 1978

U. S. GEOLOGICAL SURVEY

LEGEND OF RIGHT-OF-WAYS

EXISTING ROADS	— — — — —
EXISTING PIPELINES	+ + +
EXISTING ROAD & PIPELINE	+ — + — +
PROPOSED ROADS	— — — — —
PROPOSED PIPELINES	+ + +
PROPOSED ROAD & PIPELINE	+ — + — +

## SE 26-31-14

P-14-W

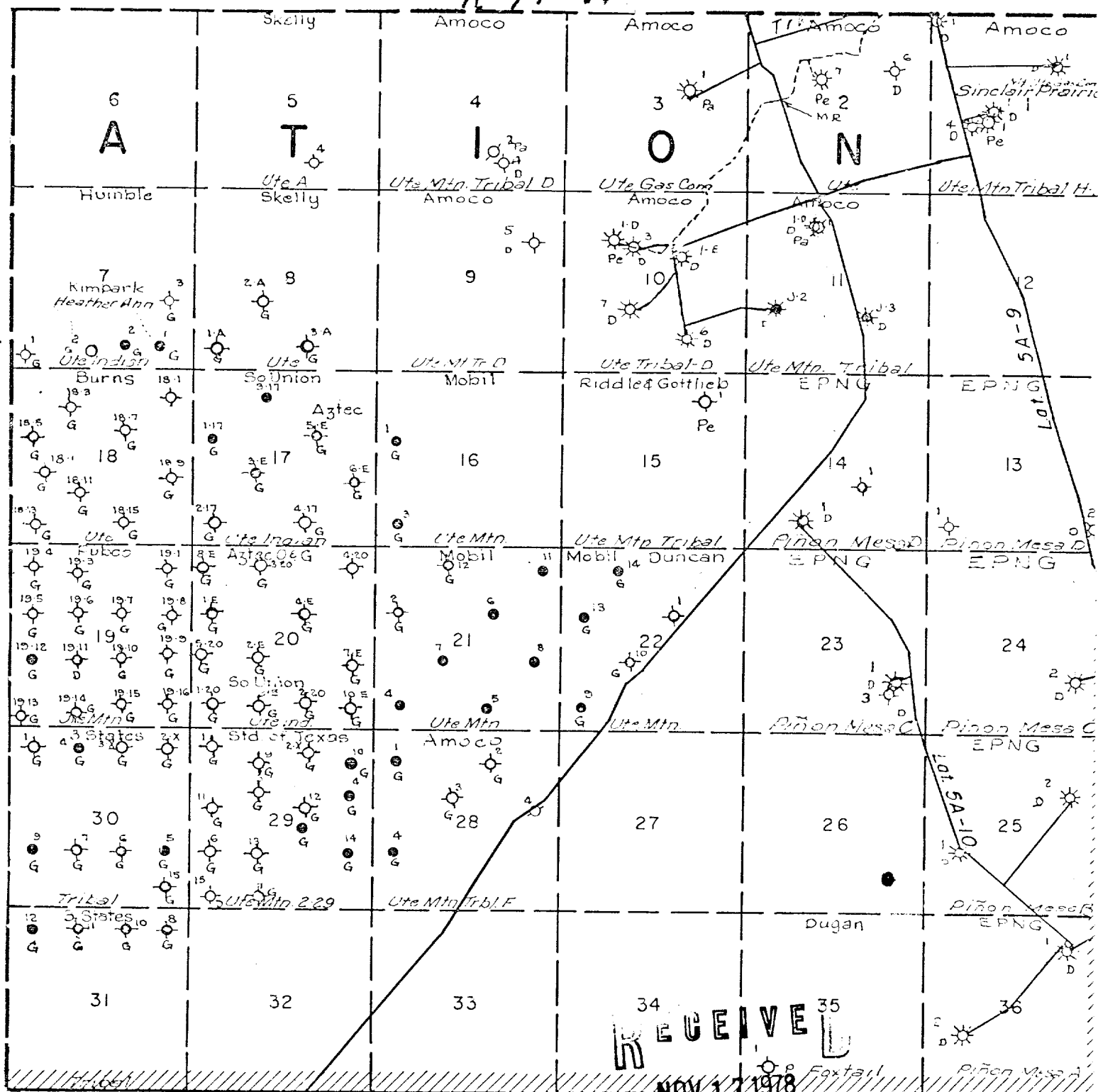

34 **RECEIVED** 35

~~NOV 17 1978~~

Map #2

Proposed Location

U. S. GEOLOGICAL SURVEY