

NEW MEXICO OIL CONSERVATION COMMISSION

NO. OF COPIES RECEIVED	4
DISTRIBUTION	
SANTA FE	
FILE	
U.S.G.S.	
LAND OFFICE	
OPERATOR	

5a. Indicate Type of Lease	
State <input checked="" type="checkbox"/>	Fee <input type="checkbox"/>
5. State Oil & Gas Lease No.	

SUNDRY NOTICES AND REPORTS ON WELLS
(DO NOT USE THIS FORM FOR PROPOSALS TO DRILL OR TO DEEPEN OR PLUG BACK TO A DIFFERENT RESERVOIR.
USE "APPLICATION FOR PERMIT -" (FORM C-101) FOR SUCH PROPOSALS.)

1. OIL WELL <input type="checkbox"/> GAS WELL <input checked="" type="checkbox"/> OTHER- 2. Name of Operator Southland Royalty Company 3. Address of Operator P. O. Drawer 570, Farmington, New Mexico 87401 4. Location of Well UNIT LETTER <u>H A</u> <u>1090'</u> FEET FROM THE <u>North</u> LINE AND <u>840'</u> FEET FROM <u>East</u> THE <u>23</u> LINE, SECTION <u>31N</u> TOWNSHIP <u>12W</u> RANGE <u>NMPM.</u>	7. Unit Agreement Name 8. Farm or Lease Name Hedges 9. Well No. #3 10. Field and Pool, or Wildcat <u>EXT</u> Aztec Pictured Cliffs 15. Elevation (Show whether DF, RT, GR, etc.) <u>6185</u> 6170 GR 12. County San Juan
---	---

Check Appropriate Box To Indicate Nature of Notice, Report or Other Data
NOTICE OF INTENTION TO:

PERFORM REMEDIAL WORK <input type="checkbox"/>	PLUG AND ABANDON <input type="checkbox"/>
TEMPORARILY ABANDON <input type="checkbox"/>	CHANGE PLANS <input type="checkbox"/>
PULL OR ALTER CASING <input type="checkbox"/>	OTHER <input type="checkbox"/>

SUBSEQUENT REPORT OF:

REMEDIAL WORK <input type="checkbox"/>	ALTERING CASING <input type="checkbox"/>
COMMENCE DRILLING OPNS. <input type="checkbox"/>	PLUG AND ABANDONMENT <input type="checkbox"/>
CASING TEST AND CEMENT JOB <input type="checkbox"/>	OTHER <u>Location change</u> <input checked="" type="checkbox"/>

17. Describe Proposed or Completed Operations (Clearly state all pertinent details, and give pertinent dates, including estimated date of starting any proposed work) SEE RULE 1103.

For geological reasons the proposed well location has been changed
to 1090' FNL & 840' FEL.



18. I hereby certify that the information above is true and complete to the best of my knowledge and belief.

SIGNED <u>[Signature]</u>	TITLE <u>District Production Manager</u>	DATE <u>2-13-79</u>
APPROVED BY <u>[Signature]</u>	TITLE <u>SUPERVISOR DIST. #3</u>	DATE <u>FEB 15 1979</u>
CONDITIONS OF APPROVAL, IF ANY:		

**NEW MEXICO OIL CONSERVATION COMMISSION
WELL LOCATION AND ACREAGE DEDICATION PLAT**

Form C-102
Supersedes C-128
Effective 1-1-65

All distances must be from the outer boundaries of the Section.

Operator SOUTHLAND ROYALTY COMPANY			Lease HEDGES		Well No. 3
Unit Letter A	Section 23	Township 31N	Range 12W	County San Juan	
Actual Footage Location of Well: 1090 feet from the North line and 840 feet from the East line					
Ground Level Elev. 6185	Producing Formation Pictured Cliffs		Pool		Dedicated Acreage: 160 Acres

1. Outline the acreage dedicated to the subject well by colored pencil or hachure marks on the plat below.
2. If more than one lease is dedicated to the well, outline each and identify the ownership thereof (both as to working interest and royalty).
3. If more than one lease of different ownership is dedicated to the well, have the interests of all owners been consolidated by communitization, unitization, force-pooling, etc?

☐ Yes ☐ No If answer is "yes," type of consolidation _____

If answer is "no," list the owners and tract descriptions which have actually been consolidated. (Use reverse side of this form if necessary.) _____

No allowable will be assigned to the well until all interests have been consolidated (by communitization, unitization, forced-pooling, or otherwise) or until a non-standard unit, eliminating such interests, has been approved by the Commission.

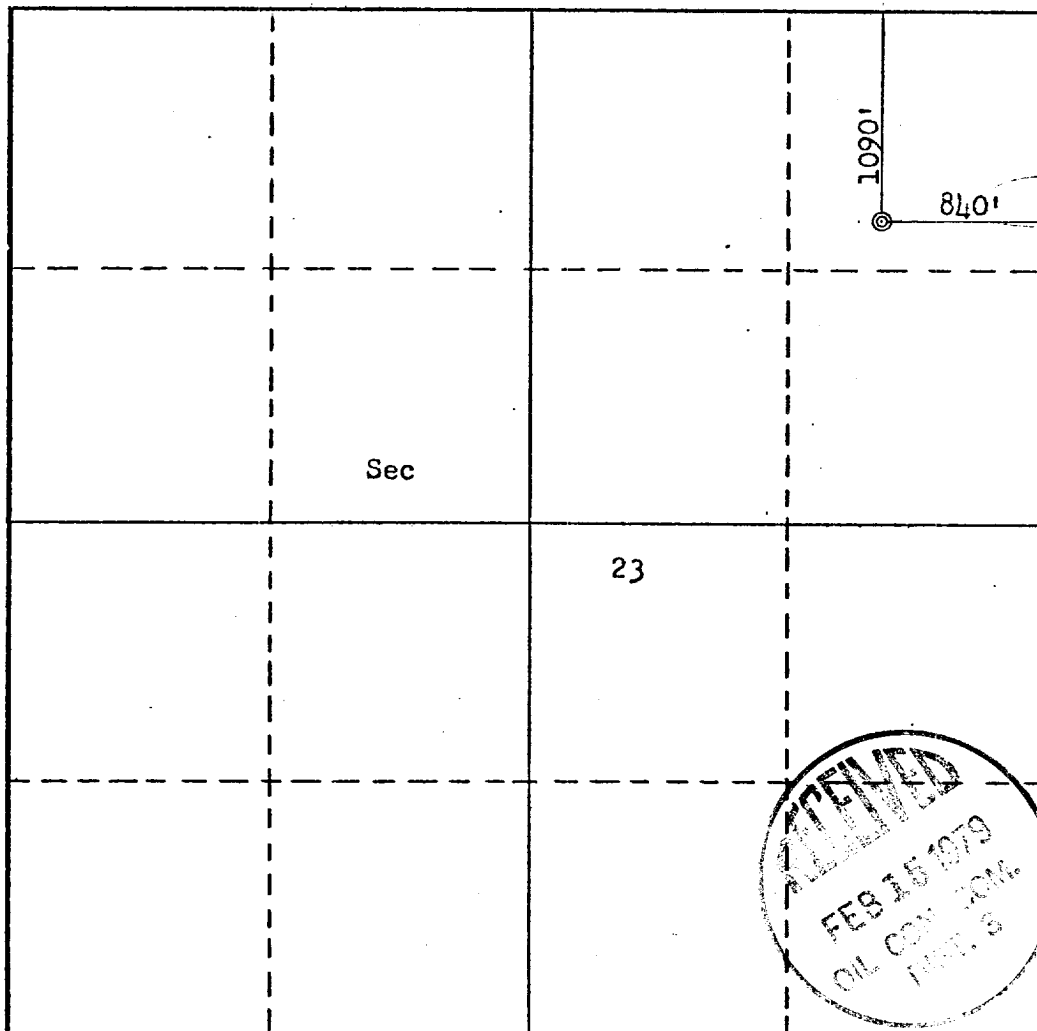

CERTIFICATION

I hereby certify that the information contained herein is true and complete to the best of my knowledge and belief.

Name
District Production Manager
 Position
Southland Royalty Company
 Company
2-13-79
 Date

I hereby certify that the well location shown on this plat was plotted from field notes of actual surveys made by me or under my supervision, and that the same is true and correct to the best of my knowledge and belief.

Date Surveyed
February 13, 1979
 Registered Professional Engineer and/or Land Surveyor
Fred R. Kerr Jr.
 Certificate No.
3950

