

State of New Mexico
Energy, Minerals and Natural Resources Department

OIL CONSERVATION DIVISION

P.O. Box 2088
Santa Fe, New Mexico 87504-2088



PIT REMEDIATION AND CLOSURE REPORT

Operator: Burlington Resources (Williams Field Services) Telephone: (801) 584-6361
Address: P.O. Box 58900, Salt Lake City, Utah 84158-0900
WellName: Rattlesnake Canyon #1A MV (85239)
Location: Unit or Qtr/Qtr Sec ✓ Sec 32 T 32N R 8W County San Juan
PitType Dehydrator
LandType Fee

Pit Location: Pit dimensions: length 15 ft., width 16 ft., depth 12 ft.
(Attach diagram)

Reference: Wellhead

Footage from reference: 100 ft.

Direction from reference: 45 Degrees West of South

Depth To Ground Water:	Less than 50 feet	(20 points)	
(Vertical distance from	50 feet to 99 feet	(10 points)	
contaminants to seasonal	Greater than 100 feet	(0 points)	<u>0</u>
high water elevation of			
ground water)			

Wellhead Protection Area:	Yes	(20 points)	
(Less than 200 feet from a private	No	(0 points)	<u>0</u>
domestic water source, or; less than			
1000 feet from all other water sources)			

Distance To Surface Water:	Less than 200 feet	(20 points)	
(Horizontal distance to perennial	200 feet to 1,000 feet	(10 points)	
lakes, ponds, rivers, streams, creeks,	Greater than 1,000 feet	(0 points)	<u>0</u>
irrigation canals and ditches)			

Ranking Score (TOTAL POINTS): 0

Date Remediation Started: 9/13/99

Date Completed: 9/21/99

Remediation Method: Excavation ☒
(check all appropriate sections)

Approx. Cubic Yard 107

Landfarmed ☒

Insitu Bioremediation

Other Landfarmed soil after mechanical aeration. LF Headspace 0 ppm.

Remediation Location: Onsite ☒ Offsite(ie. landfarmed onsite,
name and location of
offsite facility)

General Description Of Remedial Action:

The pit was excavated to remove gross petroleum contamination. The excavated material was mechanically aerated and placed into an onsite landfarm.

Ground Water Encountered: No

Final Pit:

Sample location RSC1A-V-EXFL-01

Closure Sampling:

(if multiple samples, attach
sample results and diagram
of sample locations and
depths)

Two samples were collected, one sample from the excavation bottom and the second sample was made up of 4 points from each excavation wall.

Sample depth 12 feet

Sample date 9/14/99

Sample time 9:20

Sample Result

Benzene (ppm) <0.05

Total BTEX (ppm) <0.05

Field Headspace (ppm)

TPH (ppm) <2.0

Ground Water Sample: No

I HEREBY CERTIFY THAT THE INFORMATION ABOVE IS TRUE AND COMPLETE TO
THE BEST OF MY KNOWLEDGE AND BELIEF

DATE 12-20-99

SIGNATURE  For WFR

PRINTED NAME Mark Harvey for Williams Field Services
AND TITLE

PIT RETIREMENT FORM

85239

Date: 9/13/99 Weather CLR, HOT
 Well Name RATTLESNAKE CANYON #1A Operator BURLINGTON Sec 32 T 32N R 8W UL
 Land Type: BLM STATE FEE INDIAN County SAN JUAN
 One Call Made (505-765-1234)? (Y) N
 Line Marking Evident? 1800 321 2337 (Y) N

Pit Location:

Reference Wellhead X Other _____
 Distance from: 100'
 Direction: 45 Degrees _____ E _____ N
 _____ of _____
X W X S

Starting Pit Dimensions 15 x 15 x 3
 Final Pit Dimensions 15 x 16 x 12

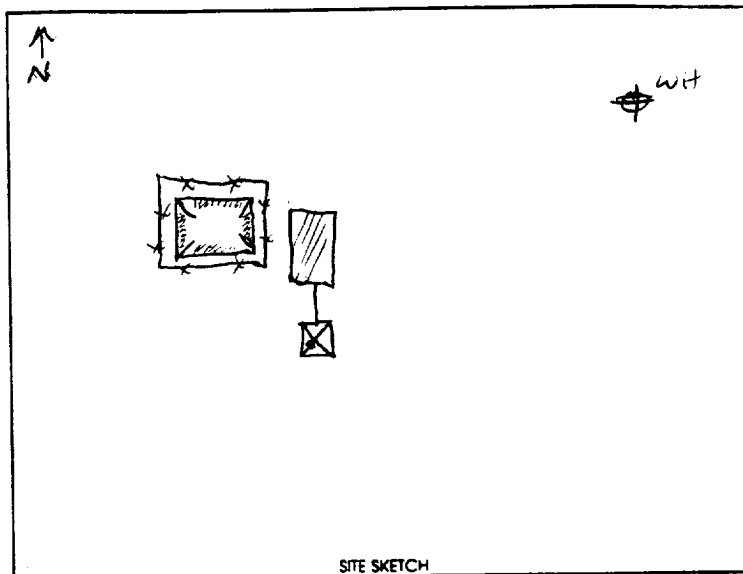

Organic Vapor Readings: Start N/A Soil Description: _____
 @ 2' () 0-12 BRN CLAYEY SILT - SILTY CLAY
 @ 4' () ↑ FINES (CLAY) w/ DEPTH
 @ 6' () 12'+ BRN SILTY CLAY - CLAYSTONE
 @ 8' ()
 @ _____
 @ _____

Well Proximity To: Residence, Domestic Water Well, Stock Well NONE
 Arroyo, Wash, Lake, Stream >1000'
 Estimated or Known Distance to Ground Water >100'

Source of Backfill (if other than processed material) _____

Samples collected: Type _____ Progress: Verification: ID RSC1A-V-EXWA-01 (soil) / water
 Progress: Verification: ID RSC1A-V-EXFL-01 (soil) / water
 Progress: Verification: ID _____ soil / water

Sample sent to Lab Via: Courier Hand Carried _____ Other _____ Preservative: ICE Other _____

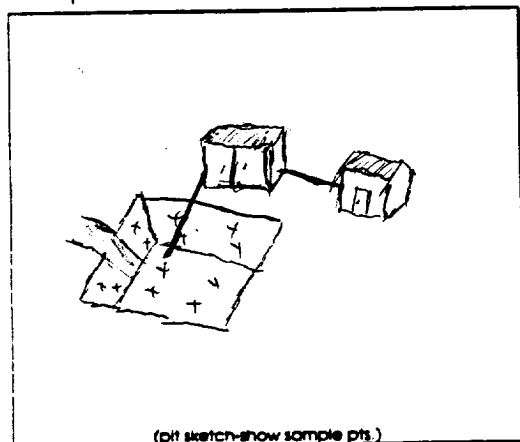

Comments: WFS (FRANCIS RUTH) BLOW DOWN LINES,
DISCONNECT STEAM VENT + DISCHARGE LINES. PULL
FENCE. EXCAVATE IMPACTED SOIL - STRONG
GLYCOL OIL. SHRED EXCAVATED MATERIAL.

Soil Shipped to: ON-SITE LANDFARM
 Prepared by: JPS

Q W A L L A B O R A T O R I E S , I N C .

2911 ROTARY TERRACE, P.O. BOX 562/PITTSBURG, KS 66762/(316)232-1970

LABORATORY REPORT:

REFERENCE #: 9909635

SENT **WILLIAMS FIELD SERVICE**
 TO: **295 CHIPETA WAY**
SALT LAKE CITY, UTAH 84158
MARK HARVEY

DATE REPORTED: 11/08/99
 DATE COLLECTED: **09/14/99**
 DATE RECEIVED: **09/17/99**

PROJECT: WFS/NM-PITS

Reference Fraction: 9909635-07A

Sample ID: RSC1A-V-EXFL-01

Sample Matrix: SOIL

Sample Date Collected: 09/14/99 09:20:00

TEST	METHOD	RESULT	UNITS	PQL	ANALYZED	BY
TPH-DRO	SW846-8015D	ND	MG/KG	2	09/23/99	BEM
BTEX	OA1/8021B			3.0		
BENZENE		ND	MG/KG	0.050	09/20/99	KKL
TOLUENE		ND	MG/KG	0.050	09/20/99	KKL
ETHYLBENZENE		ND	MG/KG	0.050	09/20/99	KKL
TOTAL XYLENES		ND	MG/KG	0.050	09/20/99	KKL
BFB (SURROGATE)		90	125	75		
QA/QC PACKAGE LEVEL	NONE	DONE	SU			

ND=NONE DETECTED

PQL=PRACTICAL QUANTITATION LIMIT

SU=STANDARD UNITS

B=DETECTED IN METHOD BLANK

APPROVED BY: _____

 TERRY KOESTER
 LABORATORY DIRECTOR

Q W A L L A B O R A T O R I E S, I N C.

2911 ROTARY TERRACE, P.O. BOX 562/PITTSBURG, KS 66762/(316)232-1970

LABORATORY REPORT:

REFERENCE #: 9909635

SENT **WILLIAMS FIELD SERVICE**
 TO: **295 CHIPETA WAY**
SALT LAKE CITY, UTAH 84158
MARK HARVEY

DATE REPORTED: 11/08/99
 DATE COLLECTED: 09/14/99
 DATE RECEIVED: 09/17/99

PROJECT: WFS/NM-PITS

Reference Fraction:9909635-08A

Sample ID: RSC1A-V-EXWA-01

Sample Matrix: SOIL

Sample Date Collected: 09/14/9909:25:00

TEST	METHOD	RESULT	UNITS	PQL	ANALYZED	BY
TPH-DRO	SW846-8015D	ND	MG/KG	2	09/23/99	BEM
BTEX	OA1/8021B			3.0		
BENZENE		ND	MG/KG	0.050	09/20/99	KKL
TOLUENE		ND	MG/KG	0.050	09/20/99	KKL
ETHYLBENZENE		ND	MG/KG	0.050	09/20/99	KKL
TOTAL XYLENES		ND	MG/KG	0.050	09/20/99	KKL
BFB (SURROGATE)		89	125	75		
QA/QC PACKAGE LEVEL	NONE	DONE	SU			

ND=NONE DETECTED
 PQL=PRACTICAL QUANTITAION LIMIT
 SU=STANDARD UNITS
 B=DETECTED IN METHOD BLANK

APPROVED BY: _____

TERRY KOESTER
 LABORATORY DIRECTOR

Q W A L L A B O R A T O R I E S , I N C .

2911 ROTARY TERRACE, P.O. BOX 562/PITTSBURG, KS 66762/(316)232-1970

LABORATORY REPORT:

REFERENCE #: 9909783

SENT WILLIAMS FIELD SERVICE
TO: 295 CHIPETA WAY
SALT LAKE CITY, UTAH 84158
MARK HARVEY
PROJECT: WFS/IGN-NM PITS

DATE REPORTED: 09/29/99
DATE COLLECTED: 09/21/99
DATE RECEIVED: 09/23/99

Reference Fraction: 9909783-27A
Sample ID: RSC#1A-V-LF-01
Sample Date Collected: 09/21/99 07:35:00

Sample Matrix: SOIL

TEST	METHOD	RESULT	UNITS	PQL	ANALYZED	BY
QA/QC PACKAGE LEVEL	NONE		SU			
TOTAL PETROLEUM HYDR	EPA 418.1	ND	MG/KG	10.0	09/27/99	BEM

ND=NONE DETECTED

PQL=PRACTICAL QUANTITATION LIMIT

SU=STANDARD UNITS

B=DETECTED IN METHOD BLANK

APPROVED BY:

TERRY KOESTER
LABORATORY DIRECTOR