

NO. OF COPIES RECEIVED	7
DISTRIBUTION	
SANTA FE	1
FILE	2
U.S.G.S.	1
LAND OFFICE	1
OPERATOR	2

# NEW MEXICO OIL CONSERVATION COMMISSION

30-045-23413  
Form C-101  
Revised 1-4-65

5A. Indicate Type of Lease STATE <input checked="" type="checkbox"/> FEE <input type="checkbox"/>	
5. State Oil & Gas Lease No. K5808	
7. Unit Agreement Name	
8. Farm or Lease Name Albino Canyon	
9. Well No. #2	
10. Field, Pool, or Wildcat Undesignated Pictured Cliffs	
12. County San Juan	
19. Proposed Depth 4043'	19A. Formation Pictured Cliffs
20. Rotary or C.T. Rotary	
21. Elevations (Show whether DF, RT, etc.) 6956' GR	21A. Kind & Status Plug. Bond
21B. Drilling Contractor	
22. Approx. Date Work will start June 1, 1979	

1a. Type of Work DRILL <input checked="" type="checkbox"/> DEEPEN <input type="checkbox"/> PLUG BACK <input type="checkbox"/>	
b. Type of Well OIL WELL <input type="checkbox"/> GAS WELL <input checked="" type="checkbox"/> OTHER <input type="checkbox"/>	
2. Name of Operator Southland Royalty Company	
3. Address of Operator P. O. Drawer 570, Farmington, New Mexico	
4. Location of Well UNIT LETTER L LOCATED 1610 FEET FROM THE South LINE AND 790 FEET FROM THE West LINE OF SEC. 36 TWP. 32N RGE. 8W NMPM	
23. PROPOSED CASING AND CEMENT PROGRAM	

SIZE OF HOLE	SIZE OF CASING	WEIGHT PER FOOT	SETTING DEPTH	SACKS OF CEMENT	EST. TOP
12-1/4"	8-5/8"	24#	140'	118 cu. ft.	Circ to surface
6-3/4"	2-7/8"	6.5#	4043'	387 cu. ft.	Cover Ojo Alamo

Surface formation is San Jose.  
Top of Ojo Alamo sand is at 2788'.  
Fresh water mud will be used to drill from surface to total depth.  
It is anticipated that an IES and a GR-Density log will be run at total depth.  
No poisonous gases or abnormal pressures are anticipated in this well.  
It is expected that this well will be drilled before September 1, 1979. This depends on time required for approvals, rig availability and the weather.  
Gas is dedicated.

APPROVAL VALID  
FOR 90 DAYS  
DURING WHICH TIME  
6-7-79

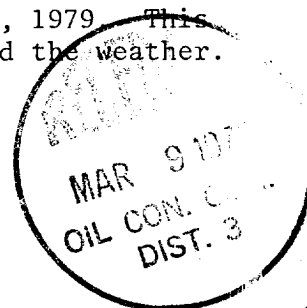

IN ABOVE SPACE DESCRIBE PROPOSED PROGRAM: IF PROPOSAL IS TO DEEPEN OR PLUG BACK, GIVE DATA ON PRESENT PRODUCTIVE ZONE AND PROPOSED NEW PRODUCTIVE ZONE. GIVE BLOWOUT PREVENTER PROGRAM, IF ANY.

I hereby certify that the information above is true and complete to the best of my knowledge and belief.

Signed [Signature] Title District Production Manager Date March 1, 1979

(This space for State Use)

APPROVED BY [Signature] TITLE DEPUTY OIL & GAS INSPECTOR, DIST. #3 DATE MAR 9 1979  
CONDITIONS OF APPROVAL, IF ANY:

**NEW MEXICO OIL CONSERVATION COMMISSION  
WELL LOCATION AND ACREAGE DEDICATION PLAT**

Form C-102  
Supersedes C-128  
Effective 1-1-65

All distances must be from the outer boundaries of the Section.

Operator <b>SOUTHLAND ROYALTY COMPANY</b>			Lease <b>ALBINO CANYON</b>		Well No. <b>2</b>
Unit Letter <b>L</b>	Section <b>36</b>	Township <b>32N</b>	Range <b>8W</b>	County <b>San Juan</b>	
Actual Footage Location of Well: <b>1610</b> feet from the <b>South</b> line and <b>790</b> feet from the <b>West</b> line					
Ground Level Elev. <b>6956</b>	Producing Formation <b>Pictured Cliffs</b>	Pool <b><del>Undesignated</del> Albino ext</b>		Dedicated Acreage: <b>160</b> Acres	

1. Outline the acreage dedicated to the subject well by colored pencil or hachure marks on the plat below.
2. If more than one lease is dedicated to the well, outline each and identify the ownership thereof (both as to working interest and royalty).
3. If more than one lease of different ownership is dedicated to the well, have the interests of all owners been consolidated by communitization, unitization, force-pooling, etc?

☐ Yes    ☐ No    If answer is "yes," type of consolidation \_\_\_\_\_

If answer is "no," list the owners and tract descriptions which have actually been consolidated. (Use reverse side of this form if necessary.) \_\_\_\_\_

No allowable will be assigned to the well until all interests have been consolidated (by communitization, unitization, forced-pooling, or otherwise) or until a non-standard unit, eliminating such interests, has been approved by the Commission.

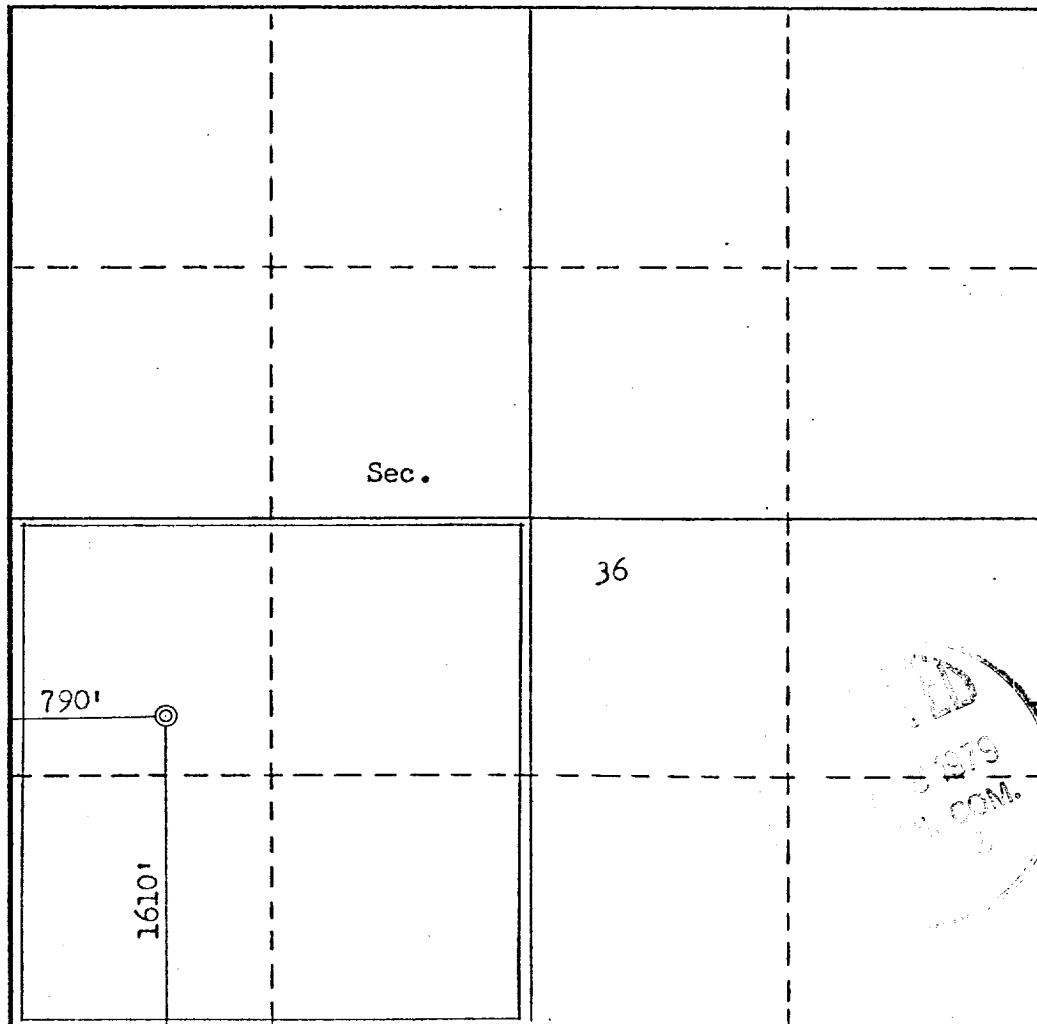

**CERTIFICATION**

*I hereby certify that the information contained herein is true and complete to the best of my knowledge and belief.*

Name \_\_\_\_\_  
 Position  
**District Production Manager**  
 Company  
**Southland Royalty Company**  
 Date  
**March 1, 1979**

*I hereby certify that the well location shown on this plat was plotted from field notes of actual surveys made by me or under my supervision, and that the same is true and correct to the best of my knowledge and belief.*

Date Surveyed  
**February 8, 1979**  
 Registered Professional Engineer and/or Land Surveyor  
**Fred B. Kerr Jr.**  
 Certificate No. **23453**  
 2050



**Southland Royalty Company**

March 1, 1979

Oil Conservation Division  
1000 Rio Brazos Road  
Aztec, New Mexico 87410

Attention: Mr. Al Kendrick

Re: Blowout Preventer Plan

Dear Sir:

All drilling and completion rigs will be equipped with 8" or larger double gate hydraulic blowout preventers and a hydraulic operated closing unit with steel lines.

The preventer is 3000# working pressure and 6000# test.

All crews will be thoroughly trained in the operation of this preventer. The preventer will be tested frequently enough to insure proper operation.

Yours truly,

L. O. Van Ryan  
District Production Manager

LOVR/dg