

UNITED STATES
DEPARTMENT OF THE INTERIOR
GEOLOGICAL SURVEY

APPLICATION FOR PERMIT TO DRILL, DEEPEN, OR PLUG BACK

1a. TYPE OF WORK
DRILL ☒ DEEPEN ☐ PLUG BACK ☐

b. TYPE OF WELL
OIL WELL ☐ GAS WELL ☒ OTHER ☐ SINGLE ZONE ☒ MULTIPLE ZONE ☐

2. NAME OF OPERATOR
Southland Royalty Company

3. ADDRESS OF OPERATOR
P. O. Drawer 570, Farmington, New Mexico

4. LOCATION OF WELL (Report location clearly and in accordance with any State requirements.)*
At surface

1840' FNL & 1110' FWL

At proposed prod. zone

14. DISTANCE IN MILES AND DIRECTION FROM NEAREST TOWN OR POST OFFICE*

6 miles northwest of Aztec, New Mexico

15. DISTANCE FROM PROPOSED*
LOCATION TO NEAREST
PROPERTY OR LEASE LINE, FT.
(Also to nearest drig. unit line, if any)

18. DISTANCE FROM PROPOSED LOCATION*
TO NEAREST WELL, DRILLING, COMPLETED,
OR APPLIED FOR, ON THIS LEASE, FT.

16. NO. OF ACRES IN LEASE

19. PROPOSED DEPTH

3029'

17. NO. OF ACRES ASSIGNED
TO THIS WELL

158.50

20. ROTARY OR CABLE TOOLS

Rotary

21. ELEVATIONS (Show whether DF, RT, GR, etc.)

6307' GR

22. APPROX. DATE WORK WILL START*

June 1, 1979

23. PROPOSED CASING AND CEMENTING PROGRAM

SIZE OF HOLE	SIZE OF CASING	WEIGHT PER FOOT	SETTING DEPTH	QUANTITY OF CEMENT
12-1/4"	8-5/8"	24#	135'	195 cu. ft.
8-3/4"	2-7/8"	6.5#	3029'	421 cu. ft.

Surface formation is Nacimiento.

Top of Ojo Alamo sand is at 1649'.

Fresh water mud will be used to drill from surface to total depth.

It is anticipated that an IES and a GR-Density log will be run at total depth.

It is expected that this well will be drilled before September 1, 1979. This

depends on time required for approvals, rig availability and the weather.

No abnormal pressures or poisonous gases are anticipated in this well.

Gas is dedicated.

IN ABOVE SPACE DESCRIBE PROPOSED PROGRAM: If proposal is to deepen or plug back, give data on present productive zone and proposed new productive zone. If proposal is to drill or deepen directionally, give pertinent data on subsurface locations and measured and true vertical depths. Give blowout preventer program, if any.

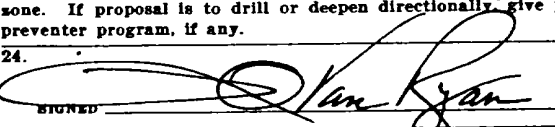
24. 

TITLE District Production Manager DATE April 30, 1979

(This space for Federal or State office use)

PERMIT NO. _____ APPROVAL DATE _____

APPROVED BY _____ TITLE _____ DATE _____

CONDITIONS OF APPROVAL, IF ANY:

*See Instructions On Reverse Side

30-045-235345
5. LEASE DESIGNATION AND SERIAL NO.
SF-077648
6. IF INDIAN, ALLOTTEE OR TRIBE NAME
7. UNIT AGREEMENT NAME
8. FARM OR LEASE NAME
Davis
9. WELL NO.
#19
10. FIELD AND POOL, OR WILDCAT
Blanco Pictured Cliffs
11. SEC., T., R., M., OR BLK.
AND SURVEY OR AREA
Section 1, T31N, R12W
12. COUNTY OR PARISH
San Juan
13. STATE
New Mexico

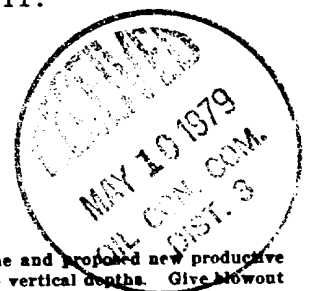

**NEW MEXICO OIL CONSERVATION COMMISSION
WELL LOCATION AND ACREAGE DEDICATION PLAT**

Form C-102
Supersedes C-128
Effective 1-1-65

All distances must be from the outer boundaries of the Section.

Operator SOUTHLAND ROYALTY COMPANY			Lease DAVIS		Well No. 19
Unit Letter E	Section 1	Township 31N	Range 12W	County SAN JUAN	
Actual Footage Location of Well: 1840 feet from the North line and 1110 feet from the West line					
Ground Level Elev. 6307	Producing Formation Pictured Cliffs	Pool Blanco <i>ext</i>		Dedicated Acreage 158.50 Acres	

1. Outline the acreage dedicated to the subject well by colored pencil or hachure marks on the plat below.
2. If more than one lease is dedicated to the well, outline each and identify the ownership thereof (both as to working interest and royalty).
3. If more than one lease of different ownership is dedicated to the well, have the interests of all owners been consolidated by communitization, unitization, force-pooling, etc?

☐ Yes ☐ No If answer is "yes," type of consolidation _____

If answer is "no," list the owners and tract descriptions which have actually been consolidated. (Use reverse side of this form if necessary.) _____

No allowable will be assigned to the well until all interests have been consolidated (by communitization, unitization, forced-pooling, or otherwise) or until a non-standard unit, eliminating such interests, has been approved by the Commission.

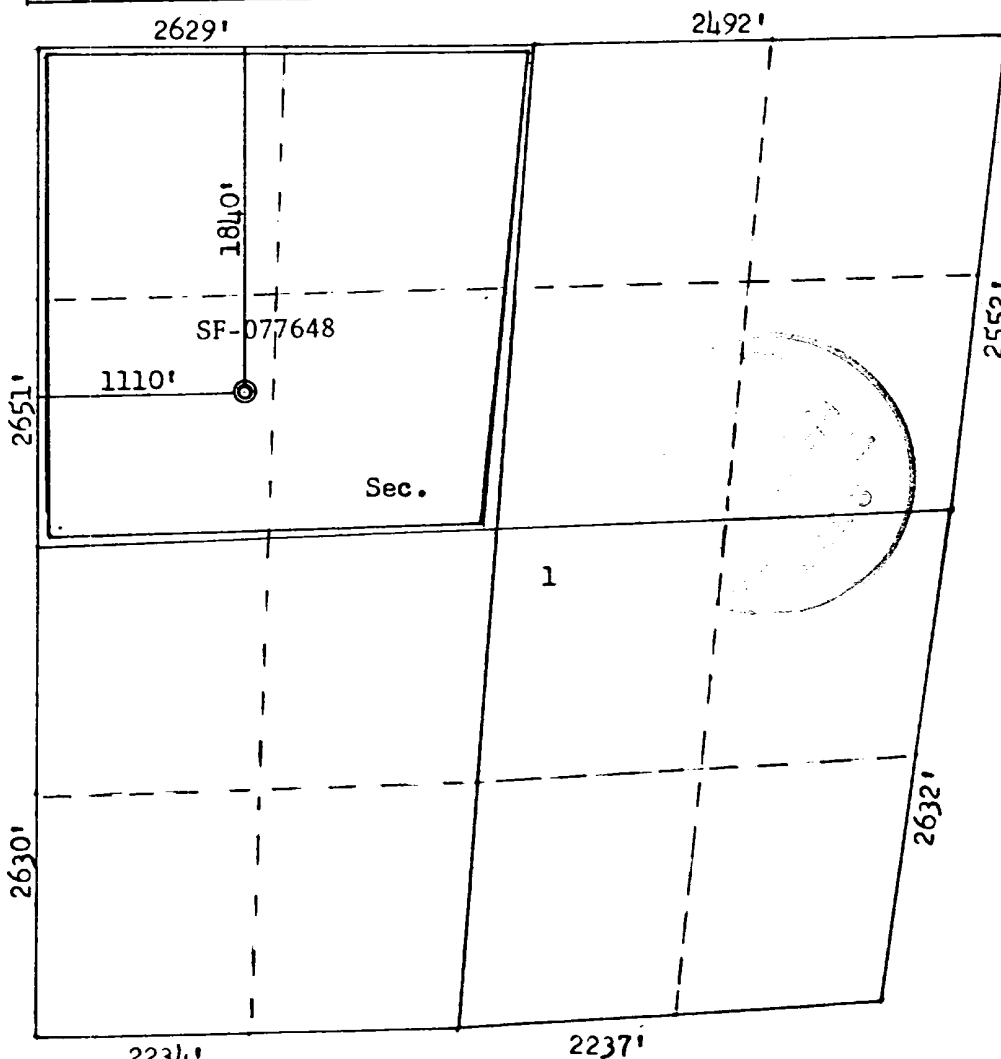

CERTIFICATION

I hereby certify that the information contained herein is true and complete to the best of my knowledge and belief.

Name _____
 Position _____
District Production Manager
 Company _____
Southland Royalty Company
 Date _____
April 30, 1979

I hereby certify that the well location shown on this plat was plotted from field notes of actual surveys made by me or under my supervision, and that the same is true and correct to the best of my knowledge and belief.

Date Surveyed _____
April 9, 1979
 Registered Professional Engineer and Land Surveyor
Fred B. Kerr, Jr.
Fred B. Kerr, Jr.
 Certificate No. **3950**

DRILLING SCHEDULE - DAVIS #19

Location: 1840' FNL & 1110' FWL, Sec. 1, T31N, R12W, San Juan County, New Mexico

Field Blanco Pictured Cliffs

Elevation: 6307' GR

Geology:

Formation Tops:	Ojo Alamo	1649'
	Fruitland	2384'
	Pictured Cliffs	2859'
	Total depth	3029'

Logging Program: IES and GR-Density at total depth.

Coring Program : None

Natural Gauges : None

Drilling

Contractor:	Tool Pusher:
	SRC Answering Service: 325-1841
SRC Representative:	Dispatch Number: 325-7391

Mud Program: Fresh water mud from surface to total depth.

Materials

Casing Program:	Hole Size	Depth	Casing Size	Wt. & Grade	
	12-1/4"	135'	8-5/8"	24#	K-55
	6-3/4"	3029'	2-7/8"	6.5#	K-55

Float Equipment

8-5/8" Surface Casing: Pathfinder cement guide shoe (#1003-1-010).

2-7/8" Production Casing: Notched collar guide shoe. Howco 2 7/8" latch down baffle (Pr. Ref. 60). Two 3 1/16" rubber balls and one 2 7/8" Omega latching plug (Pr. Ref. 59). Use 3 1/4" plug container head. Six (6) B & W stabilizers on bottom 6 joints.

Wellhead Equipment: 8 5/8" X 2 7/8", EUE, screwed head.

DRILLING SCHEDULE - DAVIS #19

Cementing

8-5/8" Surface Casing: 195 cu. ft. (165 sxs) Class "B" with 1/4# gel flake per sx and 3% CaCl₂. (100% excess)

2-7/8" Production Casing: 421 cu. ft. (243 sxs) of 50/50 Class "B" Poz with 6% gel mixed with 7.2 gals water per sx to weigh 12.85 ppg. Tail in with 50 sxs Class "B" with 2% CaCl₂. If lost circulation occurs add 1/4 cu. ft. fine gilsonite per sack. (50% excess to cover Ojo Alamo) Displace cement with 50 gals of 7 1/2% acetic acid. Run temperature survey after 12 hours.



Southland Royalty Company

United States Geological Survey
P. O. Box 959
Farmington, New Mexico 87401

Attention: Mr. P. T. McGrath

Dear Sir:

I hereby certify that I, or persons under my direct supervision, have inspected the proposed drillsite and access route; that I am familiar with the conditions which presently exist; that the statements made in this plan are, to the best of my knowledge, true and correct; and, that the work associated with the operations proposed herein be performed by Southland Royalty Company and its contractors and subcontractors in conformity with this plan and the terms and conditions under which it is approved.

Date: April 30, 1979

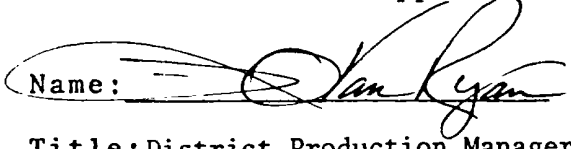
Name: 

Title: District Production Manager



Southland Royalty Company

April 30, 1979

United States Geological Survey
P. O. Box 959
Farmington, New Mexico 87410

Attention: Mr. P. T. McGrath

Dear Sir:

Enclosed please find a map showing existing roads and planned access roads to Southland Royalty Company's Davis #19 well. The locations of tank batteries and flow lines will be on location with well. A burn pit will be provided for disposal of trash. Cuttings, drilling fluid and produced fluids will be put into the reserve pit and properly disposed of depending on amount and type of fluids.

There will be no camps or air strips.

Also, enclosed is a location layout showing approximate location of rig, pits and pipe racks.

Water supply will be Farmer's Ditch.

The location will be restored to the land owner's satisfaction. If this is not satisfactory, please have the Bureau of Land Management contact the land owner. This work will begin when all related construction is finished.

Mr. Max Larson will be Southland Royalty Company's field representative supervising these operations.

Yours truly,

L. O. Van Ryan
District Production Manager

LOVR/dg



Southland Royalty Company

April 30, 1979

United States Geological Survey
P. O. Box 959
Farmington, New Mexico

Attention: Mr. Phil McGrath

Re: Davis #19

Dear Sir:

We intend to rehabilitate damaged area to land owners wishes;
however, the land owner has not specified exact restoration at this
time.

If this is not acceptable, please have the Bureau of Land Manage-
ment contact the land owner.

Yours truly,

L. O. Van Ryan
District Production Manager

LOVR/dg

Attachment



Southland Royalty Company

April 30, 1979

United States Geological Survey
P. O. Box 959
Farmington, New Mexico

Attention: Mr. P. T. McGrath

Re: Blowout Preventer Plan

Dear Sir:

All drilling and completion rigs will be equipped with 8" or larger double gate hydraulic blowout preventers and a hydraulic operated closing unit with steel lines.

The preventer is 3000# working pressure and 6000# test.

All crews will be thoroughly trained in the operation of this preventer. The preventer will be tested frequently enough to insure proper operation.

Yours truly,

L. O. Van Ryan
District Production Manager

LOVR/dg

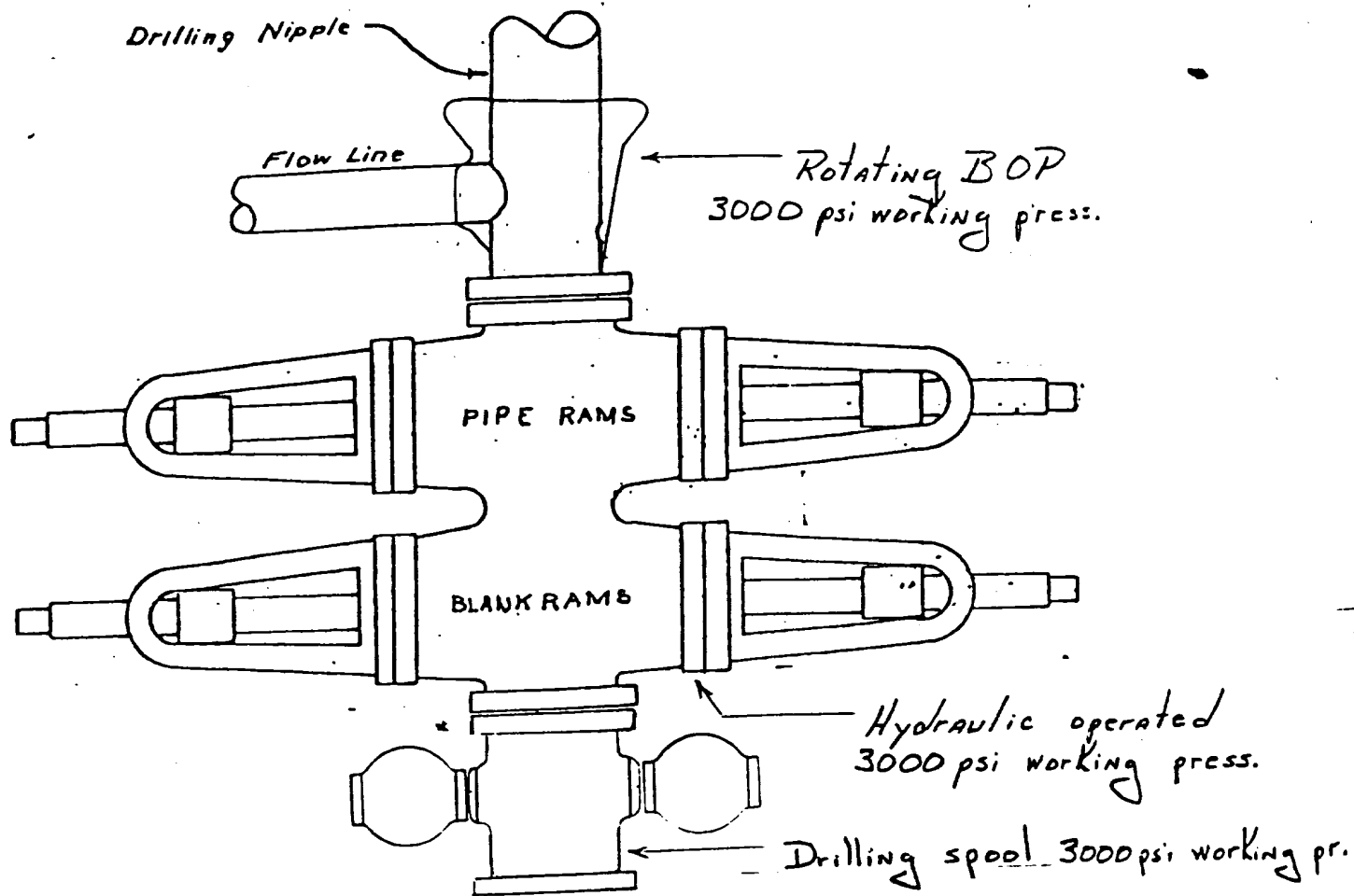

Preventers and spools are to have
through bore of 8" - 3000# PSI or larger.

LOCATION FROILLS FOR
 SOUTHLAND ROYALTY COMPANY #19 DAVIS
 1840' FNL 1110' FWL Sec 1-T31N-R12W
 SAN JUAN COUNTY, NEW MEXICO

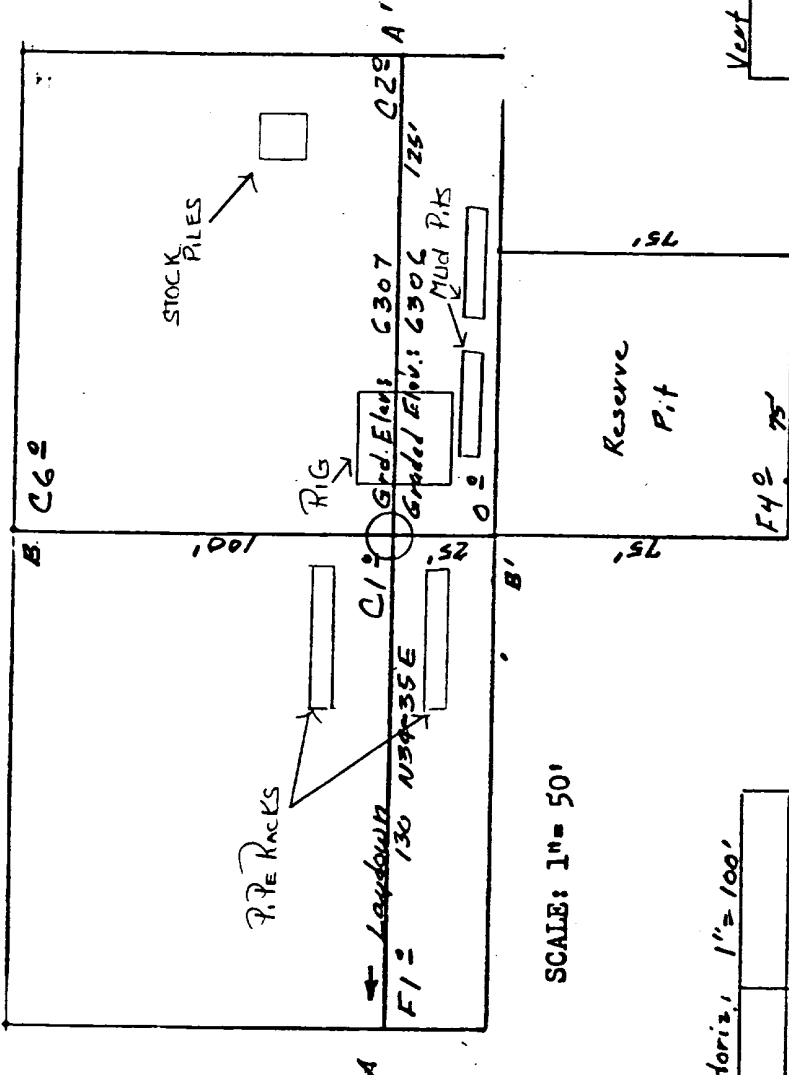

SCALE: 1" = 50'

Vert: 1" = 40' A-A' Horiz: 1" = 100'

6310					
6300					
6290					

B-B' <

6310					
6300					
6290					

Vert: 1" = 40' C-C' < Horiz: 1" = 100'

D-D' <

KERR LAND SURVEYING
 Date: 4-9-79

PROPOSED LOCATION
 EXISTING LOCATIONS
 PROPOSED ROAD
 PROPOSED ROADS

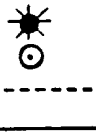

Vicinity Map for
 SOUTHLAND ROYALTY CO. #19 DAVIS
 1840'FNL 1110'FWL Sec 1-T31N-R12W
 SAN JUAN COUNTY, NEW MEXICO

