

NO. OF COPIES RECEIVED	5
DISTRIBUTION	
SANTA FE	1
FILE	✓
U.S.G.S.	2
LAND OFFICE	
OPERATOR	1

NEW MEXICO OIL CONSERVATION COMMISSION

30-045-23538
Form C-101
Revised 1-1-65

5A. Indicate Type of Lease	
STATE <input type="checkbox"/>	FEE <input checked="" type="checkbox"/>
5. State Oil & Gas Lease No.	

APPLICATION FOR PERMIT TO DRILL, DEEPEN, OR PLUG BACK

1a. Type of Work		7. Unit Agreement Name	
b. Type of Well DRILL <input checked="" type="checkbox"/> DEEPEN <input type="checkbox"/> PLUG BACK <input type="checkbox"/> OIL WELL <input type="checkbox"/> GAS WELL <input checked="" type="checkbox"/> OTHER <input type="checkbox"/> SINGLE ZONE <input checked="" type="checkbox"/> MULTIPLE ZONE <input type="checkbox"/>		Maddox	
2. Name of Operator		8. Farm or Lease Name	
Northwest Pipeline Corporation		Maddox	
3. Address of Operator		9. Well No.	
P.O. Box 90 - Farmington, N.M. 87401		2	
4. Location of Well UNIT LETTER <u>N</u> LOCATED <u>1180</u> FEET FROM THE <u>South</u> LINE AND <u>1590</u> FEET FROM THE <u>West</u> LINE OF SEC. <u>10</u> TWP. <u>32N</u> RGE. <u>11W</u> NMPM		10. Field and Pool, or Wildcat	
		Blanco <i>PC ext</i>	
		12. County	
		San Juan	
		19. Proposed Depth	
		3600'	
		19A. Formation	
		Pictured Cliffs	
		20. Rotary or C.T.	
		Rotary	
21. Elevations (Show whether DF, RT, etc.)		21B. Drilling Contractor	
6424' GR			
21A. Kind & Status Plug. Bond		22. Approx. Date Work will start	
Blanket		June 15, 1979	

PROPOSED CASING AND CEMENT PROGRAM

SIZE OF HOLE	SIZE OF CASING	WEIGHT PER FOOT	SETTING DEPTH	SACKS OF CEMENT	EST. TOP
12 1/4"	8 5/8"	24#	100'	90 sks.	Surface
6 3/4"	2 3/8"	6.4#	3600'	210 sks.	1850'

Selectively perforate and stimulate the Pictured Cliffs formation.

A BOP will be installed after the surface casing has been run and cemented. All subsequent operations will be conducted through the BOP.

The W/2 of Section 10 is dedicated to this well.

Gas is dedicated.

APPROVAL VALID
FOR 90 DAYS UNLESS
DRILLING COMMENCED,

EXPIRES 8-9-79



IN ABOVE SPACE DESCRIBE PROPOSED PROGRAM: IF PROPOSAL IS TO DEEPEN OR PLUG BACK, GIVE DATA ON PRESENT PRODUCTIVE ZONE AND PROPOSED NEW PRODUCTIVE ZONE. GIVE BLOWOUT PREVENTER PROGRAM, IF ANY.

I hereby certify that the information above is true and complete to the best of my knowledge and belief.

Signed William J. Billman Title Drilling Engineer Date May 8, 1979
W.J. Billman
(This space for State Use)

APPROVED BY AK Kendrick TITLE SUPERVISOR DISTRICT # 3 DATE MAY 11 1979

CONDITIONS OF APPROVAL, IF ANY:

ch-100-1111

**NEW MEXICO OIL CONSERVATION COMMISSION
WELL LOCATION AND ACREAGE DEDICATION PLAT**

Form C-102
Supersedes C-128
Effective 1-1-65

All distances must be from the outer boundaries of the Section.

Operator Northwest Pipeline Corporation			Lease Maddox		Well No. 2
Unit Letter N	Section 10	Township 32N	Range 11W	County San Juan	
Actual Footage Location of Well: 1180 feet from the South line and 1590 feet from the West line					
Ground Level Elev. 6426	Producing Formation Pictured Cliffs		Pool Blanco ext	Dedicated Acreage: 167.9 Acres	

1. Outline the acreage dedicated to the subject well by colored pencil or hachure marks on the plat below.
2. If more than one lease is dedicated to the well, outline each and identify the ownership thereof (both as to working interest and royalty).
3. If more than one lease of different ownership is dedicated to the well, have the interests of all owners been consolidated by communitization, unitization, force-pooling, etc?

☐ Yes ☐ No If answer is "yes," type of consolidation _____

If answer is "no," list the owners and tract descriptions which have actually been consolidated. (Use reverse side of this form if necessary.) _____

No allowable will be assigned to the well until all interests have been consolidated (by communitization, unitization, forced-pooling, or otherwise) or until a non-standard unit, eliminating such interests, has been approved by the Commission.

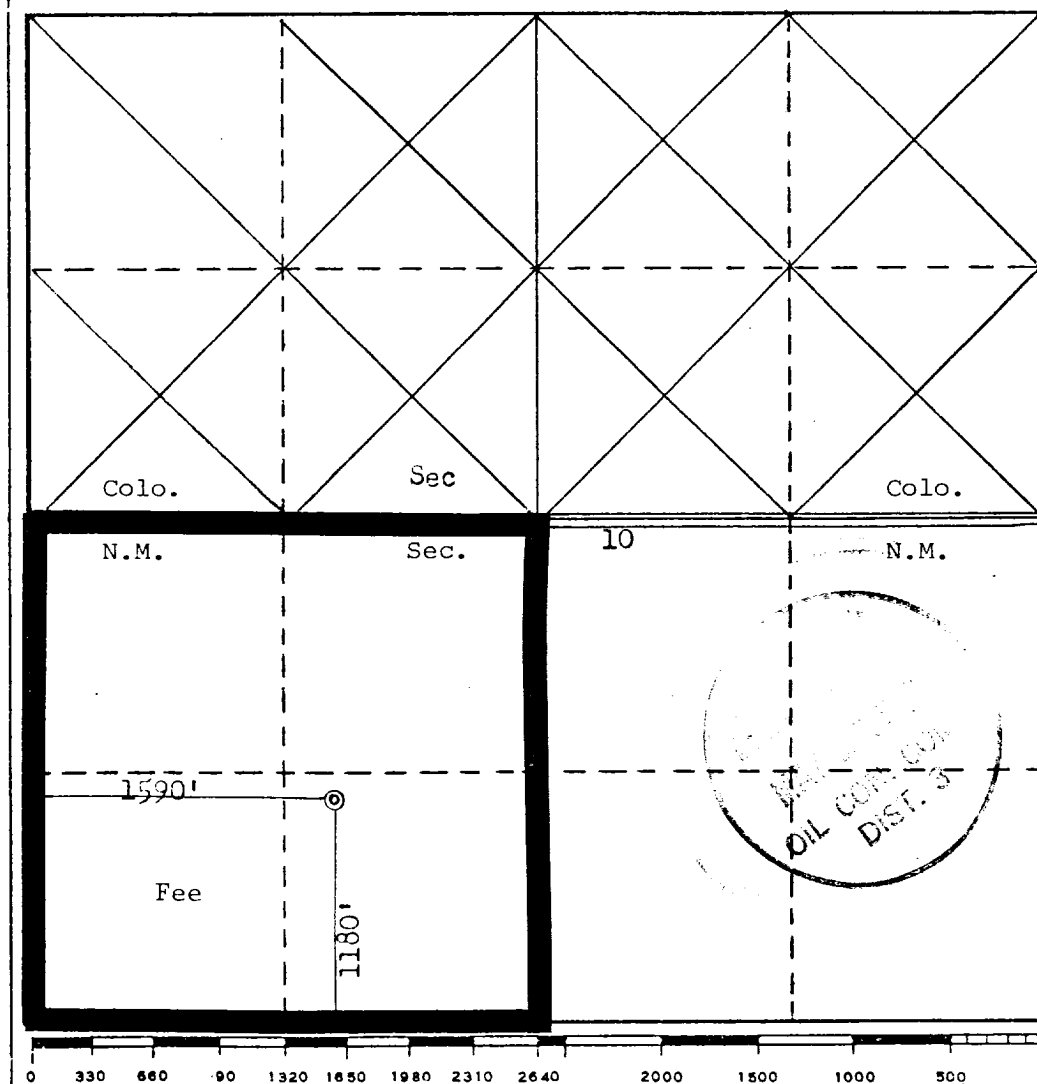

CERTIFICATION

I hereby certify that the information contained herein is true and complete to the best of my knowledge and belief.

W.J. Billman

Name **W.J. Billman**

Position **Drilling Engineer**

Company **Northwest Pipeline Corp.**

Date **5-2-79**

I hereby certify that the well location shown on this plat was plotted from field notes of actual surveys made by me or under my supervision, and that the same is true and correct to the best of my knowledge and belief.

Date Surveyed **February 14, 1979**

Registered Professional Engineer and/or Land Surveyor

Fred B. Kerr, Jr.

Fred B. Kerr, Jr.

Certificate No. **3950**