

**UNITED STATES
DEPARTMENT OF THE INTERIOR
GEOLOGICAL SURVEY**

(Other instructions on reverse side)

30-045-23619
5. LEASE DESIGNATION AND SERIAL NO.
NM 053798

APPLICATION FOR PERMIT TO DRILL, DEEPEN, OR PLUG BACK

1a. TYPE OF WORK
 DRILL ☒ DEEPEN ☐ PLUG BACK ☐

b. TYPE OF WELL
 OIL WELL ☐ GAS WELL ☒ OTHER ☐ SINGLE ZONE ☐ MULTIPLE ZONE ☐

2. NAME OF OPERATOR
 Bruce Anderson

3. ADDRESS OF OPERATOR
 Box 234, Farmington, NM 87401

4. LOCATION OF WELL (Report location clearly and in accordance with any State requirements)
 At surface
 1570' FSL - 1000' FEL
 At proposed prod. zone

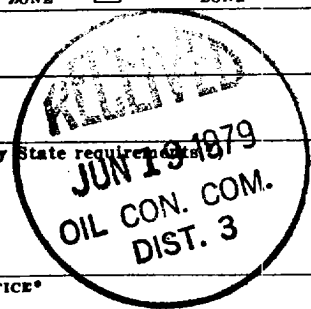

6. IF INDIAN, ALLOTTEE OR TRIBE NAME

7. UNIT AGREEMENT NAME

8. FARM OR LEASE NAME
 Federal

9. WELL NO.
 #2

10. FIELD AND POOL, OR WILDCAT
 Basin Dakota

11. SEC., T., R., M., OR BLK. AND SURVEY OR AREA
 Section 30 T31N R13W

12. COUNTY OR PARISH
 San Juan

13. STATE
 NM

14. DISTANCE IN MILES AND DIRECTION FROM NEAREST TOWN OR POST OFFICE*
 10 miles NW of Farmington

15. DISTANCE FROM PROPOSED* LOCATION TO NEAREST PROPERTY OR LEASE LINE, FT. (Also to nearest drlg. unit line, if any)
 1000'

16. NO. OF ACRES IN LEASE

17. NO. OF ACRES ASSIGNED TO THIS WELL
 E/315.56

18. DISTANCE FROM PROPOSED LOCATION* TO NEAREST WELL, DRILLING, COMPLETED, OR APPLIED FOR, ON THIS LEASE, FT.
 approx 2350'

19. PROPOSED DEPTH
 6600'

20. ROTARY OR CABLE TOOLS
 Rotary

21. ELEVATIONS (Show whether DF, RT, GR, etc.)
 5657' GR

22. APPROX DATE WORK WILL START*
 July 25, 1979

23. PROPOSED CASING AND CEMENTING PROGRAM

| SIZE OF HOLE | SIZE OF CASING | WEIGHT PER FOOT | SETTING DEPTH | QUANTITY OF CEMENT |
|--------------|----------------|-----------------|---------------|----------------------|
| 12-1/2" | 8-5/8" | 24# | 180' | 150 sx |
| 7-7/8" | 4-1/2" | 10.5# | 6600' | 800 sx in two stages |

Plan to drill with mud to test producing formation. If productive, will set 4-1/2" casing, selectively perforate, frac, clean out after frac, run 1-1/4" tubing, and complete well.

Plan to use BOP furnished by rig while drilling (10" 3000 psi hydraulic)

Plan to use BOP rental while completing (6" 3000 psi double gate manual)

NMERB: Gas dedicated to El Paso

IN ABOVE SPACE DESCRIBE PROPOSED PROGRAM: If proposal is to deepen or plug back, give data on present productive zone and proposed new productive zone. If proposal is to drill or deepen directionally, give pertinent data on subsurface locations and measured and true vertical depths. Give blowout preventer program, if any.

24. SIGNED Thomas A. Dugan TITLE Petroleum Engineer DATE 6-14-79
 (This space for Federal or State office use)

PERMIT NO. _____ APPROVAL DATE _____

APPROVED BY _____ TITLE _____ DATE _____
 CONDITIONS OF APPROVAL, IF ANY:

ok Frank
 Winter 1979

WYMOCK

*See Instructions On Reverse Side

**NEW MEXICO OIL CONSERVATION COMMISSION
WELL LOCATION AND ACREAGE DEDICATION PLAT**

Form C-102
Supersedes C-128
Effective 1-1-65

All distances must be from the outer boundaries of the Section.

| | | | | | |
|--|--------------------------------------|-----------------------------|---|---------------------------|-----------------------|
| Operator Bruce Anderson | | | Lease Federal | | Well No. #2 |
| Unit Letter 1 | Section 30 | Township 31 North | Range 13 West | County San Juan | |
| Actual Footage Location of Well: <div style="display: flex; justify-content: space-between;"> 1570 feet from the South line and 1000 feet from the East line </div> | | | | | |
| Ground Level Elev. 5657 | Producing Formation Dakota | Pool Basin | Dedicated Acreage: 315.56 Acres | | |

1. Outline the acreage dedicated to the subject well by colored pencil or hachure marks on the plat below.
2. If more than one lease is dedicated to the well, outline each and identify the ownership thereof (both as to working interest and royalty).
3. If more than one lease of different ownership is dedicated to the well, have the interests of all owners been consolidated by communitization, unitization, force-pooling, etc?

☐ Yes ☐ No If answer is "yes," type of consolidation _____

If answer is "no," list the owners and tract descriptions which have actually been consolidated: (Use reverse side of this form if necessary.) _____

No allowable will be assigned to the well until all interests have been consolidated (by communitization, unitization, forced-pooling, or otherwise) or until a non-standard unit, eliminating such interests, has been approved by the Commission.

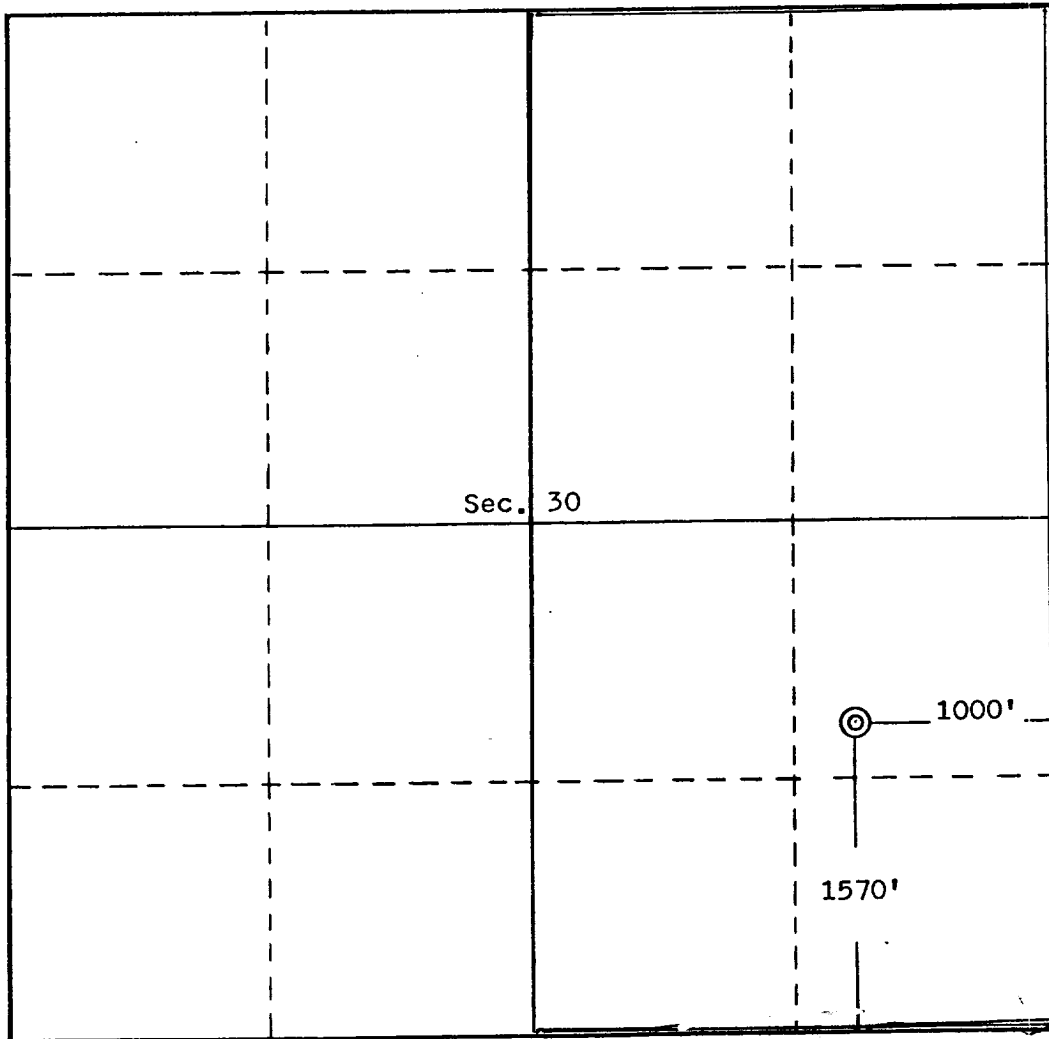
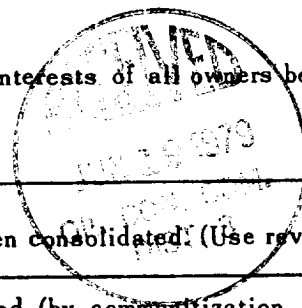

CERTIFICATION

I hereby certify that the information contained herein is true and complete to the best of my knowledge and belief.

Thomas A. Dugan

Name
Thomas A. Dugan

Position
Agent

Company
Bruce Anderson

Date
6-14-79

I hereby certify that the information shown on this plat was placed in the field notes of actual survey made by me or under my supervision, and that the same is true and correct to the best of my knowledge and belief.

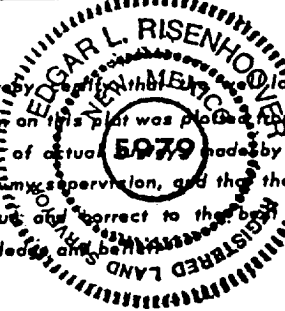

Date Surveyed
April 25, 1979

Registered Professional Engineer
and/or Land Surveyor

Edgar L. Risenhoover

Certificate No. **5979**
Edgar L. Risenhoover, L.S.