

UNITED STATES
DEPARTMENT OF THE INTERIOR
GEOLOGICAL SURVEY

APPLICATION FOR PERMIT TO DRILL, DEEPEN, OR PLUG BACK

1a. TYPE OF WORK

DRILL ☒DEEPEN ☐PLUG BACK ☐

b. TYPE OF WELL

OIL
WELL ☐GAS
WELL ☒

OTHER

SINGLE
ZONE ☐MULTIPLE
ZONE ☒

2. NAME OF OPERATOR

Consolidated Oil & Gas, Inc.

3. ADDRESS OF OPERATOR

1860 Lincoln Street, Denver, Colorado 80295

4. LOCATION OF WELL (Report location clearly and in accordance with any State requirements.)*

At surface 1850' FWL & 1758' FNL 'F' Sec 5, T31N, R12W

At proposed prod. zone Same

14. DISTANCE IN MILES AND DIRECTION FROM NEAREST TOWN OR POST OFFICE*

3.8 miles West of La Plata, New Mex.

15. DISTANCE FROM PROPOSED*

LOCATION TO NEAREST
PROPERTY OR LEASE LINE, FT.
(Also to nearest drlg. unit line, if any)

1758'

18. DISTANCE FROM PROPOSED LOCATION*

TO NEAREST WELL, DRILLING, COMPLETED,
OR APPLIED FOR, ON THIS LEASE, FT.

2700'

16. NO. OF ACRES IN LEASE

320.00

19. PROPOSED DEPTH

7070'

17. NO. OF ACRES ASSIGNED
TO THIS WELL

W/313.36 320.00

20. ROTARY OR CABLE TOOLS

Rotary

21. ELEVATIONS (Show whether DF, RT, GR, etc.)

5966' GR

22. APPROX. DATE WORK WILL START*

July 1, 1979

23. PROPOSED CASING AND CEMENTING PROGRAM

SIZE OF HOLE	SIZE OF CASING	WEIGHT PER FOOT	SETTING DEPTH	QUANTITY OF CEMENT
12-1/4"	8-5/8"	24.0#/	250'	200 sx - circl'd to surface
7-7/8"	4-1/2"	10.5#/	7070'	300 sx

1. Drill 12-1/4" hole to 250'. Run and set 8-5/8" casing. Circ cement to surface.
2. WOC 12 hrs.
3. Install blowout preventer. Pressure test surface casing and BOP's to 1000#.
4. Drill 7-7/8" hole to \pm 7070' w/fresh water gel mud. Log.
5. Run and set 4-1/2" production casing and cement same w/approximately 300 sx.
6. Selectively perforate and stimulate Dakota formation and complete per applicable rules and regulations.

The W/2 of Section 5 is dedicated to this well and the acreage is committed to a gas sales contract.

IN ABOVE SPACE DESCRIBE PROPOSED PROGRAM: If proposal is to deepen or plug back, give data on present productive zone and proposed new productive zone. If proposal is to drill or deepen directionally, give pertinent data on subsurface locations and measured and true vertical depths. Give blowout preventer program, if any.

24.

SIGNED

TITLE Senior Production Engineer

DATE June 26, 1979

(This space for Federal or State office use)

PERMIT NO.

APPROVAL DATE

APPROVED BY

TITLE

CONDITIONS OF APPROVAL, IF ANY:

ok S. R. h

nymocc

30-045-23645

5. LEASE DESIGNATION AND SERIAL NO.

NM 019413

6. IF INDIAN, ALLOTTEE OR TRIBE NAME

7. UNIT AGREEMENT NAME

8. FARM OR LEASE NAME

Mitchell

9. WELL NO.

1-E

10. FIELD AND POOL, OR WILDCAT

Basin Dakota

11. SEC., T., R., M., OR BLK.
AND SURVEY OR AREA

Sec 5, T31N, R12W, NMPM

12. COUNTY OR PARISH

San Juan

13. STATE

New Mexico

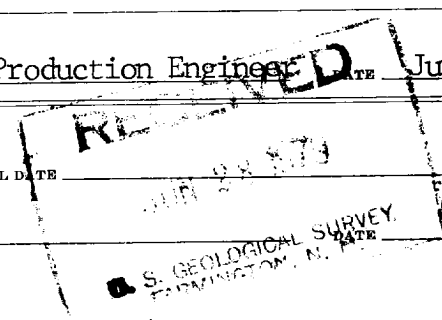
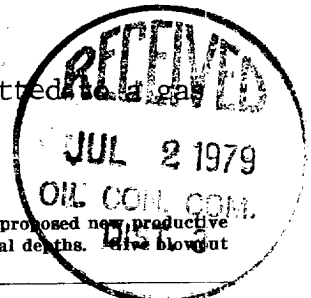

Instructions

General: This form is designed for submitting proposals to perform certain well operations, as indicated, on all types of lands and leases for appropriate action by either a Federal or a State agency, or both, pursuant to applicable Federal and/or State laws and regulations. Any necessary special instructions concerning the use of this form and the number of copies to be submitted, particularly with regard to local, area, or regional procedures and practices, either are shown below or will be issued by, or may be obtained from, the local Federal and/or State office.

Item 1: If the proposal is to redrill to the same reservoir at a different subsurface location or to a new reservoir, use this form with appropriate notations. Consult applicable State or Federal regulations concerning subsequent work proposals or reports on the well.

Item 4: If there are no applicable State requirements, locations on Federal or Indian land should be described in accordance with Federal requirements. Consult local State or Federal office for specific instructions.

Item 14: Needed only when location of well cannot readily be found by road from the land or lease description. A plat, or plats, separate or on this reverse side, showing the roads to, and the surveyed location of, the well, and any other required information, should be furnished when required by Federal or State agency offices.

Items 15 and 18: If well is to be, or has been directionally drilled, give distances for subsurface location of hole in any present or objective production zone.

Item 22: Consult applicable Federal or State regulations, or appropriate officials, concerning approval of the proposal before operations are started.

MEXICO OIL CONSERVATION COMMISSION
WELL LOCATION AND ACREAGE DEDICATION PLAT

Form C-102
Supersedes C-128
Effective 1-1-65

All distances must be from the outer boundaries of the Section.

Operator: CONSOLIDATED OIL AND GAS, INC.			Lease: MITCHELL		Well No.: 1-E
Unit Letter: F	Section: 5	Township: 31 NORTH	Range: 12 WEST	County: SAN JUAN	
Actual Footage Location of Well:					
1758 feet from the NORTH line and		1850 feet from the WEST line			
Ground Level Elev.: 5966	Producing Formation: Dakota	Pool: Basin Dakota		Dedicated Acreage: 318.36 320 Acres	

1. Outline the acreage dedicated to the subject well by colored pencil or hachure marks on the plat below.
2. If more than one lease is dedicated to the well, outline each and identify the ownership thereof (both as to working interest and royalty).
3. If more than one lease of different ownership is dedicated to the well, have the interests of all owners been consolidated by communitization, unitization, force-pooling, etc?

☒ Yes ☐ No If answer is "yes," type of consolidation Communitization

If answer is "no," list the owners and tract descriptions which have actually been consolidated. (Use reverse side of this form if necessary.) _____

No allowable will be assigned to the well until all interests have been consolidated (by communitization, unitization, forced-pooling, or otherwise) or until a non-standard unit, eliminating such interests, has been approved by the Commission.

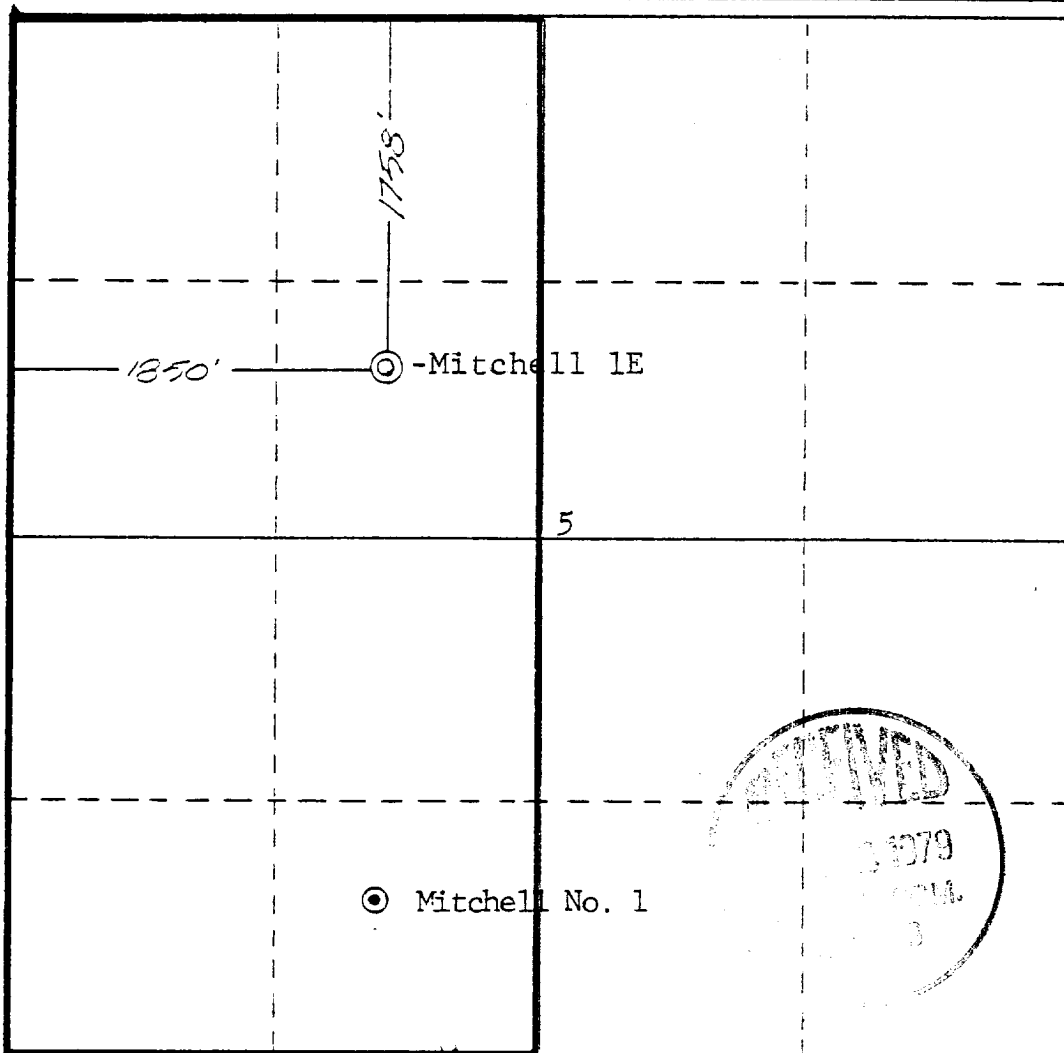

CERTIFICATION

I hereby certify that the information contained herein is true and complete to the best of my knowledge and belief.

C. M. Parham

Name

C. M. Parham

Position

Senior Production Engineer

Company

Consolidated Oil & Gas, Inc.

Date

I hereby certify that the well location shown on this plat was located from notes of actual surveys made by me under my commission, and that the same is true and correct to the best of my knowledge and belief.

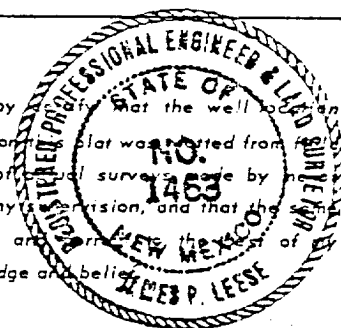

Date Surveyed

13 May 1979

Registered Professional Engineer

and/or Land Surveyor

James P. Leese

Certificate No.

1463