

NO. OF COPIES RECEIVED	6
DISTRIBUTION	
SANTA FE	1
FILE	
U.S.G.S.	2
LAND OFFICE	
OPERATOR	2

NEW MEXICO OIL CONSERVATION COMMISSION

30-095-23646  
Form C-101  
Revised 1-1-65

APPLICATION FOR PERMIT TO DRILL, DEEPEN, OR PLUG BACK			
1a. Type of Work DRILL <input checked="" type="checkbox"/> DEEPEN <input type="checkbox"/> PLUG BACK <input type="checkbox"/>		5a. Indicate Type of Lease STATE <input type="checkbox"/> FEE <input checked="" type="checkbox"/>	
b. Type of Well OIL WELL <input type="checkbox"/> GAS WELL <input checked="" type="checkbox"/> OTHER <input type="checkbox"/> SINGLE ZONE <input type="checkbox"/> MULTIPLE ZONE <input checked="" type="checkbox"/>		5. State Oil & Gas Lease No.	
2. Name of Operator Southland Royalty Company		7. Unit Agreement Name	
3. Address of Operator P. O. Drawer 570, Farmington, New Mexico		8. Farm or Lease Name Grenier	
4. Location of Well UNIT LETTER N LOCATED 1075 FEET FROM THE South LINE AND 1850 FEET FROM THE West LINE OF SEC. 13 TWP. 31N RGE. 12W NMPM		9. Well No. #11E	
		10. Field and Pool, or Wildcat Undesignated Fruitland Basin Dakota	
		12. County San Juan	
		19. Proposed Depth 7300'	
		19A. Formation Dakota	
		20. Rotary or C.T. Rotary	
21. Elevations (Show whether DF, RT, etc.) 6087' GR		21A. Kind & Status Plug. Bond	
		21B. Drilling Contractor	
		22. Approx. Date Work will start July 15, 1979	

23.

PROPOSED CASING AND CEMENT PROGRAM

SIZE OF HOLE	SIZE OF CASING	WEIGHT PER FOOT	SETTING DEPTH	SACKS OF CEMENT	EST. TOP
13-3/4"	10-3/4"	32.75#	200'	238 sxs	Circ. to Surface
9-5/8"	7-5/8"	27.40#	4820'	700 sxs	Cover Ojo Alamo
6-3/4"	5-1/2"	15.50#	4670'-7150'	251 sxs	Liner Top
6-3/4"	5-1/2"	17.00#	7150'-7300'		
	2-3/8"	4.70#	7300'		
	1-1/4"	2.40#	2200'		

Surface formation is Nacimiento.

Top of Ojo Alamo sand is at 1199'.

Top of Pictured Cliffs sand is at 2614'.

Top of Cliff House Sand is at 4129'.

Fresh water mud will be used to drill from surface to intermediate depth.

An air system will be used to drill from intermediate depth to total depth.

It is anticipated that an IES and a GR-Density log will be run at intermediate depth.

It is anticipated that a GR-Induction and a GR-Density log will be run at total depth.

No abnormal pressures or poisonous gases are expected in this well.

It is expected that this well will be drilled before September 1, 1979. This depends on time required for approvals, rig availability and the weather.

Gas is dedicated.

Dedicated Acreage: W/2 Section 13, T31N, R12W (314.53 acres)

IN ABOVE SPACE DESCRIBE PROPOSED PROGRAM: IF PROPOSAL IS TO DEEPEN OR PLUG BACK, GIVE DATA ON PRESENT PRODUCTIVE ZONE AND PROPOSED NEW PRODUCTIVE ZONE. GIVE BLOWOUT PREVENTER PROGRAM, IF ANY.

I hereby certify that the information above is true and complete to the best of my knowledge and belief.

Signed [Signature] Title District Production Manager Date June 26, 1979

(This space for State Use)

APPROVED BY [Signature] TITLE DEPUTY OIL & GAS INSPECTOR, DIST. #3 DATE JUL 2 1979

CONDITIONS OF APPROVAL, IF ANY:

NWU-456612

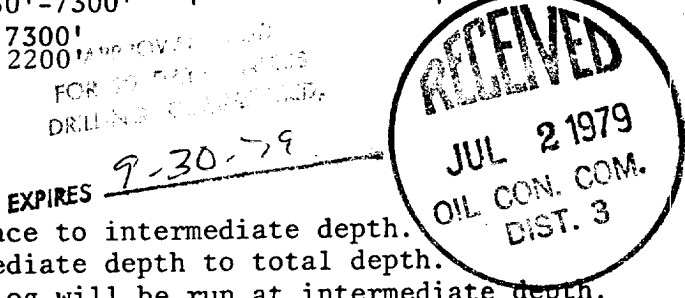

**NEW MEXICO OIL CONSERVATION COMMISSION  
WELL LOCATION AND ACREAGE DEDICATION PLAT**

Form C-102  
Supersedes C-128  
Effective 1-1-65

All distances must be from the outer boundaries of the Section.

Operator <b>SOUTHLAND ROYALTY COMPANY</b>			Lease <b>BREWER</b>		Well No. <b>11E</b>
Unit Letter <b>N</b>	Section <b>13</b>	Township <b>31N</b>	Range <b>12W</b>	County <b>San Juan</b>	
Actual Footage Location of Well: <b>1075</b> feet from the <b>South</b> line and <b>1850</b> feet from the <b>West</b> line					
Ground Level Elev. <b>6087</b>	Producing Formation <b>Dakota - Fruitland</b>		Pool <b>Basin Dakota - Undesignated</b>	Dedicated Acreage: <b>160/314.53</b> Acres	

1. Outline the acreage dedicated to the subject well by colored pencil or hachure marks on the plat below.
2. If more than one lease is dedicated to the well, outline each and identify the ownership thereof (both as to working interest and royalty).
3. If more than one lease of different ownership is dedicated to the well, have the interests of all owners been consolidated by communitization, unitization, force-pooling, etc?

☐ Yes    ☐ No    If answer is "yes," type of consolidation \_\_\_\_\_

If answer is "no," list the owners and tract descriptions which have actually been consolidated. (Use reverse side of this form if necessary.) \_\_\_\_\_

No allowable will be assigned to the well until all interests have been consolidated (by communitization, unitization, forced-pooling, or otherwise) or until a non-standard unit, eliminating such interests, has been approved by the Commission.

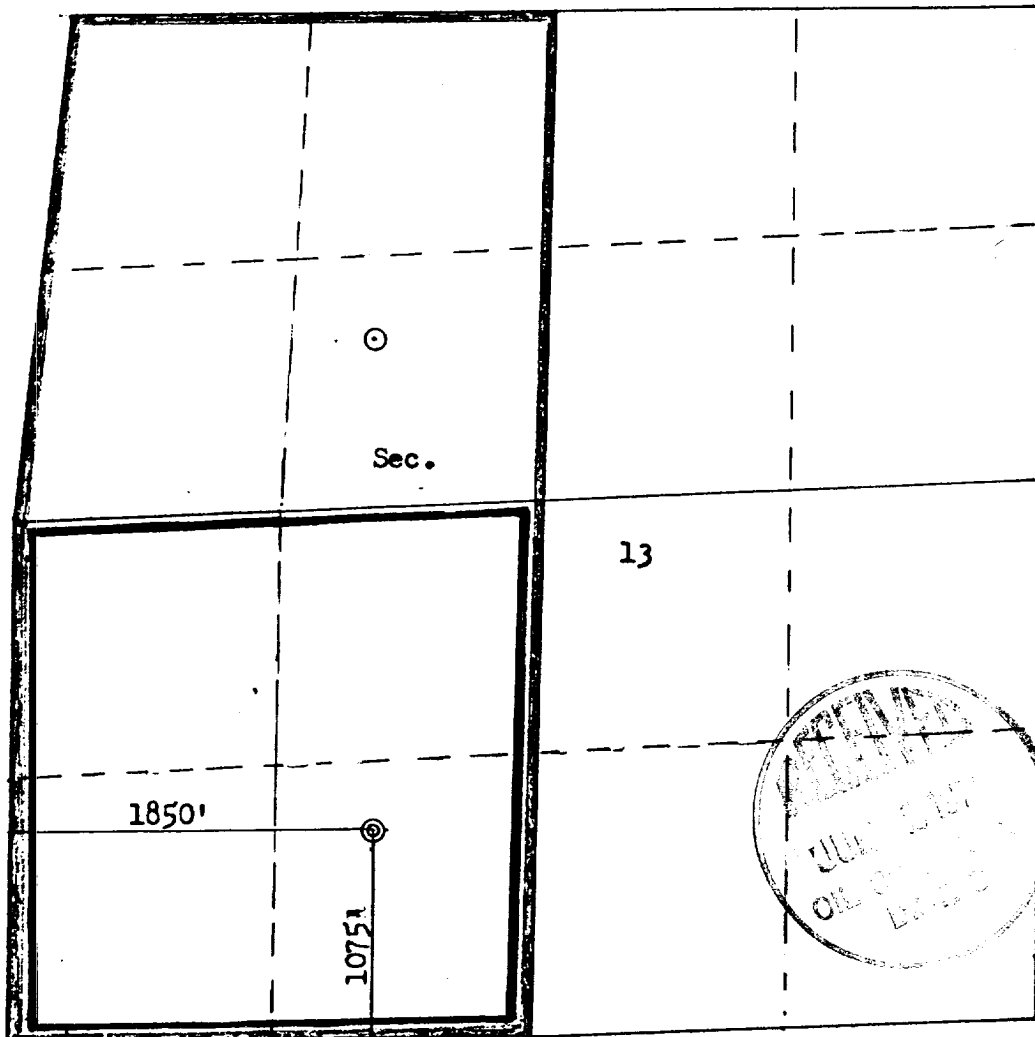

SCALE: 1"=1000'

**CERTIFICATION**

*I hereby certify that the information contained herein is true and complete to the best of my knowledge and belief.*

Name \_\_\_\_\_  
 Position \_\_\_\_\_  
**District Production Manager**  
 Company \_\_\_\_\_  
**Southland Royalty Company**  
 Date \_\_\_\_\_  
**June 26, 1979**

*I hereby certify that the well location shown on this plat was plotted from field notes of actual surveys made by me or under my supervision, and that the same is true and correct to the best of my knowledge and belief.*

Date Surveyed \_\_\_\_\_  
**June 18, 1979**  
 Registered Professional Engineer and Land Surveyor  
 \_\_\_\_\_  
**Fred B. Kerr, Jr.**  
 Certificate No. **ERR, JR.**  
**3950**



**Southland Royalty Company**

June 26, 1979

Oil Conservation Division  
1000 Rio Brazos Road  
Aztec, New Mexico 87410

Attention: Mr. Al Kendrick

Re: Blowout Preventer Plan

Dear Sir:

All drilling and completion rigs will be equipped with 8" or larger double gate hydraulic blowout preventers and a hydraulic operated closing unit with steel lines.

The preventer is 3000# working pressure and 6000# test.

All crews will be thoroughly trained in the operation of this preventer. The preventer will be tested frequently enough to insure proper operation.

Yours truly,

L. O. Van Ryan  
District Production Manager

LOVR/dg