

UNITED STATES
DEPARTMENT OF THE INTERIOR
GEOLOGICAL SURVEY(Other instructions on
reverse side)30-045-23686
5. LEASE DESIGNATION AND SERIAL NO.

SF-078640

6. IF INDIAN, ALLOTTEE OR TRIBE NAME

7. UNIT AGREEMENT NAME

San Juan 32-7 Unit

8. FARM OR LEASE NAME

San Juan 32-7 Unit

9. WELL NO.

56

10. FIELD AND POOL, OR WILDCAT

Basin Dakota

11. SEC., T., R., M., OR BLK.
AND SURVEY OR AREA

Sec. 17, T32N, R7W

12. COUNTY OR PARISH 13. STATE

San Juan

New Mexico

APPLICATION FOR PERMIT TO DRILL, DEEPEN, OR PLUG BACK

1a. TYPE OF WORK

DRILL ☒DEEPEN ☐PLUG BACK ☐

b. TYPE OF WELL

OIL
WELL ☐GAS
WELL ☒

OTHER

SINGLE
ZONE ☐MULTIPLE
ZONE ☐

2. NAME OF OPERATOR

Northwest Pipeline Corporation

3. ADDRESS OF OPERATOR

P.O. Box 90 - Farmington, New Mexico 87401

4. LOCATION OF WELL (Report location clearly and in accordance with any State requirements.)*

At surface

1670' FNL & 800' FWL

At proposed prod. zone

as above

14. DISTANCE IN MILES AND DIRECTION FROM NEAREST TOWN OR POST OFFICE*

23 miles east of Aztec, New Mexico

15. DISTANCE FROM PROPOSED*

LOCATION TO NEAREST

PROPERTY OR LEASE LINE, FT.

(Also to nearest drig. unit line, if any) 800'

16. NO. OF ACRES IN LEASE

NA

17. NO. OF ACRES ASSIGNED
TO THIS WELL

w/ 342.62

18. DISTANCE FROM PROPOSED LOCATION*

TO NEAREST WELL, DRILLING, COMPLETED,
OR APPLIED FOR, ON THIS LEASE, FT. NA

19. PROPOSED DEPTH

8000'

20. ROTARY OR CABLE TOOLS

Rotary

21. ELEVATIONS (Show whether DF, RT, GR, etc.)

6333' GR

22. APPROX. DATE WORK WILL START*

Sept. 1, 1979

23.

PROPOSED CASING AND CEMENTING PROGRAM

SIZE OF HOLE	SIZE OF CASING	WEIGHT PER FOOT	SETTING DEPTH	QUANTITY OF CEMENT
12 1/4"	9 5/8"	32.3#	350'	185 sks.
8 3/4"	7"	20#	3700'	165 sks.
6 1/4"	4 1/2"	10.5#	8000'	225 sks.

Selectively perforate and stimulate the Dakota Formation.

A BOP will be installed after the surface casing is cemented. All subsequent operations will be conducted through the BOPs.

Gas is dedicated.

The West half of Section 17 is dedicated to this well.

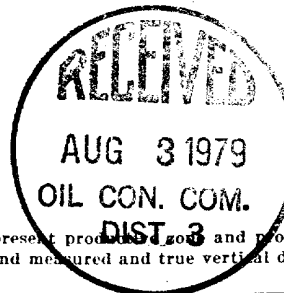

IN ABOVE SPACE DESCRIBE PROPOSED PROGRAM: If proposal is to deepen or plug back, give data on present productive zone and proposed new productive zone. If proposal is to drill or deepen directionally, give pertinent data on subsurface locations and measured and true vertical depths. Give blowout preventer program, if any.

24.

SIGNED

M. Turnbaugh
M. Turnbaugh

TITLE Assoc. Drilling Engineer

DATE 7/25/79

(This space for Federal or State office use)

PERMIT NO.

APPROVAL DATE

APPROVED BY

TITLE

DATE

CONDITIONS OF APPROVAL, IF ANY:

AUG 1 1979

U. S. GEOLOGICAL SURVEY
DENVER, COLO.

*See Instructions On Reverse Side

ch

ok Frank
Write NWU

Slide

NEW MEXICO OIL CONSERVATION COMMISSION
WELL LOCATION AND ACREAGE DEDICATION PLAT

Form C-102
Supersedes C-128
Effective 1-1-55

All distances must be from the outer boundaries of the Section.

Operator NORTHWEST PIPELINE CORPORATION		Lease SAN JUAN 32-7 UNIT		Well No. 56
Unit Letter E	Section 17	Township 32N	Range 7W	County San Juan
Actual Footage Location of Well: 1670 feet from the North line and 800 feet from the West line				
Ground Level Elev. 6333	Producing Formation Dakota	Pool Basin	Dedicated Acreage 320 342.62 Acres	

1. Outline the acreage dedicated to the subject well by colored pencil or hachure marks on the plat below.
2. If more than one lease is dedicated to the well, outline each and identify the ownership thereof (both as to working interest and royalty).
3. If more than one lease of different ownership is dedicated to the well, have the interests of all owners been consolidated by communitization, unitization, force-pooling, etc?

☐ Yes ☐ No If answer is "yes," type of consolidation _____

If answer is "no," list the owners and tract descriptions which have actually been consolidated. (Use reverse side of this form if necessary.) _____

No allowable will be assigned to the well until all interests have been consolidated (by communitization, unitization, forced-pooling, or otherwise) or until a non-standard unit, eliminating such interests, has been approved by the Commission.

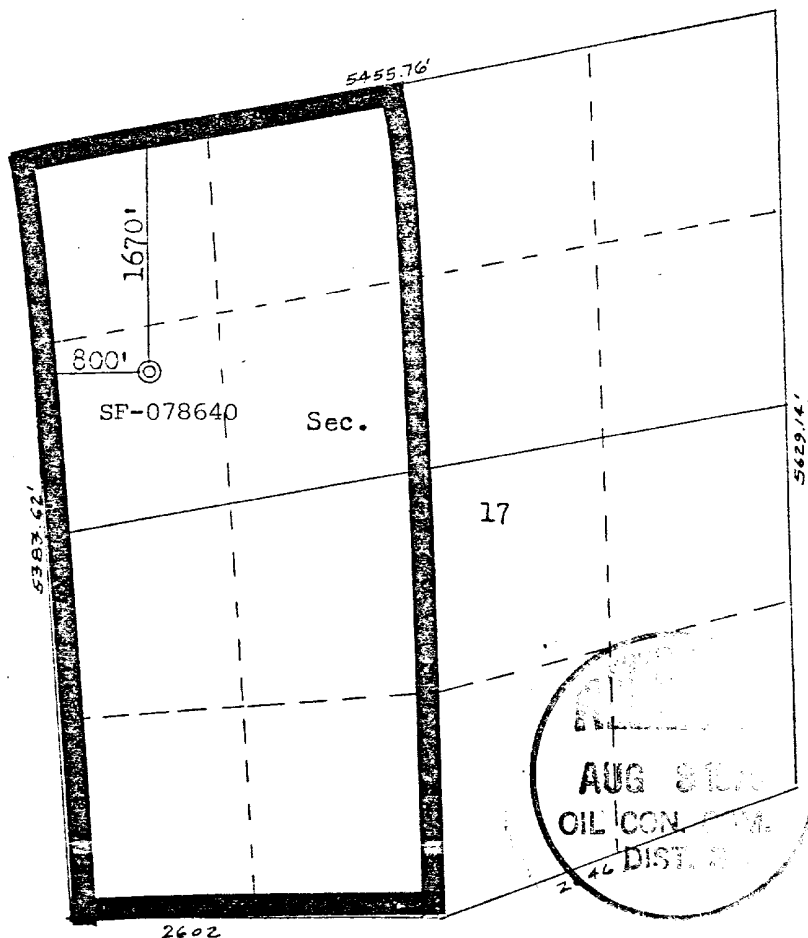

CERTIFICATION

I hereby certify that the information contained herein is true and complete to the best of my knowledge and belief.

Mike Turnbaugh

Name
Mike Turnbaugh

Position
Assoc. Drilling Engineer

Company
Northwest Pipeline Corp.

Date
7/31/79

I hereby certify that the well location shown on this plat was plotted from field notes of actual surveys made by me or under my supervision, and that the same is true and correct to the best of my knowledge and belief.

Date Surveyed
July 20, 1979

Registered Professional Engineer and Land Surveyor
Fred R. Kerr Jr.

Certificate No.
3950

NORTHWEST PIPELINE CORPORATION

MULTI - POINT SURFACE USE PLAN

for the

San Juan 32-7 Unit

Well Number 56

1. Existing Roads: See attached topographic map. All existing roads used, shall be maintained in a serviceable condition at all times during the drilling operation.
2. Planned Access Roads: See attached topographic map. Maximum grade is approximately 1%. The road surface will not exceed twenty feet in width. Upon completion of drilling operations the access road will be adequately drained to control runoff and soil erosion. Drainage facilities may include ditches, water bars, culverts or any other measure deemed necessary. All activities will be confined to the access road and drill pad.
3. Location of Existing Wells: See attached topographic map.
4. Location of Tank Batteries; Production Facilities; and Production; Gathering and Service lines: See attached topographic map for locations of existing and proposed gas gathering lines.
5. Location and Type of Water Supply: Water needed for the drilling operation will be hauled from private sources.
6. Source of Construction Materials: No additional materials will be needed.
7. Methods for Handling Waste Disposal: All garbage, debris, and trash will be buried at least three feet deep. A portable toilet will be supplied for human waste. After drilling operations have been completed the reserve pit will be fenced and the liquid portion will be allowed to evaporate before the location is cleaned up and leveled. The earthen pits will not be located on natural drainages and will be constructed in such a manner so that they will not leak. Any evaporator pit containing toxic liquids will be fenced.
8. Ancillary Facilities: There will be no camps or airstrips associated with the drilling of this well.
9. Well Site Layout: See attached location layout sheet. There will be a drainage ditch above the cut slope.
10. Plans for Restoration of the Surface: Upon completion of drilling, the location will be cleaned, and leveled so that no cut or fill banks will be steeper than 3:1.

All of the area disturbed in connection with the drill site will be seeded as close as possible for any above ground equipment while still allowing for access to the equipment. Seeding will be done within one year after drilling is completed and during the period from July 1 through September 15. Seeding will be done with seed Mixture specified by land use authorities.

All equipment above ground will be painted a non-glare, non-reflective, non-chalking color that simulates the natural color of the site.

11. Other Information: If, during operations, any historic or prehistoric ruin, monument or site, or any object of antiquity is discovered, then work will be suspended and the discovery will be reported to the District Manager of the BLM.

When drilling with gas, the line used to discharge and burn off the gas will be located so as not to damage vegetation in the area, and if necessary an earthen screen will be constructed to protect the vegetation. All liquids from the line will be contained at the site unless otherwise specified by the surface agency's representative.

12. Operator's Representative: M. J. Turnbaugh, P.O. Box 90, Farmington, New Mexico 87401 Phone: 327-5351 Extension 115.

13. Certification:

I hereby certify that I have inspected the proposed drillsite and access route; that I am familiar with the conditions which presently exist; that the statements made in this plan are, to the best of my knowledge true and correct; and, that the work associated with the operations proposed herein will be performed by Northwest Pipeline Corporation and its contractors and subcontractors in conformity with this plan and the terms and conditions under which it is approved.

7/31/79
Date

M. Turnbaugh
M. Turnbaugh
Assoc. Drilling Engineer

MJT/skw

OPERATIONS PLAN

I. WELL NAME: San Juan 32-7 Unit #56

July 31, 1979

LOCATION: 1670' FNL & 800' FWL
Sec. 17, T32N, R7W

LEASE NUMBER: SF-078640

FIELD: Basin Dakota

ELEVATION: 6333' GR

II. GEOLOGY:

A. Formation Tops:	Cliff House	5179'
Ojo Alamo	Point Lookout	5379'
Kirtland	Greenhorn	7384'
Fruitland	Graneros	7434'
Pictured Cliffs	Dakota	7609'
Lewis	Total Depth	8000'

B. Logging Program: Gamma Ray Induction & Density at total depth.

C. Coring Program: None

D. Natural Gauges: Gauge at 5379', 7384', 7434', and at total depth. Gauge any noticable increases in gas flow at depths other than those noted above. Record all gauges on daily drilling report and tower reports.

III. DRILLING:

A. BOP: Blind rams and pipe rams, 10', 900 series, double gate, rated at 3000 psi.

B. Mud Program:

a) Spud Mud: Water, lime and gel.

b) Surface to 350.

Viscosity: 32-38 sec/qt.

Weight: 8.8-9.2 #/gal.

Water Loss: 8-20 cc

Ph: 8.5-9.5

c) From 350' to 3700'.

Viscosity: 36-45 sec/qt.

Weight: 8.5-9.5 #/gal.

Water Loss: 8-20 cc

Ph: 8.5-9.5

d) From 3700' to total depth with gas.

IV. MATERIALS:

A. Casing Program:

<u>Hole Size</u>	<u>Depth</u>	<u>Casing Size</u>	<u>Wt. & Grade</u>
12 1/4"	350'	9 5/8"	32.3# H-40
8 3/4"	3700'	7"	20# K-55
6 1/4"	8000'	4 1/2"	10.5# & 11.6# K-55

