

State of New Mexico
Energy, Minerals and Natural Resources Department

OIL CONSERVATION DIVISION

P.O. Box 2088
Santa Fe, New Mexico 87504-2088



PIT REMEDIATION AND CLOSURE REPORT

Operator: Phillips Petroleum (Williams Field Services) Telephone: (801) 584-6361
Address: P.O. Box 58900, Salt Lake City, Utah 84158-0900
WellName: San Juan 32-7 #60 (85378)
Location: Unit or Qtr/Qtr Sec *A* Sec 20 T 32N R 7W County San Juan
PitType Dehydrator
LandType Fee

Pit Location: Pit dimensions: length 19 ft., width 17 ft., depth 3 ft.
(Attach diagram)

Reference: Wellhead

Footage from reference: 82 ft.

Direction from reference: 60 Degrees West of South

Depth To Ground Water:	Less than 50 feet	(20 points)	
(Vertical distance from	50 feet to 99 feet	(10 points)	
contaminants to seasonal	Greater than 100 feet	(0 points)	<u>0</u>
high water elevation of			
ground water)			

Wellhead Protection Area:	Yes	(20 points)	
(Less than 200 feet from a private	No	(0 points)	<u>0</u>
domestic water source, or; less than			
1000 feet from all other water sources)			

Distance To Surface Water:	Less than 200 feet	(20 points)	
(Horizontal distance to perennial	200 feet to 1,000 feet	(10 points)	
lakes, ponds, rivers, streams, creeks,	Greater than 1,000 feet	(0 points)	<u>0</u>
irrigation canals and ditches)			

Ranking Score (TOTAL POINTS): 0

Date Remediation Started: 9/16/99

Date Completed: 9/27/99

Remediation Method: Excavation ☒

Approx. Cubic Yard 36

(check all appropriate sections)

Landfarmed ☒

Insitu Bioremediation

Other Landfarmed soil after mechanical aeration. LF Headspace 7 ppm.

Remediation Location: Onsite ☒ Offsite

(ie. landfarmed onsite, name and location of offsite facility)

General Description Of Remedial Action:

The pit was excavated to remove gross petroleum contamination. The excavated material was mechanically aerated and placed into an onsite landfarm.

Ground Water Encountered: No

Final Pit:

Sample location SJ 32-7 #60-V-EXFL-01

Closure Sampling:

(if multiple samples, attach sample results and diagram of sample locations and depths)

Two samples were collected, one sample from the excavation bottom and the second sample was made up of 4 points from each excavation wall.

Sample depth 3 feet

Sample date 9/17/99

Sample time 9:42

Sample Result

Benzene (ppm) <0.05

Total BTEX (ppm) <0.05

Field Headspace (ppm)

TPH (ppm) 15

Ground Water Sample: No

I HEREBY CERTIFY THAT THE INFORMATION ABOVE IS TRUE AND COMPLETE TO THE BEST OF MY KNOWLEDGE AND BELIEF

DATE 12-20-99

SIGNATURE  (FOR WFS)

PRINTED NAME AND TITLE Mark Harvey for Williams Field Services

PIT RETIREMENT FORM

Date: 9-16-99
 Well Name: SJ 32-7 #60 Operator: PHILLIPS Sec: 20 T: 32N R: 7W UL:
 and Type: BLM STATE FEE INDIAN County: SAN JUAN
 Phone Call Made (505-765-1234)? (Y) N
 Phone Marking Evident? (Y) N

Weather: PTLY CLOUDY, WARM

Location:

Reference: Wellhead X Other:
 Distance from: 82
 Direction: 60 Degrees E N
 BRG = 240°

Starting Pit Dimensions

16 x 16 x 3

Final Pit Dimensions

19 x 17 x 3

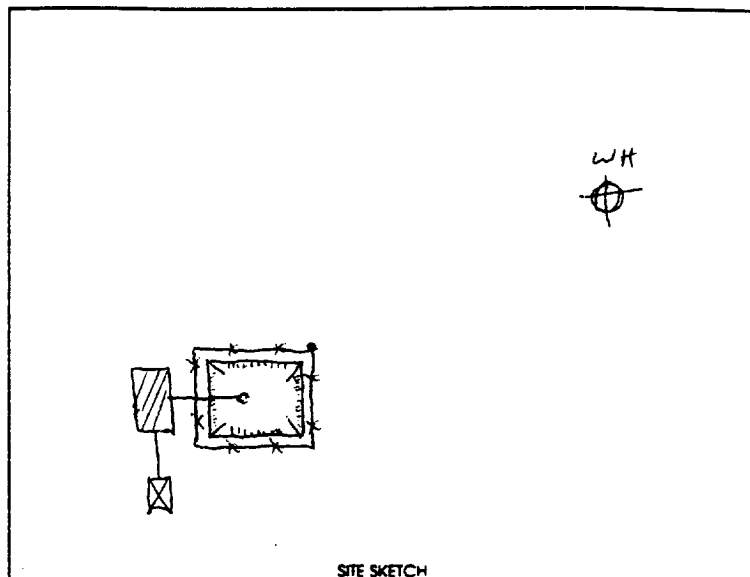

Organic Vapor Readings:

Start N/A

Soil Description:

@ 2'
 @ 4'
 @ 6'
 @ 8'
 @
 @

0-3' BRN CLAYEY SILT, MOD PLASTIC, TRC
OF SAND

3'+ GRAY SANDY SILTSTONE - WELL INDURATED

Well Proximity To:

Residence, Domestic Water Well, Stock Well NONE

Arroyo, Wash, Lake, Stream > 1000'

Estimated or Known Distance to Ground Water > 100'

Source of Backfill (If other than processed material)

Samples collected:

Type

Progress: Verification:

ID

SJ 32-7#60-V-EXFL-01

soil / water

Progress: Verification:

ID

SJ 32-7#60-V-EXFLA-01

soil / water

Progress: Verification:

ID

soil / water

Sample sent to Lab Via: Courier

Hand Carried

Other

Preservative:

ICE Other

Comments:

BEDROCK ENCOUNTERED @ 3' bgs.

WELL INDURATED, LATERALLY CONTINUOUS SILTSTONE /
SANDSTONE.

Soil Shipped to:

ON-SITE LANDFARM

Prepared by:

PS

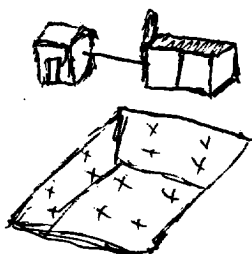

(pit sketch-show sample pts.)

QWAL LABORATORIES, INC.

2911 ROTARY TERRACE, P.O. BOX 562/PITTSBURG, KS 66762/(316)232-1970

LABORATORY REPORT:

REFERENCE #: 9909783

SENT WILLIAMS FIELD SERVICE
TO: 295 CHIPETA WAY
SALT LAKE CITY, UTAH 84158
MARK HARVEY

DATE REPORTED: 09/29/99
DATE COLLECTED: 09/17/99
DATE RECEIVED: 09/23/99

PROJECT: WFS/IGN-NM PITS

Reference Fraction: 9909783-26A
Sample ID: SJ32-7 #60-V-EXWA-01 85378
Sample Date Collected: 09/17/99 09:47:00

Sample Matrix: SOIL

TEST	METHOD	RESULT	UNITS	PQL	ANALYZED	BY
TPH-DRO	SW846-8015D	8	MG/KG	2	09/25/99	BEM
BTEX	OA1/8021B			3.0		
BENZENE		ND	MG/KG	0.050	09/28/99	KKL
TOLUENE		ND	MG/KG	0.050	09/28/99	KKL
ETHYLBENZENE		ND	MG/KG	0.050	09/28/99	KKL
TOTAL XYLENES		ND	MG/KG	0.050	09/28/99	KKL
BFB (SURROGATE)		76	125	75		
QA/QC PACKAGE LEVEL	NONE		SU			

ND=NONE DETECTED
PQL=PRACTICAL QUANTITAION LIMIT
SU=STANDARD UNITS
B=DETECTED IN METHOD BLANK

APPROVED BY:

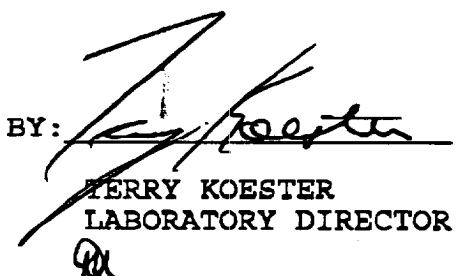
TERRY KOESTER
LABORATORY DIRECTOR

QWAL LABORATORIES, INC.

2911 ROTARY TERRACE, P.O. BOX 562/PITTSBURG, KS 66762/(316)232-1970

LABORATORY REPORT:

REFERENCE #: 9909783

SENT WILLIAMS FIELD SERVICE
TO: 295 CHIPETA WAY
SALT LAKE CITY, UTAH 84158
MARK HARVEY
PROJECT: WFS/IGN-NM PITS

DATE REPORTED: 09/29/99
DATE COLLECTED: 09/17/99
DATE RECEIVED: 09/23/99

Reference Fraction: 9909783-25A 85378
Sample ID: SJ32-7 #60-V-EXFL-01
Sample Date Collected: 09/17/9909:42:00

Sample Matrix: SOIL

TEST	METHOD	RESULT	UNITS	PQL	ANALYZED	BY
TPH-DRO	SW846-8015D	15	MG/KG	2	09/25/99	BEM
BTEX	OA1/8021B			3.0		
BENZENE		ND	MG/KG	0.050	09/28/99	KKL
TOLUENE		ND	MG/KG	0.050	09/28/99	KKL
ETHYLBENZENE		ND	MG/KG	0.050	09/28/99	KKL
TOTAL XYLENES		ND	MG/KG	0.050	09/28/99	KKL
BFB (SURROGATE)		85	125	75		
QA/QC PACKAGE LEVEL	NONE		SU			

ND=NONE DETECTED

PQL=PRACTICAL QUANTITATION LIMIT

SU=STANDARD UNITS

B=DETECTED IN METHOD BLANK

APPROVED BY:

TERRY KOESTER
LABORATORY DIRECTOR

QA

Q W A L L A B O R A T O R I E S , I N C .

2911 ROTARY TERRACE, P.O. BOX 562/PITTSBURG, KS 66762/(316)232-1970

LABORATORY REPORT:

REFERENCE #: 9909913

SENT WILLIAMS FIELD SERVICE
TO: 295 CHIPETA WAY
SALT LAKE CITY, UTAH 84158
MARK HARVEY
PROJECT: WFS/IGW/NM PITS

DATE REPORTED: 09/29/99
DATE COLLECTED: 09/27/99
DATE RECEIVED: 09/28/99

Reference Fraction: 9909913-06A
Sample ID: SJ32-7#60-V-LF-01
Sample Date Collected: 09/27/99 13:30:00

Sample Matrix: SOIL

TEST	METHOD	RESULT	UNITS	PQL	ANALYZED BY
QA/QC PACKAGE LEVEL	NONE	DONE	SU		
TOTAL PETROLEUM HYDR	EPA 418.1	347	MG/KG	10.0	09/29/99 BEM

ND=NONE DETECTED
PQL=PRACTICAL QUANTITATION LIMIT
SU=STANDARD UNITS
B=DETECTED IN METHOD BLANK

APPROVED BY: _____

TERRY KOESTER
LABORATORY DIRECTOR