

**NEW MEXICO OIL CONSERVATION COMMISSION
WELL LOCATION AND ACREAGE DEDICATION PLAT**

Form C-102
Supersedes C-128
Effective 1-1-65

All distances must be from the outer boundaries of the Section.

Operator EL PASO NATURAL GAS COMPANY			Lease FIELDS (NM 010989)		Well No. AUG 31 1979
Unit Letter N	Section 28	Township 32N	Range 11W	County San Juan	
Actual Footage Location of Well: 910 feet from the South line and 1400 feet from the West line					
Ground Level Elev: 6463	Producing Formation Pictured Cliffs		Pool: Blanco Pictured Cliffs		Dedicated Acreage: 160.00 Acres

1. Outline the acreage dedicated to the subject well by colored pencil or hachure marks on the plat below.
2. If more than one lease is dedicated to the well, outline each and identify the ownership thereof (both as to working interest and royalty).
3. If more than one lease of different ownership is dedicated to the well, have the interests of all owners been consolidated by communitization, unitization, force-pooling, etc?

☐ Yes ☐ No If answer is "yes," type of consolidation _____

If answer is "no," list the owners and tract descriptions which have actually been consolidated. (Use reverse side of this form if necessary.) _____

No allowable will be assigned to the well until all interests have been consolidated (by communitization, unitization, forced-pooling, or otherwise) or until a non-standard unit, eliminating such interests, has been approved by the Commission. Note: Plat reissued to show formation change from a dual well to Pictured Cliffs 8/27/79

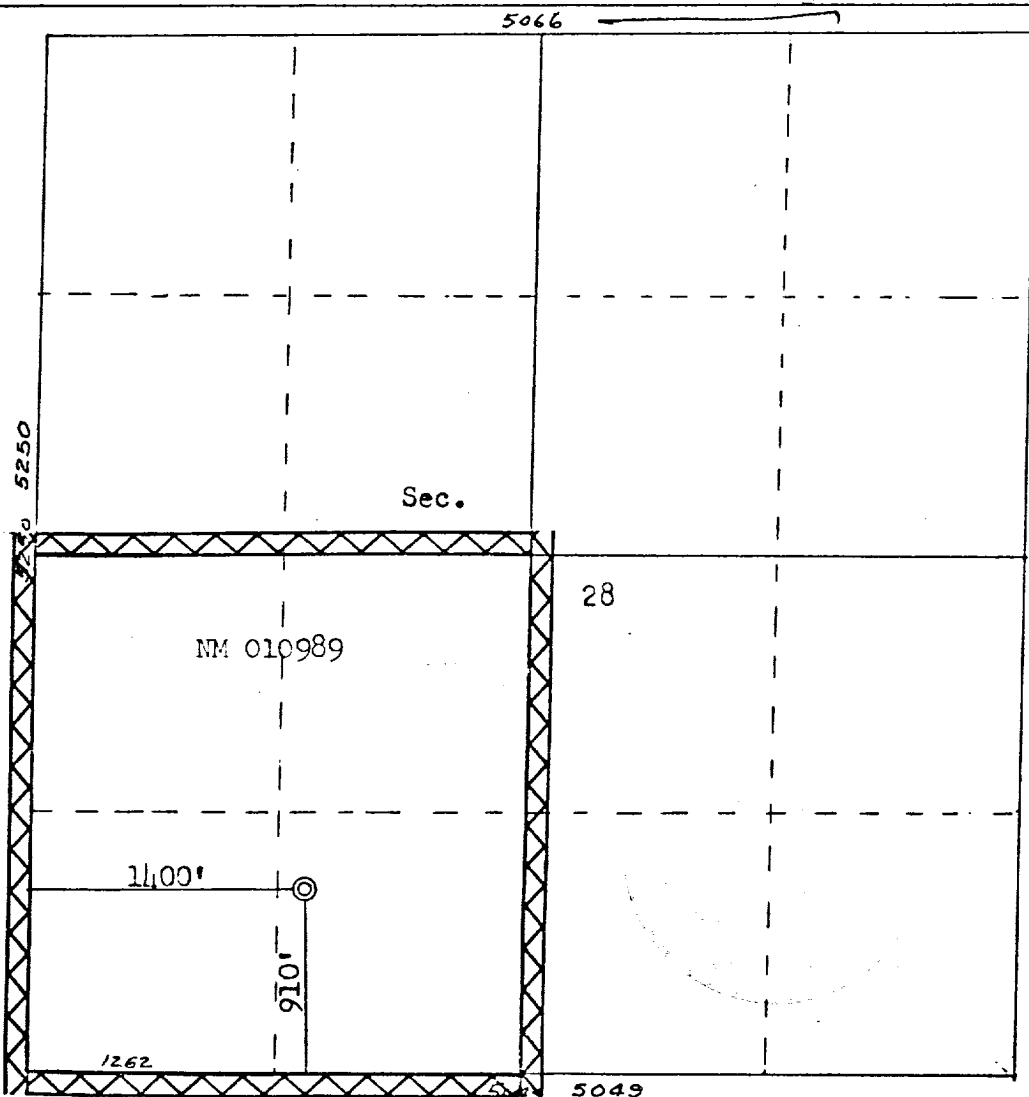

CERTIFICATION

I hereby certify that the information contained herein is true and complete to the best of my knowledge and belief.

A. J. Buices

Name
Drilling Clerk

Position
El Paso Natural Gas Co.

Company
August 31, 1979

Date

I hereby certify that the well location shown on this plat was plotted from field notes of actual surveys made by me or under my supervision, and that the same is true and correct to the best of my knowledge and belief.

Date Surveyed
July 25, 1979

Registered Professional Engineer and Land Surveyor
Fred B. Kerr Jr.

Certificate No.
3950