

District I _____
 P.O. Box 1980, Hobbs, NM
 District II _____
 P.O. Drawer, Artesia, NM 88211
 District III _____
 1000 Rio Brazos Rd. Aztec, NM 87410

State Of New Mexico
 Energy, Minerals and Natural Resources Department

OIL CONSERVATION DIVISION
 P.O. Box 2088
 Santa Fe, New Mexico 87504-2088

RECEIVED
 JUL - 9 1999
 OIL CON. DIV.
 DIST. 3
 (Revised 3/9/94)

84
 DISTRICT OFFICE
 AND 1 COPY TO
 STATE OFFICE

PIT REMEDIATION AND CLOSURE REPORT

Operator:	<u>Conoco Inc.</u>	Telephone:	<u>505-324-5813</u>
Address:	<u>3315 Bloomfield Hwy - Farmington, NM 87401</u>		
Facility Or:	<u>Newberry LS 3A</u>		
Well Name			
Location:	Unit or Qtr/Qtr Sec	<u>0</u> Sec <u>8</u> T <u>31N</u> R <u>12</u> County	
Pit Type:	Separator _____	Dehydrator _____	Other <u>CSP</u>
Land Type:	BLM _____ State <u>X</u> Fee _____	Other _____	
Pit Location: (Attach diagram)	Pit dimension:	length <u>12'</u>	width <u>10'</u> depth <u>3'</u>
	Reference:	wellhead <u>X</u>	other _____
	Footage from reference:	<u>87'</u>	
	Direction from reference:	<u>46</u> Degrees <u>X</u> East of <u>X</u> North _____ West _____ South	

Depth To Ground Water: (Vertical distance from contaminants to seasonal high water elevation of ground water)	Less than 50 feet 50 feet to 9 feet Greater than 100 feet	(20 points) (10 points) (0 points)	
	Total		<u>0</u>
Wellhead Protection Area: (Less than 200 feet from a private domestic water source, or; less than 1000 feet from all other water sources)	Yes (20 points) No (0 points)		
	Total		<u>0</u>
Distance To Surface Water: (Horizontal distance to perennial lakes, ponds, rivers, streams, creeks, irrigation canals and ditches)	Less than 200 feet 200 feet to 1000 feet Greater than 1000 feet	(20 points) (10 points) (0 points)	(20 points) (10 points) (0 points)
	Total		<u>0</u>
	RANKING SCORE (TOTAL POINTS):		<u>0</u>

Date Remediation Started: _____		Date Completed: _____	
Remediation Method: _____		Approx. cubic yards _____	
(Check all appropriate sections)			
Excavation: _____		Insitu Bioremediation _____	
Landfarm _____			
Other _____			
Remediation Location: _____		Onsite _____ Offsite _____	
(ie. landfarmed onsite, name and location of offsite facility)			
General Description Of Remedial Action: _____		haul off water -- sample center of pit -- back fill clean dirt	
Ground Water Encountered: _____		No <input checked="" type="checkbox"/> Yes _____ Depth _____	
Final Pit: _____		Sample location _____ center of pit -- 3' in from bottom of pit	
Closure Sampling: _____			
(if multiple samples attach sample results and diagram of sample locations and depths)		Sample depth _____ 3'	
		Sample date _____ 4/12/99 Sample time _____ 10:14	
		Sample Results	
		Benzene (ppm) _____ 0.17	
		Total BTEX (ppm) _____ 1.6	
		Field headspace (ppm) _____ 325	
		TPH _____ 354	
Ground Water Sample: _____		Yes _____ No <input checked="" type="checkbox"/> (If yes, attach sample results)	
I HEREBY CERTIFY THAT THE INFORMATION ABOVE IS TRUE AND COMPLETE TO THE BEST OF MY KNOWLEDGE AND BELIEF			
DATE _____ 6-28-99		PRINTED NAME _____	
SIGNATURE _____ <i>John Walsh</i>		AND TITLE _____ P.L.	

Revised

Lease Name: Newberry LS 3A

Operator: Conoco Inc.

Date:

4-7-99

Site Security

(Indicate North)

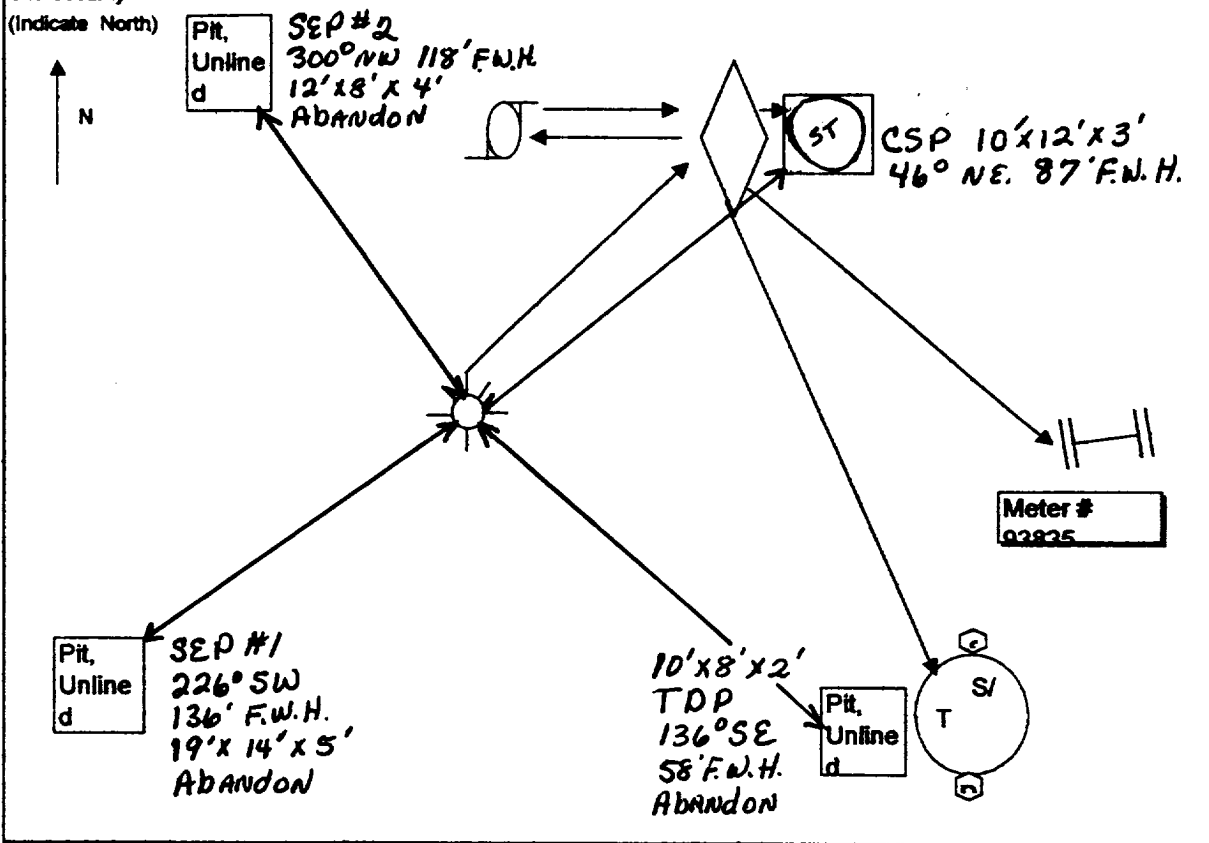

Lease Name: Newberry LS 3A

Federal/ Indian Lease No: SF-078146

CA No.:

Unit: 0

Legal Description: Sec. 8-T31N-R12W

County: San Juan

Load line valves :
Sealed during Production

Drain line valves :
Sealed during Production

Production Line valve:
Sealed during sales

This lease is subject to the site security plan for
San Juan Basin Operations. The plan is located at:
Conoco Inc.
3315 Bloomfield Hwy
Farmington, NM

NEWBERRY LS 3A

4-7-99

SEP #1
226° SW 136' From W.H.

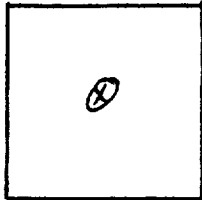

Time
1018
414 ppm

SEP #2
300° NW 118' From W.H.

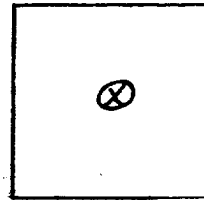

Time
1022
864
ppm

+ > 2

TDP
136° SE 58' From W.H.

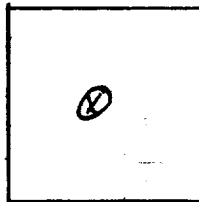

Time
1018
118 ppm

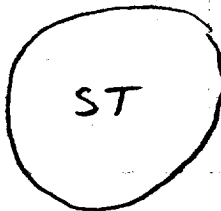

CROP
340° NE 87' From W.H.

SEP/DHP

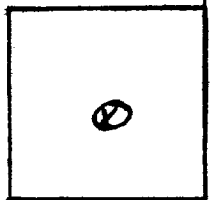

② sample taken

CHAIN OF CUSTODY RECORD

6795

Client / Project Name			Project Location			ANALYSIS / PARAMETERS													
Conoco Inc.			Newberry LS 3A																
Sampler: J. Valdez			Client No. 97070-03			Remarks													
Sample No./ Identification	Sample Date	Sample Time	Lab Number	Sample Matrix	No. of Containers	BTex	8021	TPH	8015	OVM	READING								
ESP - Grab	4.12.99	1014	F036	Soil	1	✓	✓	325	Middle of AT Grab Sample										
Relinquished by: (Signature) <i>Paul Valdez</i>			Date 4.15.99			Time 17:23			Received by: (Signature) <i>M. David D. Young</i>			Date 4/15/99	Time 17:23						
Relinquished by: (Signature)									Received by: (Signature)										
Relinquished by: (Signature)									Received by: (Signature)										
<div style="text-align: center;"> ENVIROTECH INC. 5796 U.S. Highway 64 Farmington, New Mexico 87401 (505) 632-0615 </div>																			
<div style="text-align: center;"> Sample Receipt </div> <table border="1" style="width: 100%;"> <tr> <td>Received Intact</td> <td>Y</td> <td>N</td> <td>N/A</td> </tr> <tr> <td>Cool - Ice/Blue Ice</td> <td>✓</td> <td></td> <td></td> </tr> </table>												Received Intact	Y	N	N/A	Cool - Ice/Blue Ice	✓		
Received Intact	Y	N	N/A																
Cool - Ice/Blue Ice	✓																		

ENVIROTECH LABS

PRACTICAL SOLUTIONS FOR A BETTER TOMORROW

EPA METHOD 8021 AROMATIC VOLATILE ORGANICS

Client:	Conoco Inc.	Project #:	707003
Sample ID:	CSF - Grab	Date Reported:	04-17-99
Laboratory Number:	F036	Date Sampled:	04-12-99
Chain of Custody:	6795	Date Received:	04-15-99
Sample Matrix:	Soil	Date Analyzed:	04-16-99
Preservative:	Cool	Date Extracted:	04-16-99
Condition:	Cool & Intact	Analysis Requested:	BTEX

Parameter	Concentration (ug/Kg)	Det. Limit (ug/Kg)
Benzene	ND	8.8
Toluene	170	8.4
Ethylbenzene	51.1	7.6
p,m-Xylene	1,110	10.8
o-Xylene	296	5.2
Total BTEX	1,630	

ND - Parameter not detected at the stated detection limit.

Surrogate Recoveries:	Parameter	Percent Recovery
	Trifluorotoluene	97 %
	Bromofluorobenzene	97 %

References: Method 5030B, Purge-and-Trap, Test Methods for Evaluating Solid Waste, SW-846, USEPA, December 1996.

Method 8021B, Aromatic Volatile Organics, Test Methods for Evaluating Solid Waste, SW-846, USEPA, December 1996.

Comments: Newberry LS 3A Middle of Pit Grab Sample. OVM Reading 325.

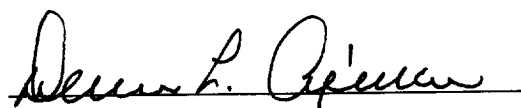
Analyst

Review

ENVIROTECH LABS

PRACTICAL SOLUTIONS FOR A BETTER TOMORROW

EPA METHOD 8015 Modified Nonhalogenated Volatile Organics Total Petroleum Hydrocarbons

Client:	Conoco Inc.	Project #:	707003
Sample ID:	ESP - Grab	Date Reported:	04-16-99
Laboratory Number:	F036	Date Sampled:	04-12-99
Chain of Custody No:	6795	Date Received:	04-15-99
Sample Matrix:	Soil	Date Extracted:	04-16-99
Preservative:	Cool	Date Analyzed:	04-16-99
Condition:	Cool and Intact	Analysis Requested:	8015 TPH

Parameter	Concentration (mg/Kg)	Det. Limit (mg/Kg)
Gasoline Range (C5 - C10)	354	0.2
Diesel Range (C10 - C28)	ND	0.1
Total Petroleum Hydrocarbons	354	0.2

ND - Parameter not detected at the stated detection limit.

References: Method 8015B, Nonhalogenated Volatile Organics, Test Methods for Evaluating Solid Waste, SW-846, USEPA, December 1996.

Comments: **Newberry LS 3 A Middle of Pit Grab Sample. OVM Reading 325.**

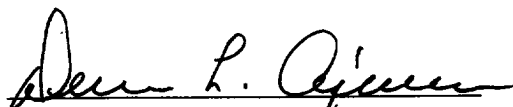
Analyst

Review