

NO. OF COPIES RECEIVED	5
DISTRIBUTION	
SANTA FE	1
FILE	
U.S.G.S.	2
LAND OFFICE	
OPERATOR	1

NEW MEXICO OIL CONSERVATION COMMISSION

30-045-23791
Form C-101
Revised 1-1-65

5A. Indicate Type of Lease	
STATE <input type="checkbox"/>	FEE <input checked="" type="checkbox"/>
5. State Oil & Gas Lease No.	

APPLICATION FOR PERMIT TO DRILL, DEEPEN, OR PLUG BACK

1a. Type of Work		7. Unit Agreement Name	
b. Type of Well OIL WELL <input type="checkbox"/> GAS WELL <input checked="" type="checkbox"/> OTHER <input type="checkbox"/>		8. Farm or Lease Name Landauer	
2. Name of Operator Consolidated Oil & Gas, Inc.		9. Well No. 1-M	
3. Address of Operator 1860 Lincoln Street, Suite 1300, Denver, Colorado 80295		10. Field and Pool, or Wildcat Mesaverde/Dakota	
4. Location of Well UNIT LETTER "I" LOCATED 680 FEET FROM THE East LINE AND 2255 FEET FROM THE South LINE OF SEC. 3 TWP. 31N RGE. 13W NMRM		12. County San Juan	
19. Proposed Depth 6870'		19A. Formation Dakota	
21. Elevations (Show whether DP, RT, etc.) 5742' GL		20. Rotary or C.T. Rotary	
21A. Kind & Status Plug Bond Blanket/Inforce		22. Approx. Date Work will start July 1, 1979	

PROPOSED CASING AND CEMENT PROGRAM

SIZE OF HOLE	SIZE OF CASING	WEIGHT PER FOOT	SETTING DEPTH	SACKS OF CEMENT	EST. TOP
12-1/4"	8-5/8"	24.0#	250'	200 sx	Surface
7-7/8"	5-1/2"	15.5#	6870'	500 sx	2000'

1. Drill 12-1/4" hole to \pm 250'. Set 8-5/8" casing. Circulate cement to surface.
 2. WOC 12 hours.
 3. Install blowout preventer. Pressure test surface casing & BOP's to 1000 psig.
 4. Drill 7-7/8" hole to \pm 6870' with fresh water gel mud. Log.
 5. Run 5-1/2" casing and cement same with approximately 500 sx in 2 stages.
 6. Selectively perforate and stimulate the Mesaverde and Dakota formations and complete per applicable rules and regulations.
- The E/2 of Section 3 is dedicated to this well and the acreage is committed to a gas sales contract.

IN ABOVE SPACE DESCRIBE PROPOSED PROGRAM: IF PROPOSAL IS TO DEEPEN OR PLUG BACK, GIVE DATA ON PRESENT PRODUCTIVE ZONE AND PROPOSED NEW PRODUCTIVE ZONE. GIVE BLOWOUT PREVENTER PROGRAM, IF ANY.

I hereby certify that the information above is true and complete to the best of my knowledge and belief.

Signed C.M. Pugh Title Sr. Production Engr. Date 7-24-79

(This space for State Use)

APPROVED BY Frank S. Chang TITLE State Engineer DATE SEP 11 1979

CONDITIONS OF APPROVAL, IF ANY:

NSL-1045

NEW MEXICO OIL CONSERVATION COMMISSION
WE LOCATION AND ACREAGE DEDICATION PLAT

Form O-10
Supersedes C
Effective 1-1-77

All distances must be from the outer boundaries of the Section.

Operator CONSOLIDATED OIL AND GAS, INC.			Lease LANDAUER		Well No. 1 - M
Unit Letter I	Section 3	Township 31 NORTH	Range 13 WEST	County SAN JUAN	
Actual Footage Location of Well: <div style="display: flex; justify-content: space-between;"> 2255 feet from the SOUTH line and 680 feet from the EAST line </div>					
Ground Level Elev. 5742	Producing Formation Mesaverde	Pool Blanco Mesaverde		Dedicated Acreage: 320.00 Ac	

1. Outline the acreage dedicated to the subject well by colored pencil or hatchure marks on the plat below.
2. If more than one lease is dedicated to the well, outline each and identify the ownership thereof (both as to working interest and royalty).
3. If more than one lease of different ownership is dedicated to the well, have the interests of all owners been consolidated by communitization, unitization, force-pooling, etc?

☒ Yes ☐ No If answer is "yes," type of consolidation communitization

If answer is "no," list the owners and tract descriptions which have actually been consolidated. (Use reverse side this form if necessary.)

No allowable will be assigned to the well until all interests have been consolidated (by communitization, unitization, forced-pooling, or otherwise) or until a non-standard unit, eliminating such interests, has been approved by the Commission.

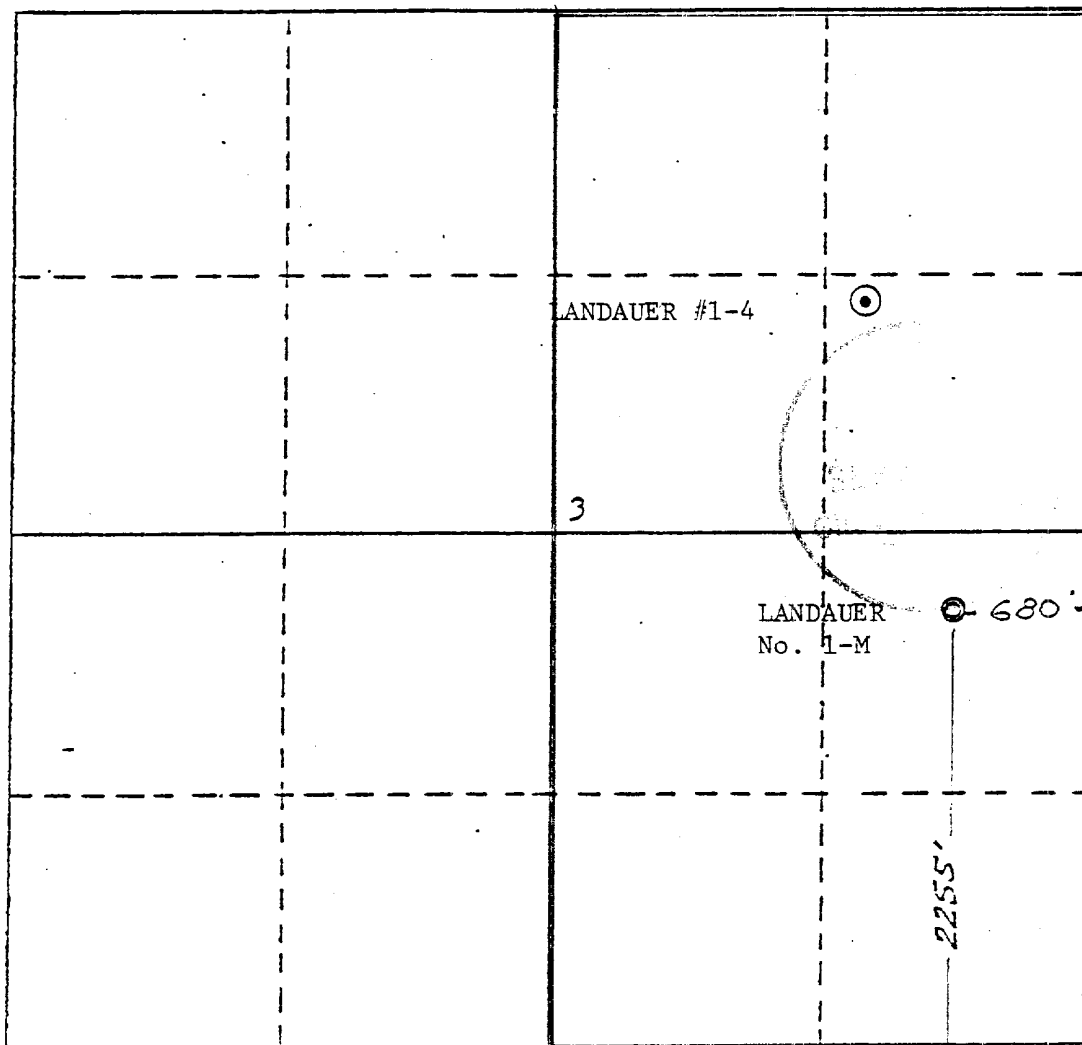

CERTIFICATION

I hereby certify that the information contained herein is true and complete to the best of my knowledge and belief.

C. M. Parham
Name

C. M. Parham

Position

Senior Production Engr

Company

Consolidated Oil & Gas

Date

INC

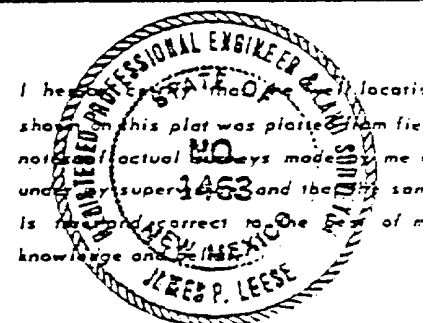

Date Surveyed

24 February 1979

Registered Professional Engineer
and/or Land Surveyor

James P. Leese
James P. Leese

Certification No.

1463

NEW MEXICO OIL CONSERVATION COMMISSION
WELL LOCATION AND ACREAGE DEDICATION PLAT

Form C-102
Supersedes C-1
Effective 1-1-6

All distances must be from the outer boundaries of the Section.

Operator CONSOLIDATED OIL AND GAS, INC.			Lease LANDAUER		Well No. 1 - M
Unit Letter I	Section 3	Township 31 NORTH	Range 13 WEST	County SAN JUAN	
Actual Footage Location of Well: <div style="display: flex; justify-content: space-between;"> 2255 feet from the SOUTH line and 680 feet from the EAST line </div>					
Ground Level Elev. 5742	Producing Formation Dakota	Pool Basin Dakota		Dedicated Acreage: 320.00 Acres	

1. Outline the acreage dedicated to the subject well by colored pencil or hatchure marks on the plat below.
2. If more than one lease is dedicated to the well, outline each and identify the ownership thereof (both as to working interest and royalty).
3. If more than one lease of different ownership is dedicated to the well, have the interests of all owners been consolidated by communitization, unitization, force-pooling, etc?

☒ Yes ☐ No If answer is "yes," type of consolidation communitization

If answer is "no," list the owners and tract descriptions which have actually been consolidated. (Use reverse side of this form if necessary.) _____

No allowable will be assigned to the well until all interests have been consolidated (by communitization, unitization, forced-pooling, or otherwise) or until a non-standard unit, eliminating such interests, has been approved by the Commission.

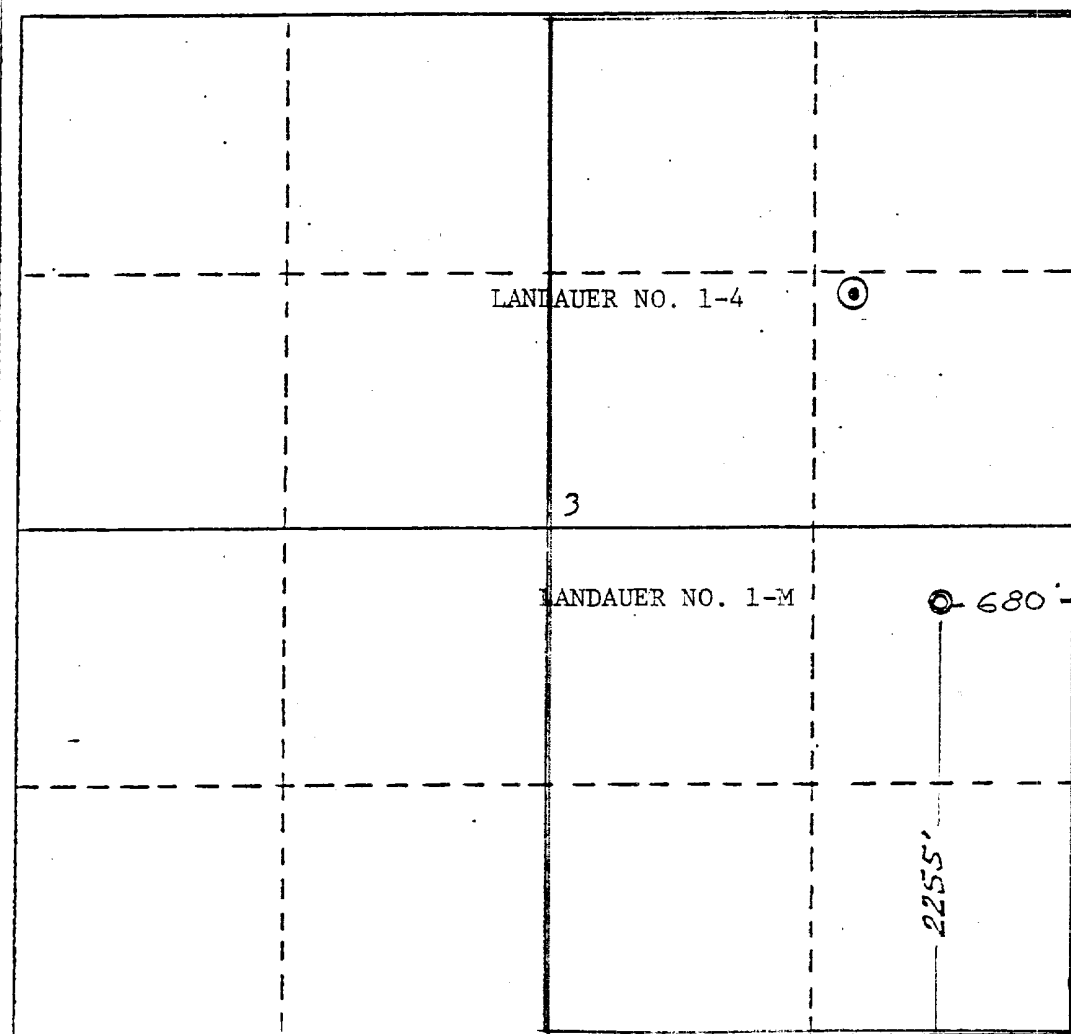

CERTIFICATION

I hereby certify that the information contained herein is true and complete to the best of my knowledge and belief.

C. M. Parham

Name
C. M. Parham
Position
Senior Production Engr
Company
Consolidated Oil & Gas
Date
Inc

I hereby certify that the location shown on this plat was plotted from field notes of actual surveys made by me or under my supervision and that the same is true and correct to the best of my knowledge and belief.

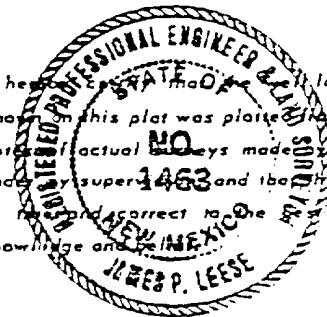

Date Surveyed
24 February 1979

Registered Professional Engineer
and/or Land Surveyor

James P. Lease
James P. Lease

Certificate No.

1463

