

NO. OF COPIES RECEIVED	6
DISTRIBUTION	
SANTA FE	1
FILE	
U.S.G.S.	2
LAND OFFICE	
OPERATOR	2

# NEW MEXICO OIL CONSERVATION COMMISSION

30-045-23834  
Form C-101  
Revised 1-1-65

5A. Indicate Type of Lease
STATE <input type="checkbox"/> FEE <input checked="" type="checkbox"/>
5. State Oil & Gas Lease No.

## APPLICATION FOR PERMIT TO DRILL, DEEPEN, OR PLUG BACK

1a. Type of Work		7. Unit Agreement Name	
DRILL <input checked="" type="checkbox"/> DEEPEN <input type="checkbox"/> PLUG BACK <input type="checkbox"/>		San Juan 32-7 Unit	
b. Type of Well		8. Farm or Lease Name	
OIL WELL <input type="checkbox"/> GAS WELL <input checked="" type="checkbox"/> OTHER <input type="checkbox"/> SINGLE ZONE <input type="checkbox"/> MULTIPLE ZONE <input type="checkbox"/>		San Juan 32-7 Unit	
2. Name of Operator		9. Well No.	
Northwest Pipeline Corporation		55	
3. Address of Operator		10. Field and Pool, or Wildcat	
P.O. Box 90 - Farmington, New Mexico 87401		Basin Dakota	
4. Location of Well		12. County	
UNIT LETTER <u>K</u> LOCATED <u>1770'</u> FEET FROM THE <u>South</u> LINE		San Juan	
AND <u>1830'</u> FEET FROM THE <u>West</u> LINE OF SEC. <u>7</u> TWP. <u>32N</u> RGE. <u>7W</u> NMPM			
		19. Proposed Depth	
		8100'	
		19A. Formation	
		Dakota	
		20. Rotary or C.T.	
		Rotary	
21. Elevations (Show whether DF, RT, etc.)		22. Approx. Date Work will start	
6515' GR		Sept. 1, 1979	

## PROPOSED CASING AND CEMENT PROGRAM

SIZE OF HOLE	SIZE OF CASING	WEIGHT PER FOOT	SETTING DEPTH	SACKS OF CEMENT	EST. TOP
12 1/4"	9 5/8"	32.3#	350'	125 sks.	
8 3/4"	7"	20#	3800'	100 sks.	
6 1/4"	4 1/2"	10.5#	8100'	210 sks.	

Selectively perforate and stimulate the Dakota Formation.

A BOP will be installed after the surface casing is cemented. All subsequent operations will be conducted through the BOPs.

Gas is dedicated.

The West half of Section 7 is dedicated to this well.



IN ABOVE SPACE DESCRIBE PROPOSED PROGRAM: IF PROPOSAL IS TO DEEPEN OR PLUG BACK, GIVE DATA ON PRESENT PRODUCTIVE ZONE AND PROPOSED NEW PRODUCTIVE ZONE. GIVE BLOWOUT PREVENTER PROGRAM, IF ANY.

I hereby certify that the information above is true and complete to the best of my knowledge and belief.

Signed M. Turnbaugh Title Assoc. Drilling Engineer Date 8/3/79  
M. Turnbaugh  
(This space for State Use)

APPROVED BY Frank J. Chang TITLE DEPUTY OIL & GAS INSPECTOR, DIST. #3 DATE SEP 21 1979

CONDITIONS OF APPROVAL, IF ANY:

ch  
NWU R-2046

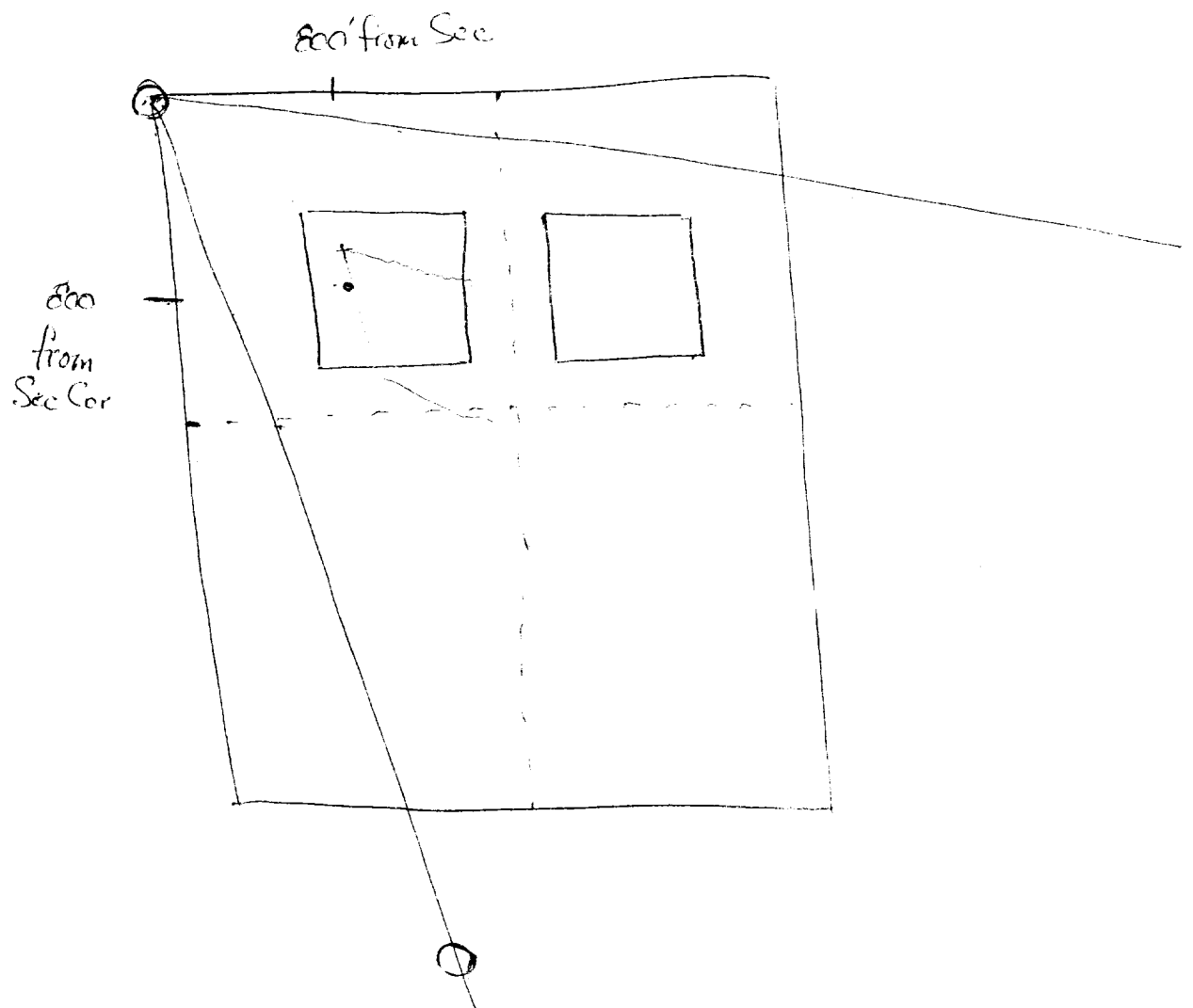

NEW MEXICO OIL CONSERVATION COMMISSION  
WELL LOCATION AND ACREAGE DEDICATION PLAT

Form C-102  
Supersedes C-128  
Effective 1-1-65

All distances must be from the outer boundaries of the Section.

Operator <b>NORTHWEST PIPELINE CORPORATION</b>			Lease <b>SAN JUAN 32-7 UNIT</b>		Well No. <b>55</b>
Unit Letter <b>K</b>	Section <b>7</b>	Township <b>32N</b>	Range <b>7W</b>	County <b>San Juan</b>	
Actual Footage Location of Well: <b>1770</b> feet from the <b>South</b> line and <b>1830</b> feet from the <b>West</b> line					
Ground Level Elev. <b>6515</b>	Producing Formation		Pool <b>Basin</b>	Dedicated Acreage: <b>293.10</b> Acres	

1. Outline the acreage dedicated to the subject well by colored pencil or hachure marks on the plat below.
2. If more than one lease is dedicated to the well, outline each and identify the ownership thereof (both as to working interest and royalty).
3. If more than one lease of different ownership is dedicated to the well, have the interests of all owners been consolidated by communitization, unitization, force-pooling, etc?

☒ Yes ☐ No If answer is "yes," type of consolidation unitization

If answer is "no," list the owners and tract descriptions which have actually been consolidated. (Use reverse side of this form if necessary.)

No allowable will be assigned to the well until all interests have been consolidated (by communitization, unitization, forced-pooling, or otherwise) or until a non-standard unit, eliminating such interests, has been approved by the Commission.

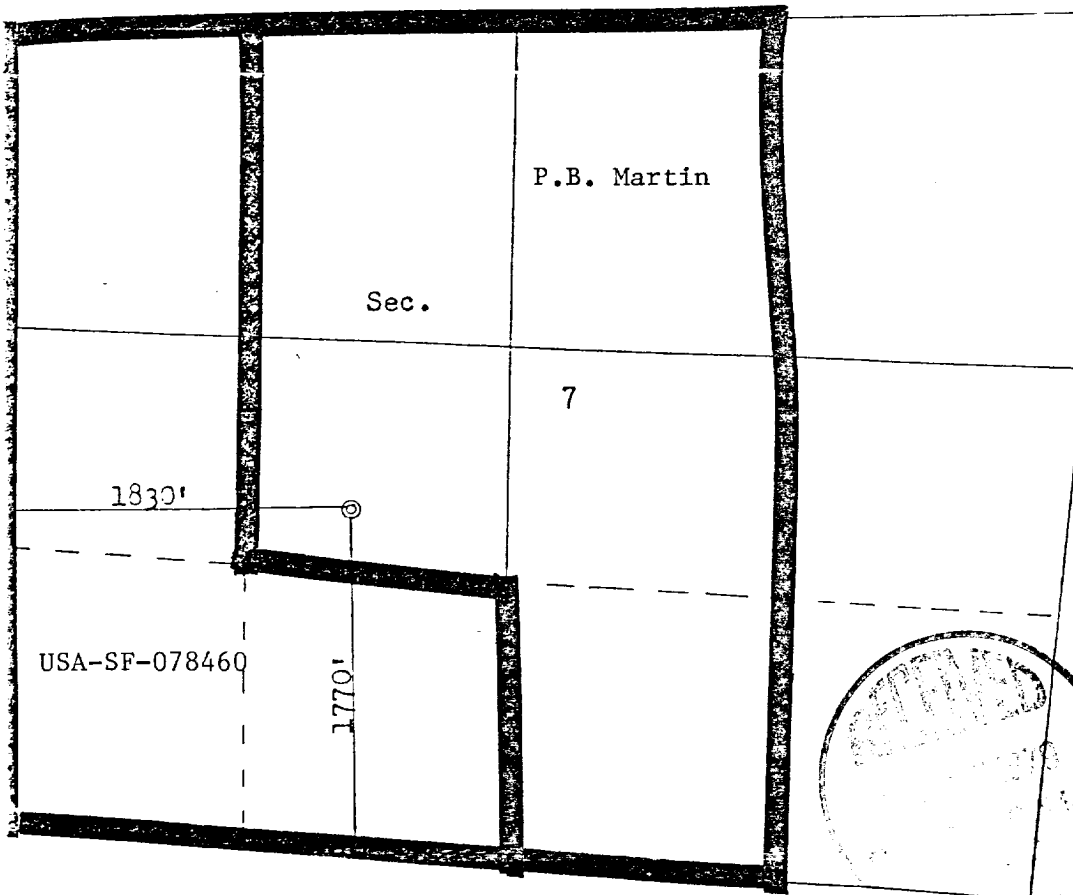

CERTIFICATION

I hereby certify that the information contained herein is true and complete to the best of my knowledge and belief.

**M. Turnbaugh**

Name

**Assoc. Drilling Engineer**

Position

**Northwest Pipeline Corp.**

Company

**August 16th, 1979**

Date

*M. Turnbaugh*

I hereby certify that the well location shown on this plat was plotted from field notes of actual surveys made by me or under my supervision, and that the same is true and correct to the best of my knowledge and belief.

Date Surveyed

**Released August 15, 1979**

Registered Professional Engineer and Land Surveyor

*Fred R. ...*

Certified

**3950**

4453  
LIFE

LIFE

