

NO. OF COPIES RECEIVED	6
DISTRIBUTION	
SANTA FE	1
FILE	2
U.S.G.S.	2
LAND OFFICE	
OPERATOR	2

# NEW MEXICO OIL CONSERVATION COMMISSION

30-045-23943  
Form C-101  
Revised 1-1-65

5A. Indicate Type of Lease	
STATE <input type="checkbox"/>	FEE <input checked="" type="checkbox"/>
5. State Oil & Gas Lease No.	
Communitized W/SF080517	

## APPLICATION FOR PERMIT TO DRILL, DEEPEN, OR PLUG BACK

1a. Type of Work		7. Unit Agreement Name	
b. Type of Well OIL WELL <input type="checkbox"/> GAS WELL <input checked="" type="checkbox"/> OTHER <input type="checkbox"/>		8. Farm or Lease Name	
DRILL <input checked="" type="checkbox"/> DEEPEN <input type="checkbox"/> PLUG BACK <input type="checkbox"/>		Payne	
2. Name of Operator		9. Well No.	
Supron Energy Corporation		3-A	
3. Address of Operator		10. Field and Pool, or Wildcat	
P.O. Box 808, Farmington, New Mexico 87401		Basin Dakota Blanco Mesaverde	
4. Location of Well		12. County	
UNIT LETTER D LOCATED 790 FEET FROM THE North LINE		San Juan	
AND 980 FEET FROM THE West LINE OF SEC. 20 TWP. 32-N RGE. 10-W NMPM			
19. Proposed Depth		19A. Formation	
7713		Dakota Mesaverde	
20. Rotary or C.T.		Rotary	
21. Elevations (Show whether DF, RT, etc.)		22. Approx. Date Work will start	
6085 GR		1-25-80	
21A. Kind & Status Plug. Bond		21B. Drilling Contractor	
Current \$50,000. Blancet		Brinkerhoff	

## PROPOSED CASING AND CEMENT PROGRAM

SIZE OF HOLE	SIZE OF CASING	WEIGHT PER FOOT	SETTING DEPTH	SACKS OF CEMENT	EST. TOP
13-3/4"	10-3/4"	32.75#	250	200 Sx.	Surface
9-7/8"	7-5/8"	26.40#	3150	200 Sx.	1800
6-3/4"	5-1/2"	15.50#	7713	500 Sx.	Circ. Liner

We propose to drill this well through the Pictured Cliffs to an intermediate depth of approximately 3150 ft. with mud and run 7-5/8" casing. We will then drill through the Dakota to approximately 7713 ft. using air or natural gas and run a 5-1/2" liner from about 3000 ft. to about 7713 ft. The Dakota zone will be perforated and frac'd. and a bridge plug set below the Mesaverde. The Mesaverde will be perforated and frac'd. The bridge plug will be removed and a packer set between the Mesaverde and Dakota zones. Tubing will be run to both zones.

This lease is in the process of being communitized.

The well will be drilled on acreage dedicated to a gas transporter.

IN ABOVE SPACE DESCRIBE PROPOSED PROGRAM: IF PROPOSAL IS TO DEEPEN OR PLUG BACK, GIVE DATA ON PRESENT PRODUCTIVE ZONE AND PROPOSED NEW PRODUCTIVE ZONE. GIVE BLOWOUT PREVENTER PROGRAM, IF ANY.

I hereby certify that the information above is true and complete to the best of my knowledge and belief.

Signed Rudy D. Morro Title Area Superintendent Date October 31, 1979

(This space for State Use)

APPROVED BY Frank J. Chang TITLE DEPUTY OIL CON. COM. DIST. 3 DATE NOV 2 1979

CONDITIONS OF APPROVAL, IF ANY:

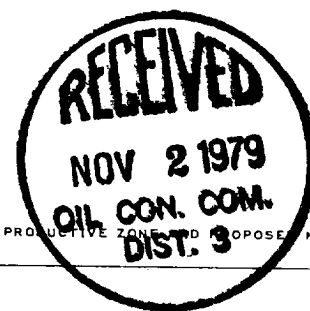

NEW MEXICO OIL CONSERVATION COMMISSION  
WELL LOCATION AND ACREAGE DEDICATION PLAT

Form C-102  
Supersedes C-128  
Effective 1-1-65

All distances must be from the outer boundaries of the Section.

Operator <b>SUPRON ENERGY CORPORATION</b>			Lease <b>PAYNE</b>		Well No. <b>3-A</b>
Unit Letter <b>D</b>	Section <b>20</b>	Township <b>32 NORTH</b>	Range <b>10 WEST</b>	County <b>SAN JUAN</b>	
Actual Footage Location of Well: <b>790</b> feet from the <b>NORTH</b> line and <b>980</b> feet from the <b>WEST</b> line					
Ground Level Elev. <b>6085</b>	Producing Formation <b>ME SAVERDE</b> <b>DAKOTA</b>	Pool <b>BLANCO</b> <b>BASIN</b>	Dedicated Acreage: <b>N 1/2 316.35</b> Acres		

1. ~~Outline~~ the acreage dedicated to the subject well by colored pencil or hachure marks on the plat below.
2. If more than one lease is dedicated to the well, outline each and identify the ownership thereof (both as to working interest and royalty).
3. If more than one lease of different ownership is dedicated to the well, have the interests of all owners been consolidated by communitization, unitization, force-pooling, etc?

☐ Yes ☒ No If answer is "yes," type of consolidation Dakota

If answer is "no," list the owners and tract descriptions which have actually been consolidated. (Use reverse side of this form if necessary.) \_\_\_\_\_

No allowable will be assigned to the well until all interests have been consolidated (by communitization, unitization, forced-pooling, or otherwise) or until a non-standard unit, eliminating such interests, has been approved by the Commission.

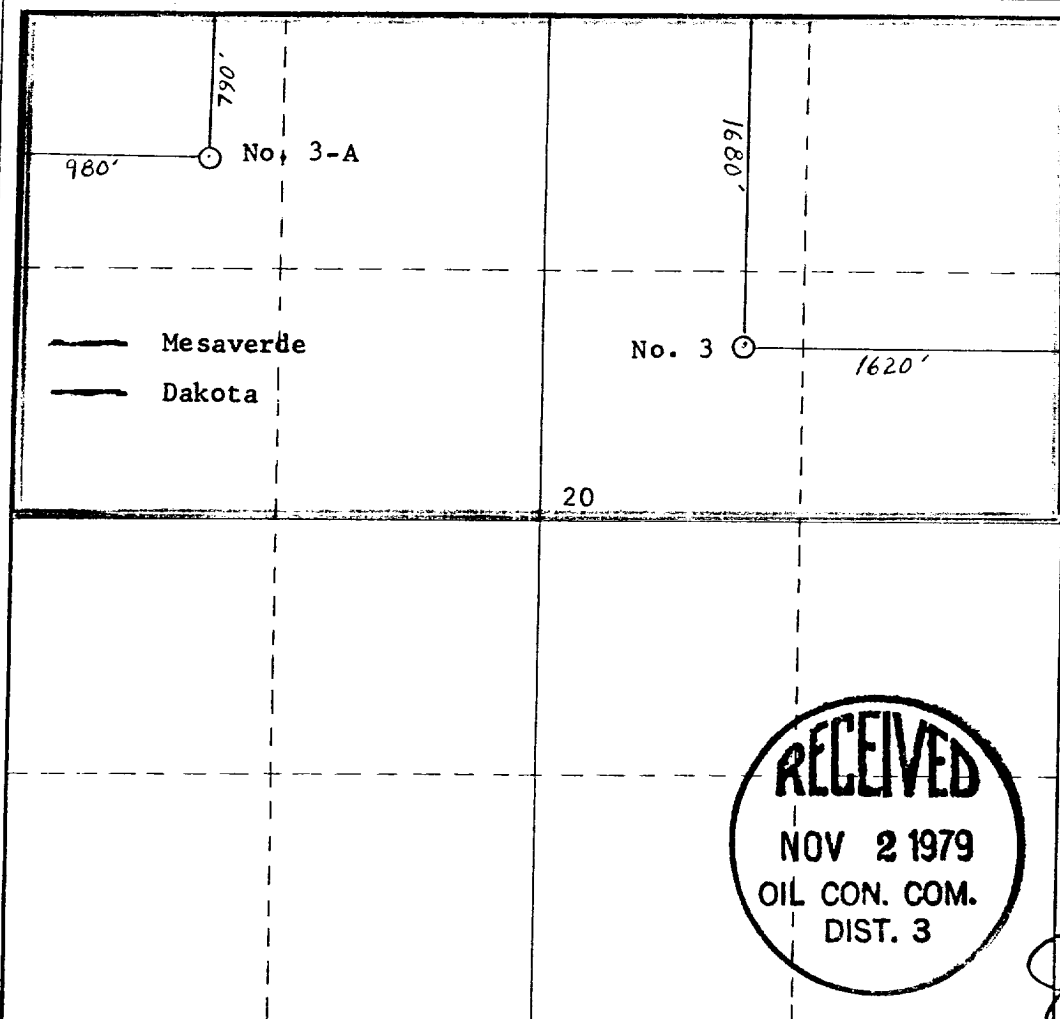

**CERTIFICATION**

I hereby certify that the information contained herein is true and complete to the best of my knowledge and belief.

*Rudy D. Motto*  
Name  
**Rudy D. Motto**

Position  
**Area Superintendent**

Company  
**SUPRON ENERGY CORPORATION**

Date  
**October 30, 1979**

I hereby certify that the well location shown on this plat was plotted from field notes, actual surveys made by me or under my supervision, and that the same is true and correct to the best of my knowledge and belief.

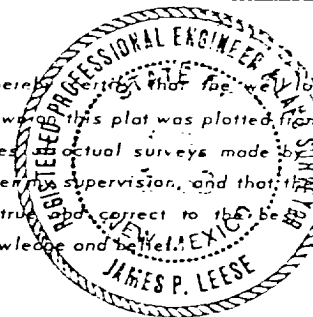

Date Surveyed  
**27 February 1979**

Registered Professional Engineer and/or Land Surveyor  
*James P. Leese*

Certificate No.  
**1463**



**NEW MEXICO OIL CONSERVATION COMMISSION**  
**MULTIPOINT AND ONE POINT BACK PRESSURE TEST FOR GAS WELL**

Form C-122  
 Revised 9-1-65

Type Test <input checked="" type="checkbox"/> Initial <input type="checkbox"/> Annual <input type="checkbox"/> Special				Test Date 5-20-80	
Company SUPRON ENERGY CORPORATION				Connection Southern Union Gathering Company	
Pool Blanco				Formation Mesaverde	
Completion Date 5-8-80		Total Depth 7595		Plug Back TD 7550	
Elevation 6098		Farm or Lease Name Payne			
Perforations: From 4761 To 5294		Well No. 3-A			
Perforations: From 5261 To 5267		Unit    Sec.    Twp.    Rge. D    20    32-N    10-W			
Type Well - Single - Bradenhead - G.G. or G.O. Multiple Dual - Gas - Gas				Packer Set At 7320	
Producing Thru Tubing		Reservoir Temp. °F @		Mean Annual Temp. °F 12	
Baro. Press. - P <sub>a</sub> 12		State New Mexico			
L 5257	H	G <sub>g</sub> 0.650	% CO <sub>2</sub>	% N <sub>2</sub>	% H <sub>2</sub> S
Prover		Meter Run		Taps	

FLOW DATA							TUBING DATA		CASING DATA		Duration of Flow
NO.	Prover Line Size	X	Orifice Size	Press. p.s.i.g.	Diff. h <sub>w</sub>	Temp. °F	Press. p.s.i.g.	Temp. °F	Press. p.s.i.g.	Temp. °F	
1.	2"		3/4"				647		649		7 days
2.							157	68°	569		3 hours
3.											
4.											
5.											

RATE OF FLOW CALCULATIONS							
NO.	Coefficient (24 Hour)	$\sqrt{h_w P_m}$	Pressure P <sub>m</sub>	Flow Temp. Factor Ft.	Gravity Factor F <sub>g</sub>	Super Compress. Factor, F <sub>pv</sub>	Rate of Flow Q, Mcfd
1.	12.3650		169	0.9924	0.9608	1.015	2022
2.							
3.							
4.							
5.							

NO.	P <sub>f</sub>	Temp. °R	T <sub>f</sub>	Z	Gas Liquid Hydrocarbon Ratio	Mcf/bbl.
1.					A.P.I. Gravity of Liquid Hydrocarbons	_____ Deg.
2.					Specific Gravity Separator Gas	XXXXXX
3.					Specific Gravity Flowing Fluid	XXXXXX
4.					Critical Pressure	P.S.I.A.
5.					Critical Temperature	P.S.I.A.

P <sub>c</sub> <sup>2</sup> 661	P <sub>c</sub> <sup>2</sup> 436,921			
NO.	P <sub>f</sub> <sup>2</sup>	P <sub>w</sub>	P <sub>w</sub> <sup>2</sup>	P <sub>c</sub> <sup>2</sup> - P <sub>w</sub> <sup>2</sup>
1.		581	337,561	99,360
2.				
3.				
4.				
5.				

(1)  $\frac{P_c^2}{P_c^2 - P_w^2} = 4.3974$

AOF = Q  $\left[ \frac{P_c^2}{P_c^2 - P_w^2} \right]^n = 6140$

(2)  $\left[ \frac{P_c^2}{P_c^2 - P_w^2} \right]^n = 3.0366$

Absolute Open Flow	6140	Mcf/d @ 15.025	Angle of Slope @	Slope, n	0.75
Remarks:					

Approved By Commission:	Conducted By: Randy Martinez	Calculated By: Kenneth E. Roddy	Checked By:
-------------------------	---------------------------------	------------------------------------	-------------

**NEW MEXICO OIL CONSERVATION COMMISSION**  
**MULTIPOINT AND ONE POINT BACK PRESSURE TEST FOR GAS WELL**

Form C-122  
 Revised 6-1-65

Type Test <input checked="" type="checkbox"/> Initial <input type="checkbox"/> Annual <input type="checkbox"/> Special				Test Date 5-27-80	
Company SUPRON ENERGY CORPORATION				Connection Southern Union Gathering Company	
Pool Basin				Formation Dakota	
Completion Date 5-8-80		Total Depth 7595		Plug Back TD 7550	
				Elevation 6098	
Farm or Lease Name Payne				Well No. 3-A	
7.625 5.500		Wt. 26.40 15.50		d 6.969 4.950	
				Set At 3160 3010-7564	
Tub. Size 2.0625		Wt. 3.25		d 1.750	
				Set At 7329	
Perforations: From 7371 To 7489				Perforations: No Perforations	
Type Well - Single - Broadhead - G.G. or G.O. Multiple Dual - Gas - Gas				Packer Set At 7320	
Producing Thru Tubing		Reservoir Temp. °F @		Mean Annual Temp. °F 12	
Baro. Press. - P <sub>a</sub> 12		County San Juan		State New Mexico	
L 7319	H	Gg 0.675	% CO <sub>2</sub>	% N <sub>2</sub>	% H <sub>2</sub> S
Prover		Meter Run		Taps	

FLOW DATA						TUBING DATA		CASING DATA		Duration of Flow	
NO.	Prover Line Size	X	Orifice Size	Press. p.s.i.g.	Diff. h <sub>w</sub>	Temp. °F	Press. p.s.i.g.	Temp. °F	Press. p.s.i.g.		Temp. °F
SI	2"		3/4"				1900				14 days
1.							100	65°			3 hours
2.											
3.											
4.											
5.											

  

RATE OF FLOW CALCULATIONS							
NO.	Coefficient (24 Hour)	$\sqrt{h_w P_m}$	Pressure P <sub>m</sub>	Flow Temp. Factor Ft.	Gravity Factor Fg	Super Compress. Factor, Fpv	Rate of Flow Q, Mcfd
1	12.3650		112	0.9952	0.9427	1.011	1314
2.							
3.							
4.							
5.							

NO.	P <sub>t</sub>	Temp. °R	T <sub>f</sub>	Z	Gas Liquid Hydrocarbon Ratio	Mcf/Lbl.
1.					A.P.I. Gravity of Liquid Hydrocarbon	_____ Deg.
2.					Specific Gravity Separator Gas	XXXXXXX
3.					Specific Gravity Flowing Fluid	XXXXXXX
4.					Critical Pressure	P.S.I.A. _____
5.					Critical Temperature	R _____

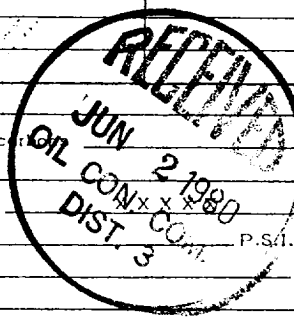

P <sub>c</sub> <sup>2</sup> 1912	P <sub>c</sub> <sup>2</sup> 3,655,744	
NO	P <sub>t</sub> <sup>2</sup>	P <sub>w</sub> <sup>2</sup>
1		103,936
2		
3		
4		
5		

$$(1) \frac{P_c^2}{P_c^2 - P_w^2} = 1.0293$$

$$(2) \left[ \frac{P_c^2}{P_c^2 - P_w^2} \right]^n = 1.0219$$

$$AOF = Q \left[ \frac{P_c^2}{P_c^2 - P_w^2} \right]^n = 1343$$

Absolute Open Flow	1343	Mcf/d @ 15.025	Angle of Slope @	Slope, n	0.75
--------------------	------	----------------	------------------	----------	------

Remarks:

Approved By Commission:	Conducted By: Randy Martinez	Calculated By: Kenneth E. Roddy	Checked By:
-------------------------	---------------------------------	------------------------------------	-------------

NO. OF COPIES RECEIVED	
DISTRIBUTION	5
SANTA FE	1
FILE	1
U.S.G.S.	2
LAND OFFICE	
OPERATOR	1

Form C-105  
Revised 11-88

# NEW MEXICO OIL CONSERVATION COMMISSION WELL COMPLETION OR RECOMPLETION REPORT AND LOG

5a. Indicate Type of Lease  
State ☐ Free ☒   
5. State Oil & Gas Lease No.  
Comm. W/S.F.080517

1a. TYPE OF WELL  
OIL WELL ☐ GAS WELL ☒ DRY ☐ OTHER ☐  
b. TYPE OF COMPLETION  
NEW WELL ☒ WORK OVER ☐ DEEPEN ☐ PLUG BACK ☐ DIFF. PRESVR. ☐ OTHER ☐

7. Unit Agreement Name  
8. Farm or Lease Name  
Payne  
9. Well No.  
3-A  
10. Field and Pool, or Wildcat  
Basin Dakota

2. Name of Operator  
Supron Energy Corporation  
3. Address of Operator  
P.O. Box 808, Farmington, New Mexico 87401  
4. Location of Well

UNIT LETTER D LOCATED 790 FEET FROM THE North LINE AND 980 FEET FROM  
THE West LINE OF SEC. 20 TWP. 32N RGE. 10W N.M.P.M.

12. County  
San Juan

15. Date Spudded 4/5/80	16. Date T.D. Reached 4/16/80	17. Date Compl. (Ready to Prod.) 5/27/80	18. Elevations (DF, RKB, RT, GR, etc.) 6098 R.K.B.	19. Elev. Casinghead 6085
20. Total Depth 7595	21. Plug Back T.D. 7550	22. If Multiple Compl., How Many 2	23. Intervals Drilled By Rotary Tools 0 - 7595	Cable Tools --

24. Producing Interval(s), of this completion - Top, Bottom, Name  
7371 - 7489 Dakota MD & TVD  
25. Was Directional Survey Made  
No

26. Type Electric and Other Logs Run  
Induction Electric and Compensated Density  
27. Was Well Cored  
No

28. CASING RECORD (Report all strings set in well)

CASING SIZE	WEIGHT LB./FT.	DEPTH SET	HOLE SIZE	CEMENTING RECORD	AMOUNT PULLED
10-3/4"	32.75	279	13-3/4"	235 Sacks	
7-5/8"	26.40	3160	9-7/8"	290 Sacks	
5-1/2"	15.50	3010 - 7564	6-3/4"	500 Sacks	

29. LINER RECORD				30. TUBING RECORD		
SIZE	TOP	BOTTOM	SACKS CEMENT	SCREEN	SIZE	DEPTH SET
5-1/2"	3010	7564	500		2-1/16" IJ	7329
						PACKER SET 7320

31. Perforation Record (Interval, size and number) 7371 - 7380 (10 holes) 7470 - 7479 (10 holes) 7448 - 7457 (10 holes) 7480 - 7489 (10 holes) Total of 40 0.42" holes	32. ACID, SHOT, FRACTURE, CEMENT SQUEEZE, ETC. DEPTH INTERVAL 7371 - 7489 AMOUNT AND KIND MATERIAL USED 4000 gal. 15% HCL, 90,000 lb. 20-40 sand, & 121,000 gal. 1% KCL water.
---	--

33. PRODUCTION  
Date First Production  
Production Method (Flowing, gas lift, pumping - Size and type pump)  
Flowing  
Well Status (Prod. or Shut-in)  
Shut-In  
Date of Test  
Hours Tested  
Choke Size  
Prod'n. For Test Period  
Oil - Bbl.  
Gas - MCF  
Water - Bbl.  
Gas - Oil Ratio  
Flow Tubing Press.  
Casing Pressure  
Calculated 24-Hour Rate  
Oil - Bbl.  
Gas - MCF  
Water - Bbl.  
Oil Gravity - API (Corr.)

34. Disposition of Gas (Sold, used for fuel, vented, etc.)  
Vented  
Test Witnessed By  
Randy Martinez

35. List of Attachments  
36. I hereby certify that the information shown on both sides of this form is true and complete to the best of my knowledge and belief.  
SIGNED Kenneth E. Roddy TITLE Production Superintendent DATE May 30, 1980

## INSTRUCTIONS

This form is to be filed with the appropriate District Office of the Commission not later than 20 days after the completion of any newly-drilled or deepened well. It shall be accompanied by one copy of all electrical and radio-activity logs run on the well and a summary of all special tests conducted, including drill stem tests. All depths reported shall be measured depths. In the case of directionally drilled wells, true vertical depths shall also be reported. For multiple completions, Items 30 through 34 shall be reported for each zone. The form is to be filed in quintuplicate except on state land, where six copies are required. See Rule 1165.

INDICATE FORMATION TOPS IN CONFORMANCE WITH GEOGRAPHICAL SECTION OF STATE

### Southeastern New Mexico

## Northwestern New Mexico

T. Anhy _____	T. Canyon _____	T. Ojo Alamo (Base) 1890 _____	T. Penn. "B" _____
T. Salt _____	T. Strawn _____	T. Kirtland-Fruitland 1930 _____	T. Penn. "C" _____
B. Salt _____	T. Atoka _____	T. Pictured Cliffs 2870 _____	T. Penn. "D" _____
T. Yates _____	T. Miss _____	T. Cliff House 4754 _____	T. Leadville _____
T. 7 Rivers _____	T. Devonian _____	T. Menefee _____	T. Madison _____
T. Queen _____	T. Silurian _____	T. Point Lookout 5153 _____	T. Elbert _____
T. Grayburg _____	T. Montoya _____	T. Mancos _____	T. McCracken _____
T. San Andres _____	T. Simpson _____	T. Gallup 5970 _____	T. Ignacio Qtzte _____
T. Glorieta _____	T. McKee _____	T. Base Greenhorn 7270 _____	T. Granite _____
T. Paddock _____	T. Ellenburger _____	T. Dakota 7353 _____	T. _____
T. Blinebry _____	T. Gr. Wash _____	T. Morrison _____	T. _____
T. Tubb _____	T. Granite _____	T. Todilto _____	T. _____
T. Drinkard _____	T. Delaware Sand _____	T. Entrada _____	T. _____
T. Abo _____	T. Bone Springs _____	T. Wingate _____	T. _____
T. Wolfcamp _____	T. _____	T. Chinle _____	T. _____
T. Penn. _____	T. _____	T. Permian _____	T. _____
T. Cisco (Bough C) _____	T. _____	T. Penn. "A" _____	T. _____

## OIL OR GAS SANDS OR ZONES

No. 1, from ..... to ..... No. 4, from ..... to .....  
No. 2, from ..... to ..... No. 5, from ..... to .....  
No. 3, from ..... to ..... No. 6, from ..... to .....

## IMPORTANT WATER SANDS

Include data on rate of water inflow and elevation to which water rose in hole.

No. 1, from ..... to ..... feet. ....

No. 2, from ..... to ..... feet. ....

No. 3, from ..... to ..... feet. ....

No. 4, from ..... to ..... feet. ....

FORMATION RECORD (Attach additional sheets if necessary)

From	To	Thickness in Feet	Formation	From	To	Thickness in Feet	Formation

NO. OF COPIES RECEIVED	3
DISTRIBUTION	
SANTA FE	1
FILE	1
U.S.G.S.	
LAND OFFICE	
OPERATOR	1

# NEW MEXICO OIL CONSERVATION COMMISSION

Form C-103  
Supersedes Old  
C-102 and C-103  
Effective 1-1-65

5a. Indicate Type of Lease
State <input type="checkbox"/> Fee <input checked="" type="checkbox"/>

5. State Oil & Gas Lease No.  
Communitized w/SF080517

## SUNDRY NOTICES AND REPORTS ON WELLS

(DO NOT USE THIS FORM FOR PROPOSALS TO DRILL OR TO DEEPEN OR PLUG BACK TO A DIFFERENT RESERVOIR. USE "APPLICATION FOR PERMIT" (FORM C-101) FOR SUCH PROPOSALS.)

1. OIL WELL <input type="checkbox"/> GAS WELL <input checked="" type="checkbox"/> OTHER-	7. Unit Agreement Name
2. Name of Operator SUPRON ENERGY CORPORATION	8. Farm or Lease Name Payne
3. Address of Operator P.O. Box 808, Farmington, New Mexico 87401	9. Well No. 3-A
4. Location of Well UNIT LETTER <u>D</u> , <u>790</u> FEET FROM THE <u>North</u> LINE AND <u>980</u> FEET FROM THE <u>West</u> LINE, SECTION <u>20</u> TOWNSHIP <u>32 North</u> RANGE <u>10 West</u> NMPM.	10. Field and Pool, or Wildcat Basin Dakota Blanco Mesaverde
15. Elevation (Show whether DF, RT, GR, etc.) 6085 GR.	12. County San Juan

Check Appropriate Box To Indicate Nature of Notice, Report or Other Data  
NOTICE OF INTENTION TO:

PERFORM REMEDIAL WORK ☐  
TEMPORARILY ABANDON ☐  
PULL OR ALTER CASING ☐

PLUG AND ABANDON ☐  
CHANGE PLANS ☐

OTHER Request for time extension ☐

SUBSEQUENT REPORT OF:

REMEDIAL WORK ☐  
COMMENCE DRILLING OPNS. ☐  
CASING TEST AND CEMENT JOB ☐  
OTHER ☐

ALTERING CASING ☐  
PLUG AND ABANDONMENT ☐

17. Describe Proposed or Completed Operations (Clearly state all pertinent details, and give pertinent dates, including estimated date of starting any proposed work) SEE RULE 1103.

We request an extension on the permit to drill. The present permit expires on 1-31-80.

APPROVAL VALID  
FOR 90 DAYS UNLESS  
DRILLING COMMENCED,

EXPIRES 4/29/80

18. I hereby certify that the information above is true and complete to the best of my knowledge and belief.

SIGNED Kenneth E. Roddy

TITLE Production Superintendent

DATE January 31, 1980

APPROVED BY

TITLE

Supervisor District # 3

DATE

**FEB 1 1980**

CONDITIONS OF APPROVAL, IF ANY:

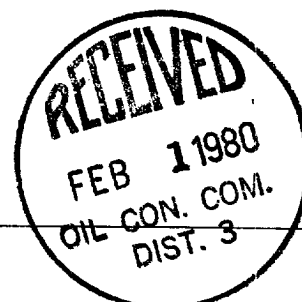

NO. OF COPIES RECEIVED	3
DISTRIBUTION	
SANTA FE	/
FILE	/
U.S.G.S.	
LAND OFFICE	
OPERATOR	/

# NEW MEXICO OIL CONSERVATION COMMISSION

Form C-103  
Supersedes Old  
C-102 and C-103  
Effective 1-1-65

5a. Indicate Type of Lease	
State <input type="checkbox"/>	Fee <input checked="" type="checkbox"/>
5. State Oil & Gas Lease No.	
Communitized s/SF 080517	

## SUNDRY NOTICES AND REPORTS ON WELLS

(DO NOT USE THIS FORM FOR PROPOSALS TO DRILL OR TO DEEPEN OR PLUG BACK TO A DIFFERENT RESERVOIR. USE "APPLICATION FOR PERMIT -" (FORM C-101) FOR SUCH PROPOSALS.)

1. OIL WELL <input type="checkbox"/> GAS WELL <input checked="" type="checkbox"/> OTHER-		7. Unit Agreement Name
2. Name of Operator SUPRON ENERGY CORPORATION		8. Farm or Lease Name Payne
3. Address of Operator P.O. Box 808, Farmington, New Mexico 87401		9. Well No. 3-A
4. Location of Well UNIT LETTER <u>D</u> , <u>790</u> FEET FROM THE <u>North</u> LINE AND <u>980</u> FEET FROM THE <u>West</u> LINE, SECTION <u>20</u> TOWNSHIP <u>32 North</u> RANGE <u>10 West</u> N.M.P.M.		10. Field and Pool, or Wildcat Basin Dakota Blanco Mesaverde
15. Elevation (Show whether DF, RT, GR, etc.) 6098 R.K.B.		12. County San Juan

## Check Appropriate Box To Indicate Nature of Notice, Report or Other Data NOTICE OF INTENTION TO:

PERFORM REMEDIAL WORK <input type="checkbox"/>	PLUG AND ABANDON <input type="checkbox"/>
TEMPORARILY ABANDON <input type="checkbox"/>	CHANGE PLANS <input type="checkbox"/>
PULL OR ALTER CASING <input type="checkbox"/>	OTHER <input type="checkbox"/>

## SUBSEQUENT REPORT OF:

REMEDIAL WORK <input type="checkbox"/>	ALTERING CASING <input type="checkbox"/>
COMMENCE DRILLING OPNS. <input type="checkbox"/>	PLUG AND ABANDONMENT <input type="checkbox"/>
CASING TEST AND CEMENT JOBS <input checked="" type="checkbox"/>	OTHER <input type="checkbox"/>

17. Describe Proposed or Completed Operations (Clearly state all pertinent details, and give pertinent dates, including estimated date of starting any proposed work) SEE RULE 1103.

- Spudded 13-3/4" hole 4:30 a.m. 4-5-80.
- Drilled 13-3/4" surface hole to total depth of 283 ft. R.K.B.
- Ran 6 joints (266 ft.) of 10-3/4", 32.75#, K-55 casing. Landed at 279 ft. R.K.B. Cemented with 235 sacks of class "B" cement with 2% calcium chloride. Plug down at 7:15 p.m. 4-6-80. Cement circulated to the surface.
- Waited on cement for 12 hours.
- Pressure-tested casing to 800 PSI for 20 minutes. Held OK.

18. I hereby certify that the information above is true and complete to the best of my knowledge and belief.

SIGNED Kenneth E. Roddy  
Kenneth E. Roddy

TITLE Production Superintendent

DATE April 10, 1980

APPROVED BY Original Signed by FRANK T. CHAVEZ

TITLE SUPERVISOR DISTRICT # 3

DATE APR 11 1980

CONDITIONS OF APPROVAL, IF ANY:

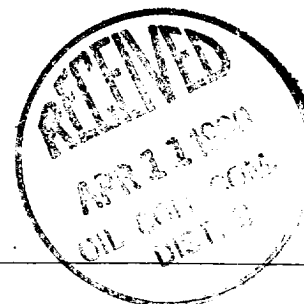



NO. OF COPIES RECEIVED	3
DISTRIBUTION	
SANTA FE	/
FILE	/
U.S.G.S.	
LAND OFFICE	
OPERATOR	/

# NEW MEXICO OIL CONSERVATION COMMISSION

Form C-103  
Supersedes Old  
C-102 and C-103  
Effective 1-1-65

5a. Indicate Type of Lease	
State <input type="checkbox"/>	Fee <input checked="" type="checkbox"/>
5. State Oil & Gas Lease No.	
Communitized W/SF 08051	

## SUNDRY NOTICES AND REPORTS ON WELLS (DO NOT USE THIS FORM FOR PROPOSALS TO DRILL OR TO DEEPEN OR PLUG BACK TO A DIFFERENT RESERVOIR. USE "APPLICATION FOR PERMIT --" (FORM C-101) FOR SUCH PROPOSALS.)

OIL WELL <input type="checkbox"/> GAS WELL <input checked="" type="checkbox"/> OTHER-		7. Unit Agreement Name
2. Name of Operator SUPRON ENERGY CORPORATION		8. Farm or Lease Name Payne
3. Address of Operator P.O. Box 808, Farmington, New Mexico 87401		9. Well No. 3-A
4. Location of Well UNIT LETTER <u>D</u> , <u>790</u> FEET FROM THE <u>North</u> LINE AND <u>980</u> FEET FROM THE <u>West</u> LINE, SECTION <u>20</u> TOWNSHIP <u>32 North</u> RANGE <u>10 West</u> NMPM.		10. Field and Pool, or Wildcat Basin Dakota-Blanco MV
15. Elevation (Show whether DF, RT, GR, etc.) 6098 R.K.B.		12. County San Juan

### Check Appropriate Box To Indicate Nature of Notice, Report or Other Data NOTICE OF INTENTION TO:

PERFORM REMEDIAL WORK <input type="checkbox"/>	PLUG AND ABANDON <input type="checkbox"/>
TEMPORARILY ABANDON <input type="checkbox"/>	CHANGE PLANS <input type="checkbox"/>
PULL OR ALTER CASING <input type="checkbox"/>	OTHER <input type="checkbox"/>

### SUBSEQUENT REPORT OF:

REMEDIAL WORK <input type="checkbox"/>	ALTERING CASING <input type="checkbox"/>
COMMENCE DRILLING OPNS. <input type="checkbox"/>	PLUG AND ABANDONMENT <input type="checkbox"/>
CASING TEST AND CEMENT JOB <input type="checkbox"/>	OTHER <u>Ran casing</u> <input checked="" type="checkbox"/>

### 17. Describe Proposed or Completed Operations (Clearly state all pertinent details, and give pertinent dates, including estimated date of starting any proposed work) SEE RULE 1103.

1. Drilled 9-7/8" hole to intermediate depth of 3160 ft. R.K.B. Ran 71 joints (3149 ft.) of 7-5/8". 26.40#, K-55 casing. Landed at 3160 ft. R.K.B.
2. Cemented with 190 sacks of Halliburton Lite and 100 sacks of class "B". Plug down at 5:45 a.m. 4-10-80.
3. Temperature survey indicated cement top at 1500 ft. R.K.B.
4. Drilled 6-3/4" hole with gas to total depth of 7595 ft. R.K.B. Total depth was reached on 4-16-80.
5. Ran 109 joints (4554 ft.) of 5-1/2", 15.50#, K-55 casing as a liner. Bottom of liner at 7564 ft. R.K.B. Top of liner at 3010 ft. R.K.B. Float collar at 7550 ft. R.K.B.
6. Cemented liner with 500 sacks of 50-50 POZ with 4% gel.

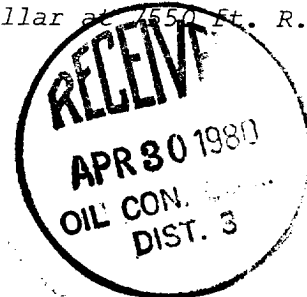

18. I hereby certify that the information above is true and complete to the best of my knowledge and belief.

SIGNED Kenneth E. Roddy TITLE Production Superintendent DATE April 29, 1980

Original Signed by FRANK T. CHAVEZ

TITLE SUPERVISOR DISTRICT # 3

APR 30 1980

APPROVED BY  
CONDITIONS OF APPROVAL, IF ANY: