

NEW MEXICO OIL CONSERVATION COMMISSION
WELL LOCATION AND ACREAGE DEDICATION PLAT

Form C-102
Supersedes C-128
Effective 1-1-85

All distances must be from the outer boundaries of the Section.

Operator SUPRON ENERGY CORPORATION			Lease PAYNE		Well No. 3-A
Unit Letter D	Section 20	Township 32 NORTH	Range 10 WEST	County SAN JUAN	
Actual Footage Location of Well:					
790 feet from the NORTH line and		980 feet from the WEST line			
Ground Level Elev. 6085	Producing Formation ME SAVERDE	Pool BLANCO	Dedicated Acreage: N 1/2 316.35 Acres		
	DAKOTA	BASIN			

1. Outline the acreage dedicated to the subject well by colored pencil or hachure marks on the plat below.
2. If more than one lease is dedicated to the well, outline each and identify the ownership thereof (both as to working interest and royalty).
3. If more than one lease of different ownership is dedicated to the well, have the interests of all owners been consolidated by communitization, unitization, force-pooling, etc?

☒ Yes ☐ No If answer is "yes," type of consolidation Communitization with S.F. 080517

If answer is "no," list the owners and tract descriptions which have actually been consolidated. (Use reverse side of this form if necessary.)

No allowable will be assigned to the well until all interests have been consolidated (by communitization, unitization, forced-pooling, or otherwise) or until a non-standard unit, eliminating such interests, has been approved by the Commission.

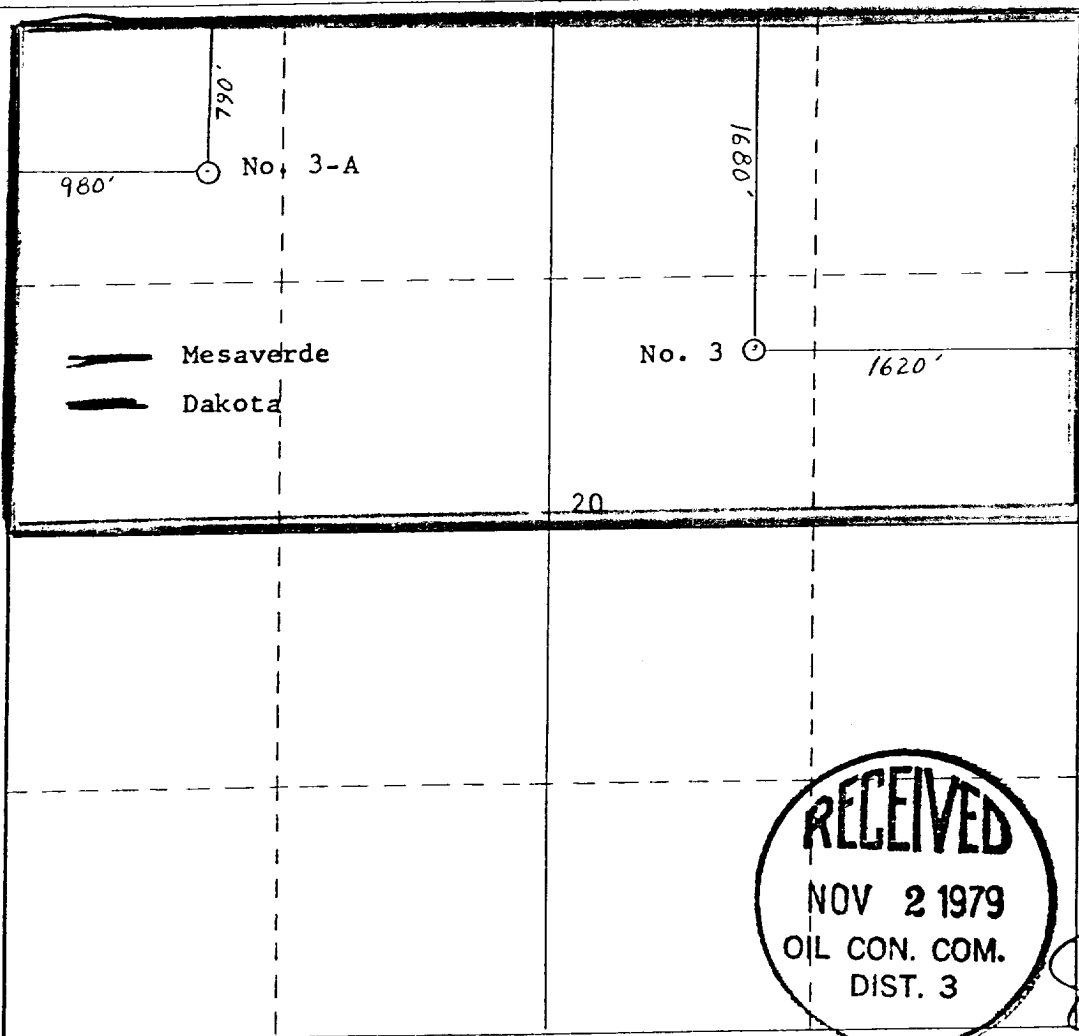

CERTIFICATION

I hereby certify that the information contained herein is true and complete to the best of my knowledge and belief.

Rudy D. Motto
Name

Rudy D. Motto

Position

Area Superintendent

Company

SUPRON ENERGY CORPORATION

Date

October 30, 1979

I hereby certify that the well location shown on this plat was plotted from field notes of actual surveys made by me or under my supervision, and that the same is true and correct to the best of my knowledge and belief.

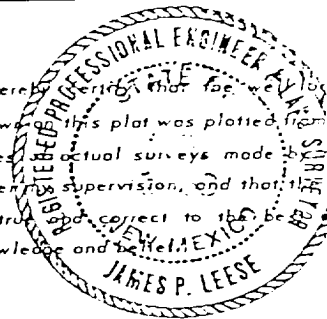

Date Surveyed

27 February 1979

Registered Professional Engineer and/or Land Surveyor

James P. Leese

Certificate No.

1463