

NO. OF COPIES RECEIVED	5
DISTRIBUTION	
SANTA FE	1
FILE	2
U.S.G.S.	
LAND OFFICE	
OPERATOR	1

NEW MEXICO OIL CONSERVATION COMMISSION

30-044-24157
Form C-101
Revised 1-1-65

5A. Indicate Type of Lease	
STATE <input type="checkbox"/>	FEE <input checked="" type="checkbox"/>
5. State Oil & Gas Lease No.	

APPLICATION FOR PERMIT TO DRILL, DEEPEN, OR PLUG BACK

1a. Type of Work		7. Unit Agreement Name	
b. Type of Well DRILL <input checked="" type="checkbox"/> DEEPEN <input type="checkbox"/> PLUG BACK <input type="checkbox"/> OIL WELL <input type="checkbox"/> GAS WELL <input checked="" type="checkbox"/> OTHER <input type="checkbox"/> SINGLE ZONE <input checked="" type="checkbox"/> MULTIPLE ZONE <input type="checkbox"/>		8. Farm or Lease Name JOHNSON	
2. Name of Operator OKLAHOMA OIL COMPANY		9. Well No. 1E	
3. Address of Operator Suite 1120, One Energy Square, Dallas, Texas 75206		10. Field and Pool, or Wildcat BASIN DAKOTA	
4. Location of Well UNIT LETTER <u>P</u> LOCATED <u>1120'</u> FEET FROM THE <u>south</u> LINE AND <u>1120</u> FEET FROM THE <u>east</u> LINE OF SEC. <u>21</u> TWP. <u>31N</u> RGE. <u>13W</u> NMPM		12. County SAN JUAN	
19. Proposed Depth 6600'		19A. Formation DAKOTA	20. Rotary or C.T. ROTARY
21. Elevations (Show whether DF, RT, etc.) 5724 GL	21A. Kind & Status Plug. Bond INDIVIDUAL WELL	21B. Drilling Contractor UNKNOWN	22. Approx. Date Work will start January 1, 1980

23.

PROPOSED CASING AND CEMENT PROGRAM

SIZE OF HOLE	SIZE OF CASING	WEIGHT PER FOOT	SETTING DEPTH	SACKS OF CEMENT	EST. TOP
12 1/4	8 5/8	24	300'	200	SURFACE
7 5/8	5 1/2	15.5	6600	1050	SURFACE

A 10" 900 series BOP will be installed and operable for all operations under surface casing. Operation of preventers will be checked daily. Any potential blowout situation will be controlled by increasing mud weight to contain pressure increase. An adequate supply of mud and weighting material will be maintained on location to control any situation.

Gas under this lease is ~~not~~ dedicated to a contract.

APPROVAL VALID
FOR 90 DAYS UNLESS
DRILLING COMMENCES

EXPIRES 4-1-80



IN ABOVE SPACE DESCRIBE PROPOSED PROGRAM; IF PROPOSAL IS TO DEEPEN OR PLUG BACK, GIVE DATA ON PRESENT PRODUCTIVE ZONE AND PROPOSED NEW PRODUCTIVE ZONE. GIVE BLOWOUT PREVENTER PROGRAM, IF ANY.

I hereby certify that the information above is true and complete to the best of my knowledge and belief.

Signed John Alexander Title AGENT Date December 18, 1979

(This space for State Use)

APPROVED BY Frank B. Long TITLE DEPUTY OIL & GAS COMMISSIONER, DIST. #3 DATE JAN 1 1980

CONDITIONS OF APPROVAL, IF ANY:

OIL CONSERVATION DIVISION

STATE OF NEW MEXICO
ENERGY AND MINERALS DEPARTMENTP. O. BOX 2088
SANTA FE, NEW MEXICO 87501Form C-102
Revised 10-1-78

All distances must be from the outer boundaries of the Section

Operator OKLAHOMA OIL COMPANY			Lease JOHNSON		Well No. 1-E
Unit Letter P	Section 21	Township 31N	Range 13W	County San Juan	
Actual Footage Location of Well: 1120 feet from the South line and 1120 feet from the East line					
Ground Level Elev. 5685	Producing Formation Dakota		Pool Basin Dakota		Dedicated Acreage: 320 Acres

1. Outline the acreage dedicated to the subject well by colored pencil or hachure marks on the plat below.
2. If more than one lease is dedicated to the well, outline each and identify the ownership thereof (both as to working interest and royalty).
3. If more than one lease of different ownership is dedicated to the well, have the interests of all owners been consolidated by communitization, unitization, force-pooling, etc?

☒ Yes ☐ No If answer is "yes," type of consolidation COMMUNITIZED

If answer is "no," list the owners and tract descriptions which have actually been consolidated. (Use reverse side of this form if necessary.) _____

No allowable will be assigned to the well until all interests have been consolidated (by communitization, unitization, forced-pooling, or otherwise) or until a non-standard unit, eliminating such interests, has been approved by the Commission.

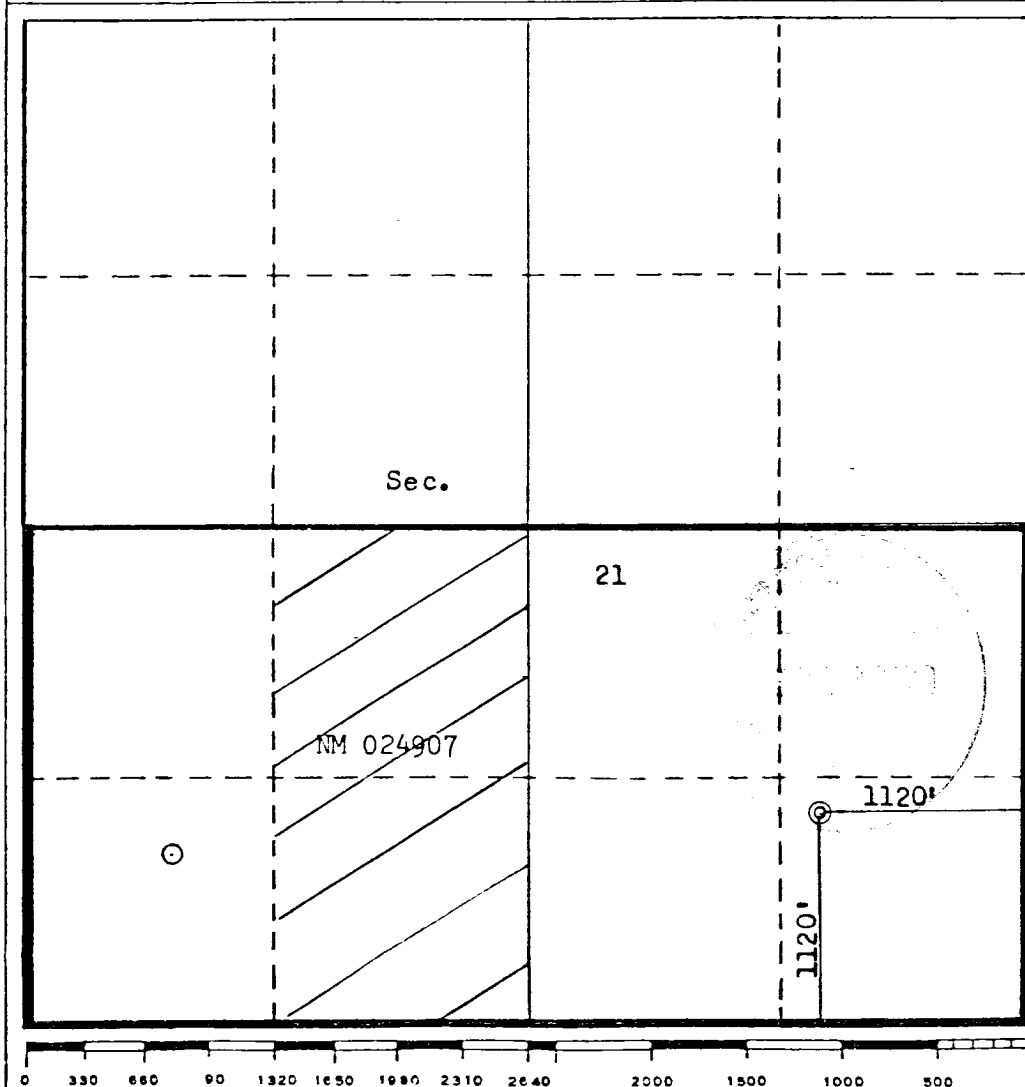

CERTIFICATION

I hereby certify that the information contained herein is true and complete to the best of my knowledge and belief.

JOHN ALEXANDER

Position

AGENT

Company

OKLAHOMA OIL CO.

Date

November 16, 1979

I hereby certify that the well location shown on this plat was plotted from field notes of actual surveys made by me or under my supervision, and that the same is true and correct to the best of my knowledge and belief.

Date Surveyed

November 16, 1979

Registered Professional Engineer
and/or Land Surveyor
Fred B. Kerr, Jr.

Certificate No.

3950