

30-045-24198

NO. OF COPIES RECEIVED	5
DISTRIBUTION	
SANTA FE	1
FILE	1
U.S.G.S.	2
LAND OFFICE	
OPERATOR	1

NEW MEXICO OIL CONSERVATION COMMISSION

Form C-101  
Revised 1-1-65

5A. Indicate Type of Lease	
STATE <input type="checkbox"/>	FEE <input checked="" type="checkbox"/>
5. State Oil & Gas Lease No.	

APPLICATION FOR PERMIT TO DRILL, DEEPEN, OR PLUG BACK

1a. Type of Work		7. Unit Agreement Name	
b. Type of Well OIL WELL <input type="checkbox"/> GAS WELL <input checked="" type="checkbox"/> OTHER <input type="checkbox"/>		8. Farm or Lease Name Phillips	
2. Name of Operator Consolidated Oil & Gas, Inc.		9. Well No. 1-E	
3. Address of Operator 1860 Lincoln Street, Denver, Colorado 80295		10. Field and Pool, or Wildcat Basin Dakota	
4. Location of Well UNIT LETTER <u>K</u> LOCATED <u>1650</u> FEET FROM THE <u>south</u> LINE <u>1700</u> FEET FROM THE <u>west</u> LINE OF SEC. <u>23</u> TWP. <u>31N</u> RGE. <u>13W</u> NMPM		12. County San Juan	
11. Elevations (Show whether DF, RT, etc.) 5775 GR		14. Proposed Depth 6850'	19A. Formation Dakota
21A. Kind & Status Plug, Bond Blanket/ In force		19B. Drilling Contractor NA	20. Rotary or C.T. Rotary
22. Approx. Date Work will start March 15, 1980			

PROPOSED CASING AND CEMENT PROGRAM

SIZE OF HOLE	SIZE OF CASING	WEIGHT PER FOOT	SETTING DEPTH	SACKS OF CEMENT	EST. TOP
12-1/4"	8-5/8"	24.0#	250'	200	Circ to surf.
7-7/8"	5-1/2"	15.5#	6850'	600	3000'

1. Drill 12-1/4" hole to  $\pm$  250'. Set 8-5/8" casing, circulate cement to surface.
2. WOC 12 hours.
3. NU BOPs. Pressure test surface casing and BOPs to 1000#.
4. Drill 7-7/8" hole to 6850' with fresh water gel mud. Log.
5. Run 5-1/2" casing and cement same in two stages with approximately 600 sx.
6. Selectively perforate and stimulate the Dakota formation and complete as required by applicable rules and regulations.

The S/2 of Section 23 is dedicated to this well and the acreage is committed to a gas sales contract.

IN ABOVE SPACE DESCRIBE PROPOSED PROGRAM IF PROPOSAL IS TO DEEPEN OR PLUG BACK; GIVE DATA ON PRESENT PRODUCTIVE ZONE AND PROPOSED NEW PRODUCTIVE ZONE. GIVE BLOWOUT PREVENTER PROGRAM, IF ANY.

I hereby certify that the information above is true and complete to the best of my knowledge and belief.

Signed Floyd E. Ellison, Jr. Title Vice Pres. Operations Date Feb. 4, 1980

(This space for State Use)

APPROVED BY Frank S. Chang TITLE SUPERVISOR DISTRICT # 3 DATE FEB 11 1980

CONDITIONS OF APPROVAL, IF ANY:

Use sufficient cement to cover fractured cliffs

All distances must be from the outer boundaries of the Section

Operator <b>CONSOLIDATED OIL &amp; GAS</b>			Lease <b>PHILLIPS</b>		Well No. <b>1-B</b>
Unit Letter <b>K</b>	Section <b>23</b>	Township <b>31 NORTH</b>	Range <b>13 WEST</b>	County <b>SAN JUAN</b>	
Actual Footage Location of Well: <b>1650</b> feet from the <b>SOUTH</b> line and <b>1700</b> feet from the <b>WEST</b> line					
Ground Level Elev. <b>5775</b>	Producing Formation <b>Dakota</b>	Pool <b>Basin Dakota</b>		Dedicated Acreage <b>320</b> Acres	

1. Outline the acreage dedicated to the subject well by colored pencil or hatchure marks on the plat below.
2. If more than one lease is dedicated to the well, outline each and identify the ownership thereof (both as to working interest and royalty).
3. If more than one lease of different ownership is dedicated to the well, have the interests of all owners been consolidated by communitization, unitization, force-pooling, etc?

☒ Yes ☐ No If answer is "yes," type of consolidation **Communitization**

If answer is "no," list the owners and tract descriptions which have actually been consolidated. (Use reverse side of this form if necessary.)

No allowable will be assigned to the well until all interests have been consolidated (by communitization, unitization, forced-pooling, or otherwise) or until a non-standard unit, eliminating such interests, has been approved by the Division.

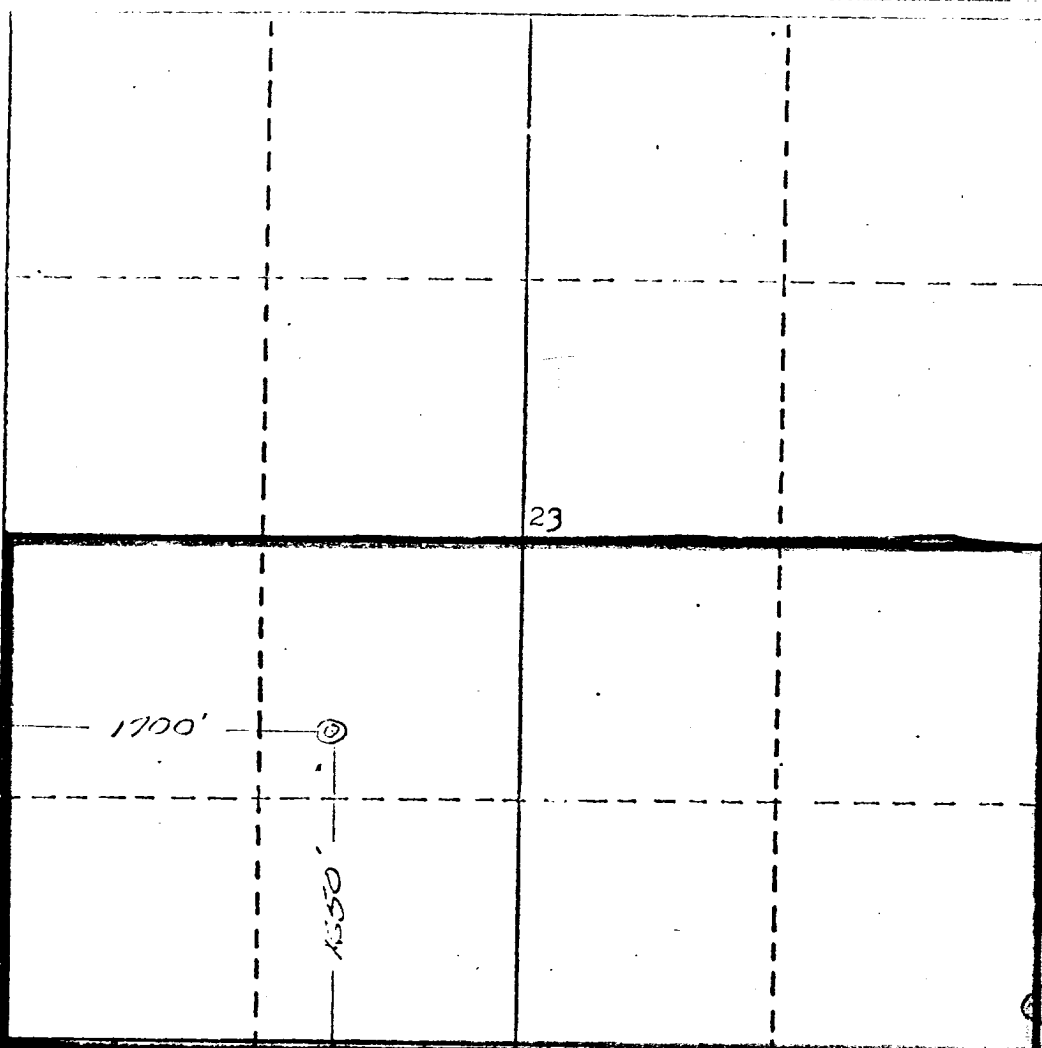

CERTIFICATION

I hereby certify that the information contained herein is true and complete to the best of my knowledge and belief.

*Floyd E. Ellison Jr.*  
Name

Vice Pres. Operations  
Position

Consolidated Oil & Gas, Inc.  
Company

February 4, 1980  
Date

I hereby certify that the well location shown on this plat was plotted from field notes and that the same are correct to the best of my knowledge and belief.  
**RECEIVED**  
**FEB 11 1980**  
**OIL & GAS COM. P. LEASE**  
**DIST. 3**

Date Surveyed  
January 21, 1979

Registered Professional Engineer  
in the State of New Mexico

*James P. Leese*  
James P. Leese

Certificate No.  
1463

