

District I  
P.O. Box 1983, Hobbs, NM

District II  
P.O. Drawer 30, Artesia, NM 88221

District III  
1000 Rio Brazos Rd, Aztec, NM 87410

*Dennis E. Faust*  
DEPUTY OIL & GAS INSPECTOR

State of New Mexico  
Energy, Minerals and Natural Resources Department

SUBMIT 1 COPY TO  
APPROPRIATE  
DISTRICT OFFICE  
AND 1 COPY TO  
SANTA FE OFFICE

OIL CONSERVATION DIVISION

2040 South Pacheco Street  
Santa Fe, New Mexico 87505

**PIT REMEDIATION AND CLOSURE REPORT**

Operator: PNM Gas Services (Williams) Telephone: 324-3764

Address: 603 W. Elm Street Farmington, NM 87401

Facility or Well Name: Wilmerding #1M Gas Transfer Line

Location: Unit C Sec 10 T 31 N R 13 W County San Juan

Pit Type: Separator ☐ Dehydrator ☐ Other No equipment.

Land Type: BLM ☐ State ☐ Fee ☒ Other No

Pit Location: Pit dimensions: length 20 width 20 depth 3

(Attach diagram) Reference: wellhead ☐ other ML gas line dog leg.

Footage from reference: 35'

Direction from reference: 30 Degrees ☒ East ☒ North ☐ West ☐ South

Depth to Ground Water: Less than 50 feet (20 points)  
50 feet to 99 feet (10 points)  
Greater than 100 feet (0 points) 10

(Vertical distance from contaminants to  
seasonal high water elevation of ground  
water)

Wellhead Protection Area:

(Less than 200 feet from a private  
domestic water source, or, less than 1,000  
feet from all other water sources)

Yes (20 points)  
No (0 points) 0

Distance to Surface Water:

(Horizontal distance to perennial lakes,  
ponds, rivers, streams, creeks, irrigation  
canals and ditches)

Less than 200 feet (20 points)  
200 feet to 1,000 feet (10 points)  
Greater than 1,000 feet (0 points) 10

RANKING SCORE (TOTAL POINTS): 20

Wilmerding #1M Gas Transfer Line

Date Remediation Started: \_\_\_\_\_

Date Completed: \_\_\_\_\_

Remediation Method: Excavation \_\_\_\_\_

Approx. Cubic Yard \_\_\_\_\_

(Check all  
appropriate  
sections)

Landfarmed \_\_\_\_\_

Amount Landfarmed (cubic yds) \_\_\_\_\_

Other \_\_\_\_\_

Remediation Location: Onsite \_\_\_\_\_

Offsite \_\_\_\_\_

(i.e., landfarmed onsite, name and  
location of offsite facility)

Backfill Material Location: \_\_\_\_\_

**General Description of Remedial Action:**

No remedial action necessary. Lab results below BLM/OCD standards.

\_\_\_\_\_  
\_\_\_\_\_  
\_\_\_\_\_  
\_\_\_\_\_

Ground Water Encountered: No ☐ Yes ☐ Depth \_\_\_\_\_

**Final Pit Closure  
Sampling:**

Sample Location Middle of pit; 3 pt. composite.

(if multiple samples, attach  
sample result and diagram of  
sample locations and depths.)

Sample depth 38"

Sample date 12/1/97 Sample time 8:30:00 AM

**Sample Results**

Benzene (ppm) \_\_\_\_\_

Total BTEX (ppm) \_\_\_\_\_

Field headspace (ppm) 1.7

TPH (ppm) < 5.00 Method 8015A

Vertical Extent (ft) \_\_\_\_\_ Risk Assessment form attached Yes ☐ No ☐

Ground Water Sample: Yes ☐ No ☒ (If yes, see attached Groundwater Site  
Summary Report)

I HEREBY CERTIFY THAT THE INFORMATION ABOVE IS TRUE AND COMPLETE TO THE BEST OF MY  
KNOWLEDGE AND MY BELIEF

DATE January 27, 1998

SIGNATURE



PRINTED NAME **Denver Bearden**  
AND TITLE **Administrator III**

Well Name: Wilmerding #1-M ML Trunk line				
Legal Description:	Sec	Twn	Rng	Unit
	10	31N	13W	C

Data Sheet #:
---------------

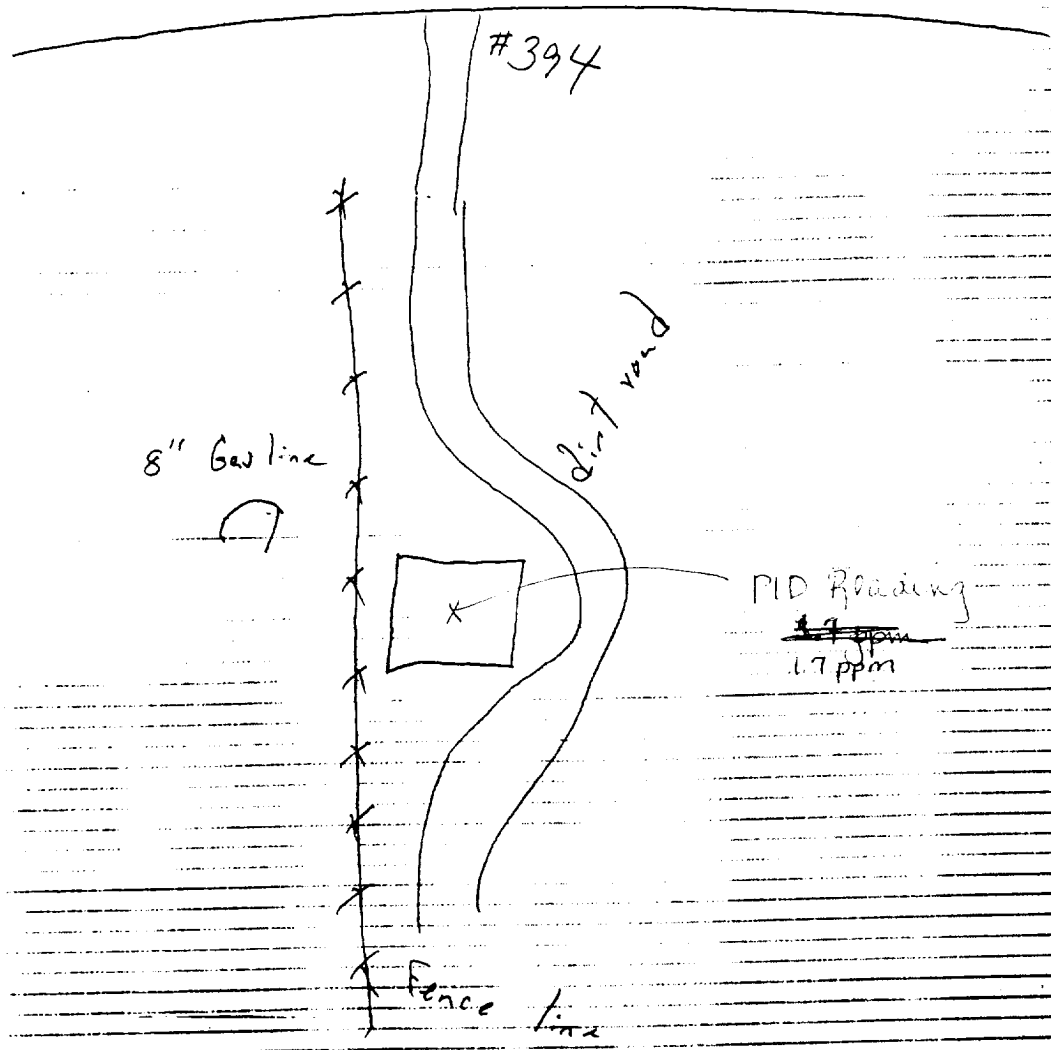

OFF: (505) 325-5667



LAB: (505) 325-1556

### *ANALYTICAL REPORT*

Attn: *Denver Bearden*  
Company: *PNM Gas Services*  
Address: *603 W. Elm*  
City, State: *Farmington, NM 87401*

Date: *9-Dec-97*  
COC No.: *7104*  
Sample No.: *16987*  
Job No.: *2-1000*

Project Name: *PNM Gas Services - Wilmerding #1M ML Gas Transfer Line*  
Project Location: *9712010830; 3pt. Composite, 3' depth*  
Sampled by: *GC* Date: *1-Dec-97* Time: *8:30*  
Analyzed by: *DC/HR* Date: *4-Dec-97*  
Sample Matrix: *Soil*

#### *Laboratory Analysis*

Parameter	Results as Received	Unit of Measure	Limit of Quantitation	Unit of Measure
<i>Diesel Range Organics (C10 - C28)</i>	ND	mg/kg	5	mg/kg

ND - Not Detected at Limit of Quantitation

#### *Quality Assurance Report*

DRO QC No.: 0555-STD

#### *Continuing Calibration Verification*

Parameter	Method Blank	Unit of Measure	True Value	Analyzed Value	RPD	RPD Limit
<i>Diesel Range (C10 - C28)</i>	ND	ppm	200	194	3.3	15%

#### *Matrix Spike*

Parameter	1- Percent Recovered	2 - Percent Recovered	Limit	RPD	RPD Limit
<i>Diesel Range (C10-C28)</i>	94	95	(70-130)	2	20%

Method - *SW-846 EPA Method 8015A mod. - Nonhalogenated Volatile Hydrocarbons by Gas Chromatography*

Approved by: *[Signature]*  
Date: *12/9/97*

P.O. BOX 2606 • FARMINGTON, NM 87499