

UNITED STATES  
DEPARTMENT OF THE INTERIOR  
GEOLOGICAL SURVEY

## APPLICATION FOR PERMIT TO DRILL, DEEPEN, OR PLUG BACK

1a. TYPE OF WORK DRILL <input checked="" type="checkbox"/> DEEPEN <input type="checkbox"/> PLUG BACK <input type="checkbox"/>			5. LEASE DESIGNATION AND SERIAL NO. SF-078244		
b. TYPE OF WELL OIL WELL <input type="checkbox"/> GAS WELL <input checked="" type="checkbox"/> OTHER <input type="checkbox"/>			6. IF INDIAN, ALLOTTEE OR TRIBE NAME N/A		
2. NAME OF OPERATOR Supron Energy Corp. c/o Gordon L. Llewellyn			7. UNIT AGREEMENT NAME N/A		
3. ADDRESS OF OPERATOR Suite 140 Campbell Centre 8350 North Central Expressway, Dallas, Texas 75206			8. FARM OR LEASE NAME Taliaferro		
4. LOCATION OF WELL (Report location clearly and in accordance with any State requirements.) At surface 1090' FNL & 1080' FEL (NE NE) At proposed prod. zone Same			9. WELL NO. #6		
14. DISTANCE IN MILES AND DIRECTION FROM NEAREST TOWN OR POST OFFICE* 6.1 miles North of Flora Vista, New Mexico			10. FIELD AND POOL, OR WILDCAT Blanco Mesa Verde		
15. DISTANCE FROM PROPOSED* LOCATION TO NEAREST PROPERTY OR LEASE LINE, FT. (Also to nearest drlg. unit line, if any) 1080'			11. SEC., T., R., M., OR BLK. AND SURVEY OR AREA Sec. 30 T31N R12W		
16. NO. OF ACRES IN LEASE 2004.86			12. COUNTY OR PARISH San Juan		
17. NO. OF ACRES ASSIGNED TO THIS WELL 320			13. STATE NM		
18. DISTANCE FROM PROPOSED* LOCATION TO NEAREST WELL, DRILLING, COMPLETED, OR APPLIED FOR, ON THIS LEASE, FT. ---			20. ROTARY OR CABLE TOOLS Rotary		
21. ELEVATIONS (Show whether DF, RT, GR, etc.) 5985' GR			22. APPROX. DATE WORK WILL START* June 30, 1980		

## PROPOSED CASING AND CEMENTING PROGRAM

SIZE OF HOLE	SIZE OF CASING	WEIGHT PER FOOT	SETTING DEPTH	QUANTITY OF CEMENT
12-1/4"	8-5/8" new	24#K-55ST&C	300'	2 stage DV tool to cover Pictured Cliffs
6-1/4"	4-1/2" new	10.5#CW-55 ST&C	5030'	

1. Drill 12-1/4" hole and set 8-5/8" surface casing to 300' with good returns.
2. Log B.O.P. checks in daily drill reports and drill 6-1/4" hole to 5030'.
3. Run tests if warranted and run 4 1/2" casing if productive.
4. Run logs, as needed, and perforate and stimulate as needed.

## EXHIBITS ATTACHED:

- |     |  |
|-----|--|
| "A" | Location and Elevation Plat                                      |
| "B" | The Ten-Point Compliance Program                                 |
| "C" | The Blowout Preventer Diagram                                    |
| "D" | The Multi-Point Requirements for A.P.D.                          |
| "E" | Access Road Maps to Location                                     |
| "F" | Radius Map of Field  |
| "G" | Drill Pay Layout, Production Facilities & Cut-Fill Cross Section |
| "H" | Drill Rig Layout   |

IN ABOVE SPACE DESCRIBE PROPOSED PROGRAM: If proposal is to deepen or plug back, give data on present productive zone and proposed new productive zone. If proposal is to drill or deepen directionally, give pertinent data on subsurface locations and measured and true vertical depths. Give blowout preventer program, if any.

SIGNED \_\_\_\_\_ TITLE Engineer Drilling & Prod. DATE May 22, 1980  
(This space for Federal or State office use)

PERMIT NO. _____	APPROVAL DATE _____
APPROVED BY _____ CONDITIONS OF APPROVAL, IF ANY:	TITLE _____ DATE _____ JUL 15 1980 JAMES F. SIMS DISTRICT ENGINEER

ok [Signature]

\*See Instructions On Reverse Side

NEW MEXICO OIL CONSERVATION COMMISSION  
WELL LOCATION AND ACREAGE DEDICATION PLAT

Form C-102  
Supersedes C-120  
Effective 1-1-65

EXHIBIT "A" - Location & Elevation Plat

All distances must be from the outer boundaries of the Section.

Owner <i>Supron Energy Corporation</i>			Lease <i>SF-078244</i>		Well No. <i>Taliaferro # 6</i>
Section <i>A</i>	Township <i>30</i>	Range <i>31 North</i>	County <i>San Juan</i>		
Section Footings: Location of Well: <i>1090</i> feet from the <i>North</i> line and <i>1090</i> feet from the <i>East</i> line					
Section Level Elev. <i>5985</i>	Producing Formation <i>Ballard Pictured Cliffs</i>		Foot <i>BLANCO MESA Verde</i>	Dedicated Acreage: <i>320</i> Acres	

1. Outline the acreage dedicated to the subject well by colored pencil or hatchure marks on the plat below.
2. If more than one lease is dedicated to the well, outline each and identify the ownership thereof (both as to working interest and royalty).
3. If more than one lease of different ownership is dedicated to the well, have the interests of all owners been consolidated by communitization, unitization, force-pooling, etc?

☐ Yes ☐ No If answer is "yes," type of consolidation \_\_\_\_\_

If answer is "no," list the owners and tract descriptions which have actually been consolidated. (Use reverse side of this form if necessary.) \_\_\_\_\_

No allowable will be assigned to the well until all interests have been consolidated (by communitization, unitization, forced-pooling, or otherwise) or until a non-standard unit, eliminating such interests, has been approved by the Commission.

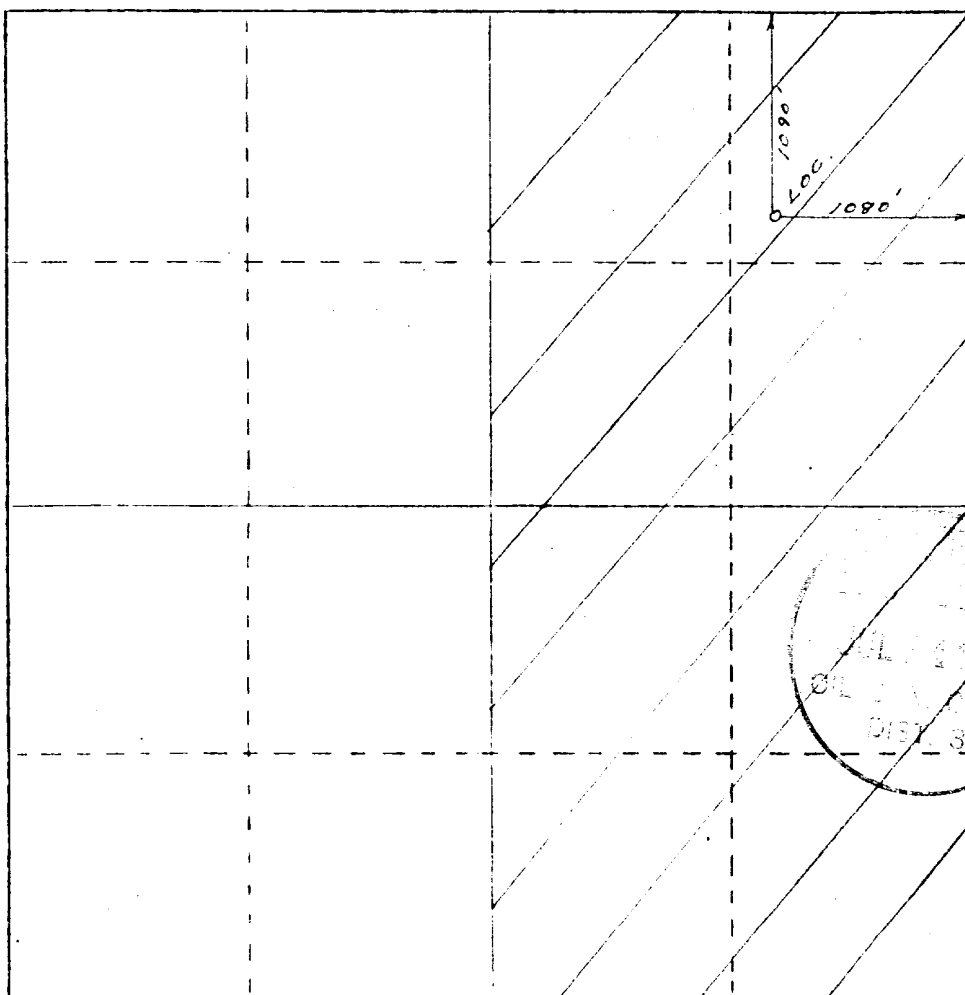

CERTIFICATION

I hereby certify that the information contained herein is true and complete to the best of my knowledge and belief.

*George Kapaseotes*  
Name: *George Kapaseotes*  
Position: *V. President Powers Elevation*

Agent Consultant for

Company: *Supron Energy Corporation*

Date: *May 22, 1980*

I hereby certify that the well location shown on this plat was plotted from field notes of actual surveys made by me or under my supervision, and that the same is true and correct to the best of my knowledge and belief.

*28*  
Date: *May 22, 1980*  
*6844*  
Registered Professional Land Surveyor  
and/or Surveyor

*6844*  
REGISTERED LAND SURVEYOR

Certificate No. \_\_\_\_\_

450 600 750 900 1050 1200 1350 1500 1650 1800 1950 2100 2250 2400 2550 2700 2850 3000 3150 3300 3450 3600 3750 3900 4050 4200 4350 4500 4650 4800 4950 5100 5250 5400 5550 5700 5850 6000 6150 6300 6450 6600 6750 6900 7050 7200 7350 7500 7650 7800 7950 8100 8250 8400 8550 8700 8850 9000 9150 9300 9450 9600 9750 9900 10000

EXHIBIT "B"

TEN-POINT COMPLIANCE PROGRAM

OF NTL-6 APPROVAL OF OPERATIONS

Attached to From 9-331C  
Supron Energy Corporation  
Taliaferro #6  
NE NE Sec. 30 T31N R12W  
1090' FNL & 1080' FEL  
San Juan County, New Mexico

1. The Geological Surface Formation

The surface formation is the Wasatch.

2. Estimated Tops of Important Geologic Markers

Ojo Alamo	520'
Kirtland	820'
Fruitland	2010'
Pictured Cliffs	2285'
Chacra	3120'
Cliffhouse	3880'
Point Lookout	4650'
Total Depth	5030'

3. Estimated Depths of Anticipated Water, Oil, Gas or Minerals

Ojo Alamo	520'	Water
Kirtland	820'	Water
Fruitland	2010'	Water
Pictured Cliffs	2285'	Gas
Chacra	3120'	Water
Cliffhouse	3880'	Gas
Point Lookout	4650'	Gas

4. The Proposed Casing Program

<u>HOLE SIZE</u>	<u>INTERVAL</u>	<u>SECTION LENGTH</u>	<u>SIZE (OD)</u>	<u>WEIGHT GRADE &amp; JOINT</u>	<u>NEW OR USED</u>
12-1/4"	0-300'	300'	8-5/8"	24# K-55 ST&C	New
6-1/4"	0-5030'	5030'	4-1/2"	10.5# CW-55 ST&C	New

Cement Plans: 2 Stage - D.V. Tool to cover Pictured Cliffs

5. The Operator's Minimum Specifications for Pressure Control

EXHIBIT "C" is a schematic diagram of the blowout preventer equipment. The BOP's will be hydraulically tested to half of working pressure after nipping up and after any use under pressure. Pipe rams will be operationally checked each 24-hour period, as will blind rams each time pipe is pulled out of the hole. Such checks of BOP will be noted on daily drilling reports.

Accessories to BOP will include a floor safety valve, drill string BOP and choke manifold with pressure rating equivalent to the BOP stack.

6. The Type and Characteristics of the Proposed Circulating Muds

Mud system will be fresh water gel with adequate stocks of sorptive agents on site to handle possible spills of fuel and oil on the surface. Heavier muds will be on location to be added if pressure requires.

<u>DEPTH</u>	<u>TYPE</u>	<u>WEIGHT#/gal.</u>	<u>VISCOSITY-sec./qt.</u>	<u>FLUID LOSS cc</u>
0-300'	Natural Mud	-----	-----	----
300-TD	Fresh Water Gel	8.4 - 9.5	35 - 45	less than 10

7. The Auxiliary Equipment to be Used

- (a) No kelly cock will be used.
- (b) A float will be used at the bit.
- (c) Neither a mud logging unit nor a gas detecting device will be monitoring the system.
- (d) A stabbing valve will be on the floor to be stabbed into the drill pipe when kelly is not in the string.

8. The Testing, Logging and Coring Programs to be Followed

- (a) No DST's are anticipated.
- (b) The logging program will consist of an IES and a GR Density over selected intervals. Other logs will be determined at well site to best evaluate any shows.
- (c) No coring is anticipated.
- (d) Stimulation procedures will be determined after evaluation of logs. If treatment is indicated, appropriate Sundry Notice will be submitted.

9. Any Anticipated Abnormal Pressures or Temperatures

No abnormal pressures or temperatures have been noted or reported in wells drilled in the area nor at the depths anticipated in this well.

No hydrogen sulfide or other hazardous fluids or gases have been found, reported or known to exist at these depths in the area.

10. Anticipated Starting Date and Duration of the Operations

The anticipated starting date is set for June 30, 1980, or as soon as possible after examination and approval of drilling requirements. Operations should be completed within 10 days after spudding the well and drilling to casing point.

# Blowout Preventer Diagram

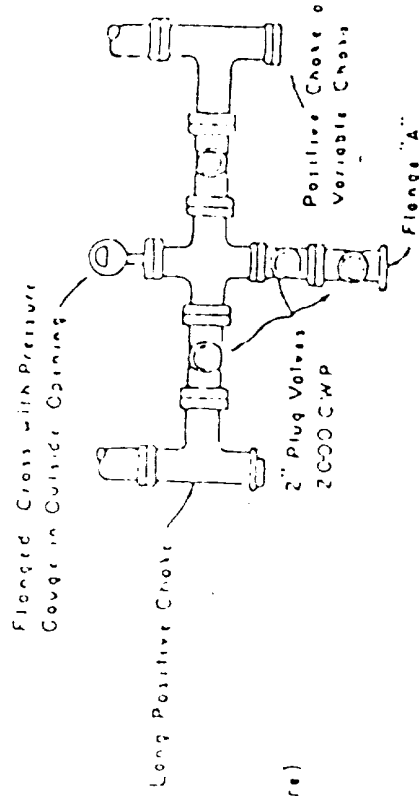
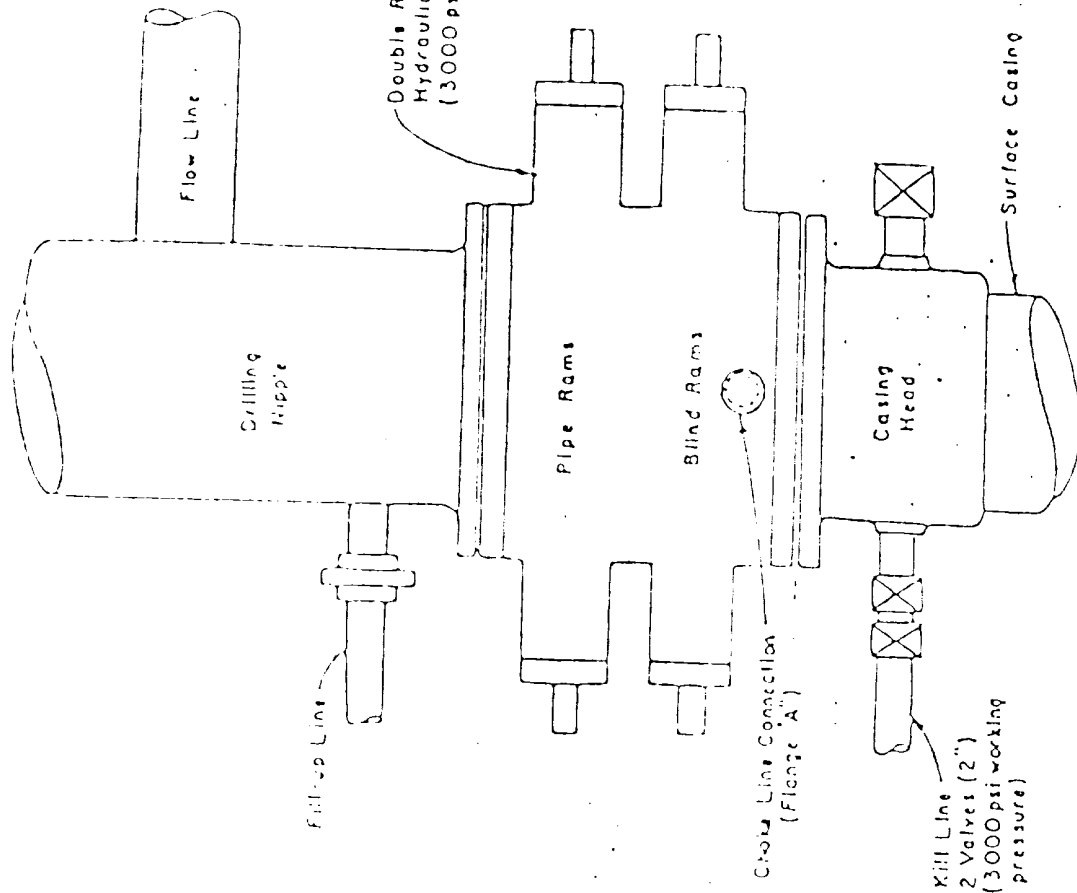

PLAN VIEW-CHOKE MANIFOLD

EXHIBIT "D"

MULTI-POINT REQUIREMENTS TO ACCOMPANY A.P.D.

Attached to Form 9-331C  
Supron Energy Corporation  
Taliaferro #6  
NE NE Sec. 30 T31N R12W  
1090' FNL & 1080' FEL  
San Juan County, New Mexico

1. Existing Roads

- A. The proposed well site and elevation plat is shown as EXHIBIT "A".
- B. The distance from Flora Vista, New Mexico is 6.1 miles. From Highway #550 proceed Northwest on CR A-115 (Flora Vista Arroyo) road 0.3 mile; bear North 1.4 miles, bear Northwest 3.5 miles to Farmington Glade, thence Northeast on oil field road 0.3 mile, thence Northwest along existing well road 0.4 mile to beginning of access road, thence 0.2 mile on access road to location, as shown on EXHIBIT "E".
- C. All roads to location are color-coded on EXHIBIT "E". A new access road 0.2 mile from the existing dirt road will be required, as shown on EXHIBIT "E".
- D. N/A
- E. This is a development well. All existing roads within a one-mile radius are shown on EXHIBIT "E".
- F. The existing roads need no improvement.

2. Planned Access Roads

Map showing all necessary access roads to be constructed or reconstructed is shown as EXHIBIT "E" for the following:

- (1) The maximum width of the running surface of the 0.2 mile of access road, extending beyond the existing dirt road will be 18'.
- (2) The grade will be 8% (eight percent) or less.
- (3) No turn outs are planned.

- (4) Appropriate water bars will be constructed to assure drainage off location to conform with the natural drainage pattern.
- (5) No culverts are needed. No major cuts or fills are anticipated along access road during drilling operation.
- (6) Surfacing materials will be native soil.
- (7) No gates, cattle guards, or fence cuts are needed.
- (8) The new access road to be constructed was staked and centerline flagged, as shown on EXHIBIT "E".

3. Location of Existing Wells

For all existing wells within a one mile radius of development well, see EXHIBIT "F".

- (1) There are no water wells withn a one-mile radius of this location.
- (2) There is one abandoned well in this one-mile radius.
- (3) There are no temporarily abandoned wells.
- (4) There are no disposal wells.
- (5) There are no wells presently being drilled.
- (6) There are 7 producing wells within this one-mile radius.
- (7) There are no shut-in wells.
- (8) There are no injection wells.
- (9) There are no monitoring or observation wells for other uses.

4. Location of Existing and/or Proposed Facilities

- A. Within a one-mile radius of location the following existing facilities are owned or controlled by lessee/operator:
  - (1) Tank Batteries: None
  - (2) Production Facilities: None
  - (3) Oil Gathering Lines: None
  - (4) Gas Gathering Lines: None
  - (5) Injection Lines: None
  - (6) Disposal Lines: None



- B. If the well is productive, new facilities will be as follows:
- (1) Production facilities will be located on solid ground of the drill pad, as shown on EXHIBIT "G".
  - (2) All well flow lines will be buried and will be on the well site and battery site.
  - (3) Facilities will be 300 feet long and 150 feet wide.
  - (4) All construction materials for battery site and pad will be obtained from site. No additional material from outside sources is anticipated.
  - (5) Any necessary pits will be fenced and flagged to protect livestock and wildlife.
- C. Rehabilitation, whether well is productive or dry, will be made on all unused areas in accordance with B.L.M. stipulations.

5. Location and Type of Water Supply

- A. The source of water will be the San Juan River 7 miles South of the location.
- B. Water will be transported by truck over existing roadways.
- C. No water well is to be drilled on this lease.

6. Construction Materials

- A. No construction materials are needed for drilling well or constructing access roads into the drilling location unless well is productive. The surface soil materials will be sufficient or will be purchased from Dirt Contractor as needed.
- B. No construction materials will be taken off Federal land.
- C. All surface soil materials for construction of access roads are sufficient.
- D. All major access roads presently exist as shown on EXHIBIT "E".

7. Handling of Waste Materials and Disposal

- (1) Drill cuttings will be buried in the reserve pit.
- (2) Drilling fluids will be handled in the reserve pit.

- (3) Any fluids produced during drilling test or while making production test will be collected in a test tank. If a test tank is not available during drilling, fluids will be handled in reserve pit. Any spills of oil, gas, salt water or other noxious fluids will be cleaned up and removed.
- (4) Chemical toilet facilities will be provided for human waste.
- (5) Garbage, waste, salts and other chemicals produced during drilling or testing will be handled in trash/burn pit. Drill fluids, water, drilling mud and tailings will be kept in reserve pit, as shown on EXHIBIT "H". The trash/burn pit will be totally enclosed with small mesh wire to prevent wind scattering trash before being burned or buried. Reserve pit will be fenced on three sides and the fourth side fenced upon removal of the rig.
- (6) After the rig moves out, all materials will be cleaned up and no adverse materials will be left on location. Any dangerous open pit will be fenced during drilling and kept closed until the pit has dried and is filled.

8. Ancillary Facilities

No air strip, camp or other facilities will be built during drilling of this well.

9. Well Site Layout

- (1) EXHIBIT "G" is the Drill Pad Layout as staked, with elevations, by Powers Elevation of Durango, Colorado. Cuts and fills have been drafted to visualize the planned cut across the location spot and the deepest part of the pad. Topsoil will be stockpiled per BL, specifications determined at time of pre-drill inspection.
- (2) EXHIBIT "H" is a plan diagram of the proposed rig and equipment, reserve pit, trash/burn pit, pipe racks and mud tanks. No permanent living facilities are planned. There will be a trailer on site.
- (3) EXHIBIT "G" is a diagram showing the proposed production facilities layout.
- (4) The reserve pits will not be lined.

10. Plans for Restoration

- (1) Backfilling, leveling and contouring are planned as soon as all pits have dried. Waste disposal and spoils materials will be buried or hauled away immediately after drilling is completed. If production is obtained, the unused area will be restored as soon as possible.

- (2) The soil banked material will be spread over the area. Revegetation will be accomplished by planting mixed grasses as per formula provided by the BLM. Revegetation is recommended for road area, as well as around drill pad.
- (3) Three sides of the reserve pit will be fenced during drilling operations. Prior to rig release, the reserve pit will be fenced on the fourth side to prevent livestock or wildlife from becoming entrapped; and the fencing will be maintained until leveling and cleanup are accomplished.
- (4) If any oil is on the pits and is not immediately removed after operations cease, the pit containing the oil or other adverse substances will be flagged overhead or covered with wire mesh.
- (5) The rehabilitation operations will begin immediately after the drilling rig is removed. Removal of oil or other adverse substances will begin immediately or area will be flagged and fenced. Other cleanup will be done as needed. Planting and revegetation is considered best in Fall, 1981, unless requested otherwise.

11. Other Information

- (1) The soil is a sandy-clay loam. No distinguishing geological features are present. The area is covered with sagebrush, cedar and native grass. There are rabbits and deer in the area. The topography is sloping South.
- (2) The primary surface use is for grazing. The surface is owned by the U.S. Government.
- (3) The closest live water is the San Juan River 7 miles South of the location.

The closest occupied dwellings are the residents of Flora Vista 6.1 miles Southeast of the location, as shown on EXHIBIT "E".

There are no known archaeological, historical, or cultural heritages that will be disturbed by this drilling.

- (4) There are no reported restrictions or reservations noted on the oil and gas lease.
- (5) Drilling is planned for on or about June 30, 1980. It is anticipated that the casing point will be reached within 10 days after commencement of drilling.

12. Lessee's or Operator's Representative

George Lapaseotes  
Agent Consultant for  
Supron Energy Corporation  
600 South Cherry Street  
Suite 1201  
Denver, Colorado 80222  
Phone (303) 321-2217

Jerry L. Lee  
Supron Energy Corporation  
c/o Gordon L. Llewellyn  
Suite 140 Campbell Centre  
8350 North Central Expressway  
Dallas, Texas 75206  
Phone (214) 692-7021

13. Certification

I hereby certify that I, or persons under my direct supervision, have inspected the proposed drillsite and access route; that I am familiar with the conditions which presently exist; that the statements made in this plan are, to the best of my knowledge, true and correct; and, that the work associated with the operations proposed herein will be performed by Supron Energy Corporation and its contractors and subcontractors in conformity with this plan and the terms and conditions under which it is approved.

5-22-80  
Date

  
George Lapaseotes  
Agent Consultant for  
Supron Energy Corporation

EXHIBIT "E"

Access Roads to Location

1. Location:

Color Coding

Supron Energy Corp.  
Taliaferro #6  
NE NE Sec. 30 T31N R12W  
San Juan County, New Mexico

Dirt Trail  
New Access Road

2. Closest Town/Closest Dwelling

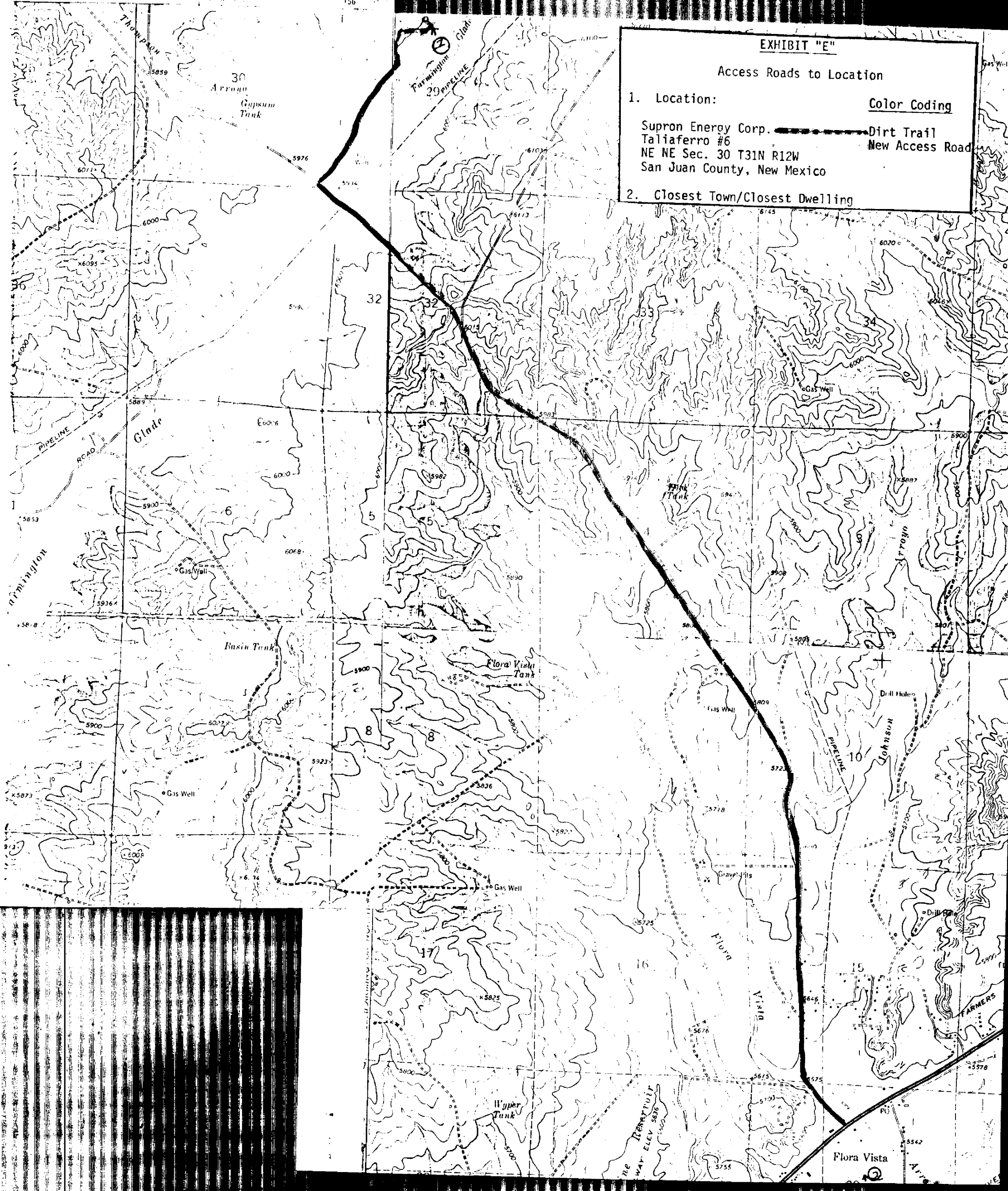

EXHIBIT "F"  
Radius Map of Field

173

one-mile RADIUS

Taliaferro #6

AZTEC  
6194' 5  
7232'

CONSOLIDATED  
5135  
5916  
5900'

LEGEND

- |                       |                            |
|-----------------------|----------------------------|
| ○ LOCATION            | ★ OIL & GAS WELL           |
| ◇ DRY HOLE            | ★ ABANDONED OIL & GAS WELL |
| ● OIL WELL            | ★ GAS WELL                 |
| ◆ ABANDONED OIL WELL  | ★ ABANDONED GAS WELL       |
| △ TRIANGULATION POINT | ○ WATER WELL               |

550

EXHIBIT "G" - Drill Pad Layout, Production Facilities & Cut-Fill Cross Section



POWERS ELEVATION

Taliaferro #6

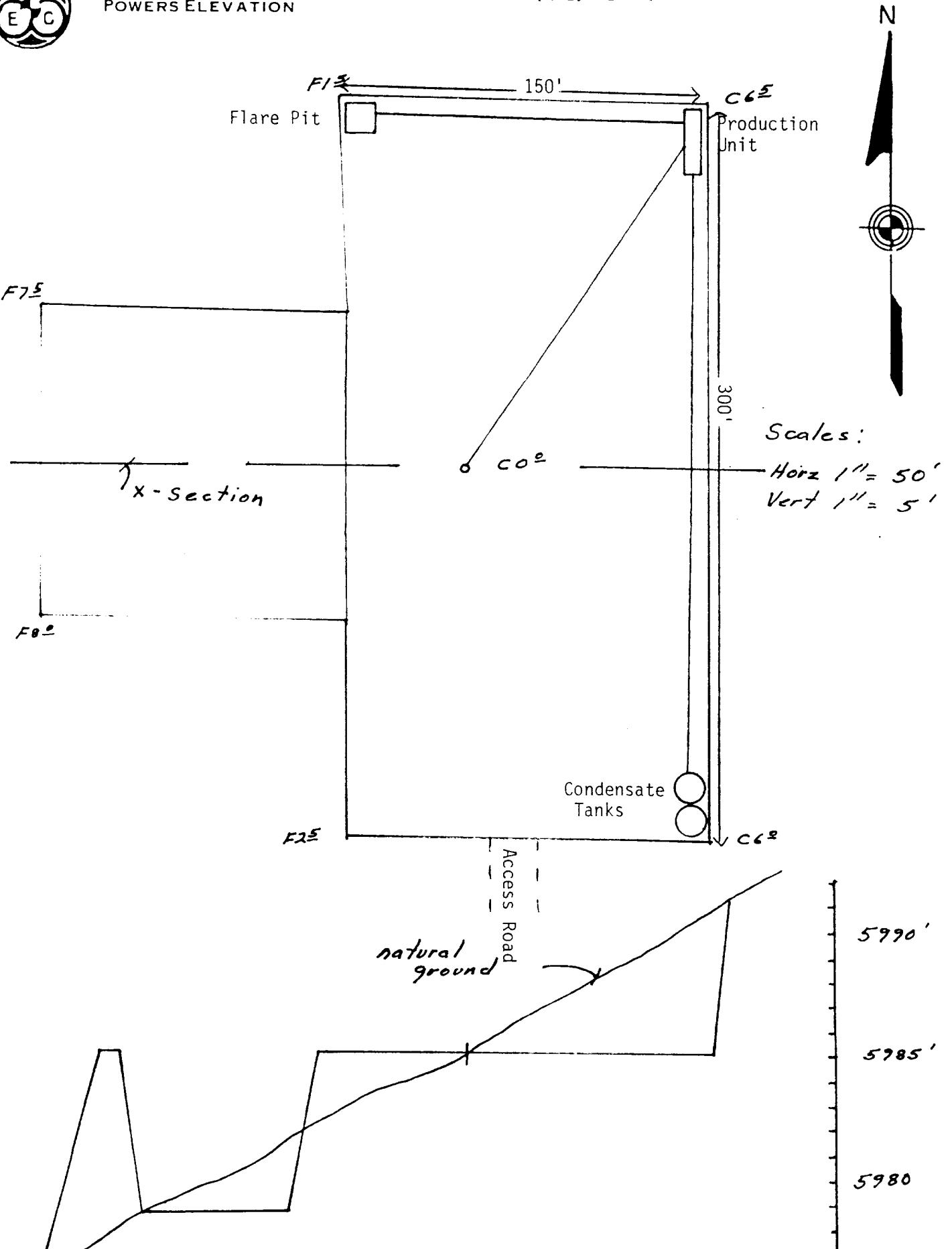

Supron Energy Corporation  
Taliaferro #6  
Sec. 30 T31N R12W  
1090' FNL & 1080' FEL  
San Juan County, New Mexico

EXHIBIT "H"  
Drill Rig Layout

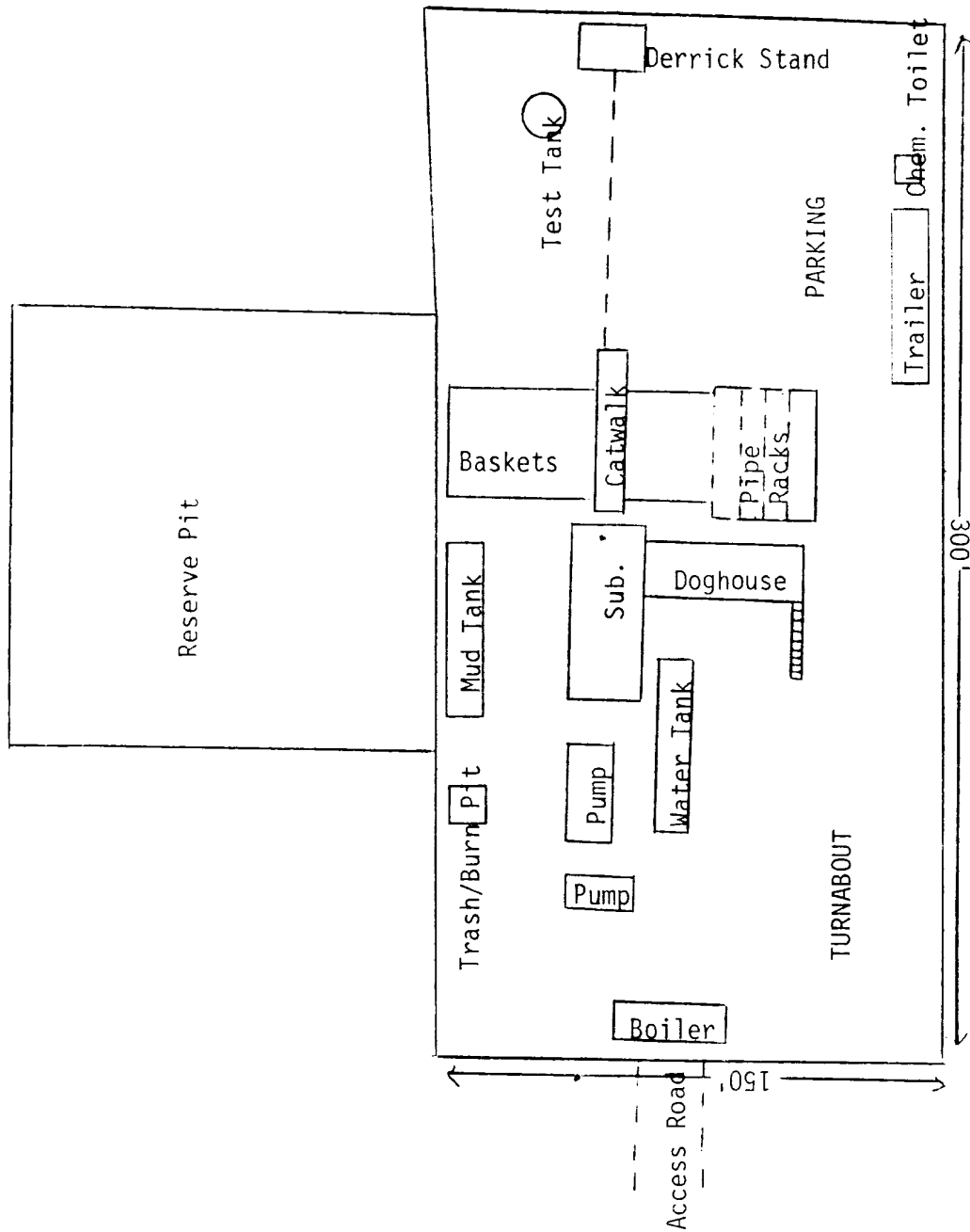

SCALE  
1" = 50'

