

<b>Operator:</b> <u>PNM Gas Services ( RC Resources )</u>		<b>Telephone:</b> <u>324-3764</u>	
<b>Address:</b> <u>603 W. Elm Street Farmington, NM 87401</u>			
<b>Facility or Well Name:</b> <u>Taliaferro #6</u>			
<b>Location:</b>	Unit <u>A</u>	Sec <u>30</u>	T <u>31 N</u> R <u>12 W</u> County <u>San Juan</u>
<b>Pit Type:</b>	Separator <input type="checkbox"/>	Dehydrator <input checked="" type="checkbox"/>	Other _____
<b>Land Type:</b>	BLM <input type="checkbox"/>	State <input type="checkbox"/>	Fee <input checked="" type="checkbox"/> Other _____
<b>Pit Location:</b> Pit dimensions: length <u>20</u> ' width <u>20</u> ' depth <u>5</u> '			
(Attach diagram)	Reference: wellhead <input checked="" type="checkbox"/> other _____		
Footage from reference: <u>150'</u>			
Direction from reference: <u>43</u> Degrees <input checked="" type="checkbox"/> East <input checked="" type="checkbox"/> North <input type="checkbox"/> South <input type="checkbox"/> West			
<b>Depth to Ground Water:</b>			
(Vertical distance from contaminants to seasonal high water elevation of ground water)		Less than 50 feet	(20 points)
		50 feet to 99 feet	(10 points)
		Greater than 100 feet	( 0 points)
			<u>0</u>
<b>Wellhead Protection Area:</b>			
(Less than 200 feet from a private domestic water source, or, less than 1,000 feet from all other water sources)		Yes	(20 points)
		No	( 0 points)
			<u>0</u>
<b>Distance to Surface Water:</b>			
(Horizontal distance to perennial lakes, ponds, rivers, streams, creeks, irrigation canals and ditches)		Less than 200 feet	(20 points)
		200 feet to 1,000 feet	(10 points)
		Greater than 1,000 feet	( 0 points)
			<u>0</u>
<b>RANKING SCORE (TOTAL POINTS) :</b>			<u>0</u>



Taliaferro #6

Date Remediation Started: 06/07/1999

Date Completed: 06/07/1999

Remediation Method: Excavation ☒ Approx. Cubic Yard 510

(Check all appropriate sections)

Landfarmed ☒ Amount Landfarmed (cubic yds) 450

Other 60 cu yds clean overburden.

Remediation Location: Onsite ☒ Offsite

(i.e., landfarmed onsite, name and location of offsite facility)

Backfill Material Location:

General Description of Remedial Action:

Excavated contaminated soil to a pit size of 24.5' X 37.5' X 15' and landfarmed soil onsite within a bermed area at a depth of 6" to 12". Soil was aerated by disking/plowing until soil met regulatory levels.

Ground Water Encountered: No ☒ Yes ☐ Depth

Final Pit Closure Sampling:

Sample Location 5 pt composite-bottom

(if multiple samples, attach sample result and diagram of sample locations and depths.)

Sample depth 15'

Sample date 06/07/1999

Sample time 1:30:00 PM

Sample Results

Benzene (ppm) 0.053

Total BTEX (ppm) 0.915

Field headspace (ppm)

TPH (ppm) &lt; 25.00

Method 8015B

Vertical Extent (ft)

Risk Analysis form attached Yes ☐ No ☒

Ground Water Sample:

Yes ☐No ☒

(If yes, see attached Groundwater Site Summary Report)

I HEREBY CERTIFY THAT THE INFORMATION ABOVE IS TRUE AND COMPLETE TO THE BEST OF MY KNOWLEDGE AND MY BELIEF

DATE January 24, 2000

SIGNATURE



PRINTED NAME Maureen Gannon  
AND TITLE Project Manager

Taliaferro #5M  
 (A) 30-31N-12W  
 RL Resources  
 6-7-94 @ 0826

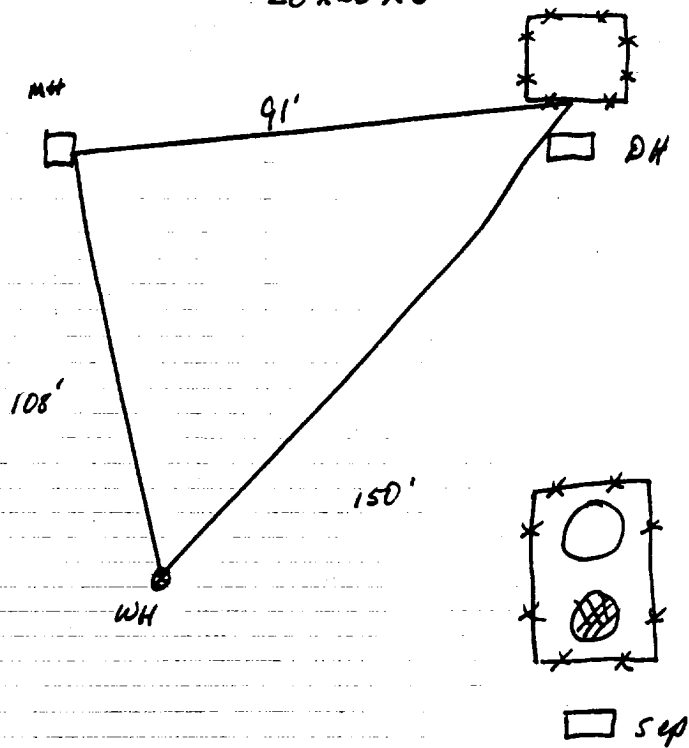

### Excavation Sampling

24.5' (N45) x 37.5' (E40) x 16' (D)

### PID Readings

5' - 2489 ppm  
 10' - 2107 ppm  
 15' - 1708 ppm

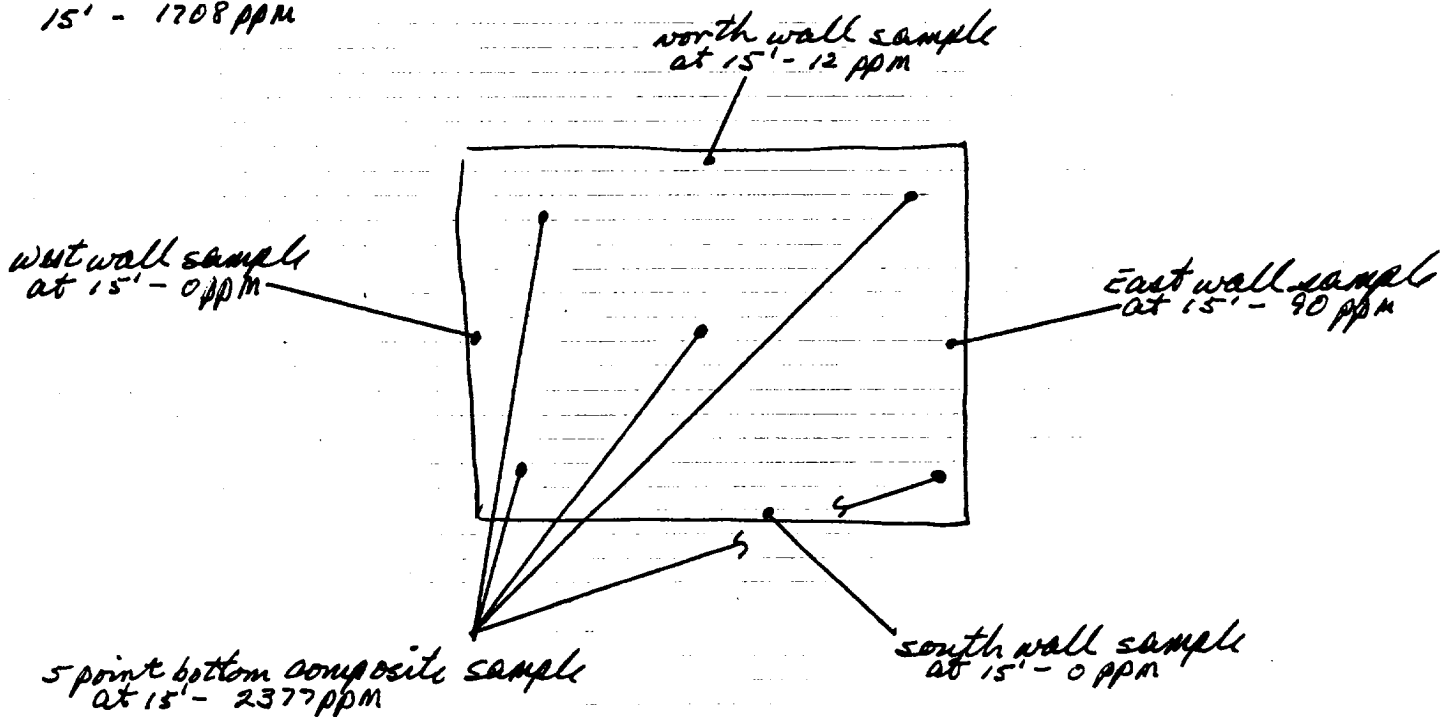

OFF: (505) 325-5667



LAB: (505) 325-1556

**On Site Technologies, LTD.**

**Date:** 23-Jun-99

---

**CLIENT:** PNM - Public Service Company of NM  
**Project:** Taliaferro #5M & #6  
**Lab Order:** 9906024

**CASE NARRATIVE**

---

Samples were analyzed using the methods outlined in the following references:

Test Methods for Evaluating Solid Waste, Physical/Chemical Methods, SW846, 3rd Edition

All method blanks, laboratory spikes, and/or matrix spikes met quality assurance objectives.

RH

OFF: (505) 325-5667



LAB: (505) 325-1556

## ANALYTICAL REPORT

Date: 23-Jun-99

<b>Client:</b>	PNM - Public Service Company of NM	<b>Client Sample Info:</b>	Taliaferro #6
<b>Work Order:</b>	9906024	<b>Client Sample ID:</b>	9906071330; 5pt. Bottom Comp
<b>Lab ID:</b>	9906024-03A	<b>Matrix:</b>	SOIL
<b>Project:</b>	Taliaferro #5M & #6	<b>Collection Date:</b>	6/7/99 1:30:00 PM
		<b>COC Record:</b>	7634

Parameter	Result	PQL	Qual	Units	DF	Date Analyzed
<b>DIESEL RANGE ORGANICS</b>		<b>SW8015B</b>				Analyst: DC
T/R Hydrocarbons: C10-C28	ND	25		mg/Kg	1	6/16/99
<b>AROMATIC VOLATILES BY GC/PID</b>		<b>SW8021B</b>				Analyst: DC
Benzene	53	25		µg/Kg	25	6/18/99
Toluene	290	50		µg/Kg	25	6/18/99
Ethylbenzene	62	25		µg/Kg	25	6/18/99
m,p-Xylene	430	50		µg/Kg	25	6/18/99
o-Xylene	80	25		µg/Kg	25	6/18/99

915  
915 ppm

**Qualifiers:**

PQL - Practical Quantitation Limit

ND - Not Detected at Practical Quantitation Limit

J - Analyte detected below Practical Quantitation Limit

B - Analyte detected in the associated Method Blank

S - Spike Recovery outside accepted recovery limits

R - RPD outside accepted recovery limits

E - Value above quantitation range

Surr: - Surrogate

1 of 1

OFF: (505) 325-5667



LAB: (505) 325-1556

## ANALYTICAL REPORT

Date: 23-Jun-99

<b>Client:</b>	PNM - Public Service Company of NM	<b>Client Sample Info:</b>	Taliaferro #6
<b>Work Order:</b>	9906024	<b>Client Sample ID:</b>	9906071335; 4pt. Wall Comp
<b>Lab ID:</b>	9906024-04A	<b>Matrix:</b>	SOIL
<b>Project:</b>	Taliaferro #5M & #6	<b>Collection Date:</b>	6/7/99 1:35:00 PM
		<b>COC Record:</b>	7634

Parameter	Result	PQL	Qual	Units	DF	Date Analyzed
<b>DIESEL RANGE ORGANICS</b>		<b>SW8015B</b>				Analyst: DC
T/R Hydrocarbons: C10-C28	ND	25		mg/Kg	1	6/14/99

**Qualifiers:**

PQL - Practical Quantitation Limit  
ND - Not Detected at Practical Quantitation Limit  
J - Analyte detected below Practical Quantitation Limit  
B - Analyte detected in the associated Method Blank

S - Spike Recovery outside accepted recovery limits  
R - RPD outside accepted recovery limits  
E - Value above quantitation range  
Surr: - Surrogate

1 of 1

Taliaferro # 6  
sec-30 T-31N R-12W Q-L-A  
RC Resources

Landfarm Drawing App 450 cu yds

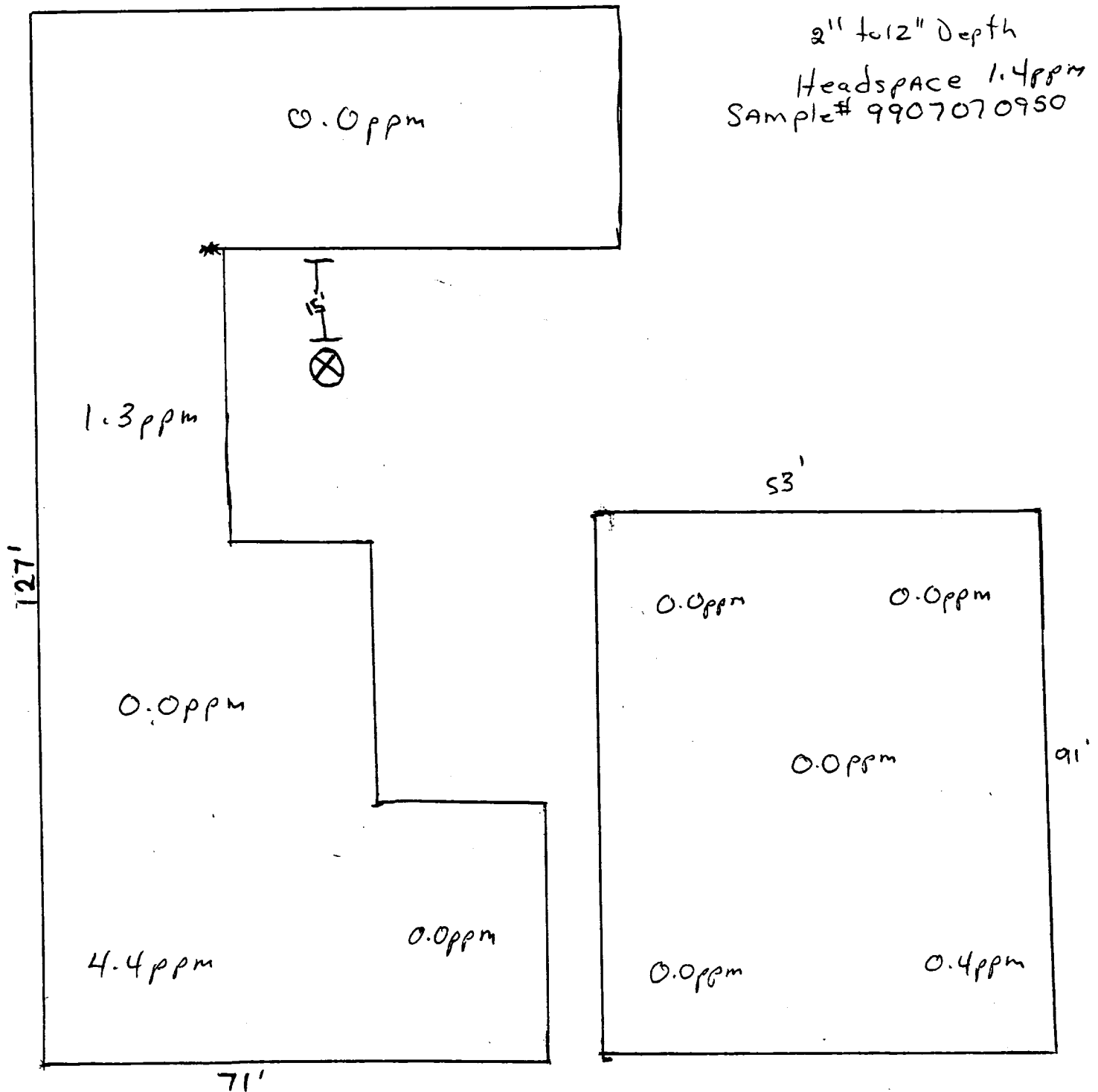

Not to Scale



OFF: (505) 325-5667



LAB: (505) 325-1556

**On Site Technologies, LTD.**

**Date:** 20-Jul-99

---

**CLIENT:** PNM - Public Service Company of NM  
**Project:** Sadie West, Nye Fed., Taliaferro 4E & 6  
**Lab Order:** 9907011

---

**CASE NARRATIVE**

Samples were analyzed using the methods outlined in the following references:

Test Methods for Evaluating Solid Waste, Physical/Chemical Methods, SW846, 3rd Edition

All method blanks, laboratory spikes, and/or matrix spikes met quality assurance objectives.

OFF: (505) 325-5667



LAB: (505) 325-1556

(Roy)

## ANALYTICAL REPORT

Date: 20-Jul-99

<b>Client:</b>	PNM - Public Service Company of NM	<b>Client Sample Info:</b>	Taliaferro #6 LF
<b>Work Order:</b>	9907011	<b>Client Sample ID:</b>	9907070950; 10pt Comp
<b>Lab ID:</b>	9907011-04A	<b>Matrix:</b>	SOIL
<b>Project:</b>	Sadie West, Nye Fed., Taliaferro 4E & 6	<b>Collection Date:</b>	7/7/99 9:50:00 AM
		<b>COC Record:</b>	7728

Parameter	Result	PQL	Qual	Units	DF	Date Analyzed
<b>DIESEL RANGE ORGANICS</b>		<b>SW8015B</b>				<b>Analyst: DC</b>
T/R Hydrocarbons: C10-C28	ND	25		mg/Kg	1	7/19/99

**Qualifiers:**

PQL - Practical Quantitation Limit

ND - Not Detected at Practical Quantitation Limit

J - Analyte detected below Practical Quantitation Limit

B - Analyte detected in the associated Method Blank

S - Spike Recovery outside accepted recovery limits

R - RPD outside accepted recovery limits

E - Value above quantitation range

Surr: - Surrogate

1 of 1