

NO. OF COPIES RECEIVED		
DISTRIBUTION		
SANTA FE		
FILE		
U.S.G.S.		
LAND OFFICE		
OPERATOR		

NEW MEXICO OIL CONSERVATION COMMISSION

30-045-24602

Form C-101
Revised 1-1-65

5A. Indicate Type of Lease	
STATE <input type="checkbox"/>	FEE <input checked="" type="checkbox"/>
5. State Oil & Gas Lease No.	

APPLICATION FOR PERMIT TO DRILL, DEEPEN, OR PLUG BACK

1a. Type of Work		7. Unit Agreement Name	
b. Type of Well OIL WELL <input type="checkbox"/> GAS WELL <input checked="" type="checkbox"/> OTHER <input type="checkbox"/>		8. Farm or Lease Name	
2. Name of Operator		9. Well No.	
3. Address of Operator		10. Field and Pool, or Wildcat	
4. Location of Well		12. County	
UNIT LETTER <u>B</u> LOCATED <u>900</u> FEET FROM THE <u>North</u> LINE AND <u>1670</u> FEET FROM THE <u>East</u> LINE OF SEC. <u>26</u> TWP. <u>31N</u> RGE. <u>10W</u> NMPM		<u>Atlantic A</u> <u>13</u> <u>Blanco Pic.Cliffs</u> <u>San Juan</u>	
21. Elevations (Show whether DF, RT, etc.)		19. Proposed Depth	19A. Formation
6314' GL		3315'	Pic.Cliffs
21A. Kind & Status Plug. Bond	21B. Drilling Contractor	20. Rotary or C.T.	
statewide		Rotary	
22. Approx. Date Work will start			

23.

PROPOSED CASING AND CEMENT PROGRAM

SIZE OF HOLE	SIZE OF CASING	WEIGHT PER FOOT	SETTING DEPTH	SACKS OF CEMENT	EST. TOP
12 1/4"	8 5/8"	24.0#	120'	106 cu.ft.	surface
7 7/8"	4 1/2"	10.5#	3315'	715 cu.ft.	100% excess to cover Ojo Alamo 1745' (O.A.)

Selectively perforate and sandwater fracture the Pictured Cliffs formation

A 3000 psi WP and 6000 psi test double gate preventer equipped with blind and pipe rams will be used for blow out prevention on this well.

APPROVAL VALID
FOR 90 DAYS UNLESS
DRILLING COMMENCED,

This gas is dedicated.

EXPIRES 1-5-81

The NE/4 of Section 26 is dedicated to this well.



IN ABOVE SPACE DESCRIBE PROPOSED PROGRAM: IF PROPOSAL IS TO DEEPEN OR PLUG BACK, GIVE DATA ON PRESENT PRODUCTIVE ZONE AND PROPOSED NEW PRODUCTIVE ZONE. GIVE BLOWOUT PREVENTER PROGRAM, IF ANY.

I hereby certify that the information above is true and complete to the best of my knowledge and belief.

Signed Peggy Bradfield Title Drilling Clerk Date 9-29-80

(This space for State Use)

Original Signed by CHARLES GHOLSON

DEPUTY OIL & GAS INSPECTOR, DIST. #3

OCT 7 - 1980

APPROVED BY _____ TITLE _____ DATE _____

CONDITIONS OF APPROVAL, IF ANY:

OIL CONSERVATION DIVISION

P. O. BOX 2088

Form C-107
Revised 10-1-STATE OF NEW MEXICO
ENERGY AND MINERALS DEPARTMENT

SANTA FE, NEW MEXICO 87501

All distances must be from the outer boundaries of the Section.

Operator EL PASO NATURAL GAS COMPANY			Lease ATLANTIC A (FEE)		Well No. 13
Unit Letter B	Section 26	Township 31N	Range 10W	County San Juan	
Actual Footage Location of Well: 900 feet from the North line and 1670 feet from the East line					
Ground Level Elev: 6314	Producing Formation PICTURED CLIFFS		Pool BLANCO PICTURED CLIFFS	Dedicated Acreage: 160.00 Acres	

1. Outline the acreage dedicated to the subject well by colored pencil or hachure marks on the plat below.
2. If more than one lease is dedicated to the well, outline each and identify the ownership thereof (both as to working interest and royalty).
3. If more than one lease of different ownership is dedicated to the well, have the interests of all owners been consolidated by communitization, unitization, force-pooling, etc?

☐ Yes ☐ No If answer is "yes," type of consolidation _____

If answer is "no," list the owners and tract descriptions which have actually been consolidated. (Use reverse side of this form if necessary.) _____

No allowable will be assigned to the well until all interests have been consolidated (by communitization, unitization, forced-pooling, or otherwise) or until a non-standard unit, eliminating such interests, has been approved by the Commission.

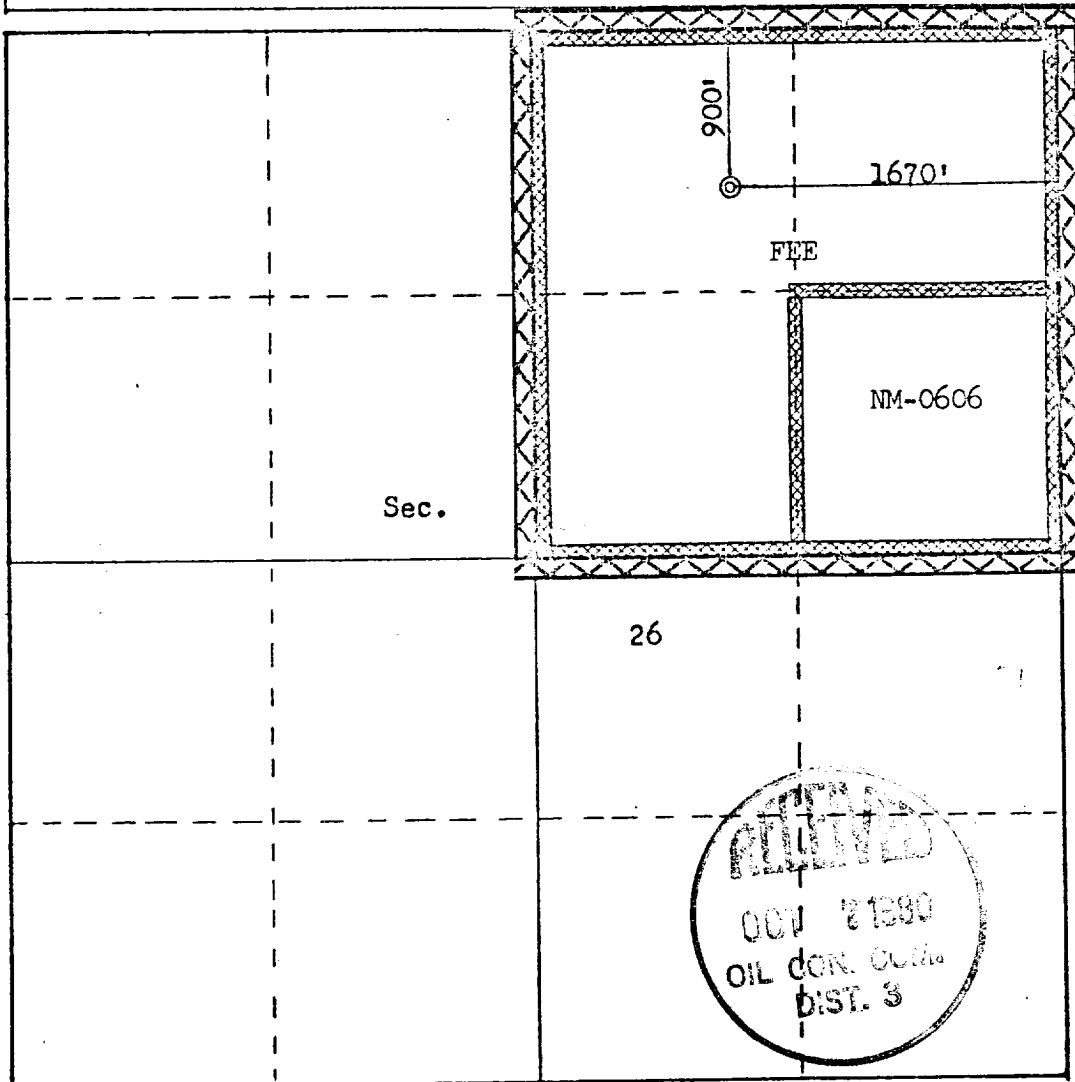

CERTIFICATION

I hereby certify that the information contained herein is true and complete to the best of my knowledge and belief.

Deputy Sheriff
Name

Drilling Clerk
Position

El Paso Natural Gas
Company

September 29, 1980
Date

I hereby certify that the well location shown on this plat was plotted from field notes of actual surveys made by me or under my supervision, and that the same is true and correct to the best of my knowledge and belief.

Date Surveyed
September 10, 1980

Registered Professional Engineer
and Land Surveyor

Fred B. Kerr Jr.
Fred B. Kerr Jr.

Certificate No. 3950

Scale: 1"=1000'