

All distances must be from the outer boundaries of the Section.

Operator UNION TEXAS PETROLEUM COMPANY			Lease CULPEPPER-MARTIN		Well No. 11M
Well Letter J	Section 6	Township 31N	Range 12W	County San Juan	
Actual Footage Location of Well:					
1720 feet from the South line and		1725 feet from the East line			
Ground Level Elev: 5915	Producing Formation Mesaverde, Dakota	Pool Blanco Mesaverde, Basin Dakota	Dedicated Acreage 315.48 Acres		

1. Outline the acreage dedicated to the subject well by colored pencil or hatchure marks on the plat below.
2. If more than one lease is dedicated to the well, outline each and identify the ownership thereof (both as to working interest and royalty).
3. If more than one lease of different ownership is dedicated to the well, have the interests of all owners been consolidated by communitization, unitization, force-pooling, etc?

☐ Yes ☐ No If answer is "yes," type of consolidation _____

If answer is "no," list the owners and tract descriptions which have actually been consolidated. (Use reverse side of this form if necessary.) _____

No allowable will be assigned to the well until all interests have been consolidated (by communitization, unitization, forced-pooling, or otherwise) or until a non-standard unit, eliminating such interests, has been approved by the Commission.

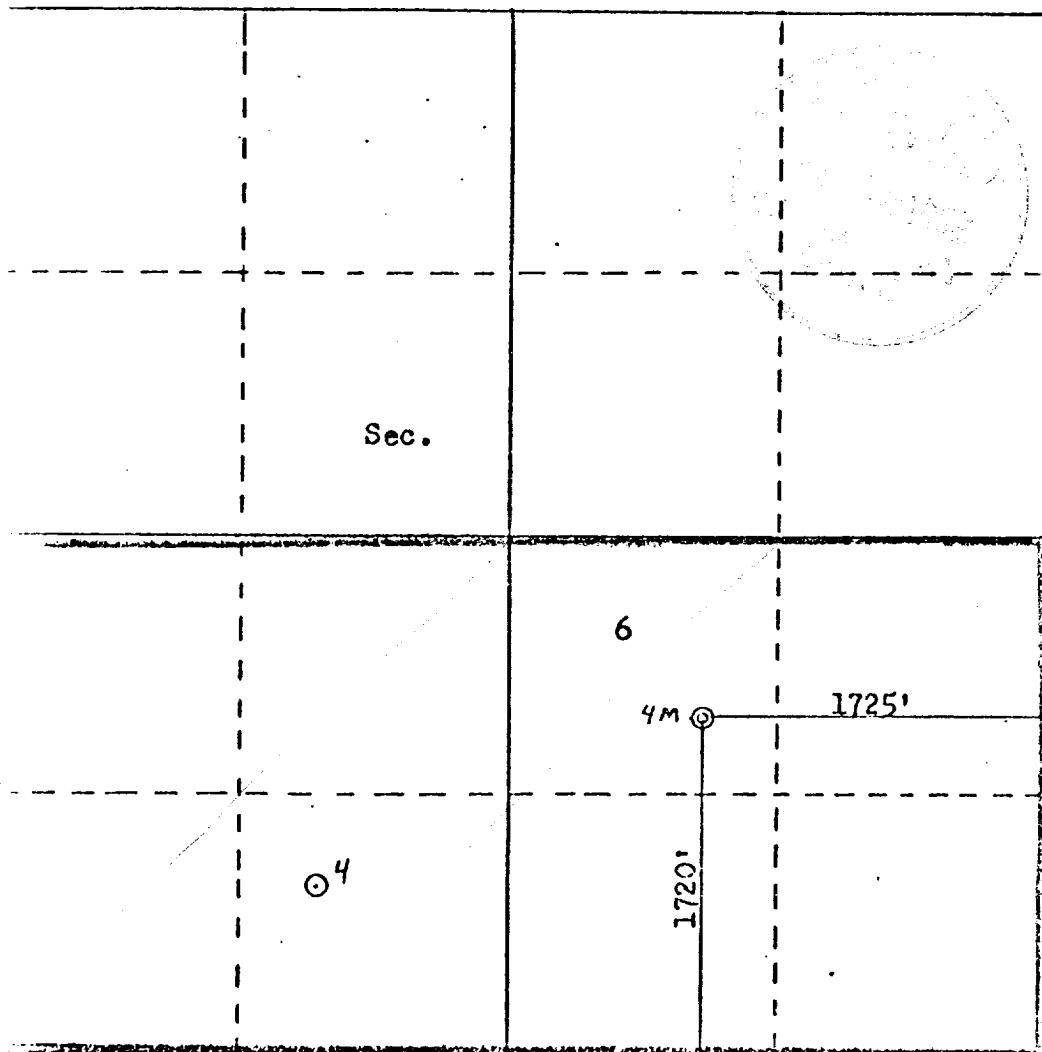

CERTIFICATION

I hereby certify that the information contained herein is true and complete to the best of my knowledge and belief.

Name Glenn C. Belton

Position
District Petroleum Engineer

Company
Union Texas Petroleum Corp.

Date
July 6, 1981

I hereby certify that the well location shown on this plat was plotted from field notes of actual surveys made by me or under my supervision, and that the same is true and correct to the best of my knowledge and belief.

Date Surveyed
June 17, 1981

Registered Professional Engineer and Land Surveyor

Fred B. Kerc, Jr.
Certified by Department