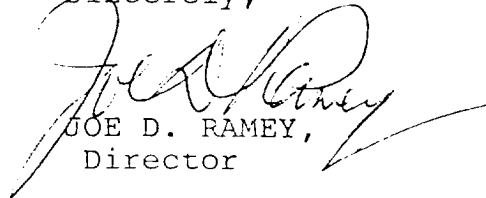

By authority granted me under the provisions of Rule 104 F of the Division Rules and Regulations, the above-described unorthodox locations are hereby approved.

Sincerely,

JOE D. RAMEY,
Director

JDR/RLS/dr

cc: Oil Conservation Division - Aztec
Oil & Gas Engineering Committee - Hobbs
Minerals Management Service - Farmington

RECEIVED

JUN 23 1983

OIL CON. DIV.
DIST. 3

By authority granted me under the provisions of Rule 104 F of the Division Rules and Regulations, the above-described unorthodox locations are hereby approved.

Sincerely,

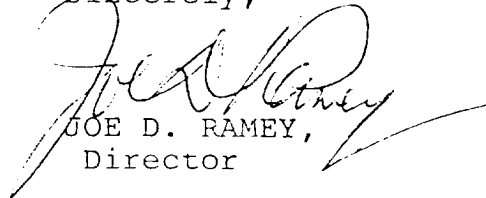
JOE D. RAMEY,
Director

JDR/RLS/dr

cc: Oil Conservation Division - Aztec
Oil & Gas Engineering Committee - Hobbs
Minerals Management Service - Farmington

RECEIVED

JUN 23 1983

OIL CON. DIV.
DIST. 3



STATE OF NEW MEXICO
ENERGY AND MINERALS DEPARTMENT

OIL CONSERVATION DIVISION
AZTEC DISTRICT OFFICE

1000 RIO BRAZOS ROAD
AZTEC, NEW MEXICO 87410
(505) 334-6178

OIL CONSERVATION DIVISION
BOX 2088
SANTA FE, NEW MEXICO 87501

DATE 6-9-83

RE: Proposed MC _____
Proposed DHC _____
Proposed NSL ☒ _____
Proposed SWD _____
Proposed WFX _____
Proposed PMX _____

Gentlemen:

I have examined the application dated 6-6-83
for the Solar Petroleum Corp Navajo Tribe of Indians F secs 4, 9, 10, 31A-17
Operator Lease and Well No. Unit, 'S-T-R'

and my recommendations are as follows:

Approve wells 147R, 158, 159, 160, 161, 162, 163, 164, 165, 166,
and 167 ✓

Yours truly,

Jeff A. Edmister
JAE

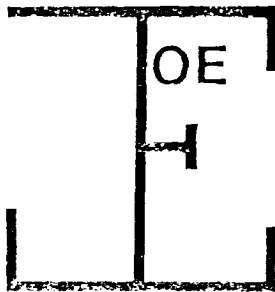

200 West 25th Street
Farmington, New Mexico 87401
(505) 327-9267
(505) 325-1873 (Car 2893)

LLEDGE

OIL and GAS PROPERTY MANAGEMENT

Mr. R. L. Stamets
State of New Mexico
Oil Conservation Division
P. O. Box 2088
Santa Fe, NM 87501

Re: Non-Standard Locations in the
Horseshoe Gallup Pool
Sections 4, 9, and 10, T31N, R17W
San Juan County, New Mexico

RECEIVED

JUN 6 1983

OIL CON. DIV.
DIST. 3

Dear Mr. Stamets:

Solar Petroleum, Inc. proposes to drill eleven non-standard oil wells to the Gallup sand on the Navajo Tribe of Indians Reservation as shown on the enclosed plat and listed on the enclosed application.

These proposed non-standard locations will maximize oil production and are located within a waterflood licensed by the State of New Mexico.

Yours truly,

Joe Elledge
Agent - Solar Petroleum, Inc.

JE:en

Attachments (2)

cc: Dave Cushman, Solar Petroleum, Inc.
Jeff Edmister, Oil Conservation Division

OIL CONSERVATION DIVISION

STATE OF NEW MEXICO
ENERGY AND MINERALS DEPARTMENTP. O. BOX 2088
SANTA FE, NEW MEXICO 87501Form C-102
Revised 10-1-78

All distances must be from the outer boundaries of the Section.

Operator SOLAR PETROLEUM, INCORPORATED			Lease NAVAJO TRIBE OF INDIANS "F"		Well No. 163
Init. Letter C	Section 9	Township 31N	Range 17W	County San Juan	
Actual Footage Location of Well:					
1310	feet from the	North	line and	2600	feet from the
					West
Ground Level Elev. 5230	Producing Formation Gallup		Pool Horseshoe Gallup		Dedicated Acreage: 40 Acres

1. Outline the acreage dedicated to the subject well by colored pencil or hachure marks on the plat below.
2. If more than one lease is dedicated to the well, outline each and identify the ownership thereof (both as to working interest and royalty).
3. If more than one lease of different ownership is dedicated to the well, have the interests of all owners been consolidated by communitization, unitization, force-pooling, etc?

☐ Yes ☐ No If answer is "yes," type of consolidation _____

If answer is "no," list the owners and tract descriptions which have actually been consolidated. (Use reverse side of this form if necessary.) _____

No allowable will be assigned to the well until all interests have been consolidated (by communitization, unitization, forced-pooling, or otherwise) or until a non-standard unit, eliminating such interests, has been approved by the Division.

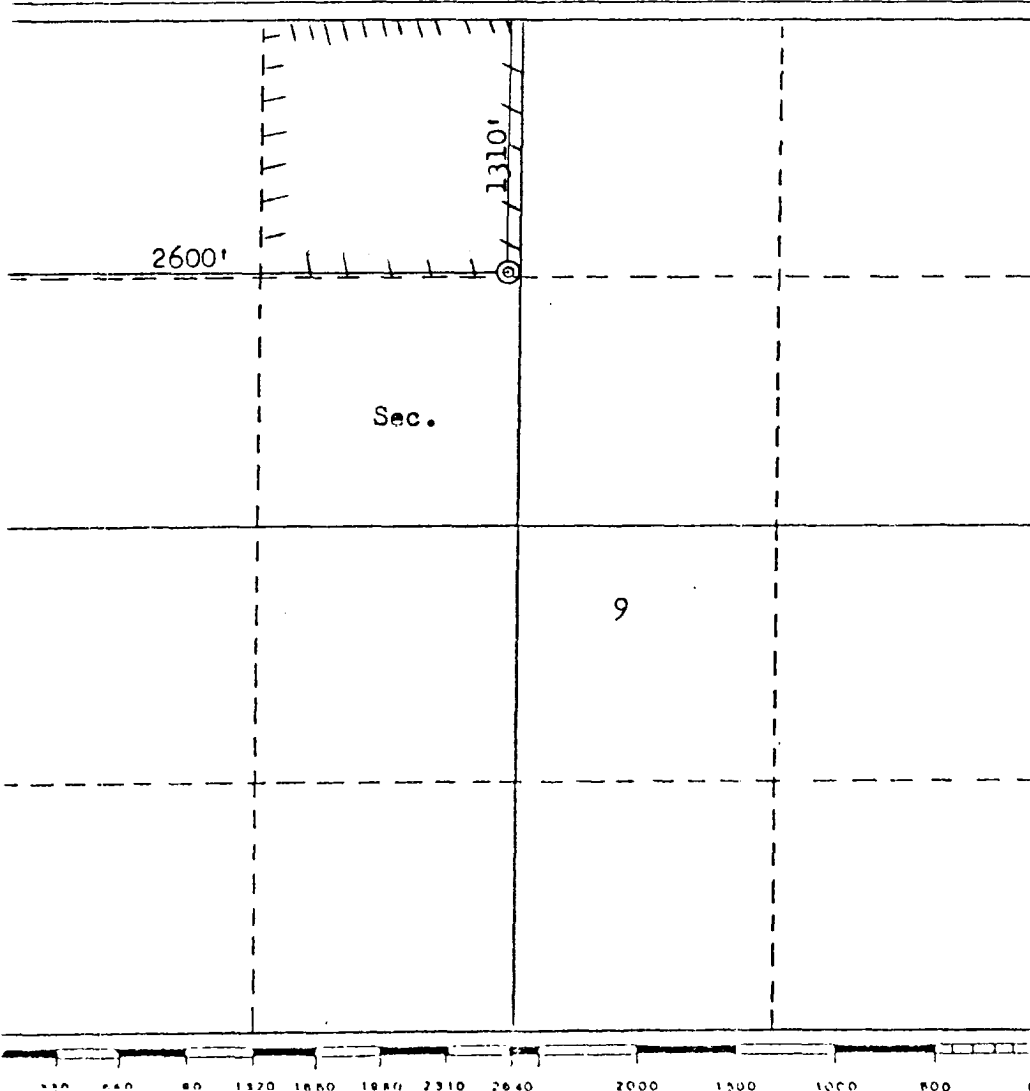

CERTIFICATION

I hereby certify that the information contained herein is true and complete to the best of my knowledge and belief.

Name

Position

Agent

Company

SOLAR PETROLEUM, INC.

Date

May 20, 1983

I hereby certify that the well location shown on this plat was plotted from field notes of actual surveys made by me or under my supervision, and that the same is true and correct to the best of my knowledge and belief.

Date Surveyed
(moved) May 17, 1983
May 31, 1983

Registered Professional Engineer
and/or Land Surveyor

Fred B. Kepp Jr.
Fred B. Kepp Jr.

Certificate No.

3950