

(SUBMIT IN TRIPLICATE)

Indian Agency Ute Indian

UNITED STATES
DEPARTMENT OF THE INTERIOR
GEOLOGICAL SURVEY

Allottee Ute Mountain Tribal
Lease No. Contract #14-20-151-45

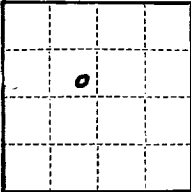

SUNDRY NOTICES AND REPORTS ON WELLS

NOTICE OF INTENTION TO DRILL.....	<input checked="" type="checkbox"/>	SUBSEQUENT REPORT OF WATER SHUT-OFF.....	
NOTICE OF INTENTION TO CHANGE PLANS.....		SUBSEQUENT REPORT OF SHOOTING OR ACIDIZING.....	
NOTICE OF INTENTION TO TEST WATER SHUT-OFF.....		SUBSEQUENT REPORT OF ALTERING CASING.....	
NOTICE OF INTENTION TO REDRILL OR REPAIR WELL.....		SUBSEQUENT REPORT OF REDRILLING OR REPAIR.....	
NOTICE OF INTENTION TO SHOOT OR ACIDIZE.....		SUBSEQUENT REPORT OF ABANDONMENT.....	
NOTICE OF INTENTION TO PULL OR ALTER CASING.....		SUPPLEMENTARY WELL HISTORY.....	
NOTICE OF INTENTION TO ABANDON WELL.....			

(INDICATE ABOVE BY CHECK MARK NATURE OF REPORT, NOTICE, OR OTHER DATA)
U. S. GEOLOGICAL SURVEY
FARMINGTON, NEW MEXICO

September 21, 1959

Well No. 1-3/ Ute Indian is located 1997 ft. from N line and 2203 ft. from W line of sec. 3
SE/4 NW/4 3 31N 15W N.M.P.M.
(1/4 Sec. and Sec. No.) (Twp.) (Range) (Meridian)
Verde Gallup San Juan New Mexico
(Field) (County or Subdivision) (State or Territory)

The elevation of the derrick floor above sea level is 5836 ft. GL

DETAILS OF WORK

(State names of and expected depths to objective sands; show sizes, weights, and lengths of proposed casings; indicate mudding jobs, cementing points, and all other important proposed work)

We Propose to: 10-3/4"
Set 200' surface pipe, cemented to surface.
Drill to an approximate depth of 2236, run 4 1/2" esg.,
Cement w/125 sx; run DV tool below Point Lookout and
cement w/200 sx. Perforate and frac Gallup. Rotary
tools will be used.



I understand that this plan of work must receive approval in writing by the Geological Survey before operations may be commenced.

Company SOUTHERN UNION GAS COMPANY

Address P. O. Box 815

Farmington, New Mexico

By Oran L. Haseltine

Title Drilling Superintendent

42-



NEW MEXICO OIL CONSERVATION COMMISSION
Well Location and Acreage Dedication Plat

Section A.

Date September 21, 1959

Operator Southern Union Gas Company Lease Ute Indian
Well No. 1-3 Unit Letter F Section 3 Township 31 North, Range 15 West, N.M.P.M.
Located 1997 Feet From North Line, 2203 Feet From West Line
County San Juan G. L. Elevation 5836 Dedicated Acreage 40 Acres
Name of Producing Formation Gallup Pool Verde-Gallup

1. Is the Operator the only owner* in the dedicated acreage outlined on the plat below?
Yes X No .
2. If the answer to question one is "no," have the interests of all the owners been consolidated by communitization agreement or otherwise? Yes No . If answer is "yes," Type of Consolidation
3. If the answer to question two is "no," list all the owners and their respective interests below:

Owner

Land Description



Section B

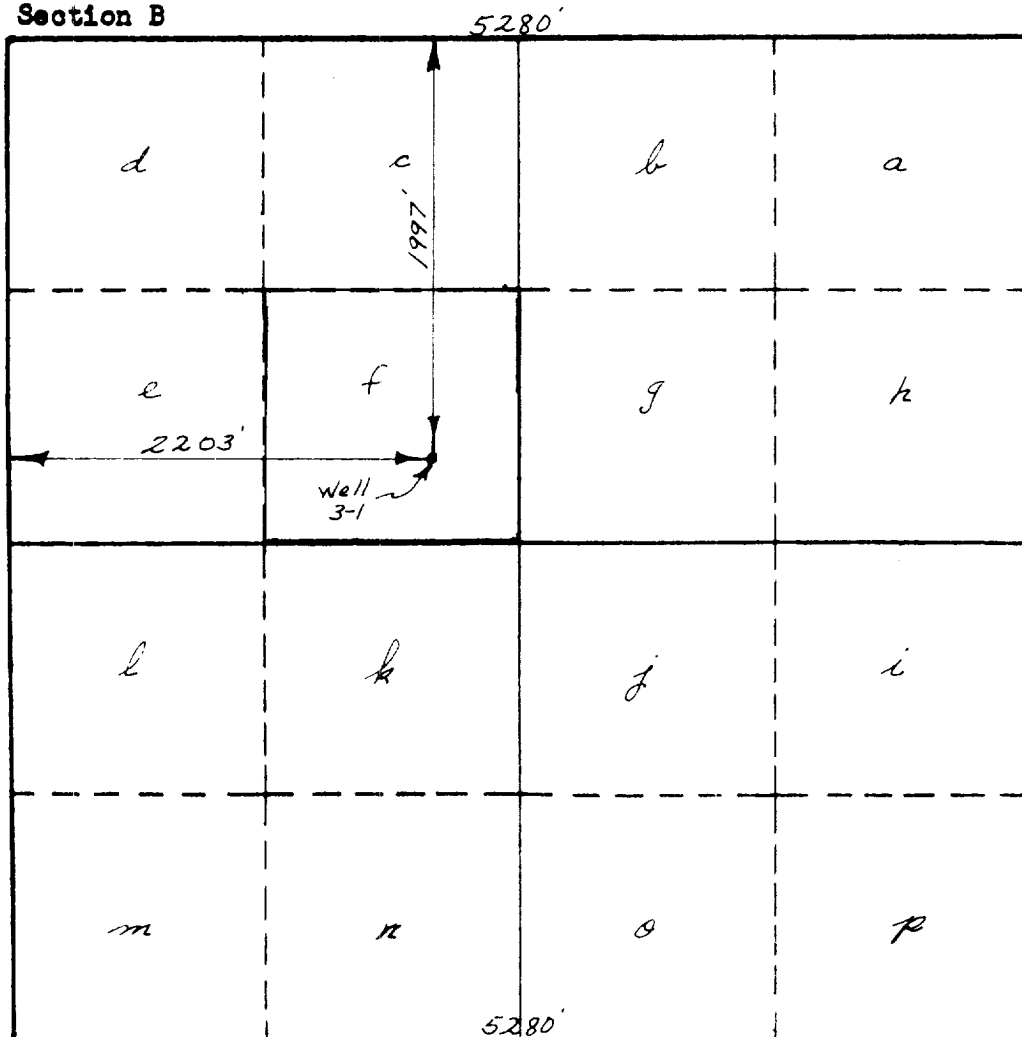

This is to certify that the information in Section A above is true and complete to the best of my knowledge and belief.

O. L. Haseltine
SOUTHERN UNION GAS COMPANY
(Operator)

O. L. Haseltine, Drlg. Supt.
(Representative)
P. O. Box 815
Farmington, New Mexico
Address

This is to certify that the well location shown on the plat in Section B was plotted from field notes of actual surveys made by me or under my supervision and that the same is true and correct to the best of my knowledge and belief.

Date Surveyed September 18, 1959

[Signature]
Registered Professional
Engineer and/or Land Surveyor.

Certificate No. 3034