

FIELD PIT SITE ASSESSMENT FORM



GENERAL

Meter: 92043 Location: RAINBOW SEEKER #1  
 Operator #: 1862 Operator Name: DUGAN PROD. P/L District: Kurtz  
 Coordinates: Letter: J Section 29 Township: 31 Range: 13  
 Or Latitude \_\_\_\_\_ Longitude \_\_\_\_\_  
 Pit Type: Dehydrator \_\_\_\_\_ Location Drip: X Line Drip: \_\_\_\_\_ Other: \_\_\_\_\_  
 Site Visit Date: 3-28-94 Run: 02 42

SITE ASSESSMENT

**NMOCD Zone:** Inside \_\_\_\_\_ Land Type: BLM   
 (From NMOCD Vulnerable \_\_\_\_\_ State   
 Maps) Zone  Fee   
 Outside  Indian \_\_\_\_\_

**Depth to Groundwater**  
 Less Than 50 Feet (20 points)   
 50 Ft to 99 Ft (10 points)   
 Greater Than 100 Ft (0 points)

**Wellhead Protection Area :**  
 Is it less than 1000 ft from wells, springs, or other sources of fresh water extraction? , or ; Is it less than 200 ft from a private domestic water source?  YES (20 points)  NO (0 points)

**Horizontal Distance to Surface Water Body**  
 Less Than 200 Ft (20 points)   
 200 Ft to 1000 Ft (10 points)   
 Greater Than 1000 Ft (0 points)

Name of Surface Water Body BARKER ARROYO  
 (Surface Water Body : Perennial Rivers, Major Wash, Streams, Creeks, Irrigation Canals, Ditches, Lakes, Ponds)

**TOTAL HAZARD RANKING SCORE:** 10 POINTS

*Denny S. Foust*  
 DEPUTY OIL & GAS INSPECTOR  
 SEP 11 0 1996

*Approved*  
 APR - 4 1996  
 OIL CON. DIV.  
 EL PASO

REMARKS

Remarks : ONLY PIT ON LOCATION. PIT IS DRY.

ORIGINAL PIT LOCATION

Original Pit : a) Degrees from North 14° Footage to Wellhead 190'  
b) Degrees from North \_\_\_\_\_ Footage to Dogleg \_\_\_\_\_  
Dogleg Name \_\_\_\_\_  
c) Length : 20' Width : 18' Depth : 3' ~~RT~~ <sup>RT</sup> 4'

ORIGINAL PIT LOCATION

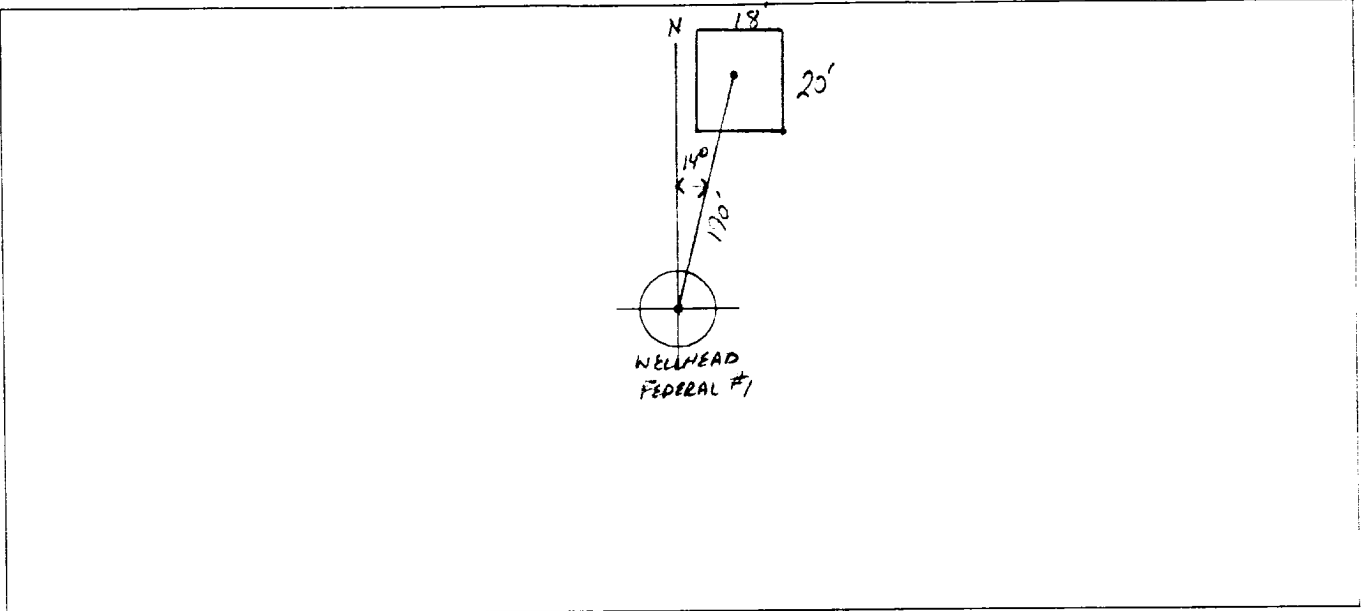

REMARKS :

STARTED TAKING PICTURES AT 1:17 P.M.  
DUMP TRUCK - BOBTAIL  
LOCATION IS ON THE SAME ONE AS THE FEDERAL #, SO I MEASURED  
TO ITS WELLHEAD.

REMARKS

Completed By:

Robert Champion  
Signature

3.28.94  
Date

4-22-94  
RT

### FIELD PIT SITE ASSESSMENT FORM

GENERAL

Meter: 92043 Location: RAINBOW SEEKER #1  
 Operator #: \_\_\_\_\_ Operator Name: \_\_\_\_\_ P/L District: \_\_\_\_\_  
 Coordinates: Letter: \_\_\_\_\_ Section \_\_\_\_\_ Township: \_\_\_\_\_ Range: \_\_\_\_\_  
 Or Latitude \_\_\_\_\_ Longitude \_\_\_\_\_  
 Pit Type: Dehydrator \_\_\_\_\_ Location Drip: \_\_\_\_\_ Line Drip: \_\_\_\_\_ Other: \_\_\_\_\_  
 Site Assessment Date: \_\_\_\_\_ Area: 02 Run: 42

SITE ASSESSMENT

**NMOCD Zone:** (From NMOCD Maps) Inside  (1) Outside  (2)

**Land Type:** BLM  (1) State  (2) Fee  (3) Indian \_\_\_\_\_

**Depth to Groundwater**  
 Less Than 50 Feet (20 points)  (1)  
 50 Ft to 99 Ft (10 points)  (2)  
 Greater Than 100 Ft (0 points)  (3)

**Wellhead Protection Area :**  
 Is it less than 1000 ft from wells, springs, or other sources of fresh water extraction? , or ; Is it less than 200 ft from a private domestic water source?  (1) YES (20 points)  (2) NO (0 points)

**Horizontal Distance to Surface Water Body**  
 Less Than 200 Ft (20 points)  (1)  
 200 Ft to 1000 Ft (10 points)  (2)  
 Greater Than 1000 Ft (0 points)  (3)

Name of Surface Water Body \_\_\_\_\_  
 (Surface Water Body : Perennial Rivers, Major Wash, Streams, Creeks, Irrigation Canals, Ditches, Lakes, Ponds)

Distance to Nearest Ephemeral Stream  (1) < 100' (Navajo Pits Only)  
 (2) > 100'

**TOTAL HAZARD RANKING SCORE: 30 POINTS**

EMARKS

Remarks : \_\_\_\_\_  
 \_\_\_\_\_  
 \_\_\_\_\_

**FIELD PIT REMEDIATION/CLOSURE FORM**

**GENERAL**

Meter: 92043 Location: Rainbow Seeker #1  
 Coordinates: Letter: J Section 29 Township: 31 Range: 13  
 Or Latitude \_\_\_\_\_ Longitude \_\_\_\_\_  
 Date Started : 4-21-94 Area: 02 Run: 42

**FIELD OBSERVATIONS**

Sample Number(s): <sup>940849</sup> VW20  
 Sample Depth: 12 Feet  
 Final PID Reading 31 PID Reading Depth 12 Feet  
 Yes No  
 Groundwater Encountered  (1)  (2) Approximate Depth \_\_\_\_\_ Feet

**CLOSURE**

Remediation Method :

Excavation  (1) Approx. Cubic Yards 2  
 Onsite Bioremediation  (2)  
 Backfill Pit Without Excavation  (3)

Soil Disposition:

Envirotech  (1)  (3) Tierra  
 Other Facility  (2) Name: \_\_\_\_\_

Pit Closure Date: 4-31-94 Pit Closed By: BEI

**REMARKS**

Remarks : Soil was clean pulled sample at 12' Backfilled. Didnt find any contamination in hole

Signature of Specialist: Vale Wilson



**FIELD SERVICES LABORATORY  
ANALYTICAL REPORT  
PIT CLOSURE PROJECT - Soil**

**SAMPLE IDENTIFICATION**

	Field ID	Lab ID
SAMPLE NUMBER:	VW 20	940849
MTR CODE   SITE NAME:	92043 <del>75236</del> <del>5/26/94</del>	N/A
SAMPLE DATE   TIME (Hrs):	4/21/94	1330
SAMPLED BY:	N/A	
DATE OF TPH EXT.   ANAL.:	4-22-94	4-22-94
DATE OF BTEX EXT.   ANAL.:	4/29/94	4/30/94
TYPE   DESCRIPTION:	VC	Dark Brown Coarse Sand

REMARKS: \_\_\_\_\_

**RESULTS**

PARAMETER	RESULT	UNITS	QUALIFIERS			
			DF	Q	M(g)	V(ml)
BENZENE	21.0	MG/KG				
TOLUENE	2.31	MG/KG	⊙	B		
ETHYL BENZENE	21.0	MG/KG				
TOTAL XYLENES	21.0	MG/KG				
TOTAL BTEX	2.31	MG/KG	1660		2.41	20
TPH (418.1)	210	MG/KG			2.03	28
H <sub>2</sub> ADSPACE PID	39	PPM				
PERCENT SOLIDS	92.8%	%				

-- TPH is by EPA Method 418.1 and BTEX is by EPA Method 8020 --

The Surrogate Recovery was at 92.5 % for this sample All QA/QC was acceptable.  
Narrative: \_\_\_\_\_

DF = Dilution Factor Used

Approved By: John Ladd

Date: 5/17/94