

NO. OF COPIES RECEIVED	
DISTRIBUTION	
SANTA FE	
FILE	
U.S.G.S.	
LAND OFFICE	
OPERATOR	

NEW MEXICO OIL CONSERVATION COMMISSION

Form C-101
Revised 1-1-65

5A. Indicate Type of Lease	
STATE <input type="checkbox"/>	FEE <input checked="" type="checkbox"/>
5. State Oil & Gas Lease No.	

APPLICATION FOR PERMIT TO DRILL, DEEPEN, OR PLUG BACK

1a. Type of Work		7. Unit Agreement Name	
b. Type of Well OIL WELL <input type="checkbox"/> GAS WELL <input checked="" type="checkbox"/> OTHER <input type="checkbox"/>		8. Farm or Lease Name Calloway	
2. Name of Operator Meridian Oil Inc.		9. Well No. 1A	
3. Address of Operator PO Box 4289, Farmington, NM 87499		10. Field and Pool, or Wildcat Blanco Mesa Verde	
4. Location of Well UNIT LETTER <u>0</u> LOCATED <u>1175</u> FEET FROM THE <u>South</u> LINE AND <u>147</u> FEET FROM THE <u>East</u> LINE OF SEC. <u>27</u> TWP. <u>31N</u> RGE. <u>11W</u> NMPM		12. County San Juan	
19. Proposed Depth 5000'		19A. Formation Mesa Verde	
21. Elevations (Show whether DF, RT, etc.) 5684' GL		22. Approx. Date Work will start	
21A. Kind & Status Plug. Bond statewide		22. Approx. Date Work will start	

PROPOSED CASING AND CEMENT PROGRAM

SIZE OF HOLE	SIZE OF CASING	WEIGHT PER FOOT	SETTING DEPTH	SACKS OF CEMENT	EST. TOP
12 1/4"	9 5/8"	32.3#	200'	130 cu.ft.	circ. surface
8 3/4"	7"	20.0#	2630'	370 cu.ft.	cover Ojo Alam
6 1/4"	4 1/2" liner	10.5#	5000'	440 cu.ft.	circ. liner

Selectively perforate and sandwater fracture the Mesa Verde formation.

A 3000 psi WP and 6000 psi test double gate preventer equipped with blind and pipe rams will be used for blow out prevention on this well.

This gas is dedicated.

The E/2 of Section 27 is dedicated to this well.

APPROVAL EXPIRES 4-1-88
UNLESS DRILLING IS COMMENCED
SPUD NOTICE MUST BE SUBMITTED
WITHIN 10 DAYS

RECEIVED

MAR 09 1988

OIL COM DIV

IN ABOVE SPACE DESCRIBE PROPOSED PROGRAM: IF PROPOSED IS TO DEEPEN OR PLUG BACK, GIVE DATA ON PRESENT PRODUCTIVE ZONE AND PROPOSED NEW PRODUCTIVE ZONE. GIVE BLOWOUT PREVENTER PROGRAM, IF ANY.

I hereby certify that the information above is true and complete to the best of my knowledge and belief.

Signed [Signature] Title Drilling Clerk Date 3-4-88

(This space for State Use)

APPROVED BY [Signature] TITLE DEPUTY OIL & GAS INSPECTOR, DIST. #3 DATE MAR 10 1988

CONDITIONS OF APPROVAL, IF ANY:

**NEW MEXICO OIL CONSERVATION COMMISSION
WELL LOCATION AND ACREAGE DEDICATION PLAT**

Form 7-102
Supersedes 6-128
Effective 1-1-65

All distances must be from the outer boundaries of the Section.

Operator MERIDIAN OIL, INC.			Lease CALLOWAY (Fee)		Well No. 1A
Unit Letter 0	Section 27	Township 31 N	Range 11 W	County SAN JUAN	
Actual Footage Location of Well: 1175 feet from the South line and 1470 feet from the East line					
Ground Level Elev. 5684	Producing Formation Masa Verde		Pool Blanco		Dedicated Acreage: 320 Acres

1. Outline the acreage dedicated to the subject well by colored pencil or hachure marks on the plat below.
2. If more than one lease is dedicated to the well, outline each and identify the ownership thereof (both as to working interest and royalty).
3. If more than one lease of different ownership is dedicated to the well, have the interests of all owners been consolidated by communitization, unitization, force-pooling, etc?

☐ Yes ☐ No If answer is "yes," type of consolidation _____

If answer is "no," list the owners and tract descriptions which have actually been consolidated. (Use reverse side of this form if necessary.) _____

No allowable will be assigned to the well until all interests have been consolidated (by communitization, unitization, forced-pooling, or otherwise) or until a non-standard unit, eliminating such interests, has been approved by the Commission.

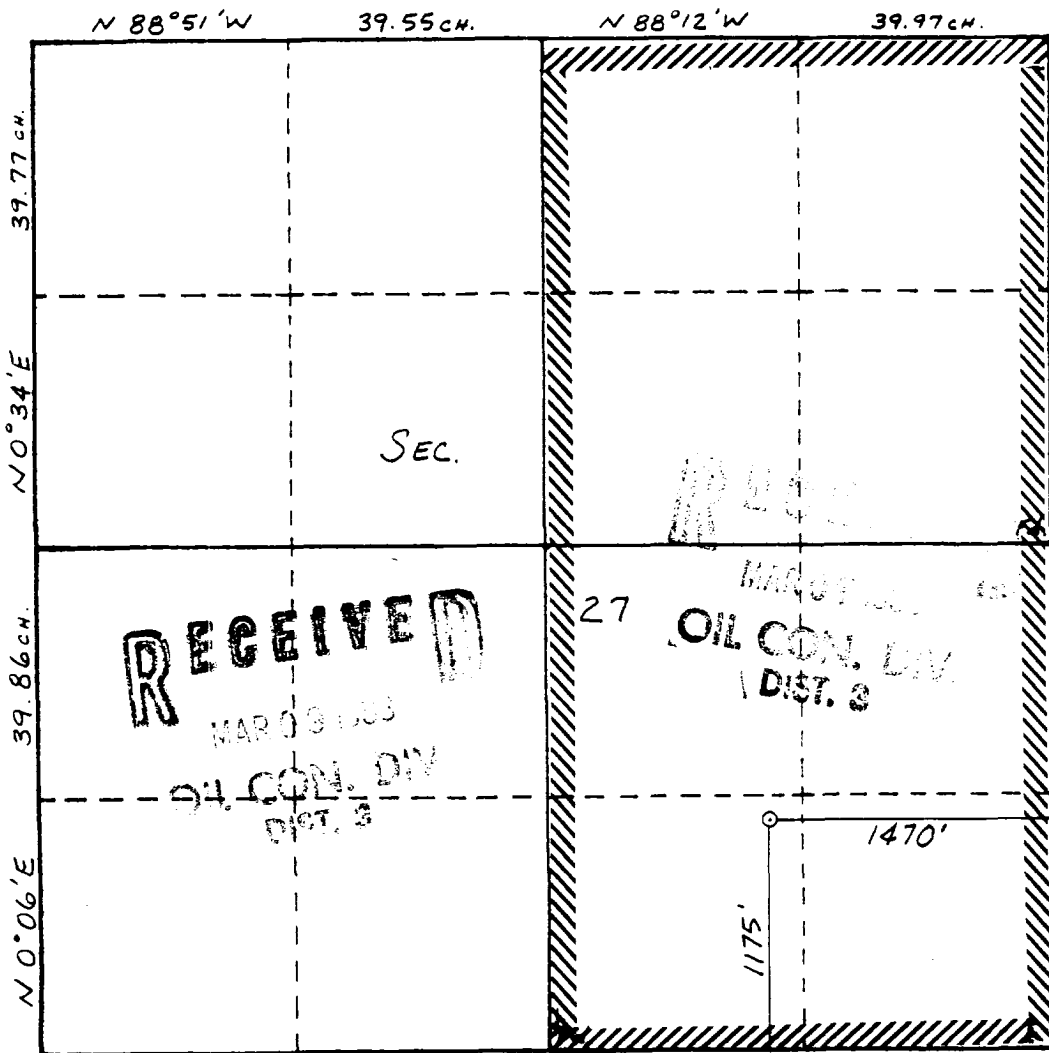

CERTIFICATION

I hereby certify that the information contained herein is true and complete to the best of my knowledge and belief.

Name _____
Position
Drilling Clerk
Company
Meridian Oil Inc.

Date
3-4-88

I hereby certify that the well location shown on this plat was plotted from field notes of actual surveys made by me or under my supervision, and that the same is true and correct to the best of my knowledge and belief.

Date Surveyed
March 9, 1968
Registered Professional Engineer and Land Surveyor
William E. Matlock II
Certificate No. **8466**