

NEW MEXICO OIL CONSERVATION COMMISSION
WELL LOCATION AND ACREAGE DEDICATION PLAT

Hold C-104 for pool change
Form C-102
Supersedes C-138
Effective 1-4-85

All distances must be from the outer boundaries of the Section.

Operator Southland Royalty Company			Lessee PAGE Com (Fee)		Well No. 100
Unit Letter I	Section 7	Township 32 N	Range 10 W	County SAN JUAN	
Actual Footage Location of Well: 1770 feet from the South line and 790 feet from the East line					
Ground Level Elev. 6210	Producing Formation Fruitland Coal	Pool Basin	Dedicated Acreage: 327.64 Ext 328.78 Acres		

1. Outline the acreage dedicated to the subject well by colored pencil or hachure marks on the plat below.
2. If more than one lease is dedicated to the well, outline each and identify the ownership thereof (both as to working interest and royalty).
3. If more than one lease of different ownership is dedicated to the well, have the interests of all owners been consolidated by communitization, unitization, force-pooling, etc?

☒ Yes ☐ No If answer is "yes," type of consolidation communitization

If answer is "no," list the owners and tract descriptions which have actually been consolidated. (Use reverse side of this form if necessary.) _____

No allowable will be assigned to the well until all interests have been consolidated (by communitization, unitization, forced-pooling, or otherwise) or until a non-standard unit, eliminating such interests, has been approved by the Commission.

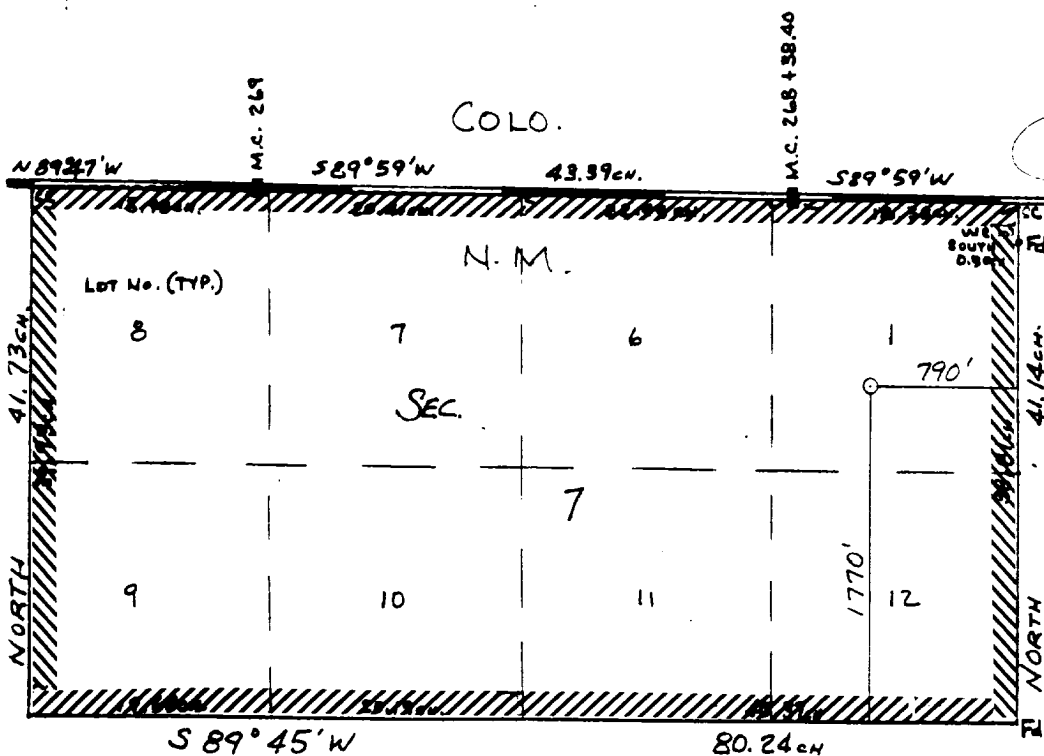

CERTIFICATION

I hereby certify that the information contained herein is true and complete to the best of my knowledge and belief.

Name Drilling Clerk
Position Southland Royalty Co.
Company 4-22-89

Date _____
I hereby certify that the well location shown on this plat was plotted from field notes of actual surveys made by me or under my supervision, and that the same is true and correct to the best of my knowledge and belief.

Date Surveyed 4-22-89
Will W. M. H. H. H.
Registered Professional Engineer and Land Surveyor #8466
Certificate No. 8466