

UNITED STATES
DEPARTMENT OF THE INTERIOR
BUREAU OF LAND MANAGEMENT

SUBMIT IN TRIPLICATE*
(Other instructions on re-
verse side)

Form approved
Budget Bureau No. 1004-0135
Expires August 31, 1985

SUNDRY NOTICES AND REPORTS ON WELLS

(Do not use this form for proposals to drill or to deepen or plug back to a different reservoir.
Use "APPLICATION FOR PERMIT—" for such proposals.)

1. OIL WELL <input type="checkbox"/> GAS WELL <input checked="" type="checkbox"/> OTHER <input type="checkbox"/>	7. UNIT AGREEMENT NAME
2. NAME OF OPERATOR Meridian Oil Inc.	8. FARM OR LEASE NAME Kelly A Com
3. ADDRESS OF OPERATOR P.O. Box 4289, Farmington, NM 87499	9. WELL NO. 205
4. LOCATION OF WELL (Report location clearly and in accordance with any State requirements.* See also space 17 below) At surface 1485'S, 1460'W	10. FIELD AND POOL, OR WILDCAT Basin Fruitland Coal
11. SEC., T., R., M., OR S.E. AND SURVEY OR AREA Sec. 15, T31N, R10W NMPM	12. COUNTY OR PARISH San Juan
13. STATE NM	
14. PERMIT NO.	15. ELEVATIONS (Show whether OP, ST, OR, etc.) 6207' GL

16.

Check Appropriate Box To Indicate Nature of Notice, Report, or Other Data

NOTICE OF INTENTION TO:

TEST WATER SHUT-OFF ☐

FRACTURE TREAT ☐

SHOOT OR ACIDIZE ☐

REPAIR WELL ☐

(Other) Revision ☒

PULL OR ALTER CASING ☐

MULTIPLE COMPLETE ☐

ABANDON* ☐

CHANGE PLANS ☐

☒

SUBSEQUENT REPORT OF:

WATER SHUT-OFF ☐

FRACTURE TREATMENT ☐

SHOOTING OR ACIDIZING ☐

(Other) ☐

REPAIRING WELL ☐

ALTERING CASING ☐

ABANDONMENT* ☐

(Note: Report results of multiple completion on Well Completion or Recompletion Report and Log form.)

17. DESCRIBE PROPOSED OR COMPLETED OPERATIONS (Clearly state all pertinent details, and give pertinent dates, including estimated date of starting any proposed work. If well is directionally drilled, give subsurface locations and measured and true vertical depths for all markers and zones pertinent to this work.)*

Attached is a copy of the C102 showing the revised pool & dedication.

RECEIVED

DEC 28 1988

BUREAU OF LAND MANAGEMENT
FARMINGTON RESOURCE AREA

18. I hereby certify that the foregoing is true and correct

SIGNED

(This space for Federal or State office use)

TITLE Regulatory Affairs

ACCEPTED FOR RECORD

APPROVED BY

CONDITIONS OF APPROVAL, IF ANY:

TITLE

JAN 12 1989

DATE

FARMINGTON RESOURCE AREA

BY SNM

*See Instructions on Reverse Side

Title 18 U.S.C. Section 1001, makes it a crime for any person knowingly and willfully to make to any department or agency of the United States any false, fictitious or fraudulent statements or representations as to any matter within its jurisdiction.

All distances must be from the outer boundaries of the Section.

Operator Meridian Oil Inc.			Lease Kelly A Com.			Well No. 205		
Unit Letter K	Section 15	Township 31 N.	Range 10 W	County San Juan				
Actual Footage Location of Well: 1485 feet from the South line and 1460 feet from the West line								
Ground Level Elev. 6207	Producing Formation Fruitland Coal			Pool Basin			Dedicated Acreage: 320 Ac	

1. Outline the acreage dedicated to the subject well by colored pencil or hachure marks on the plat below.
2. If more than one lease is dedicated to the well, outline each and identify the ownership thereof (both as to working interest and royalty).
3. If more than one lease of different ownership is dedicated to the well, have the interests of all owners been consolidated by communitization, unitization, force-pooling, etc?

☒ Yes ☐ No If answer is "yes," type of consolidation Communitization

If answer is "no," list the owners and tract descriptions which have actually been consolidated. (Use reverse side of this form if necessary.)

No allowable will be assigned to the well until all interests have been consolidated (by communitization, unitization, forced-pooling, or otherwise) or until a non-standard unit, eliminating such interests, has been approved by the Division.

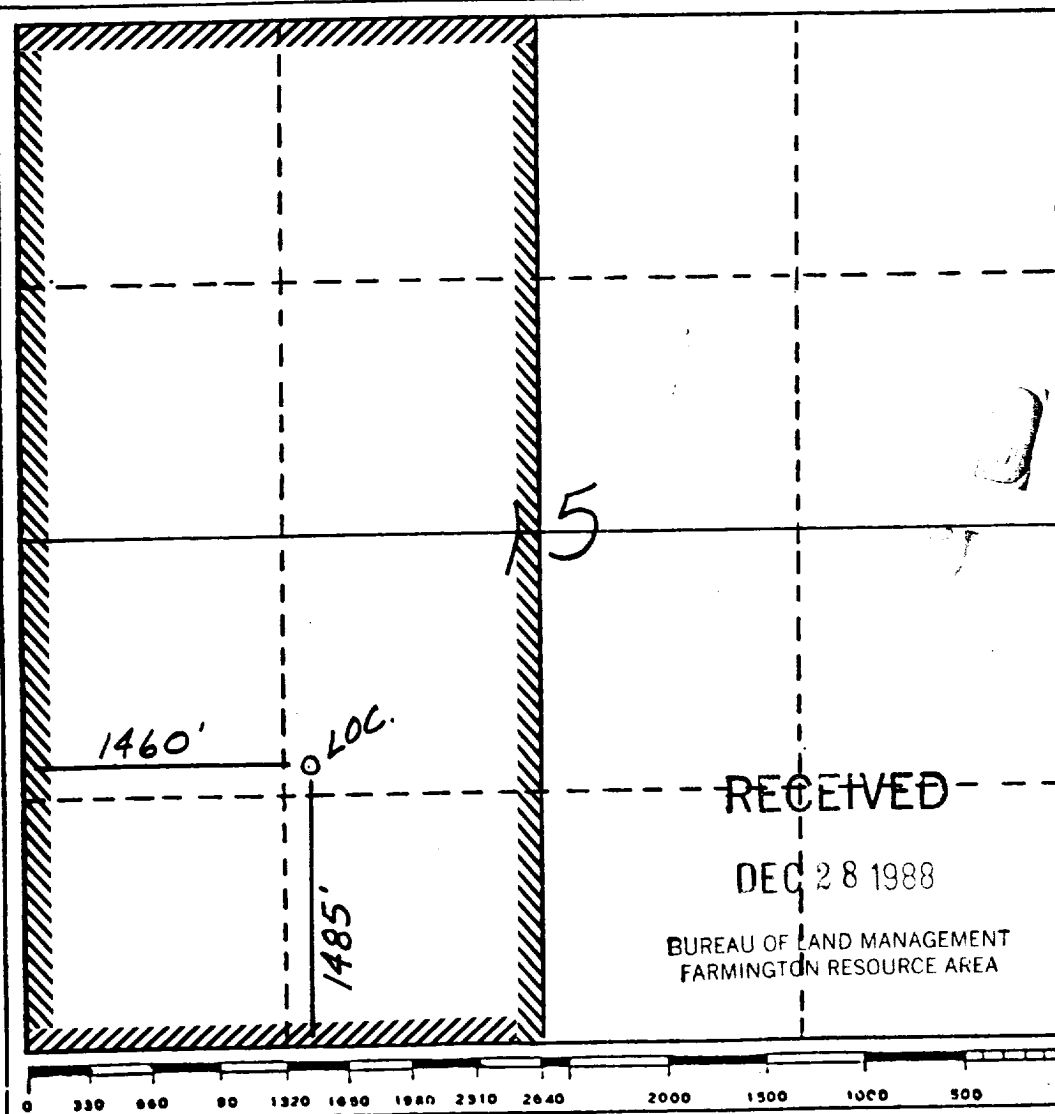

CERTIFICATION

I hereby certify that the information contained herein is true and complete to the best of my knowledge and belief.

Name
Regulatory Affairs

Position
Meridian Oil Inc.

Company
12-23-88

Date

NEALE C. EDWARDS
NEW MEXICO
6357
REGISTERED LAND SURVEYOR
I hereby certify that the well location shown on this plat was plotted from the notes of actual surveys made by me under my supervision, and that the same is true and correct to the best of my knowledge and belief.

Neale C. Edwards
Date Surveyed
7/23/88

Registered Professional Engineer and/or Land Surveyor

Neale C. Edwards

Certificate No.

RECEIVED

DEC 28 1988

BUREAU OF LAND MANAGEMENT
FARMINGTON RESOURCE AREA