

UNITED STATES
DEPARTMENT OF THE INTERIOR
GEOLOGICAL SURVEY

APPLICATION FOR PERMIT TO DRILL, DEEPEN, OR PLUG BACK

1a. TYPE OF WORK DRILL <input checked="" type="checkbox"/> DEEPEN <input type="checkbox"/> PLUG BACK <input type="checkbox"/>			5. LEASE DESIGNATION AND SERIAL NO. SF-078319-A	
b. TYPE OF WELL OIL WELL <input type="checkbox"/> GAS WELL <input checked="" type="checkbox"/> OTHER <input type="checkbox"/> SINGLE ZONE <input checked="" type="checkbox"/> MULTIPLE ZONE <input type="checkbox"/>			6. IF INDIAN, ALLOTTEE OR TRIBE NAME	
2. NAME OF OPERATOR Tenneco Oil Company			7. UNIT AGREEMENT NAME	
3. ADDRESS OF OPERATOR P.O. Box 3249, Englewood, CO 80155			8. FARM OR LEASE NAME Riddle Com C	
4. LOCATION OF WELL (Report location clearly and in accordance with any State requirements.) At surface 950' FSL, 1435' FWL At proposed prod. zone Same as above			9. WELL NO. 811	
14. DISTANCE IN MILES AND DIRECTION FROM NEAREST TOWN OR POST OFFICE* 11 1/2 miles east of Aztec, NM			10. FIELD AND POOL OR WILDCAT Blanco-Fruitland Coal	
15. DISTANCE FROM PROPOSED* LOCATION TO NEAREST PROPERTY OR LEASE LINE, FT. (Also to nearest drlg. unit line, if any) 950'			11. SEC., T., R., M., OR BLK. AND SURVEY OR AREA N Sec. 29, T31N, R9W	
16. NO. OF ACRES IN LEASE 905.92			12. COUNTY OR PARISH San Juan	
17. NO. OF ACRES ASSIGNED TO THIS WELL 160 157.46			13. STATE NM	
18. DISTANCE FROM PROPOSED LOCATION* TO NEAREST WELL, DRILLING, COMPLETED, OR APPLIED FOR, ON THIS LEASE, FT. 145'			20. ROTARY OR CABLE TOOLS Rotary	
21. ELEVATIONS (Show whether DE, RT, GR, etc.) 6316' GL			22. APPROX. DATE WORK WILL START* ASAP	

23. DRILLING OPERATIONS AUTHORIZED ARE
SUBJECT TO COMPLIANCE WITH ATTACHED
"GENERAL REQUIREMENTS" PROPOSED CASING AND CEMENTING PROGRAM

SIZE OF HOLE	SIZE OF CASING	WEIGHT PER FOOT	SETTING DEPTH
12 1/2"	9 5/8"	36#	± 200'
8 3/4"	7"	23#	± 2678'
6 1/2"	5 1/2"	23#	± 3101'

See Attached Drilling Procedure.

RECEIVED
SEP 26 1988
OIL CON. DIV
DIST 2

IN ABOVE SPACE DESCRIBE PROPOSED PROGRAM: If proposal is to deepen or plug back, give data on present productive zone and proposed new productive zone. If proposal is to drill or deepen directionally, give pertinent data on subsurface locations and measured and true vertical depths. Give blowout preventer program, if any.

24. SIGNED Niles V. Jokela TITLE Staff Analyst DATE 8/18/88
(This space for Federal or State office use)

PERMIT NO. _____ APPROVAL DATE _____
APPROVED BY _____ TITLE _____
CONDITIONS OF APPROVAL, IF ANY:

APPROVED KH
AS AMENDED

SEP 23 1988

JAMES E. EDWARDS
AREA MANAGER

OK
A

RECEIVED

**NEW MEXICO OIL CONSERVATION COMMISSION
WELL LOCATION AND ACREAGE DEDICATION PLAT**

Form C-102
Supersedes C-128
Effective 1-1-85

All distances must be from the outer boundaries of the Section.

Operator TENNECO OIL COMPANY		Lease RIDDLE COM C		Well No. 11
Unit Letter N	Section 29	Township 31 N	Range 9 W	County SAN JUAN
Actual Footage Location of Well: 950 feet from the South line and 1435 feet from the West line				
Ground Level Elev. 6316	Producing Formation Blanco	Pool Fruitland Coal	Dedicated Acreage 320/157-46 Acres	

1. Outline the acreage dedicated to the subject well by colored pencil or hatchure marks on the plat below.
2. If more than one lease is dedicated to the well, outline each and identify the ownership thereof (both as to working interest and royalty).
3. If more than one lease of different ownership is dedicated to the well, have the interests of all owners been consolidated by communitization, unitization, force-pooling, etc?

☐ Yes ☐ No If answer is "yes," type of consolidation _____

If answer is "no," list the owners and tract descriptions which have actually been consolidated. (Use reverse side of this form if necessary.) _____

No allowable will be assigned to the well until all interests have been consolidated (by communitization, unitization, forced-pooling, or otherwise) or until a non-standard unit, eliminating such interests, has been approved by the Commission.

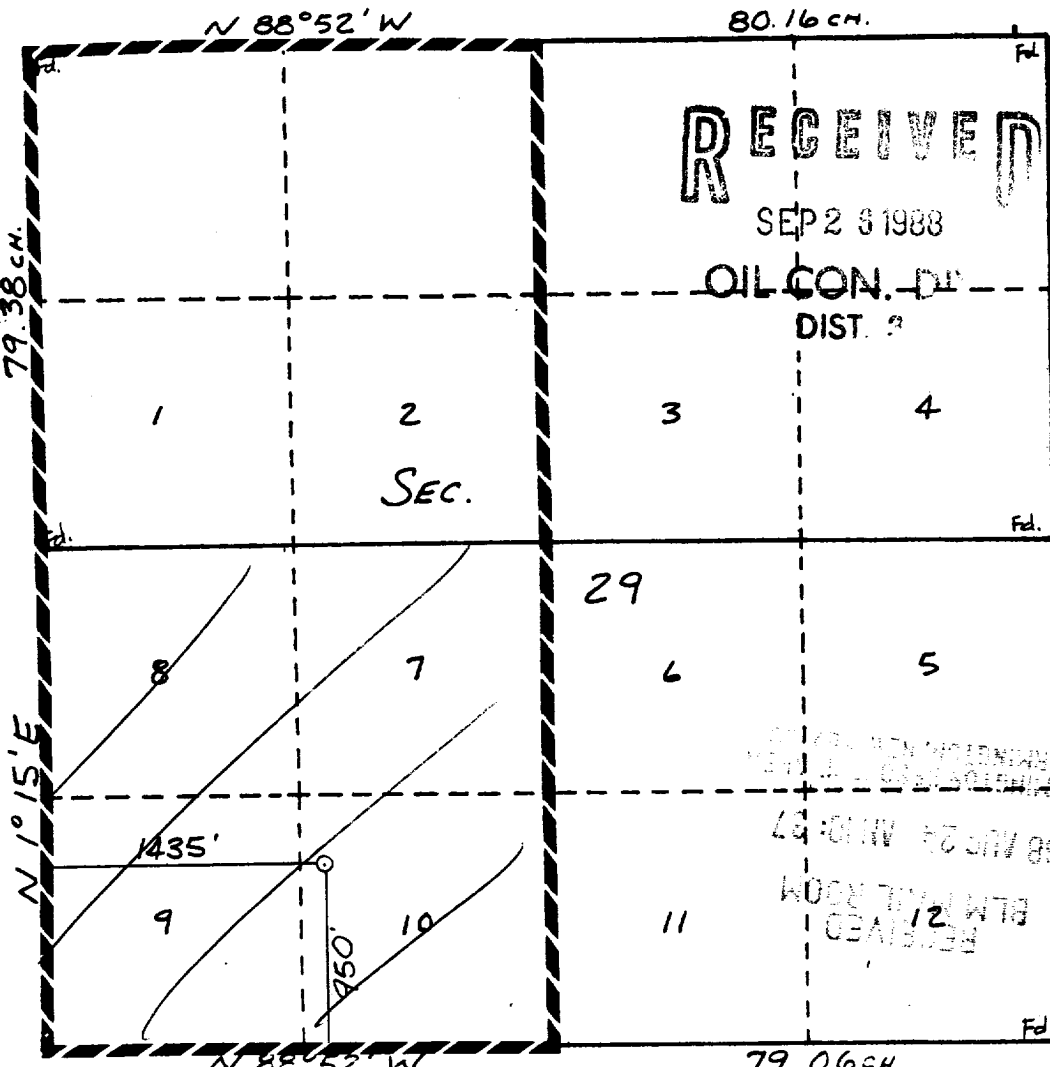

CERTIFICATION

I hereby certify that the information contained herein is true and complete to the best of my knowledge and belief.

Niles V. Jokela

Name
Niles V. Jokela
Position
Staff Analyst
Company
Tenneco Oil Company
Date
8/18/88

I hereby certify that the well location shown on this plat was plotted from field notes of actual surveys made by me or under my supervision, and that the same is true and correct to the best of my knowledge and belief.

Date Surveyed
WILLIAM J. HENNING II
Registered Professional Engineer and Land Surveyor
#8466
Certificate No. **PROFESSOR**

MAP 1

950' FSL, 1435' FWL
Sec. 29, T31N, R9W
San Juan, New Mexico

WELL LOCATION
ACCESS ROAD

