

NO. OF COPIES RECEIVED	
DISTRIBUTION	
SANTA FE	
FILE	
U.S.G.S.	
LAND OFFICE	
OPERATOR	

NEW MEXICO OIL CONSERVATION COMMISSION

Form C-101
Revised 1-4-65

5A. Indicate Type of Lease

STATE ☐ FEE ☒

5. State Oil & Gas Lease No.

APPLICATION FOR PERMIT TO DRILL, DEEPEN, OR PLUG BACK

1a. Type of Work DRILL <input checked="" type="checkbox"/> DEEPEN <input type="checkbox"/> PLUG BACK <input type="checkbox"/>		7. Unit Agreement Name Allison Unit
b. Type of Well OIL WELL <input type="checkbox"/> GAS WELL <input checked="" type="checkbox"/> OTHER <input type="checkbox"/> SINGLE ZONE <input checked="" type="checkbox"/> MULTIPLE ZONE <input type="checkbox"/>		8. Farm or Lease Name Allison Unit
2. Name of Operator Meridian Oil Inc.		9. Well No. 134
3. Address of Operator PO Box 4289, Farmington, NM 87499		10. Field and Pool, or Wildcat Basin, Fruitland Coa
4. Location of Well UNIT LETTER M LOCATED 790 FEET FROM THE South LINE AND 790 FEET FROM THE West LINE OF SEC. 8 TWP. 32N RGE. 6W NMPM		12. County San Juan
19. Proposed Depth 3100		19A. Formation Fruitland
20. Rotary or C.T. Rotary		
21. Elevations (Show whether DE, RT, etc.) 6521' GL	21A. Kind & Status Plug. Bond statewide	21B. Drilling Contractor
22. Approx. Date Work will start		

23. PROPOSED CASING AND CEMENT PROGRAM

SIZE OF HOLE	SIZE OF CASING	WEIGHT PER FOOT	SETTING DEPTH	SACKS OF CEMENT	EST. TOP
12 1/4"	9 5/8"	32.3#	200'	130 cu.ft.	circ. surface
8 3/4"	7"	20.0#	2975	218 cu.ft.	cover Ojo Ala
6 1/4"	5 1/2"	23.0#	3100	do not cement	

The Fruitland Coal formation will be completed.

A 3000 psi WP and 6000 psi test double gate preventer equipped with blind and pipe rams will be used for blow out prevention on this well.

This gas is dedicated.

SW of NE, SE of NW, SW/4 and W/2 of SE/4 are dedicated to this well.

APPROVAL 6-14-89
UNLESS LAID OFF COMMENCED
SPUD NOTIFICATION BE SUBMITTED
WITHIN 10 DAYS

IN ABOVE SPACE DESCRIBE PROPOSED PROGRAM: IF PROPOSAL IS TO DEEPEN OR PLUG BACK, GIVE DATA ON PRESENT PRODUCTIVE ZONE AND PROPOSED NEW PRODUCTIVE ZONE. GIVE BLOWOUT PREVENTER PROGRAM, IF ANY.

I hereby certify that the information above is true and complete to the best of my knowledge and belief.

Signed [Signature] Title Regulatory Affairs Date 12-12-88

(This space for State Use)

APPROVED BY [Signature] TITLE CHIEF OIL & GAS INSPECTOR, DIST. #3 DATE DEC 14 1988

CONDITIONS OF APPROVAL, IF ANY:

Hold C-104 For MSP

All distances must be from the outer boundaries of the Section.

Operator Meridian Oil Inc.		Lease Allison Unit (Fee)		Well No. 134
Unit Letter M	Section 8	Township 32 North	Range 6 West	County San Juan
Actual Footage Location of Wells 790 feet from the South line and 790 feet from the West line				
Ground Level Elev. 6521	Producing Formation Fruitland Coal	Pool Basin	Dedicated Acreage: 357-41 Acres	

1. Outline the acreage dedicated to the subject well by colored pencil or hatchure marks on the plat below.
2. If more than one lease is dedicated to the well, outline each and identify the ownership thereof (both as to working interest and royalty).
3. If more than one lease of different ownership is dedicated to the well, have the interests of all owners been consolidated by communitization, unitization, force-pooling, etc?

☐ Yes ☐ No If answer is "yes," type of consolidation _____

If answer is "no," list the owners and tract descriptions which have actually been consolidated. (Use reverse side of this form if necessary.) _____

No allowable will be assigned to the well until all interests have been consolidated (by communitization, unitization, forced-pooling, or otherwise) or until a non-standard unit, eliminating such interests, has been approved by the Division

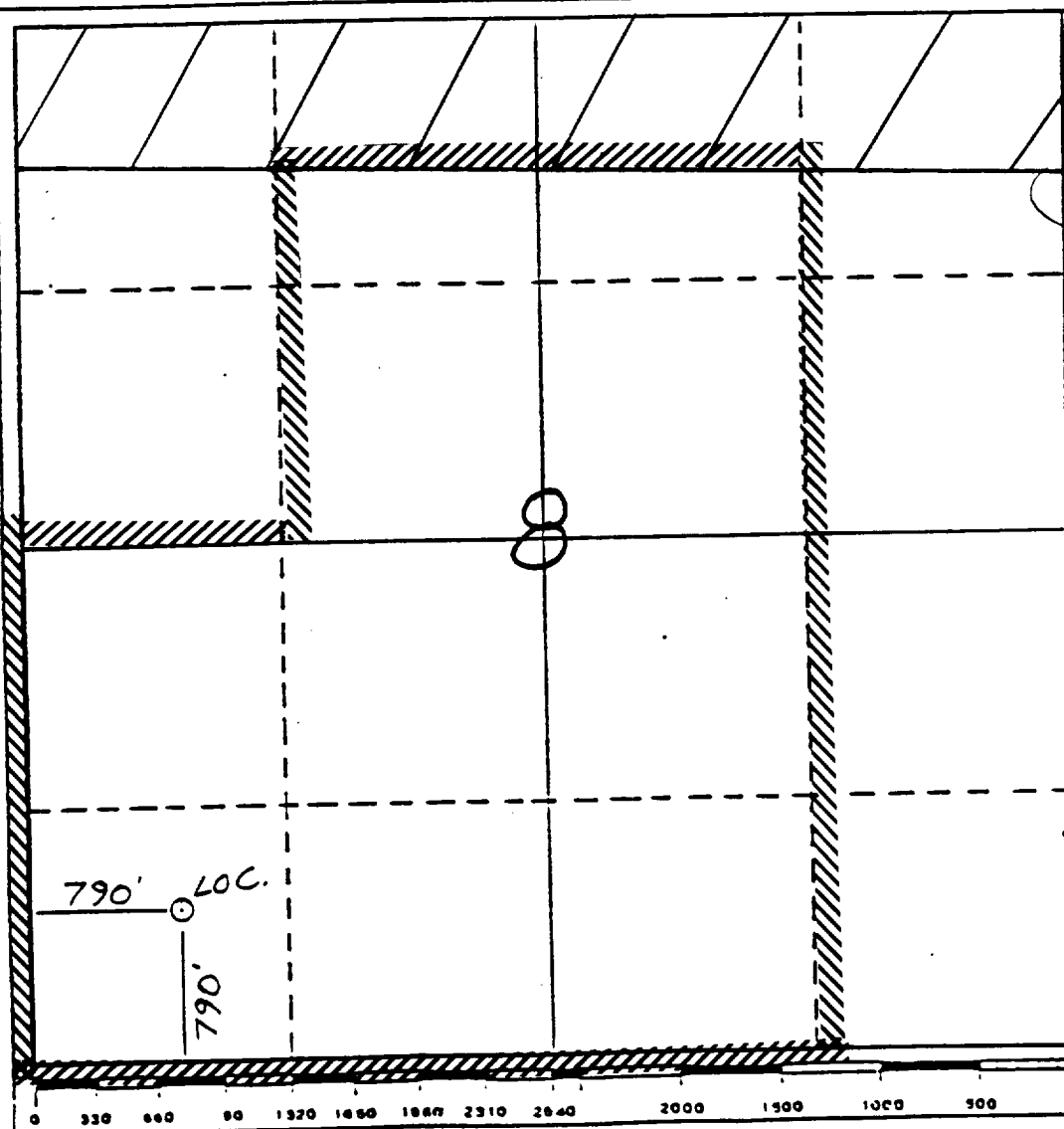

CERTIFICATION

I hereby certify that the information contained herein is true and complete to the best of my knowledge and belief.

Name
Regulatory Affairs

Position
Meridian Oil Inc.

Company
12-14-88

Date

I hereby certify that the well location shown on this plat was plotted from field notes of actual surveys made by me or under my supervision, and that the same is true and correct to the best of my knowledge and belief.

Date Surveyed
12-9-88

Registered Professional Engineer
and/or Land Surveyor

Neale C. Edwards

Certificate No.

6857