

BK 10/89

Allison Unit # 113
M-19-32N-6W

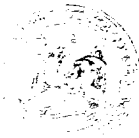

STATE OF NEW MEXICO
ENERGY, MINERALS AND NATURAL RESOURCES DEPARTMENT
OIL CONSERVATION DIVISION

ek
E

GARREY CARRUTHERS
GOVERNOR

POST OFFICE BOX 2088
STATE LAND OFFICE BUILDING
SANTA FE, NEW MEXICO 87504
(505) 827-5800

June 21, 1989

Meridian Oil, Inc.
P.O. Box 4289
Farmington, NM 87499-4289

Attention: Peggy Bradfield

Administrative Order NSL-2667

Dear Ms. Bradfield:

Reference is made to your application of May 30, 1989 for a non-standard coal gas well location for your Allison Unit Well No. 113 to be located 820 feet from the South line and 600 feet from the West line (Unit M) of Section 19, Township 32 North, Range 6 West, NMPM, Basin Fruitland Coal (Gas) Pool, San Juan County, New Mexico. Lots 1, 2, 3 and 4 and the E/2 W/2 of said Section 19 shall be dedicated to the well forming a standard 316.83-acre gas spacing and proration unit for said pool.

By the authority granted me under the provisions of Rule 8 of the Special Rules and Regulations for the Basin-Fruitland Coal (Gas) Pool as promulgated by Division Order No. R-8768, the above-described unorthodox coal gas well location is hereby approved.

Sincerely,

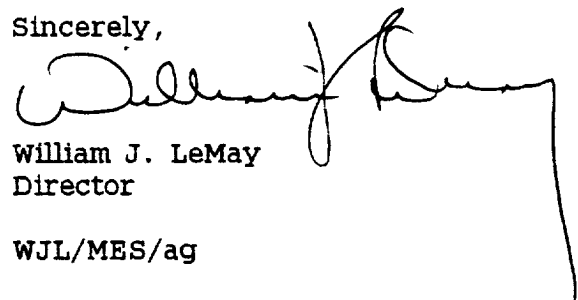
William J. LeMay
Director
WJL/MES/ag

RECEIVED
JUN 26 1989
OIL CON. DIV
DIST. 3

cc: Oil Conservation Division - Aztec
New Mexico Oil & Gas Engineering Committee - Hobbs
US Bureau of Land Management - Farmington

MERIDIAN OIL

May 24, 1989

Mr. William LeMay
New Mexico Oil Conservation Division
Post Office Box 2088
Santa Fe, New Mexico 87504

Dear Mr. LeMay:

This is a request for administrative approval for an unorthodox gas well location in the Basin Fruitland Coal Pool.

It is intended to locate the El Paso Natural Gas Company Allison Unit #113 at 820' from the South line and 600' from the West line of Section 19, T-32-N, R-6-W, San Juan County, New Mexico.

This location is non-standard due to archaeology ruins.

All surrounding lands are within Allison Unit boundaries and El Paso Natural Gas Company is the operator of the Allison Unit.

Plats showing the proposed well location and the terrain in Section 19, along with an ownership plat, are attached.

Sincerely yours,

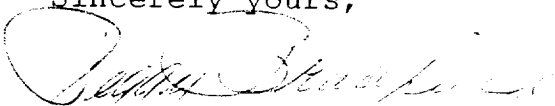
Peggy Bradfield

encl.

RECEIVED
MAY 30 1989
OIL CON. DIV.
DIST. 3

EL PASO NATURAL GAS COMPANY

Well Name Allison Unit #113

Footage 820' FSL; 600' FWL

APPLICATION FOR NON-STANDARD LOCATION

County San Juan State New Mexico Section 19 Township 32N Range 13W

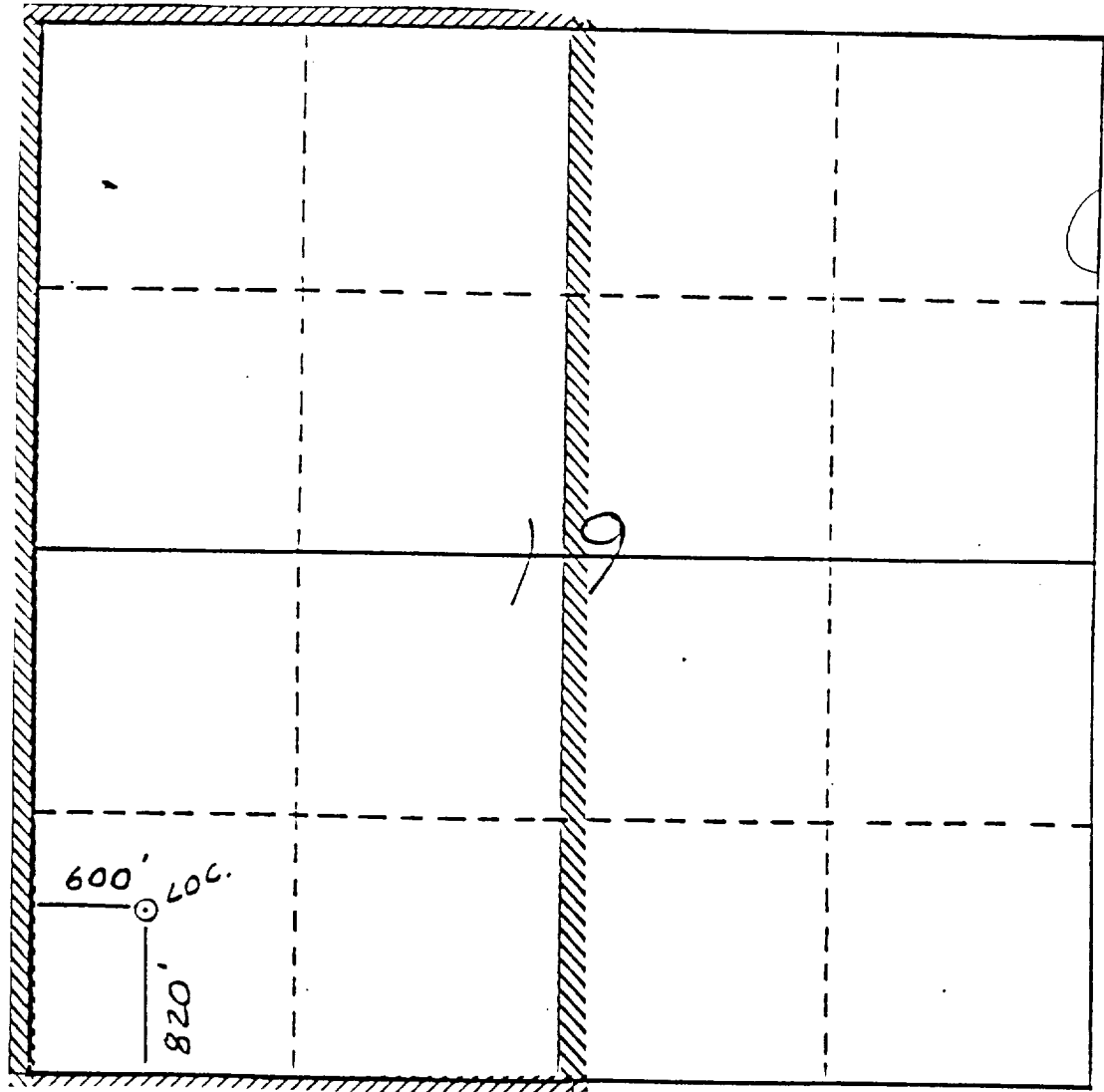

Remarks All surrounding lands are within Allison Unit boundaries - El Paso
Natural Gas Company, Operator

BURNT MESA QUADRANGLE

NEW MEXICO

7.5 MINUTE SERIES (TOPOGRAPHIC)

LA PLATA CO

SAN JUAN CO

R 7 W
MP 246 6265

R 6 W 277

107

UNITED STATES

DEPARTMENT OF THE INTERIOR

GEOLOGICAL SURVEY

ALLISON COLO. 2.2
500 000 FEET (WEST)

MI. 279000m.E.

LA PLATA CO

ARCHULETA CO

MP 6034
244

T-32-N

R-6-W

ALLISON UNIT #113

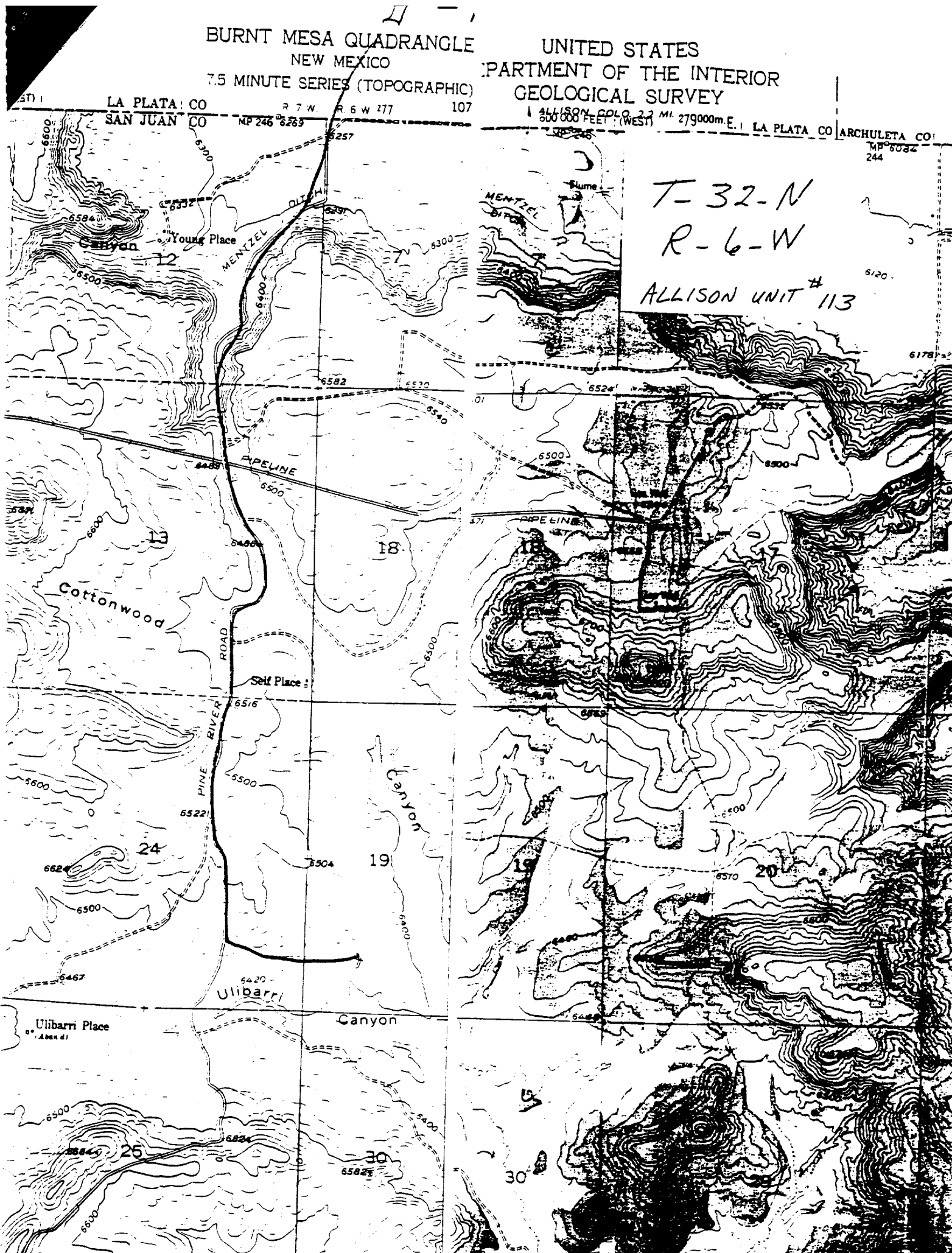

All distances must be from the outer boundaries of the Section.

Operator El Paso Natural Gas		Lease Allison Unit (SF-081155)		Well No. 113
Unit Letter M	Section 19	Township 32 North	Range 6 West	County San Juan
Actual Footage Location of Well 820 feet from the South line and 600 feet from the West line				
Ground Level Elev. 6437'	Producing Formation Fruitland Coal		Pool Basin	Dedicated Acreage: 320

1. Outline the acreage dedicated to the subject well by colored pencil or hachure marks on the plat below.
2. If more than one lease is dedicated to the well, outline each and identify the ownership thereof (both as to work interest and royalty).
3. If more than one lease of different ownership is dedicated to the well, have the interests of all owners been consolidated by communitization, unitization, force-pooling, etc?

☒ Yes ☐ No If answer is "yes," type of consolidation unitization

If answer is "no," list the owners and tract descriptions which have actually been consolidated. (Use reverse side of this form if necessary.)

No allowable will be assigned to the well until all interests have been consolidated (by communitization, unitization, forced-pooling, or otherwise) or until a non-standard unit, eliminating such interests, has been approved by the Division.
* Non-standard due to archeology. Note: reissued to show moved location

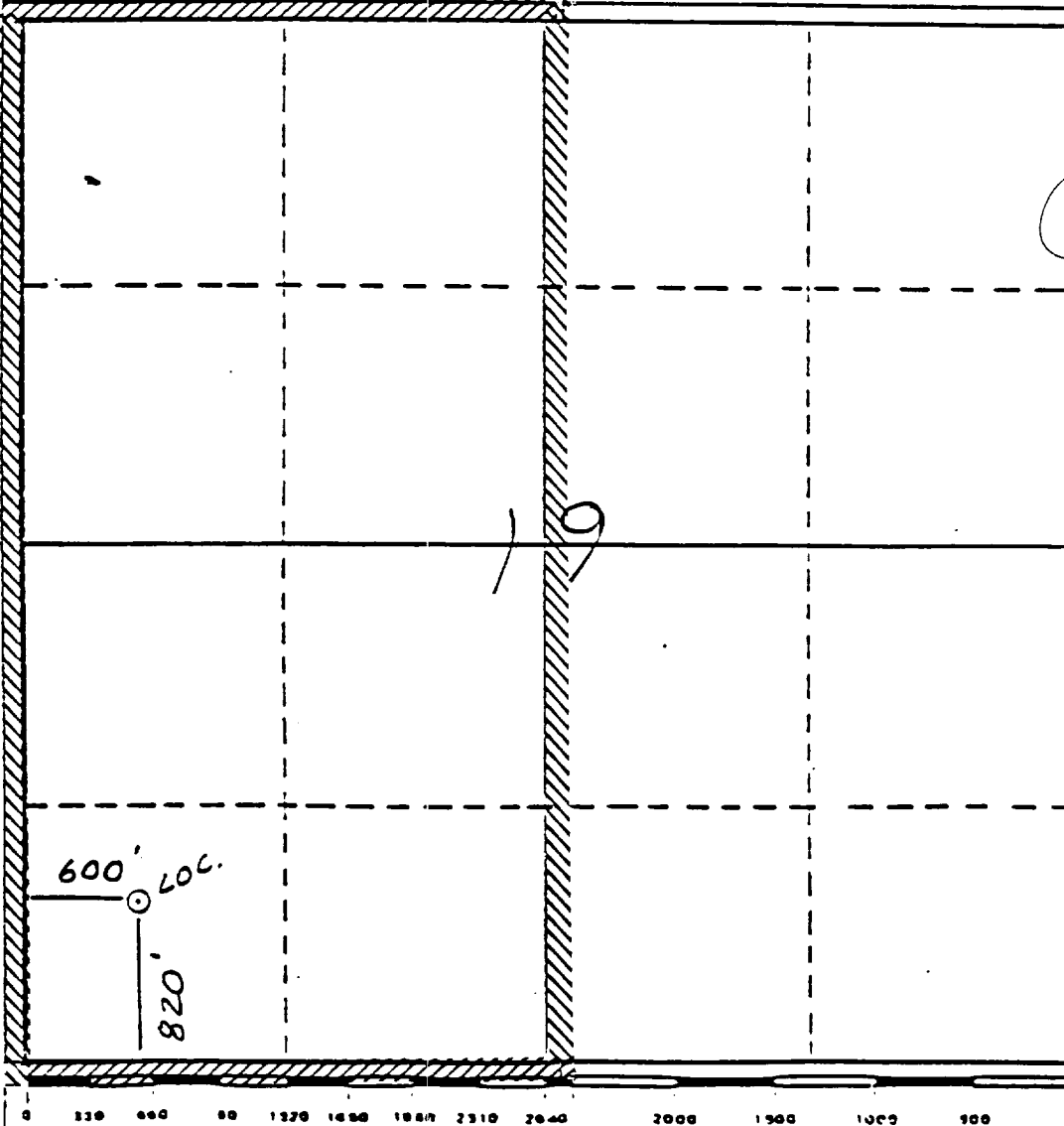

CERTIFICATION

I hereby certify that the information contained herein is true and complete to best of my knowledge and belief.

Neale C. Edward
Name
Regulatory Affairs

Position
El Paso Natural Gas

Company
11-30-88

Date

I hereby certify that the location shown on this plat was plotted from notes of actual survey made by me under my supervision, and that the same is true and correct to the best of my knowledge and belief.

Neale C. Edward
Date Surveyed
11-17-88

Registered Professional Engineer
and/or Land Surveyor

Neale C. Edward

Certificate No.
6657