

30-045-27529

UNITED STATES
DEPARTMENT OF THE INTERIOR
BUREAU OF LAND MANAGEMENT

APPLICATION FOR PERMIT TO DRILL, DEEPEN, OR PLUG BACK

1a. TYPE OF WORK DRILL	5. LEASE NUMBER SF-077652
1b. TYPE OF WELL GAS SINGLE ZONE	6. IF INDIAN, ALL. OR TRIBE NAME
2. OPERATOR SOUTHLAND ROYALTY CO.	7. UNIT AGREEMENT NAME
3. ADDRESS & PHONE NO. OF OPERATOR P O BOX 4289 FARMINGTON, NM 87499	8. FARM OR LEASE NAME EAST
4. LOCATION OF WELL 790'S 1210'W	9. WELL NO. 101
14. DISTANCE IN MILES FROM NEAREST TOWN 4 MILES FROM AZTEC	10. FIELD, POOL, OR WILDCAT BASIN FRUITLAND COAL
	11. SEC. T. R. M OR BLK. M SEC. 25 T31N R12W NMPM
15. DISTANCE FROM PROPOSED LOCATION 790' TO NEAREST PROPERTY OR LEASE LINE.	12. COUNTY 13. STATE SAN JUAN NM
16. ACRES IN LEASE 2560	17. ACRES ASSIGNED TO WELL W/ 320.00
18. DISTANCE FROM PROPOSED LOCATION TO NEAREST WELL DR. 300' COMPL., OR APPLIED FOR ON THIS LEASE.	20. ROTARY OR CABLE TOOLS ROTARY
21. ELEVATIONS (DF, FT, GR, ETC.) 5983'GL	22. APPROX. DATE WORK WILL START

This action is subject to technical and
procedural review pursuant to 43 CFR 3160.4
and appeal pursuant to 43 CFR 3165.4.

23. PROPOSED CASING AND CEMENTING PROGRAM

*SEE OPERATIONS PLAN

RECEIVED

NOV 13 1989

24. AUTHORIZED BY: *[Signature]*
REGULATORY AFFAIRS

OIL CON. DIV
DIST. 3

3-29-89
DATE

24:00 PM 11/13/89

NOTE: THIS FORMAT IS ISSUED IN LIEU OF US BLM FORM 3160-3.

84
②

Submit to Appropriate
District Office
State Lease - 4 copies
Fee Lease - 3 copies

State of New Mexico
Energy, Minerals and Natural Resources Department

Form C-102
Revised 1-1-89

OIL CONSERVATION DIVISION

P.O. Box 2088
Santa Fe, New Mexico 87504-2088

DISTRICT I
P.O. Box 1980, Hobbs, NM 88240

DISTRICT II
P.O. Drawer DD, Artesia, NM 88210

DISTRICT III
1000 Rio Brazos Rd., Aztec, NM 87410

WELL LOCATION AND ACREAGE DEDICATION PLAT

All Distances must be from the outer boundaries of the section

Operator Southland Royalty Company			Lease East (SF-077652)		Well No. 101
Unit Letter II	Section 25	Township 31 North	Range 12 West	County San Juan	
Actual Footage Location of Well: 790 feet from the South line and 1210 feet from the West line					
Ground level Elev. 5983 "	Producing Formation Fruitland Coal		Pool Basin	Dedicated Acreage: 320 Acres	

1. Outline the acreage dedicated to the subject well by colored pencil or hatchure marks on the plat below.
2. If more than one lease is dedicated to the well, outline each and identify the ownership thereof (both as to working interest and royalty).
3. If more than one lease of different ownership is dedicated to the well, have the interest of all owners been consolidated by communitization, unitization, force-pooling, etc.?
☐ Yes ☐ No If answer is "yes" type of consolidation _____
If answer is "no" list the owners and tract descriptions which have actually been consolidated. (Use reverse side of this form if necessary.) _____
No allowable will be assigned to the well until all interests have been consolidated (by communitization, unitization, forced-pooling, or otherwise) or until a non-standard unit, eliminating such interest, has been approved by the Division.

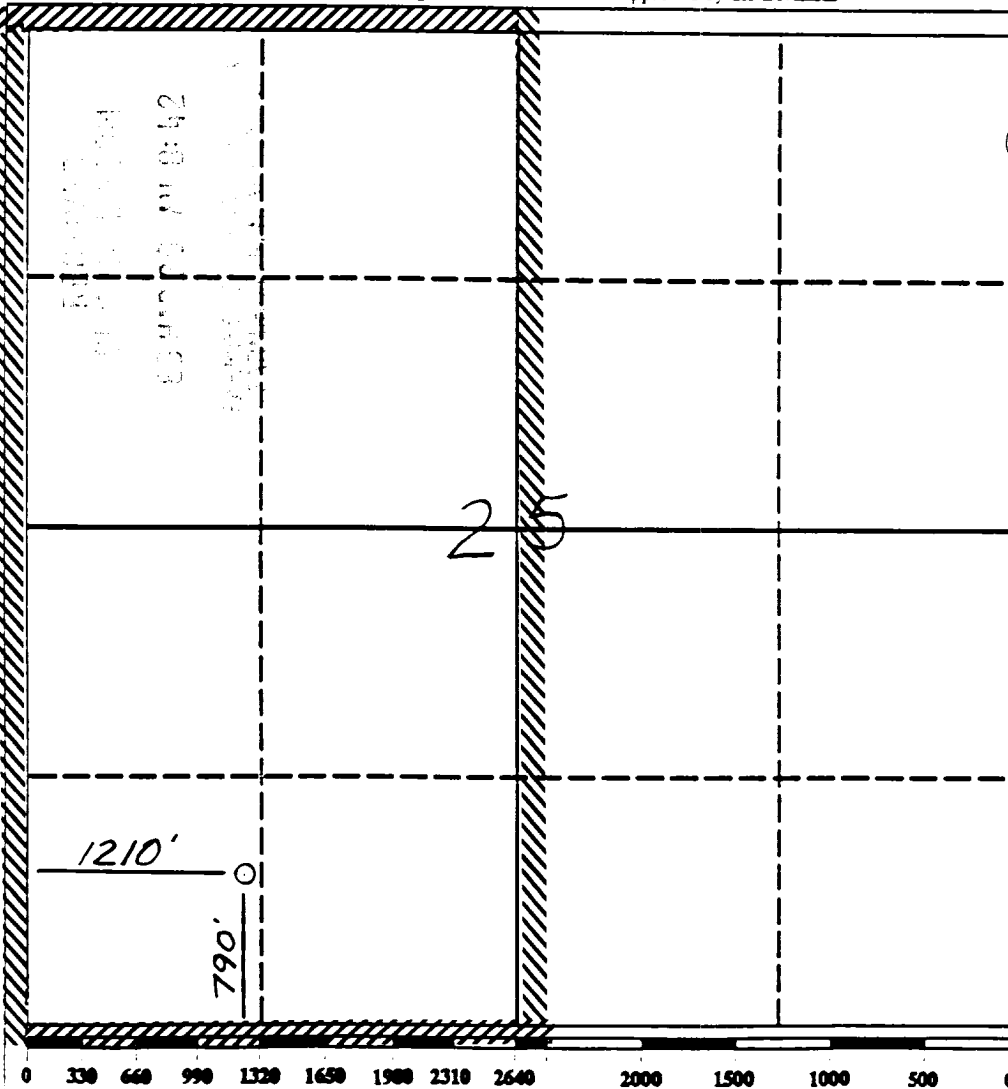

OPERATOR CERTIFICATION

I hereby certify that the information contained herein is true and complete to the best of my knowledge and belief.

Peggy Bradfield
Signature

Peggy Bradfield

Printed Name

Regulatory Affairs

Position

Southland Royalty Co
Company

Date

SURVEYOR CERTIFICATION

I hereby certify that the well location shown on this plat was plotted from field notes of actual surveys made by me or under my supervision, and that the same is true and correct to the best of my knowledge and belief.

2-27-89

Date Surveyed

Negle G. Edwards

Signature & Seal of
Professional Surveyor

6857
Certificate No.

6857

OPERATIONS PLAN

DATE: MAR 15, 1989

Well Name: 101 EAST 790'S 1210'W
 Sec. 25 T31N R12W SAN JUAN NEW MEXICO
 BASIN FRUITLAND COAL Elevation 5983'GL

Formation tops: Surface- NACIMIENTO
 Ojo Alamo- 807
 Kirtland- 837
 Fruitland- 2086
 Fruitland Coal Top- 2336
 Fruitland Coal Base- 2406
 Intermediate TD- 2316
 Total Depth- 2408
 Pictured Cliffs- 2416

Logging Program: Mud logs from intermediate to total depth.

Mud Program: Low solid non-dispersed mud from surface to total depth.

Casing Program:	Hole Size	Depth Interval	Csg. Size	Weight	Grade
	12 1/4"	0 - 200	9 5/8"	32.3#	H-40
	8 3/4"	0 - 2316	7"	20.0#	K-55
	6 1/4"	2266 - 2408	5 1/2"	15.5#	K-55
Tubing Program:		0 - 2408	2 7/8"	6.5#	J-55

Float Equipment: 9 5/8" surface casing - saw tooth guide shoe.

7" intermediate casing - guide shoe and self-fill insert float valve. Three centralizers run every other joint above shoe. Run insert float one joint above the guide shoe.

5 1/2" production liner - float shoe on bottom and a pre-drilled liner run to the 7" casing with a minimum 50' overlap. Liner hanger is a double slip grip type.

Wellhead Equipment: 9 5/8" x 7" x 2 7/8" x 11" 3000 psi xmas tree assembly.

Cementing:
 9 5/8" surface casing - cement with 106 sacks of class "B" cement with 1/4# flocele/sack and 3% calcium chloride (125 cu ft. of slurry, 100% excess to circulate to surface). WOC 12 hours. Test casing to 600 psi for 30 minutes.

7" intermediate casing - lead with 174 sacks of 65/35 class "B" poz with 6% gel, 2% calcium chloride and 1/2 cu.ft. Perlite/sack (10.3 gallons of water/sack) tail with 100 sacks of class "B" with 2% calcium chloride. 454 cu ft. of slurry, 100% excess to cover the Ojo Alamo. Run temperature survey at 8 hours. WOC 12 hours. Test casing to 1500 psi for 30 minutes.

5 1/2" liner - do not cement.

The Fruitland coal formation will be completed.

A 3000 psi WP and 6000 psi test double gate preventer equipped with blind and pipe rams will be used for blow out prevention on this well. This gas is dedicated.
 The W/2 of Section 25 is dedicated to this well.

