

UNITED STATES
DEPARTMENT OF THE INTERIOR

BUREAU OF LAND MANAGEMENT NT *30-045-28936*

APPLICATION FOR PERMIT TO DRILL, DEEPEN, OR PLUG BACK

1a. TYPE OF WORK

DRILL ☒

DEEPEN ☐

PLUG BACK ☐

b. TYPE OF WELL

OIL
WELL ☐

GAS
WELL ☐

OTHER ☒ SWD

SINGLE
ZONE ☐

MULTIPLE
ZONE ☐

2. NAME OF OPERATOR

Phillips Petroleum Company *17654*

3. ADDRESS OF OPERATOR

5525 Hwy 64, NBU 3004, Farmington, NM 87401

4. LOCATION OF WELL (Report location clearly and in accordance with any State requirements.)

At surface Unit B, 1033' FNL & 1764' FEL

At proposed prod. zone Same as above

14. DISTANCE IN MILES AND DIRECTION FROM NEAREST TOWN OR POST OFFICE*

Approximately 20 miles southeast of Ignacio, CO

15. DISTANCE FROM PROPOSED*
LOCATION TO NEAREST
PROPERTY OR LEASE LINE, FT.
(Also to nearest drlg. unit line, if any)

19. DISTANCE FROM PROPOSED LOCATION*
TO NEAREST WELL, DRILLING, COMPLETED,
OR APPLIED FOR, ON THIS LEASE, FT.

16. NO. OF ACRES IN LEASE

2240

19. PROPOSED DEPTH

9525'

17. NO. OF ACRES ASSIGNED
TO THIS WELL

0 *NA*

20. ROTARY OR CABLE TOOLS

Rotary

21. ELEVATIONS (Show whether DF, RT, GR, etc.)

6599' (Unprepared)

*This action is subject to technical and
procedural review pursuant to 43 CFR 3160.3
and appeal pursuant to 43 CFR 3185.4.*

22. APPROX. DATE WORK WILL START*

Upon Approval

23.

PROPOSED CASING AND CEMENTING PROGRAM

DRILLING OPERATIONS AUTHORIZED ARE
SUBJECT TO COMPLIANCE WITH ATTACHED
"GENERAL REQUIREMENTS"

SIZE OF HOLE	SIZE OF CASING	WEIGHT PER FOOT	SETTING DEPTH
20"	16"	65#, J-55	400'
13-1/2"	10-3/4"	51#, L-80	3800'
9-1/2"	7-5/8"	26.4#, C-95	3600'-7200'
6-1/2"	5-1/2", 4-1/2"	17#, 11.6#, C-95	7200' & 9525'

QUANTITY OF CEMENT
915 Sx CI B, Circ to Surface
See Attachment I, Circ to Surface
See Attachment I, Circ to Liner Top
See Attachment I, Circ to Liner Top

RECEIVED

MAR 18 1993

OIL CON. DIV
DIST. 3

SEE ATTACHED CEMENT & MUD PROGRAMS
BOP EQUIPMENT: See Fig. 7-7 or 7-8

IN ABOVE SPACE DESCRIBE PROPOSED PROGRAM: If proposal is to deepen or plug back, give data on present productive zone and proposed new productive zone. If proposal is to drill or deepen directionally, give pertinent data on subsurface locations and measured and true vertical depths. Give blowout preventer program, if any.

24.

SIGNED

J. B. Stonestreet for
L. E. Robinson

TITLE Sr. Drlg. & Prod. Engr.

DATE 5-15-92

(This space for Federal or State office use)

PERMIT NO.

APPROVAL DATE

APPROVED
AS AMENDED

APPROVED BY

CONDITIONS OF APPROVAL, IF ANY:

TITLE

MAR 15 1993

DISTRICT MANAGER

*See Instructions On Reverse Side

Submit to Appropriate
District Office
State Lease - 4 copies
Fee Lease - 3 copies

State of New Mexico
Energy, Minerals and Natural Resources Department

Form C-102
Revised 1-1-89

OIL CONSERVATION DIVISION

P.O. Box 2088
Santa Fe, New Mexico 87504-2088

DISTRICT I
P.O. Box 1980, Hobbs, NM 88240

DISTRICT II
P.O. Drawer DD, Artesia, NM 88210

DISTRICT III
1000 Rio Brazos Rd., Aztec, NM 87410

WELL LOCATION AND ACREAGE DEDICATION PLAT

All Distances must be from the outer boundaries of the section

RECEIVED
BLM
MAY 15 PM 2:33

Operator PHILLIPS PETROLEUM		SAN JUAN 32-8 UNIT		302 SWD	
Unit Lease B	Section 33	Township T.32 N.	Range R.8 W.	County SAN JUAN	

Actual Footage Location of Well:		NORTH 1764		EAST	
Ground level Elevation 6599	Producing Formation Morrison-Entrada- Bluff	Pool Undesignated Morrison-Entrada	Dedicated Acreage: 0 Acres		

1. Outline the acreage dedicated to the subject well by colored pencil or hatchure marks on the plat below.
2. If more than one lease is dedicated to the well, outline each and identify the ownership thereof (both as to working interest and royalty).
3. If more than one lease of different ownership is dedicated to the well, have the interest of all owners been consolidated by communitization, unitization, force-pooling, etc?
☐ Yes ☐ No If answer is "yes" type of consolidation _____
If answer is "no" list the owners and tract descriptions which have actually been consolidated. (Use reverse side of this form if necessary.)
No allowable will be assigned to the well until all interests have been consolidated (by communitization, unitization, force-pooling, or otherwise) or until a non-standard unit, eliminating such interest, has been approved by the Division.

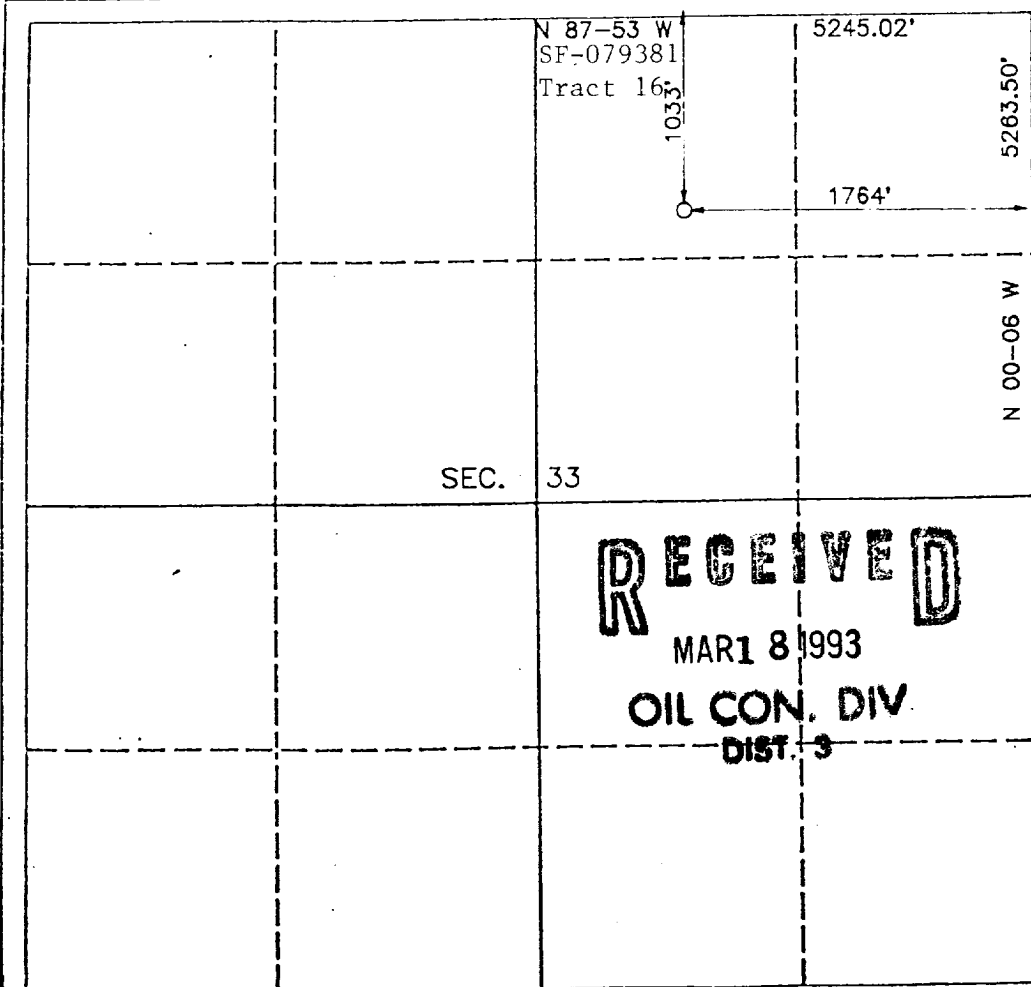

OPERATOR CERTIFICATION

I hereby certify that the information contained herein is true and complete to the best of my knowledge and belief.

Signature *J. L. Stonestreet for*
Printed Name L. E. Robinson
Position Sr. Drlg. & Prod. Engr.
Company Phillips Petroleum Company
Date May 15, 1992

SURVEYOR CERTIFICATION

I hereby certify that the well location shown on this plat was plotted from field notes of actual surveys made by me or under my supervision, and that the same is true and correct to the best of my knowledge and belief.

Date Surveyed APRIL 8, 1992

Signature & Seal of Professional Surveyor
ROY A. RUSH
NEW MEXICO
8894
Certified Professional Land Surveyor

0 330 660 990 1320 1650 1980 2310 2640 2000 1500 1000 500 0

SAN JUAN 32-8 UNIT

302 SWD

Canyon

205

32

33

Jaquez

PUMP

MESA

Arena

Canyon

6573

Barrel Spring

17

16

15

Simon

303 SWD

Phillips Petroleum Company
Farmington Area

Unit/Well No. :	<u>32-8 # 302 SWD</u>	Location :	_____
Datum of specified depths :	_____	Spud Date :	_____
Date Completion began :	_____	Final Date of Completion :	_____

SAN JUAN 32-2 # 302 SWD : PROPOSED

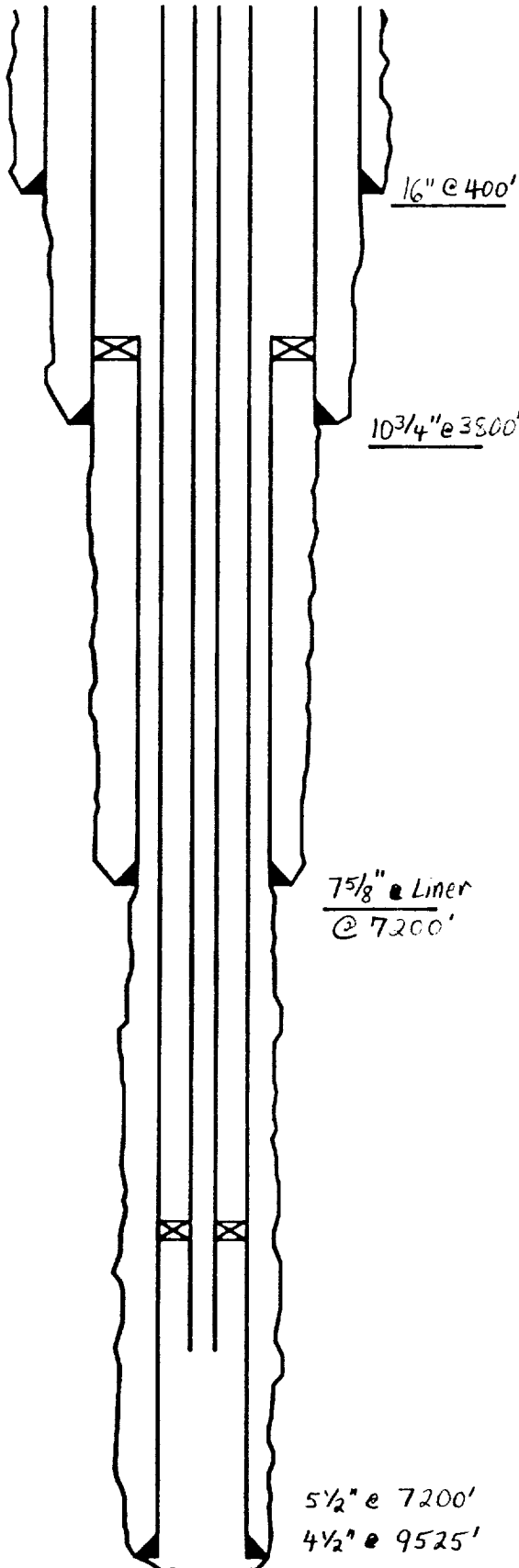

Casing/Tubulars Program

	Size (in)	Grade	Setting Depth (ft)
Conductor	16" ; 65 #/ft	J-55	400'
Surface	10 3/4" ; 51 #/ft	L-80	3800'
Intermediate Liner	7 5/8" ; 26.4 #/ft	C-95	Top 3600' Bottom 7200'
Production	5 1/2" ; 17 #/ft	C-95	7200'
	4 1/2" ; 11.6 #/ft	C-95	9525'
Tubing	2 7/8" ; 6.5 #/ft	N-80	8300'

Cement Program

	Lead	Tail	Comments
Conductor	665 sacks CL 'B" @ 15.6 ppj 1.15 #/sx	250 sacks CL 'B" w/ 3% CaCl ₂ @ 15.6 ppj ; 1.19 #/sx	Circulate cement to surface
Surface	See Attachment I	See Attachment I	Circulate cement to surface
Intermediate	See Attachment I	See Attachment I	Circulate cement to top of liner
Production	See Attachment I	See Attachment I	Circulate cement above 7 5/8" liner shoe

ATTACHMENT I: CEMENTING PROGRAMS

10-3/4" CASING:

Cement I = 65:35 (Class "B":Fly Ash) with 6% Bentonite, 10 lb/sx Gilsonite and 2% KCl (by weight of mix water); 12.4 ppg & 1.87 ft³/sx.

Cement II = Class "B" Neat cement @ 15.6 ppg & 1.18 ft³/sx.

Two stage cement job with stage tool set at approximately 2700'.

First Stage: Lead: 120 Sxs Cement I
 Tail: 200 Sxs Cement II

Second Stage: Lead: 560 Sxs Cement I
 Tail: 200 Sxs Cement II

7-5/8" CASING:

Lead: 275 Sxs 50:50 (Class "B":Fly Ash) with 2% Bentonite, 0.8% Halad-9 (Fluid Loss), 1/4 lb/sx Flocele and 2% KCl (by weight of mix water); 13.6 ppg & 1.26 ft³/sx.

Tail: 200 Sxs Class "B" cement with 0.8% Halad-9 (Fluid Loss), 0.4% CFR-3 (Friction Reducer) and 1/4 lb/sx Flocele; 15.6 ppg & 1.18 ft³/sx.

5-1/2" & 4-1/2" CASING:

700 Sxs Class "G" cement with 40% Silica Flour (Fine-Grained), 0.6% Halad-423 (Fluid Loss), 0.2% CFR-2 (Friction Reducer), 0.2% HR-12 (High Temperature Retardent) and 6 lbs/sx Gilsonite; 15.5 ppg & 1.62 ft³/sx.