

Submit to Appropriate  
District Office  
State Lease - 6 copies  
Fee Lease - 5 copies

State of New Mexico  
Energy, Minerals and Natural Resources Department

Form C-101  
Revised 1-1-89

OIL CONSERVATION DIVISION

DISTRICT I  
P.O. Box 1980, Hobbs, NM 88240

P.O. Box 2088  
Santa Fe, New Mexico 87504-2088

DISTRICT II  
P.O. Drawer DD, Artesia, NM 88210

DISTRICT III  
1000 Rio Brazos Rd., Aztec, NM 87410

API NO. (assigned by OCD on New Wells)

30-045-29084

5. Indicate Type of Lease

STATE ☒

FEE ☐

6. State Oil & Gas Lease No.

B-11125-82

APPLICATION FOR PERMIT TO DRILL, DEEPEN, OR PLUG BACK

1a. Type of Work:

DRILL ☒

RE-ENTER ☐

DEEPEN ☐

PLUG BACK ☐

b. Type of Well:

OIL  
WELL ☐

GAS  
WELL ☒

OTHER

SINGLE  
ZONE ☒

MULTIPLE  
ZONE ☐

2. Name of Operator

Conoco, Inc. 5073

3. Address of Operator

10 Desta Dr. Ste 100W, Midland, TX 79705

7. Lease Name or Unit Agreement Name

FC State Com

8. Well No.

2R

9. Pool name or Wildcat

Basin Fruitland Coal

4. Well Location

Unit Letter A : 790 Feet From The north Line and 790 Feet From The east Line

Section 32

Township 31N

Range 9W

NMPM

San Juan County

10. Proposed Depth

3084'

11. Formation

Fruitland Coal

12. Rotary or C.T.

13. Elevations (Show whether DF, RT, GR, etc.)

6287'

14. Kind & Status Plug. Bond

15. Drilling Contractor

16. Approx. Date Work will start

17.

PROPOSED CASING AND CEMENT PROGRAM

SIZE OF HOLE	SIZE OF CASING	WEIGHT PER FOOT	SETTING DEPTH	SACKS OF CEMENT	EST. TOP
12-1/4"	9-5/8"	36#	220'	120 sxs	surface
8-3/4"	7"	23#	2850'	470 sxs	surface
6-1/4"	open hole		3084'		

It is proposed to drill this Fruitland Coal well vertically to a depth of 3085' according to the well plan contained in the following attachments:

1. Well Location and Acreage Dedication Plat (C-102)
2. Proposed Well Plan Outline
3. Casing, Cementing, and Mud programs information sheet
4. BOP information sheet
5. BOP / Choke Diagram
6. Diagram of Drilling Stack Configuration for open-hole cavitation drilling

RECEIVED

FEB 11 1994

OIL CON. DIV.  
DIST. 3

IN ABOVE SPACE DESCRIBE PROPOSED PROGRAM: IF PROPOSAL IS TO DEEPEN OR PLUG BACK, GIVE DATA ON PRESENT PRODUCTIVE ZONE AND PROPOSED NEW PRODUCTIVE ZONE. GIVE BLOWOUT PREVENTER PROGRAM, IF ANY.

I hereby certify that the information above is true and complete to the best of my knowledge and belief.

SIGNATURE

Jerry W. Hoover

TITLE Sr. Conservation Coordinator DATE 2/7/94

TYPE OR PRINT NAME

Jerry W. Hoover

(915) 686-6548 TELEPHONE NO.

(This space for State Use)

APPROVED BY

Emil Busch

TITLE

DEPUTY OIL & GAS INSPECTOR, DIST. #3

This Approval

DATE

FEB 11 1994

CONDITIONS OF APPROVAL, IF ANY:

Expires 2-11-95

And Will Not Be

Extended

Submit to Appropriate  
District Office  
State Lease - 4 copies  
Fee Lease - 3 copies

State of New Mexico  
Energy, Minerals and Natural Resources Department

Form C-102  
Revised 1-1-89

OIL CONSERVATION DIVISION

P.O. Box 2088

Santa Fe, New Mexico 87504-2088

DISTRICT I  
P.O. Box 1980, Hobbs, NM 88240

DISTRICT II  
P.O. Drawer DD, Artesia, NM 88210

DISTRICT III  
1000 Rio Brazos Rd., Aztec, NM 87410

WELL LOCATION AND ACREAGE DEDICATION PLAT

All Distances must be from the outer boundaries of the section

Operator Conoco		Lease F.C. State Com		Well No. 2R	
Unit Letter A	Section 32	Township 31 North	Range 9 West	County San Juan	
Actual Footage Location of Well: 790 feet from the North line and 790 feet from the East line					
Ground level Elev. 6287'	Producing Formation Fruitland Coal		Pool Basin Fruitland Coal	Dedicated Acreage: 14/320 Acres	
<p>1. Outline the acreage dedicated to the subject well by colored pencil or hectare marks on the plat below.</p> <p>2. If more than one lease is dedicated to the well, outline each and identify the ownership thereof (both as to working interest and royalty).</p> <p>3. If more than one lease of different ownership is dedicated to the well, have the interest of all owners been consolidated by communitization, unitization, force-pooling, etc.? <input type="checkbox"/> Yes <input type="checkbox"/> No If answer is "yes" type of consolidation _____</p> <p>If answer is "no" list the owners and tract descriptions which have actually been consolidated. (Use reverse side of this form if necessary.) _____</p> <p>No allowable will be assigned to the well until all interests have been consolidated (by communitization, unitization, forced-pooling, or otherwise) or until a non-standard unit, eliminating such interest, has been approved by the Division.</p>					

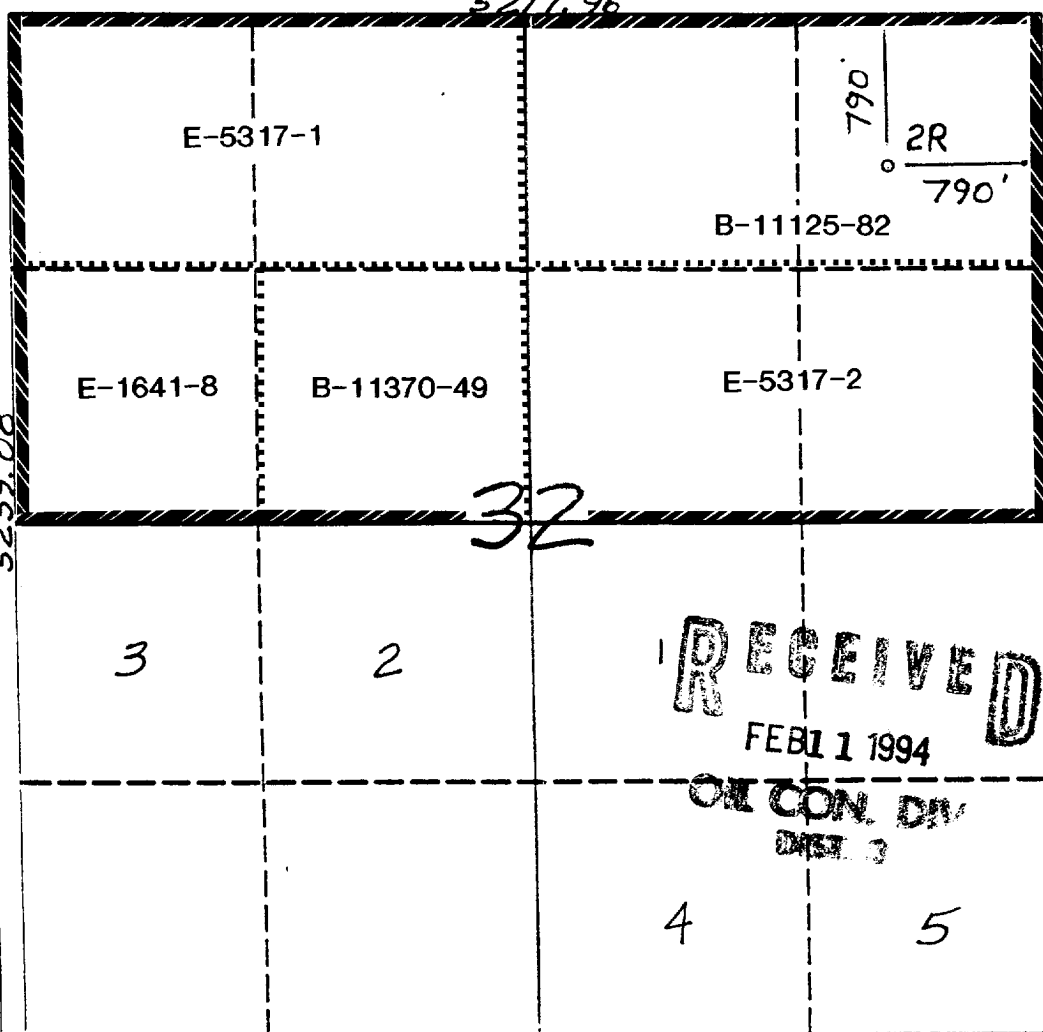

OPERATOR CERTIFICATION

I hereby certify that the information contained herein is true and complete to the best of my knowledge and belief.

Signature  
*Jerry W. Hoover*  
Printed Name  
Jerry W. Hoover  
Position  
Sr. Conservation Coordinator  
Company  
Conoco Inc.  
Date  
2/17/94

SURVEYOR CERTIFICATION

I hereby certify that the well location shown on this plat was plotted from field notes of actual surveys made by me or under my supervision, and that the same is true and correct to the best of my knowledge and belief. 10-20-93

Date Surveyed  
New Mexico  
Signature  
Professional Surveyor  
6857

Certificate No.  
6857

## PROPOSED WELL PLAN OUTLINE

WELL NAME: F.C. STATE COM 2R

EST. KB = +6356

LOCATION: 790' FNL & 790' FEL, SEC 32, T31N, R9W, SAN JUAN CO., N.M.

[illegible]

DATE: JANUARY 1994

PREPARED BY:

**F.C. STATE COM 2R  
SEC 32, T31N, R9W  
SAN JUAN COUNTY, NEW MEXICO**

Conoco proposes to drill the 2R well as a vertical hole to 3084'. The well will further develop the Fruitland Coal reservoir. The well will be drilled to the surface casing point using native mud. The well will then be drilled to 2850' with water/gel mud. The attached modified 12-inch 3000 psi blow-out preventor well be used for this portion of the hole. A 7" casing string will be run and cemented as detailed below. The Fruitland Coal will then be drilled underbalance with air. Please find attached Diagrams 2 showing the BOP schematic for the drilling of the Fruitland Coal and the following "Cavitation Completion". This well will be completed as an open hole "Cavitation Completion" in the Fruitland Coal. The surface and bottom hole location and casing and cement program are planned as follows:

Surface & PBHL: 790' FNL & 790' FEL Sec. 32-31N-9W

**CASING AND CEMENTING PROGRAM:**

Footage	Casing	Cement
220'	9-5/8" 36.0#, K-55, ST&C	<u>120</u> sxs Cl "B" + 2% CaCl 15.6 ppg, 1.18 cu. ft./sx
2850'	7" 23.0#, K-55, LT&C	<u>320</u> sxs 35/65/6 Cl "B" + 6.25 pps Kolseal + 10% Salt + 1/4 pps Celloflake + .2 SMS 12.5 ppg, 2.10 cu. ft./sx  <u>150</u> sxs Cl "B" + 2% CaCl 15.6 ppg, 1.18 cu. ft./sx

**MUD PROGRAM**

Interval	Mud Weight (lbs/gal)	Viscosity (secs)	Fluid Loss (cc)	MudType
0'- 220'	8.4 - 9.4	Native	N/C	SpudMud
220'-2850'	8.4 - 9.4	30 - 45	N/C	Gel/Water
2850'-3084'	N/A	N/A	N/A	Air/1% KCl Water

**EVALUATION**

No open-hole logs will be run. The Fruitland Coal section will be mud logged while drilling for the

open hole completion.

## **BOP INFORMATION**

Drilling contractors used in the San Juan Basing supply 3000 psi equipment, but cannot provide annular preventors because of sub-structure limitations. Maximum anticipated surface pressures for this well will not exceed the working pressure of the proposed BOP system. Please see the attached BOP diagram details 2000 psi equipment according to Onshore Order No. 2 even though the equipment will test to 3000 psi. The 2000 psi system allows deletion of the annular preventor and fulfills your requirements (note diagram No. 1). In addition, the following equipment will comprise the 2000 psi system:

1. Two rams with one blind and one pipe ram.
2. Kill line (2 inch minimum).
3. One kill line valve.
4. One choke line valve.
5. Two chokes (reference diagram No. 1).
6. Upper kelly cock valve with handle.
7. Safety valve and subs to fit all drill strings in use.
8. Two-inch minimum choke line.
9. Pressure gauge on choke manifold.
10. Fill-up line above the upper most preventor.
11. Rotating head.

Please direct any questions to: Billy Goodwin - (915) 686-6154 in Conoco's Midland Office.

DIAGRAM 1

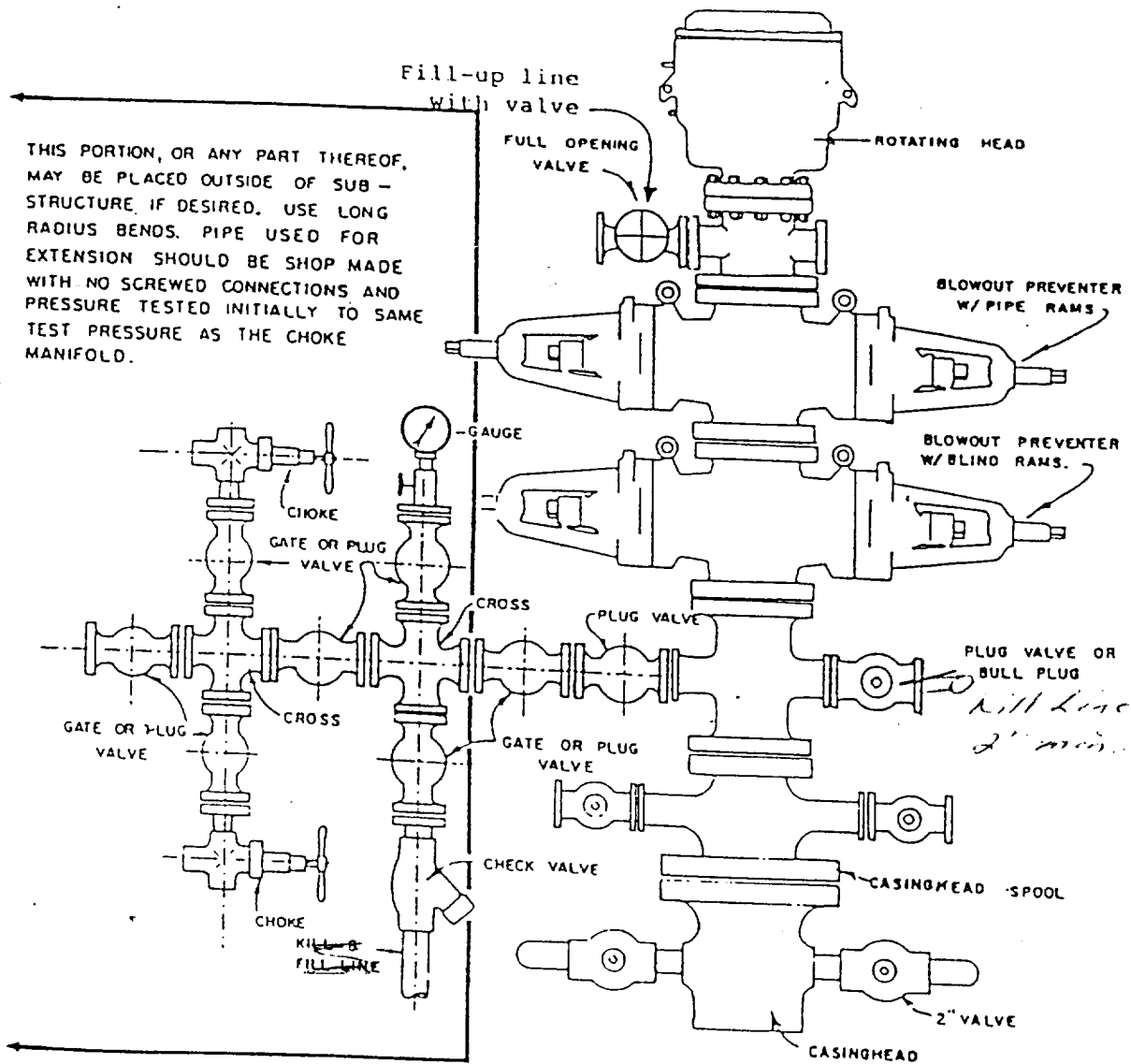

BLOWOUT PREVENTER HOOKUP

DIAGRAM 2

# DRILLING STACK CONFIGURATION

DRILLING FRUITLAND COAL SECTION UNDERBALANCE

