

RECEIVED  
UNITED STATES  
DEPARTMENT OF THE INTERIOR  
BUREAU OF LAND MANAGEMENT  
MAR 17 PM 4:03

SUBMIT IN TRIPLICATE\*  
(Other instructions on  
reverse side)

FORM APPROVED  
OMB NO. 1004-0136  
Expires: February 28, 1995

APPLICATION FOR PERMIT TO DRILL OR DEEPEN

1a. TYPE OF WORK

DRILL ☒

DEEPEEN ☐

1b. TYPE OF WELL

OIL  
WELL ☐

GAS  
WELL ☒

OTHER ☐

SINGLE  
ZONE ☒

MULTIPLE  
ZONE ☐

2. NAME OF OPERATOR

Phillips Petroleum Company

3. ADDRESS AND TELEPHONE NO.

5525 Highway 64, NBU 3004, Farmington, NM 87401

505-599-3454

4. LOCATION OF WELL (Report location clearly and in accordance with any State requirements)  
At surface

Unit M, 1220' FSL & 980' FWL

At proposed prod. zone

Same as above

14. DISTANCE IN MILES AND DIRECTION FROM NEAREST TOWN OR POST OFFICE\*

15 miles from Aztec, NM

15. DISTANCE FROM PROPOSED\*

LOCATION TO NEAREST

PROPERTY OR LEASE LINE, FT.

(Also to nearest drlg. unit line, if any)

980'

16. NO. OF ACRES IN LEASE

2080 acres

17. NO. OF ACRES ASSIGNED  
TO THIS WELL

316.27 W/2

18. DISTANCE FROM PROPOSED LOCATION\*

TO NEAREST WELL, DRILLING, COMPLETED,  
OR APPLIED FOR, ON THIS LEASE, FT.

19. PROPOSED DEPTH

3607'

20. ROTARY OR CABLE TOOLS

Rotary

21. ELEVATIONS (Show whether DF, RT, GR, etc.)

6792' unprepared groundlevel

22. APPROX. DATE WORK WILL START\*

2nd Qtr 1999

23. PROPOSED CASING AND CEMENTING PROGRAM

SIZE OF HOLE	GRADE SIZE OF CASING	WEIGHT PER FOOT	SETTING DEPTH	QUANTITY OF CEMENT
12-1/4"	9-5/8"	36#, J/K-55	350'	185 sx (204 cf) C1 H
8-3/4"	7"	20#, J/K-55	3207'	L-370 sx (777 cf) 35/65 C1 H POZ
6-1/4"	5-1/2" liner	15.5#	3187' - 3607'	T-100 sx (120 cf) C1 H
				**

\*\* The 6-1/4" interval from the 7" casing shoe to the base of the coal may be underreamed to 9-1/2".

See the drilling prognosis for more details on the 5-1/2" liner.

See attached for BOP equipment, mud program and cathodic protection.

The pipeline and APD DO NOT qualify for the APD/ROW process. El Paso will be filing for P/L ROW.

This action is subject to technical and  
procedural review pursuant to 43 CFR 3166.3  
and appeal pursuant to 43 CFR 3166.4.

DRILLING OPERATIONS AUTHORIZED ARE  
SUBJECT TO COMPLIANCE WITH ATTACHED  
"GENERAL REQUIREMENTS"

IN ABOVE SPACE DESCRIBE PROPOSED PROGRAM: If proposal is to deepen, give data on present productive zone and proposed new productive zone. If proposal is to drill or deepen directionally, give pertinent data on subsurface locations and measured and true vertical depths. Give blowout preventer program, if any.

24.

SIGNED

*Patsy Clugston*

TITLE

Regulatory Assistant

DATE

12/17/98

(This space for Federal or State office use)

MAR 12 1999

PERMIT NO.

APPROVAL DATE

Application approval does not warrant or certify that the applicant holds legal or equitable title to those rights in the subject lease which would entitle the applicant to conduct operations thereon.

CONDITIONS OF APPROVAL, IF ANY:

APPROVED BY

*Chip Haraden*

TITLE

*Acting Team Lead*

DATE

3/12/99

\*See Instructions On Reverse Side

Title 18 U.S.C. Section 1001, makes it a crime for any person knowingly and willfully to make to any department or agency of the United States any false, fictitious or fraudulent statements or representations as to any matter within its jurisdiction.

NMCD

District I  
180 Box 1980, Hobbs, NM 88241-1980  
District II  
811 South First, Artesia, NM 88210  
District III  
1000 Rio Brazos Rd., Aztec, NM 87410  
District IV  
2040 South Pacheco, Santa Fe, NM 87505

STATE OF NEW MEXICO  
Energy, Minerals & Natural Resources Department

Revised October 18, 1994

OIL CONSERVATION DIVISION  
2040 South Pacheco  
Santa Fe, NM 87505

Instructions on back  
Submit to Appropriate District Office  
State Lease - 4 Copies  
Fee Lease - 3 Copies

98 DEC 17 PM 4:03

☐ AMENDED REPORT

WELL LOCATION AND ACREAGE DEDICATION PLAT

1 APT Number 30-045-29758		2 Pool Code 71629		3 Pool Name Basin Fruitland Coal	
4 Property Code 24392		5 Property Name SAN JUAN 32 FED 21 UNIT			6 Well Number 2
7 OGRID No. 017654		8 Operator Name PHILLIPS PETROLEUM COMPANY			9 Elevation 6792'

10 Surface Location

UL or lot no.	Section	Township	Range	Lot Idn	Feet from the	North/South line	Feet from the	East/West line	County
M	21	32N	9W		1220'	SOUTH	980'	WEST	SAN JUAN

11 Bottom Hole Location If Different From Surface

UL or lot no.	Section	Township	Range	Lot Idn	Feet from the	North/South line	Feet from the	East/West line	County
M									

12 Dedicated Acres 316.27 W/2	13 Joint or Infill N	14 Consolidation Code	15 Order No.
----------------------------------	-------------------------	-----------------------	--------------

NO ALLOWABLE WILL BE ASSIGNED TO THIS COMPLETION UNTIL ALL INTERESTS HAVE BEEN CONSOLIDATED OR A NON-STANDARD UNIT HAS BEEN APPROVED BY THE DIVISION

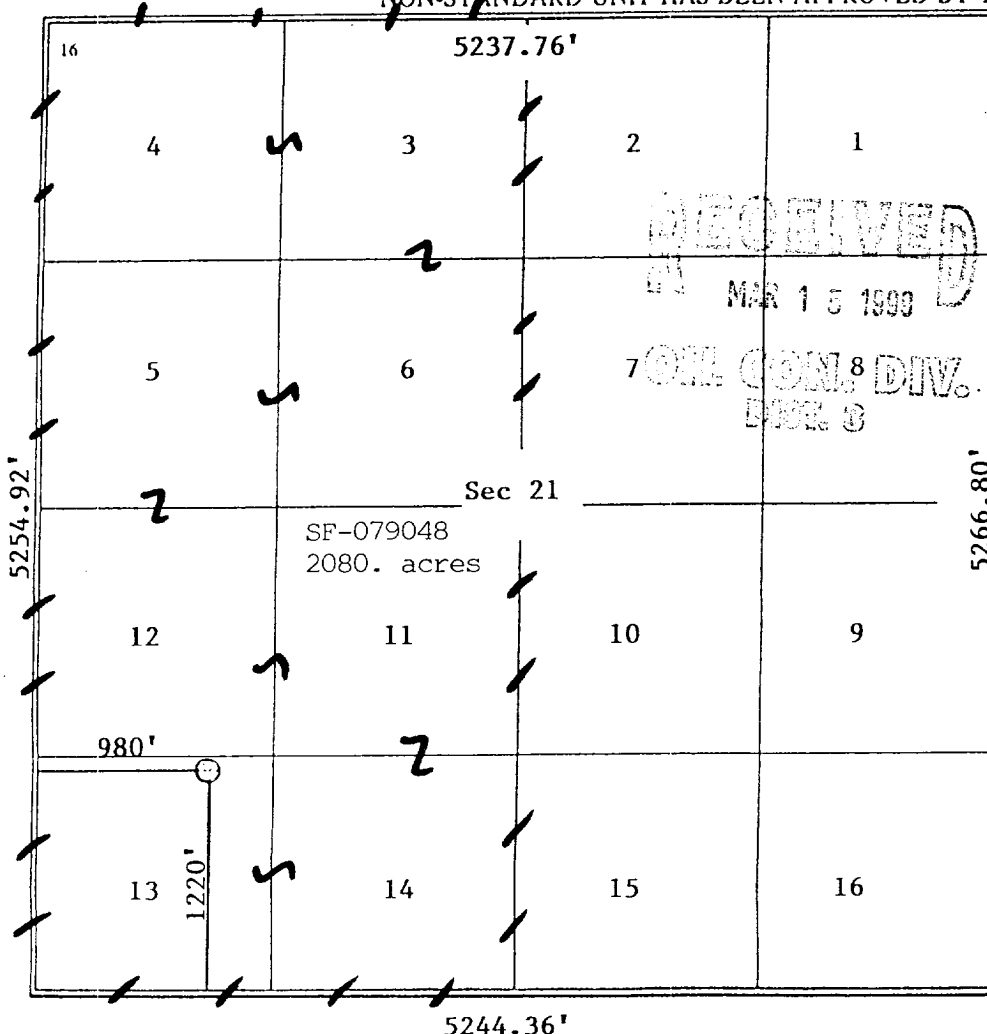

17 OPERATOR CERTIFICATION

I hereby certify that the information contained herein is true and complete to the best of my knowledge and belief

*Patsy Clugston*  
Signature  
Patsy Clugston  
Printed Name  
Regulatory Assistant  
Title  
12-17-98  
Date

18 SURVEYOR CERTIFICATION

I hereby certify that the well location shown on this plat was plotted from field notes of actual surveys made by me or under my supervision, and that the same is true and correct to the best of my belief.

10/13/98  
Date of Survey  
Signature and Seal of Professional Surveyor:

*Henry P. Broadhurst*  
Certificate Number 393  
PROFESSIONAL SURVEYOR

NEW MEXICO-COLOR  
7.5 MINUTE SERIES-COLOR

520000:FILE

