

NO. OF COPIES RECEIVED	
DISTRIBUTION	
SANTA FE	
FILE	
U.S.G.S.	
LAND OFFICE	
OPERATOR	

NEW MEXICO OIL CONSERVATION COMMISSION

Form C-101 -
Revised 1-4-65

5A. Indicate Type of Lease
STATE ☐ FEE ☒
5. State Oil & Gas Lease No.

APPLICATION FOR PERMIT TO DRILL, DEEPEN, OR PLUG BACK

1a. Type of Work DRILL <input checked="" type="checkbox"/> DEEPEN <input type="checkbox"/> PLUG BACK <input type="checkbox"/>		7. Unit Agreement Name Allison Unit
b. Type of Well OIL WELL <input type="checkbox"/> GAS WELL <input checked="" type="checkbox"/> OTHER <input type="checkbox"/>		8. Form or Lease Name Allison Unit
2. Name of Operator Meridian Oil Inc.		9. Well No. 131
3. Address of Operator PO Box 4289, Farmington, NM 87499		10. Field and Pool, or Wildcat: Basin, Fruitland Coal
4. Location of Well UNIT LETTER M LOCATED 1080 FEET FROM THE South LINE AND 925 FEET FROM THE West LINE OF SEC. 24 TWP. 32N RGE. 7W NMPM		12. County San Juan
19. Proposed Depth 3305'		19A. Formation Fruitland
20. Rotary or C.T. Rotary		
21. Elevations (Show whether DE, RT, etc.) 6523' GL 6503	21A. Kind & Status Plug. Bond statewide	21B. Drilling Contractor
22. Approx. Date Work will start		

PROPOSED CASING AND CEMENT PROGRAM

SIZE OF HOLE	SIZE OF CASING	WEIGHT PER FOOT	SETTING DEPTH	SACKS OF CEMENT	EST. TOP
12 1/4"	9 5/8"	32.3#	200'	130 cu.ft.	circ. surface
8 3/4"	7"	20.0#	3205'	242 cu.ft.	cover Ojo Alamo
6 1/4"	5 1/2"	23.0#	3305'	do not cement	

The Fruitland Coal formation will be completed.

A 3000 psi WP and 6000 psi test double gate preventer equipped with blind and pipe rams will be used for blow out prevention on this well.

This gas is dedicated.

The W / 2 of Section 24 is dedicated to this well.

APPROVAL EXPIRES 6-12-88
UNLESS DRILLING IS COMMENCED.
SPUD NOTICE MUST BE SUBMITTED
WITHIN 10 DAYS.

RECEIVED

DEC 12 1988

OIL CON. DIV.
DIST. 3

IN ABOVE SPACE DESCRIBE PROPOSED PROGRAM: IF PROPOSAL IS TO DEEPEN OR PLUG BACK, GIVE DATA ON PRESENT PRODUCTIVE ZONE AND PROPOSED NEW PRODUCTIVE ZONE. GIVE BLOWOUT PREVENTER PROGRAM, IF ANY.

I hereby certify that the information above is true and complete to the best of my knowledge and belief.

Signed [Signature] Title Regulatory Affairs Date 12-12-88
(This space for State Use)

DEPUTY OIL & GAS INSPECTOR, DIST. #3

APPROVED BY [Signature] TITLE

CONDITIONS OF APPROVAL, IF ANY:

DEC 12 1988

All distances must be from the outer boundaries of the Section.

Operator Meridian Oil Inc.		Lease Allison Unit (Fee)		Well No. 131
Unit Letter M	Section 24	Township 32 North	Range 7 West	County San Juan
Actual Postage Location of Well: 1080 feet from the South line and 925 feet from the West line				
Ground Level Elev. 6503	Producing Formation Fruitland Coal		Pool Basin	Dedicated Acreage: 320 Acres

1. Outline the acreage dedicated to the subject well by colored pencil or hatchure marks on the plat below.
2. If more than one lease is dedicated to the well, outline each and identify the ownership thereof (both as to working interest and royalty).
3. If more than one lease of different ownership is dedicated to the well, have the interests of all owners been consolidated by communitization, unitization, force-pooling, etc?

☒ Yes ☐ No If answer is "yes," type of consolidation unitization

If answer is "no," list the owners and tract descriptions which have actually been consolidated. (Use reverse side of this form if necessary.)

No allowable will be assigned to the well until all interests have been consolidated (by communitization, unitization, forced-pooling, or otherwise) or until a non-standard unit, eliminating such interests, has been approved by the Division.

Reissued to show moved location 12-12-88.

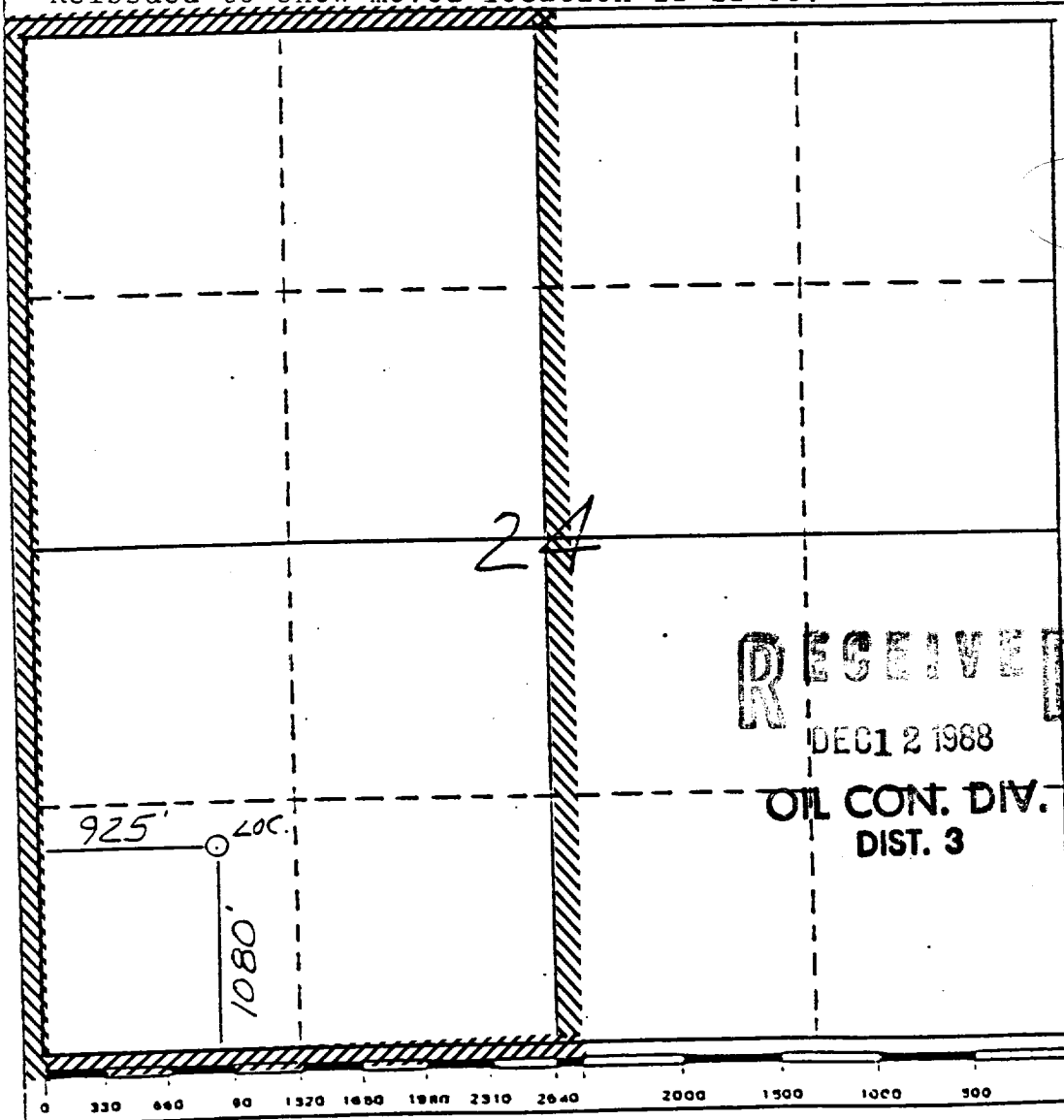

CERTIFICATION

I hereby certify that the information contained herein is true and complete to the best of my knowledge and belief.

Neale C. Edwards
Name

Regulatory Affairs

Position
Meridian Oil Inc.

Company
12-12-88

Date

I hereby certify that the location shown on this plat was plotted from the notes of actual survey made by me under my supervision, and that the same is true and correct to the best of my knowledge and belief.

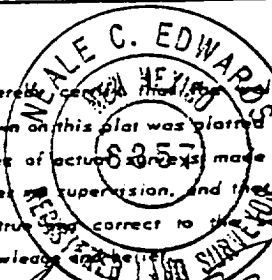

Date Surveyed
12-9-88

Registered Professional Engineer
and/or Land Surveyor

Neale C. Edwards
Certificate No.

6857

RECEIVED
DEC 12 1988
OIL CON. DIV.
DIST. 3