

District I
1625 N. French Dr., Hobbs, NM 88240
District II
811 South First, Artesia, NM 88210
District III
1000 Rio Brazos Road, Aztec, NM 87410
District IV
2040 South Pacheco, Santa Fe, NM 87505

State of New Mexico
Energy Minerals and Natural Resources

Form C-101
Revised March 17, 1999

Oil Conservation Division
2040 South Pacheco
Santa Fe, NM 87505

Submit to appropriate District Office
State Lease - 6 Copies
Fee Lease - 5 Copies

☐ AMENDED REPORT

APPLICATION FOR PERMIT TO DRILL, RE-ENTER, DEEPEN, PLUGBACK, OR ADD A ZONE

¹ Operator Name and Address Koch Exploration Company 20 E. Greenway Plaza Houston, TX 77046		² OGRID Number 12807
³ Property Code 5667		⁴ API Number 30-045-30286
⁵ Property Name Walker		⁶ Well No. 2B

⁷ Surface Location									
UL or lot no. O	Section 10	Township 31N	Range 10W	Lot Idn	Feet from the 660	North/South line South	Feet from the 1712	East/West line East	County San Juan

⁸ Proposed Bottom Hole Location If Different From Surface									
UL or lot no.	Section	Township	Range	Lot Idn	Feet from the	North/South line	Feet from the	East/West line	County
⁹ Proposed Pool 1 Blanco Mesa Verde					¹⁰ Proposed Pool 2				

¹¹ Work Type Code N	¹² Well Type Code G	¹³ Cable/Rotary R	¹⁴ Lease Type Code P	¹⁵ Ground Level Elevation 6131'
¹⁶ Multiple N	¹⁷ Proposed Depth 5350'	¹⁸ Formation Mesa Verde	¹⁹ Contractor	²⁰ Spud Date Upon Approval

²¹ Proposed Casing and Cement Program					
Hole Size	Casing Size	Casing weight/foot	Setting Depth	Sacks of Cement	Estimated TOC
12 1/4"	9 5/8" J-55	36#	200' +/-	140	Surface
8 3/4"	7" J-55	23#	3300' +/-	360	Surface
6 1/4"	4 1/2" J-55	10.5#	3200' - 5350'	240	3200'

- 22 Describe the proposed program. If this application is to DEEPEN or PLUG BACK, give the data on the present productive zone and proposed new productive zone. Describe the blowout prevention program, if any. Use additional sheets if necessary.
- Set new or tested 9-5/8" J-55 36# casing @200' +/- Cement to surface. WOC 12 hrs. Test casing to 1000 psi before drilling out from under shoe.
 - Drill 8-3/4" hole w/ 9.2 PPG mud to 3300' +/- Set 7" J-55 23# casing with enough cement to circulate to surface.
 - Drill 6-1/4" production hole w/ air to TD (5350' +/-). Set 4-1/2" J-55 10.5# production liner or DP with enough cement to circulate from 5350' to 3200'.
 - 3000# double ram BOPs will be installed. For well control pipe rams utilized for when pipe is in the hole and blind rams for when pipe is out of hole. Well head will consist of 11"x9-5/8", 11"x7" (2), 7"x2-3/8", 2-3/8" MV, B1 adapter flange w/ 2-3/8" threads + threaded tee & wing valve.

(See Attachments for further details)

²³ I hereby certify that the information given above is true and complete to the best of my knowledge and belief.

Signature:

Printed name: Donald Johnson

Title: Operations Manager

Date: 6/23/00

Phone: 505-334-9111

OIL CONSERVATION DIVISION

Approved by:

Title: DEPUTY OIL & GAS INSPECTOR, DIST. 4

Approval Date: JUN 23 2000

Expiration Date: JUN 23 2001

Conditions of Approval:

Attached ☐

STRICT II
O. Drawer DD, Artesia, N.M. 80211-0719

STRICT III
00 Rio Brazos Rd., Aztec, N.M. 87410

STRICT IV
Box 2088, Santa Fe, NM 87504-2088

OIL CONSERVATION DIVISION
P.O. Box 2088
Santa Fe, NM 87504-2088

Submit to Appropriate District Office
State Lease - 4 Copies
Fee Lease - 3 Copies

☐ AMENDED REPORT

WELL LOCATION AND ACREAGE DEDICATION PLAT

*API Number 30045-30286		*Pool Code 72319	*Pool Name Blanco Mesa Verde
*Property Code 5667	*Property Name WALKER		*Well Number 2B
*GRID No. 12807	*Operator Name KOCH EXPLORATION		*Elevation 6131'

10 Surface Location									
UL or lot no.	Section	Township	Range	Lot Idn	Feet from the	North/South line	Feet from the	East/West line	County
0	10	31-N	10-W		660'	SOUTH	1712'	EAST	SAN JUAN

11 Bottom Hole Location If Different From Surface									
UL or lot no.	Section	Township	Range	Lot Idn	Feet from the	North/South line	Feet from the	East/West line	County

*Dedicated Acres 313.89 5/2	*Joint or Infill 1	*Consolidation Code	*Order No.
--------------------------------	-----------------------	---------------------	------------

NO ALLOWABLE WILL BE ASSIGNED TO THIS COMPLETION UNTIL ALL INTERESTS HAVE BEEN CONSOLIDATED
OR A NON-STANDARD UNIT HAS BEEN APPROVED BY THE DIVISION

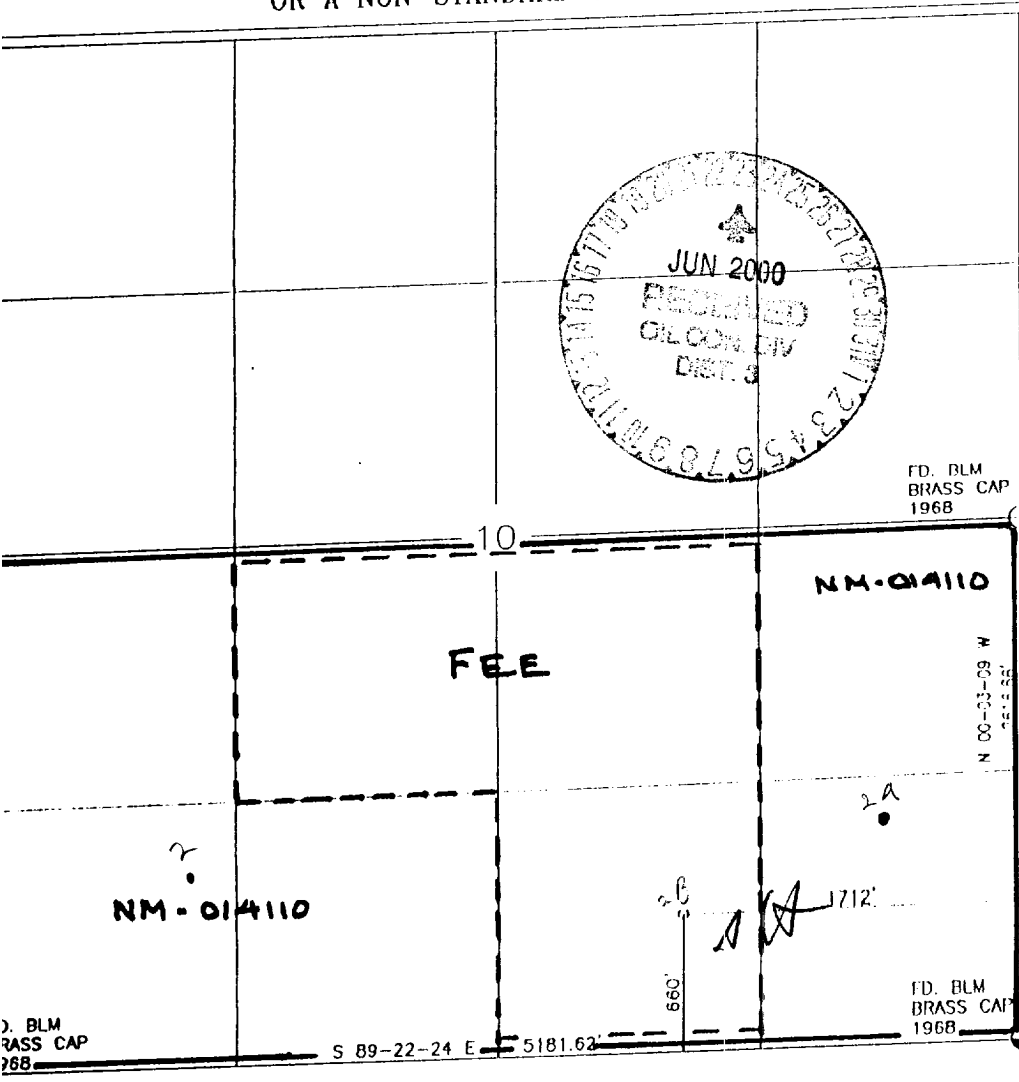

17 OPERATOR CERTIFICATION

I hereby certify that the information contained herein is true and complete to the best of my knowledge and belief

Signature: Rolf A. Ornelas

Printed Name: Rolf A. Ornelas

Title: Sr Engineer

Date: 6/15/00

18 SURVEYOR CERTIFICATION

I hereby certify that the well location shown on this plat was plotted from field notes of actual surveys made by me or under my supervision, and that the same is true and correct to the best of my belief

Date of Survey: 5-3-2000

Signature and Seal of Professional Surveyor: ROY A. RUSH

Certificate Number: 8894

Drilling Program:

1. Geological name of surface formation -

Estimated tops of important geological markers:

Ojo Alamos	2,230 feet
Kirtland Shale	2,250 feet
Fruitland Coal	2,525 feet
Picture Cliff	2,925 feet
Lewis Shale	3,200 feet
Cliff House	4,450 feet
Menefee	4,830 feet
Pt. Lookout	5,180 feet
Mancos	5,345 feet
TD	5,350 feet

2. Estimated depths at which oil, gas, water and mineral bearing formation will be found:

Fresh Water	0 feet to 200 feet
Salt Water	201 feet to 2,525 feet
Oil and Gas	2,526 feet to 5,350 feet

3. Pressure Control Equipment:

- a. 10-inch 900 series or 3,000 PSI test double gate hydraulic with 4-1/2" pipe rams and 10-inch series 900 hydril above 10-inch series casinghead and cross spool with flanged outlets. See BOP diagram at **Exhibit F** for drawing of choke lines, kill lines and choke manifold. Procedures will include waiting on cement 12 hours, nipple up blowout preventer (BOP) assembly and test to 70% of yield of casing or 3,000 psi maximum. The production casinghead pressure rating will be 3,000 psi.
- b. Type of BOP rams: Blind rams and pipe rams are used as shown on the BOP diagram at Exhibit F. Occasionally, the position of the rams is reversed depending on the drilling contractor's methods.
- c. The choke manifold and header will have 2-inch choke outlets, a 2-inch straight through the line with 2-inch adjustable chokes installed. The inlet line will be a 2-inch line. All of the above are rated at 3,000 psi working pressure (WP).

The choke manifold and header system will have manual control valves; no hydraulic valves will be installed.

Casing testing procedure - Surface casing will be tested at 750 psi with 1,000 psi maximum after cementing in place and before drilling out of shoe. Intermediate and production casing will be tested to 3,000 psi after cementing in place and after drilling to the required depth.

- d. Hydraulic controls to close the BOPs are located on the rig floor; the hydraulic remote control is located in the bottom doghouse. There will be no manual controls on the BOP.
- e. BOP testing procedures and frequency:

SEC. 10, T-31-N, R-10-W, N.M.P.M.,
SAN JUAN COUNTY, NEW MEXICO
660' FSL, 1712' FEL
ROAD ACCESS: 451' in length

SE/4 SEC. 10, T-31-N, R-10-W, N.M.P.M.,
SAN JUAN COUNTY, NEW MEXICO
660' FSL, 1712' FEL
ROAD ACCESS: 451' in length

