

Company.....Greenbrier Oil Company.....

Lease..... Well No.....

Sec..... 23 ....., T..... 31 N....., R..... <sup>12</sup> ~~11~~ W....., N.M.P.M.....

Location..... 1700' from the South line and 1130' from the East line.

Elevation..... 6079 Graded ground.

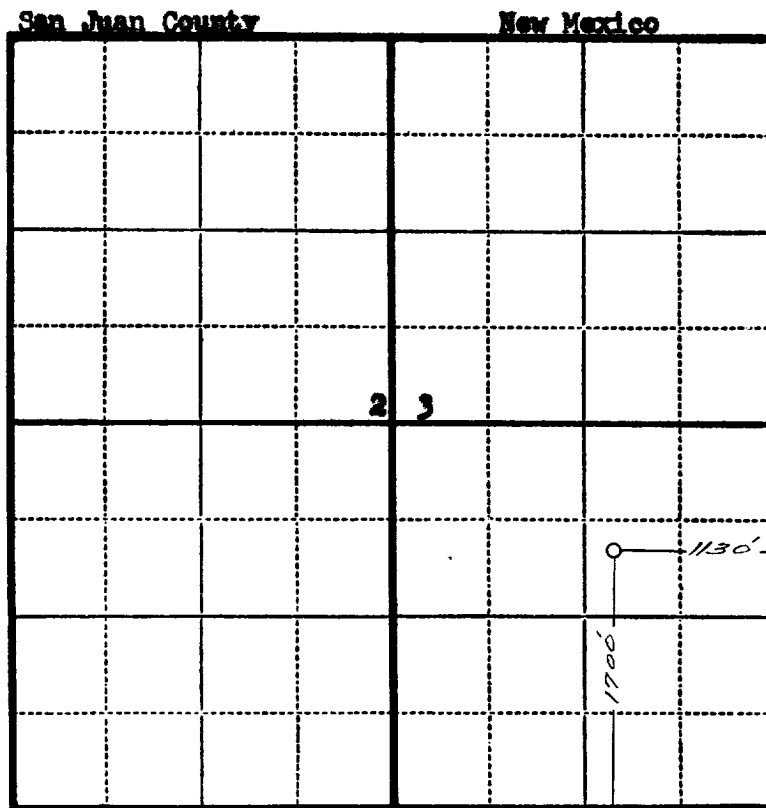

Scale—4 inches equal 1 mile.

This is to certify that the above plat was prepared from field notes of actual surveys made by me or under my supervision and that the same are true and correct to the best of my knowledge and belief.

Seal:

Registered Professional  
Engineer and Land Surveyor.



Charles J. Finkles  
N. Mex. Reg. No. 1302

Surveyed ..... October 22 ....., 19... 52

# OIL CONSERVATION COMMISSION

## AZTEC DISTRICT OFFICE

No. Copies Received 11

### DISTRIBUTION

	NO. FURNISHED	
Operator	7	
Int'l. Fe	1	
Operation Office		
State Land Office		
U.S.C.S.	2	
Transporter		
File	1	✓