

NO. OF COPIES RECEIVED	5
DISTRIBUTION	
SANTA FE	1
FILE	
U.S.G.S.	2
LAND OFFICE	
OPERATOR	1

NEW MEXICO OIL CONSERVATION COMMISSION

Form C-101
Revised 1-1-65

5A. Indicate Type of Lease
STATE <input type="checkbox"/> FEE <input checked="" type="checkbox"/>

5. State Oil & Gas Lease No.

APPLICATION FOR PERMIT TO DRILL, DEEPEN, OR PLUG BACK

1a. Type of Work		7. Unit Agreement Name	
b. Type of Well OIL WELL <input type="checkbox"/> GAS WELL <input checked="" type="checkbox"/> OTHER <input type="checkbox"/>		8. Farm or Lease Name Davis	
2. Name of Operator Palmer Oil & Gas Company		9. Well No. No. 1	
3. Address of Operator P. O. Box 2564, Billings, Montana 59103		10. Field and Pool, or Wildcat Blanco Mesaverde	
4. Location of Well UNIT LETTER F LOCATED 1750 FEET FROM THE North LINE AND 1800 FEET FROM THE West LINE OF SEC. 4 TWP. 26N RGE. 2W NMPM		12. County Rio Arriba	
19. Proposed Depth 6200'		19A. Formation Mesaverde	20. Rotary or C.T. Rotary
21. Elevations (Show whether DF, RT, etc.) 7289' GL	21A. Kind & Status Plug. Bond Blanket	21B. Drilling Contractor Four Corners	22. Approx. Date Work will start January 20, 1979

23.

PROPOSED CASING AND CEMENT PROGRAM

SIZE OF HOLE	SIZE OF CASING	WEIGHT PER FOOT	SETTING DEPTH	SACKS OF CEMENT	EST. TOP
12-1/4"	9-5/8"	36#	225'	250	surface
8-3/4"	7"	20#	3960'	150	
6-1/4"	4-1/2"	10.5# & 11.6#	6200'	350	

- Palmer Oil & Gas Company plans to drill a Mesaverde test in the SE $\frac{1}{4}$ NW $\frac{1}{4}$ Sec. 4-26N-2W.
- Palmer designates the ^N~~W~~ of Section 4 as the spacing unit as illustrated and outlined in red on the attached plat.
- We plan to gas drill below the 7" and set 4-1/2" line from TD to 3800' if productive or plug and abandon as required by the Oil & Gas Commission if dry.
- If productive, the well will be completed by perforating, break down perforations with acid and frac with gelled water, N₂ and 10/20 sand as required.
- Survey plat attached.
- Gas is not dedicated.

IN ABOVE SPACE DESCRIBE PROPOSED PROGRAM: IF PROPOSAL IS TO DEEPEN OR PLUG BACK, GIVE DATA ON PRESENT PRODUCTIVE ZONE AND PROPOSED NEW PRODUCTIVE ZONE. GIVE BLOWOUT PREVENTER PROGRAM, IF ANY.

I hereby certify that the information above is true and complete to the best of my knowledge and belief.

Signed James G. Routson Title Petroleum Engineer Date 12/18/78
James G. Routson
(This space for State Use)

APPROVED BY Frank S. Dargatzis TITLE DEPUTY COMMISSIONER #3 DATE 12/21/78

CONDITIONS OF APPROVAL, IF ANY:

**NEW MEXICO OIL CONSERVATION COMMISSION
WELL LOCATION AND ACREAGE DEDICATION PLAT**

Form C-102
Supersedes C-101
Effective 1-1-6

All distances must be from the outer boundaries of the Section.

Operator PALMER OIL & GAS COMPANY			Lease DAVIS		Well No. 1
Unit Letter F	Section 4	Township 26N	Range 2W	County Rio Arriba	
Actual Footage Location of Well: 1750 feet from the North line and 1800 feet from the West line					
Ground Level Elev. 7289	Producing Formation Mesaverde	Pool Blanco-Mesaverde ext		Dedicated Acreage: 315.92 Acres	

1. Outline the acreage dedicated to the subject well by colored pencil or hatchure marks on the plat below.
2. If more than one lease is dedicated to the well, outline each and identify the ownership thereof (both as to working interest and royalty).
3. If more than one lease of different ownership is dedicated to the well, have the interests of all owners been consolidated by communitization, unitization, force-pooling, etc?

☐ Yes ☐ No If answer is "yes," type of consolidation In process of preparing Communitization Agreement.

If answer is "no," list the owners and tract descriptions which have actually been consolidated. (Use reverse side of this form if necessary.) _____

No allowable will be assigned to the well until all interests have been consolidated (by communitization, unitization, force-pooling, or otherwise) or until a non-standard unit, eliminating such interests, has been approved by the Commission.

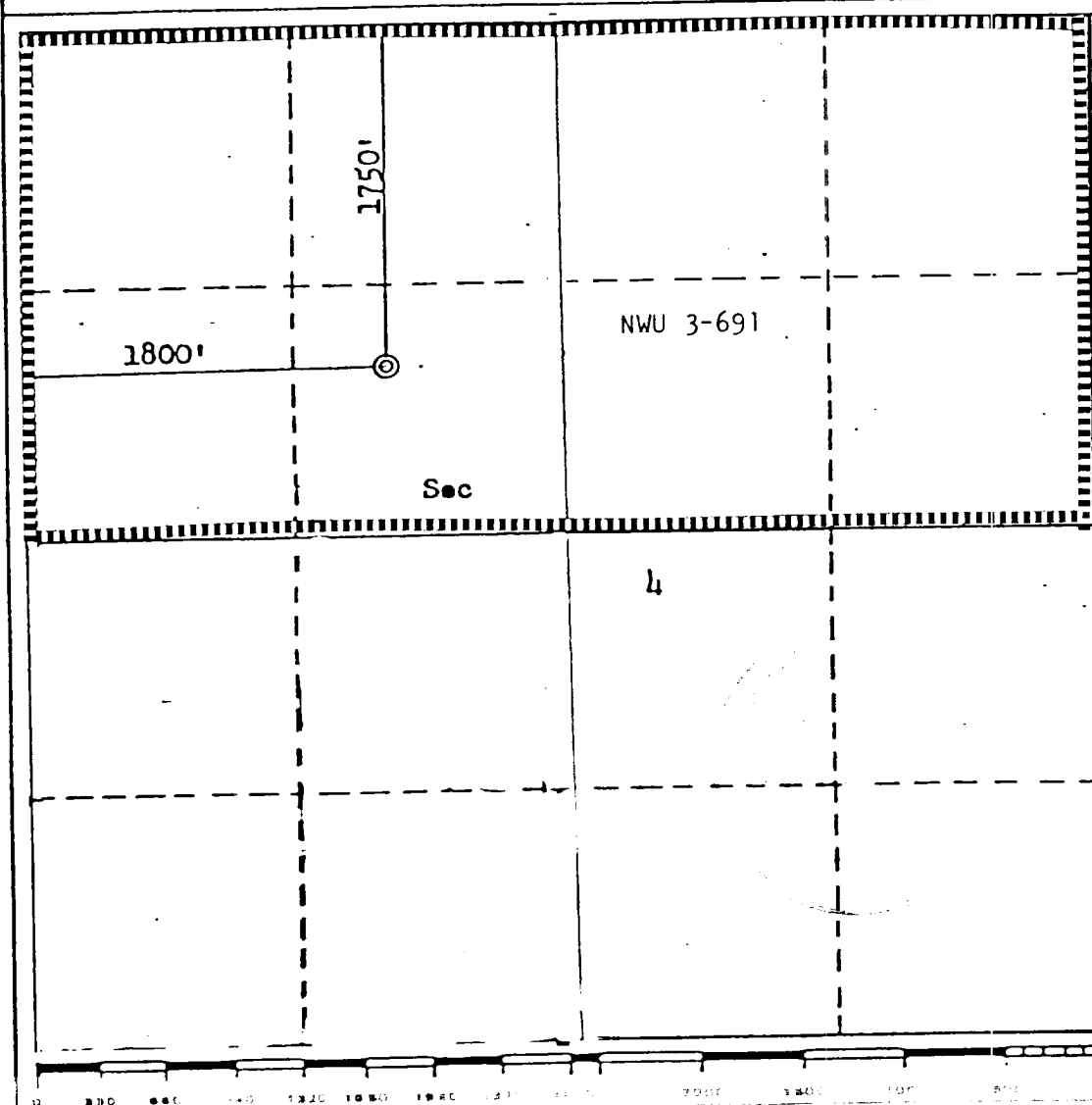

CERTIFICATION

I hereby certify that the information contained herein is true and complete to the best of my knowledge and belief.

James G. Routson
Name

James G. Routson

Position

Petroleum Engineer

Company

Palmer Oil & Gas Company

Date

December 18, 1978

I hereby certify that the well location shown on this plat was plotted from field notes of actual surveys made by me or under my supervision, and that the same is true and correct to the best of my knowledge and belief.

Date Surveyed

December 18, 1978

Registered Professional Engineer and/or Land Surveyor

James G. Routson
No.

James G. Routson
Certification No.

James G. Routson
No.

James G. Routson
No.