

(SUBMIT IN TRIPLICATE)

UNITED STATES
DEPARTMENT OF THE INTERIOR
GEOLOGICAL SURVEY

Land Office Santa Fe
Lease No. SF 080715A
Unit _____

SUNDRY NOTICES AND REPORTS ON WELLS

NOTICE OF INTENTION TO DRILL.....	<input checked="" type="checkbox"/>	SUBSEQUENT REPORT OF WATER SHUT-OFF.....	
NOTICE OF INTENTION TO CHANGE PLANS.....		SUBSEQUENT REPORT OF SHOOTING OR ACIDIZING.....	
NOTICE OF INTENTION TO TEST WATER SHUT-OFF.....		SUBSEQUENT REPORT OF ALTERING CASING.....	
NOTICE OF INTENTION TO RE-DRILL OR REPAIR WELL.....		SUBSEQUENT REPORT OF RE-DRILLING OR REPAIR.....	
NOTICE OF INTENTION TO SHOOT OR ACIDIZE.....		SUBSEQUENT REPORT OF ABANDONMENT.....	
NOTICE OF INTENTION TO PULL OR ALTER CASING.....		SUPPLEMENTARY WELL HISTORY.....	
NOTICE OF INTENTION TO ABANDON WELL.....			

(INDICATE ABOVE BY CHECK MARK NATURE OF REPORT, NOTICE, OR OTHER DATA)

May 10, 1961

~~Abram-Federal~~
Well No. 6 is located 1450 ft. from [N] line and 1800 ft. from [E] line of sec. 19
NE/4 29 24 North 1 West NMPM
($\frac{1}{4}$ Sec. and Sec. No.) (Twp.) (Range) (Meridian)
Undesignated Rio Arriba New Mexico
(Field) (County or Subdivision) (State or Territory)

~~Oround~~

The elevation of the ~~deck~~ floor above sea level is 7643 ft.

DETAILS OF WORK

(State names of and expected depths to objective sands; show sizes, weights, and lengths of proposed casings; indicate mudding jobs, cementing points, and all other important proposed work)

To set a minimum of 100' of 3 5/8" surface casing and cement w/100 sacks. To drill w/rotary tools to an approximate T.D. of 3500'. To run electric log to T.D. If productive, to set approximately 3500' of 4 1/2" casing, and cement w/100 sacks. To perforate the Pictured Cliffs sand, sand-water frac, and run 1 1/2" EUE tubing.

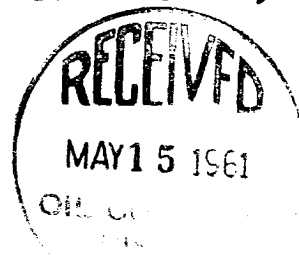

I understand that this plan of work must receive approval in writing by the Geological Survey before operations may be commenced.

Company SHAR-ALAN OIL COMPANY
Address 1402 Denver U. S. National Center
Denver 2, Colorado

By Richard S. Hunt
Richard S. Hunt
Title Mgr. of Lands and Exploration
Box 1428
Durango, Colorado

NEW MEXICO OIL CONSERVATION COMMISSION

Well Location and Acreage Dedication Plat

SECTION A.

Date **May 11, 1961**

Operator **Shar-Alan Oil Company** Lease **Abraham-Federal** **SR 000715 A**
 Well No. **6** Unit Letter **G** Section **19** Township **24 North** Range **1 West** NMPM
 Located **1450** Feet From **North** Line, **1800** Feet From **East** Line
 County **Rio Arriba** G. L. Elevation **7463** Dedicated Acreage **22 1/2 - 160** Acres
 Name of Producing Formation **Pictured Cliffs** Pool **Undesignated**

1. Is the Operator the only owner* in the dedicated acreage outlined on the plat below? Yes ☒ No ☐
2. If the answer to question One is "No," have the interests of all the owners been consolidated by communitization agreement or otherwise? Yes ☐ No ☐ If answer is "Yes," Type of Consolidation _____
3. If the answer to question Two is "No," list all the owners and their respective interests _____

OWNER

LAND DESCRIPTION



SECTION B.

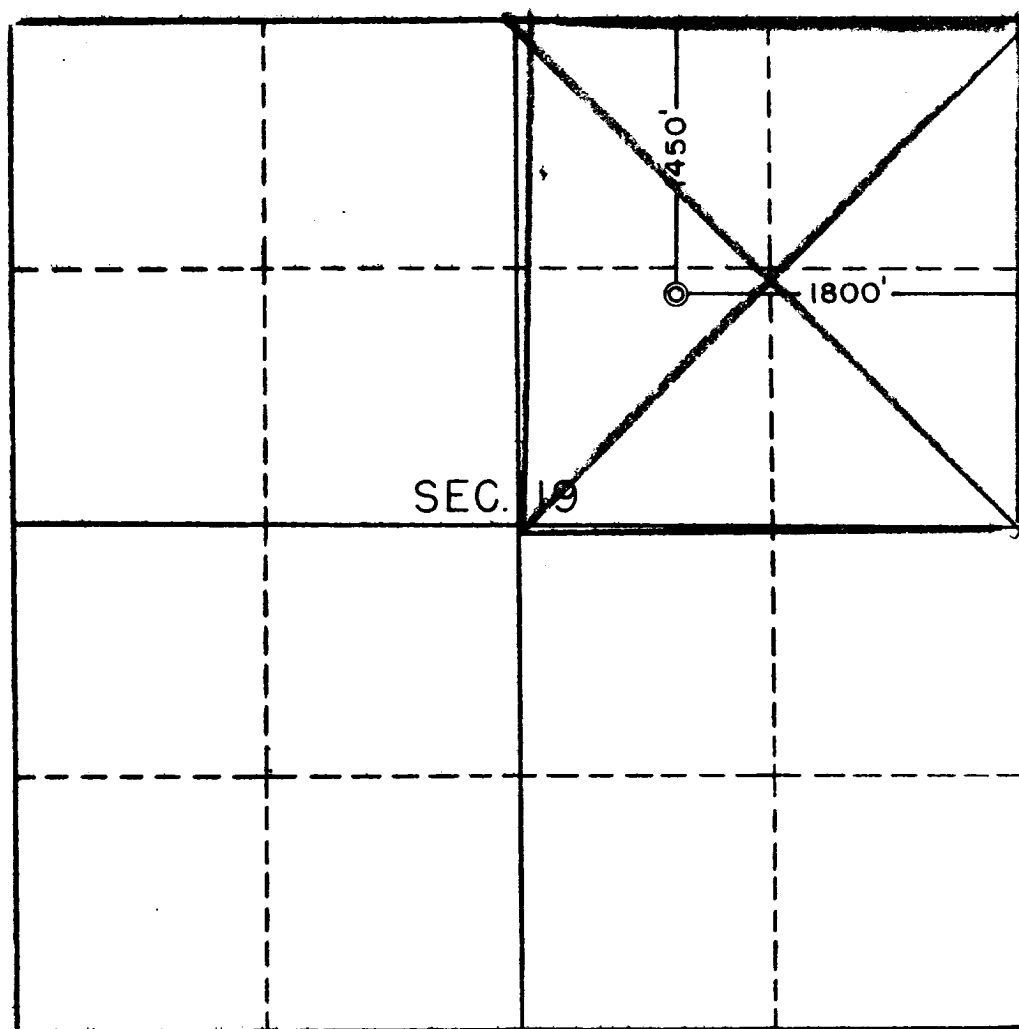

This is to certify that the information in Section A above is true and complete to the best of my knowledge and belief.

SHAR-ALAN OIL COMPANY

By *Richard S. Hunt*
Richard S. Hunt
 (REPRESENTATIVE)
 Mgr. Lands and Exploration
 Box 1428
 Durango, Colorado (ADDRESS)

This is to certify that the well location shown on the plat in Section B was plotted from field notes of actual surveys made by me or under my supervision and that the same is true and correct to the best of my knowledge and belief.

Date Surveyed **April 18, 1961****Four States Engineering Co.**

FARMINGTON, NEW MEXICO

Ernest V. Echshaw
 REGISTERED ENGINEER OR
 AND SURVEYOR

Certificate No. **1545**