

Form 9-331a
(Feb. 1951)

(SUBMIT IN TRIPLICATE)

Land Office Santa Fe
Lease No. S. F. 001353
Unit _____

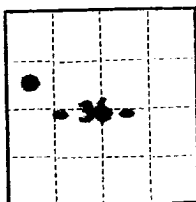

UNITED STATES
DEPARTMENT OF THE INTERIOR
GEOLOGICAL SURVEY

SUNDRY NOTICES AND REPORTS ON WELLS

NOTICE OF INTENTION TO DRILL	<input checked="" type="checkbox"/>	SUBSEQUENT REPORT OF WATER SHUT-OFF	
NOTICE OF INTENTION TO CHANGE PLANS		SUBSEQUENT REPORT OF SHOOTING OR ACIDIZING	
NOTICE OF INTENTION TO TEST WATER SHUT-OFF		SUBSEQUENT REPORT OF ALTERING CASING	
NOTICE OF INTENTION TO RE-DRILL OR REPAIR WELL		SUBSEQUENT REPORT OF RE-DRILLING OR REPAIR	
NOTICE OF INTENTION TO SHOOT OR ACIDIZE		SUBSEQUENT REPORT OF ABANDONMENT	
NOTICE OF INTENTION TO PULL OR ALTER CASING		SUPPLEMENTARY WELL HISTORY	
NOTICE OF INTENTION TO ABANDON WELL			

(INDICATE ABOVE BY CHECK MARK NATURE OF REPORT, NOTICE, OR OTHER DATA)

January 3, 19 57

Well No. 24-A Fed. is located 1010 ft. from N line and 843 ft. from W line of sec. 34

NW 1/4, Sec. 34
(1/4 Sec. and Sec. No.)

T24N, R2W
(Twp.) (Range)

New Mexico Prime
(Meridian)

San Juan Co.
(Field)

New Mexico - Rio Arriba County
(County or Subdivision) (State or Territory)

The elevation of the ground level above sea level is 7317.5 ft.

DETAILS OF WORK

(State names of and expected depths to objective sands; show sizes, weights, and lengths of proposed casings; indicate mudding jobs, cementing points, and all other important proposed work)

The Pictured Cliffs sandstone.

Approximately 100' of 5-5/8" 24-pound surface casing.

Approximately 3500' of 5-1/2" 14-pound production casing.

Cement both surface and production casing.

Mud up for surface.



I understand that this plan of work must receive approval in writing by the Geological Survey before operations may be commenced.

Company San Juan Gas Corporation

Address 1716 First National Building

Tulsa, Oklahoma

By Robert C. Tolan

Title Vice President

NEW MEXICO
OIL CONSERVATION COMMISSION

JUL 24 1956

Form C-128

Well Location and/or Gas Proration Plat

Date January 3, 1957

Operator SAN JUAN GAS CORPORATION

Lease S.F. 081353

Well No. 36-A Fed. Section 36 Township 24 NORTH Range 2 WEST, NMPM

Located 1810 Feet From the NORTH Line, 843 Feet From the WEST Line,

RIO ARRIBA County, New Mexico. G. L. Elevation 7317.5 UNGRADED.

Name of Producing Formation Pictured Cliffs Pool ^{W.C.} ~~Graham~~ Dedicated Acreage 160

(Note: All distances must be from outer boundaries of Section)

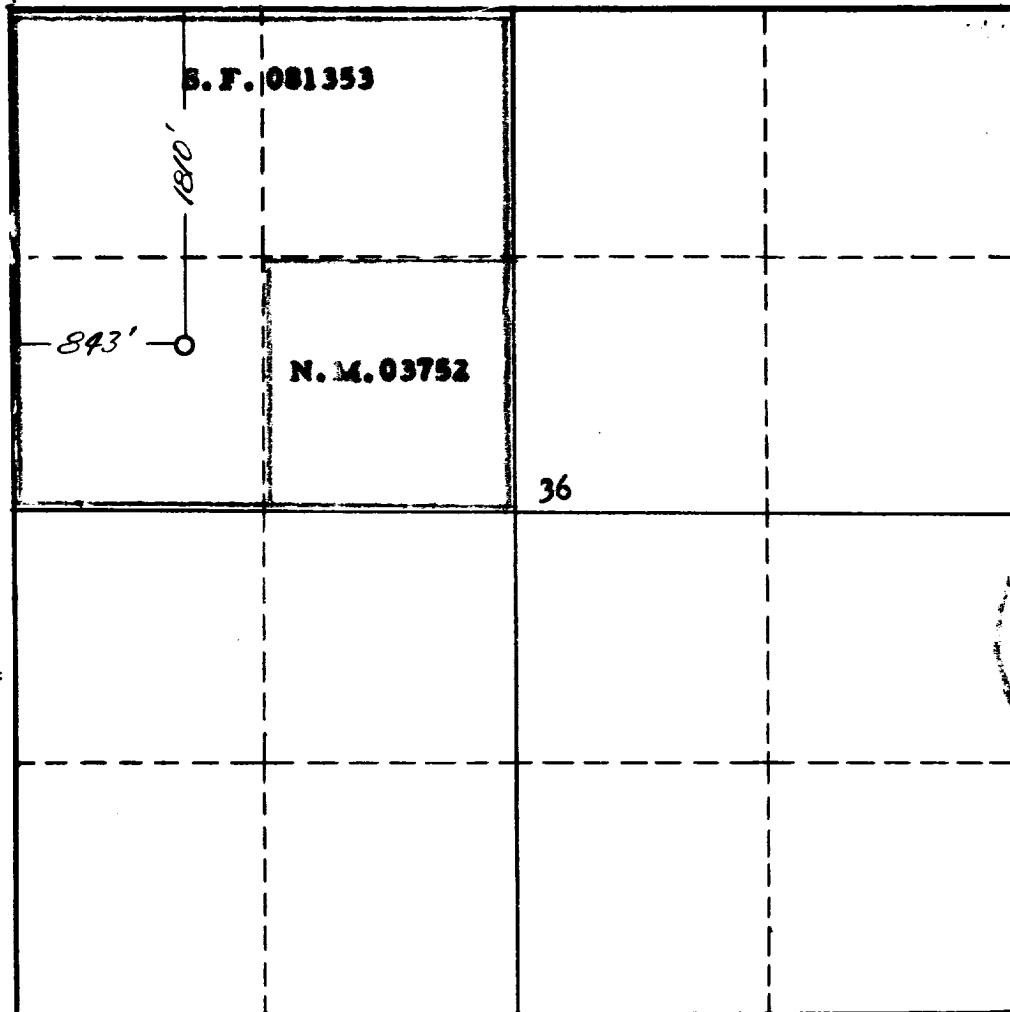

NOTE

This section of
form is to be
used for gas
wells only.



SCALE: 1"=1000'

1. Is this Well a Dual Comp. ? Yes ___ No X .
2. If the answer to Question 1 is yes, are there any other dually completed wells within the dedicated acreage ? Yes ___ No ___ .

Name Robert C. Leese
Position Vice President
Representing San Juan Gas Corporation
Address 1716 First National Building
Tulsa, Oklahoma

This is to certify that the above plat was prepared from field notes of actual surveys made by me or under my supervision and that the same are true and correct to the best of my knowledge and belief.

Date Surveyed 19 MAY 1956
James P. Leese
Registered Professional Engineer and/or
Land Surveyor James P. Leese
N. Mex. Reg. No. 1463

