

NEW MEXICO OIL CONSERVATION COMMISSION
Santa Fe, New Mexico

Form C-101
Revised (12/1/55)

NOTICE OF INTENTION TO DRILL

Notice must be given to the District Office of the Oil Conservation Commission and approval obtained before drilling or recompletion begins. If changes in the proposed plan are considered advisable, a copy of this notice showing such changes will be returned to the sender. Submit this notice in QUINTUPPLICATE. One copy will be returned following approval. See additional instructions in Rules and Regulations of the Commission. If State Land submit 6 Copies Attach Form G-128 in triplicate to first 3 copies of form C-101

Midland, Texas

(Place)

7/25/60

(Date)

OIL CONSERVATION COMMISSION
SANTA FE, NEW MEXICO

Gentlemen:

You are hereby notified that it is our intention to commence the Drilling of a well to be known as

Neil E. Salsich, Jr.

(Company or Operator)

Large

(Lease)

Well No. 2

B

(Unit)

The well is

located 790 feet from the

East

North

line and

1850

feet from the

line of Section 7

T. 24 N

R. 6 W

NMPM.

(GIVE LOCATION FROM SECTION LINE)

Ballard PC

Pool,

Rio Arriba

County

If State Land the Oil and Gas Lease is No.

If patented land the owner is Mark Elkins

Address Grants, New Mexico

We propose to drill well with drilling equipment as follows: Rotary to total depth

The status of plugging bond is \$10,000.00 Blanket Bond

Maryland Casualty Company

Drilling Contractor Not let

We intend to complete this well in the Pictured Cliffs

formation at an approximate depth of 2300 feet.

CASING PROGRAM

We propose to use the following strings of Casing and to cement them as indicated:

Size of Hole	Size of Casing	Weight per Foot	New or Second Hand	Depth	Sacks Cement
11 7/8	8 5/8	24#	New	100	25
7 7/8	4 1/2	9.5#	New	2300	100

If changes in the above plans become advisable we will notify you immediately.

ADDITIONAL INFORMATION (If recompletion give full details of proposed plan of work.)

Approved
Except as follows:

7-28, 1960

Sincerely yours,

Neil E. Salsich, Jr.

(Company or Operator)

By

Position Operator

Send Communications regarding well to

Name Neil E. Salsich

Address 716 1st Nat'l Bank Bldg. - Midland, Texas

OIL CONSERVATION COMMISSION

By



STATE OF NEW MEXICO		
OIL CONSERVATION COMMISSION		
AZTEC DISTRICT OFFICE		
NUMBER OF COPIES RECEIVED		
BY STATE		
SANTA FE		
FILE		
U.S.G.S.		
LAND OFFICE		
TRANSPORTER	OIL	
	GAS	
PRODUCTION OFFICE		
OPERATOR		

NEW MEXICO OIL CONSERVATION COMMISSION

Well Location and Acreage Dedication Plat

Section A.

Date 7/25/60

Operator Neil E. Salsich Jr. Lease Largo
Well No. 2 Unit Letter B Section 7 Township 24 North Range 6 West NMPN
Located 790 Feet From North Line, 1890 Feet From East Line
County El Paso G. L. Elevation 6573 Dedicated Acreage 160 Acres
Name of Producing Formation Pictured Cliffs Pool Ballard

1. Is the Operator the only owner* in the dedicated acreage outlined on the plat below?
Yes X No
2. If the answer to question one is "no," have the interests of all the owners been consolidated by communitization agreement or otherwise? Yes No . If answer is "yes,"
Type of Consolidation
3. If the answer to question two is "no," list all the owners and their respective interests below:

Owner

Land Description

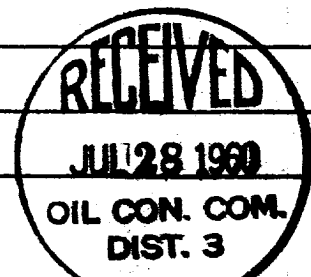

Section B

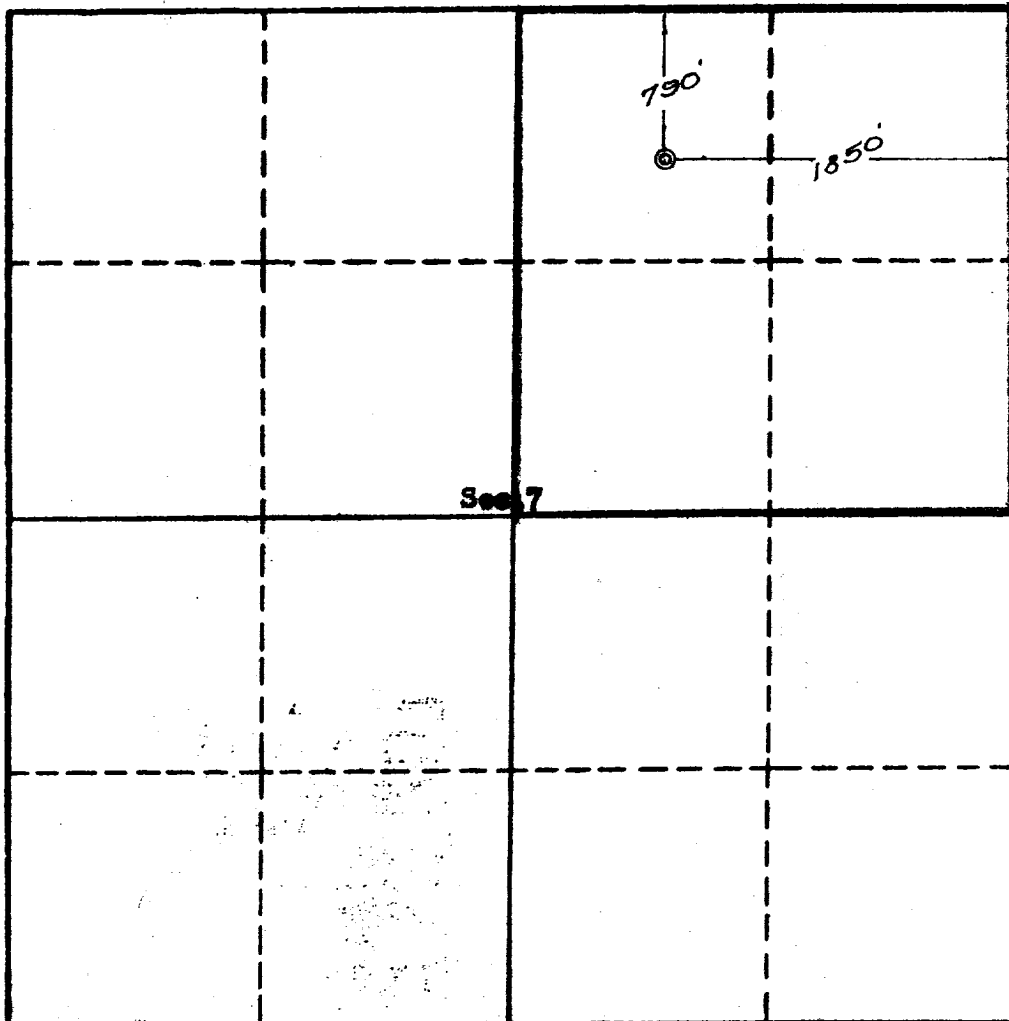

This is to certify that the information in Section A above is true and complete to the best of my knowledge and belief.

Neil E. Salsich, Jr.
(Operator)

(Representative)

Midland, Texas

Address

This is to certify that the well location shown on the plat in Section A was taken from field notes of actual surveys made by me or my super... the best of my knowledge and belief.

Date Surveyed May 12, 1960

Ernest V. Echohawk
Ernest V. Echohawk
Registered Land Surveyor.

Certificate No. 1343

STATE OF NEW MEXICO		
OIL CONSERVATION COMMISSION		
AZT. C DISTRICT OFFICE		
NUMBER OF COPIES RECEIVED		6
DISTRIBUTION		
SANTA FE		
FILE	1	✓
U.S.G.S.	2	
LAND OFFICE		
TRANSPORTER	OIL	
	GAS	
PRODUCTION OFFICE		
OPERATOR	2	